

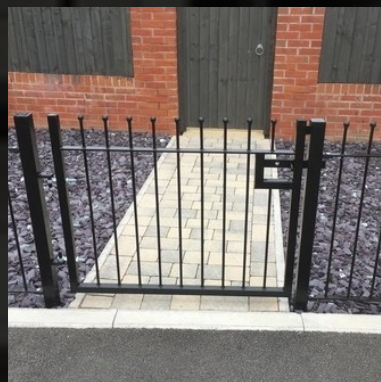

FENCINGDIRECT

Balltop Gates

- Gate frame in 40x8mm flat bar
- Vertical infill in 12mm diameter solid bar with max. 100mm gaps
- 25mm diameter solid balls welded to infill
- Conforms to British Standards
- Available in 900mm and 1200mm heights
- Single leaf pedestrian gates 1200mm wide and double gates 3000mm wide
- Supplied with free standing gate posts and adjustable hinges. Double gates are fitted with drop bolts
- Hot dip galvanising as standard to BS EN 1461
- Polyester powder coating to BS 1722 Part 16 in a choice of standard colours





FENCINGDIRECT

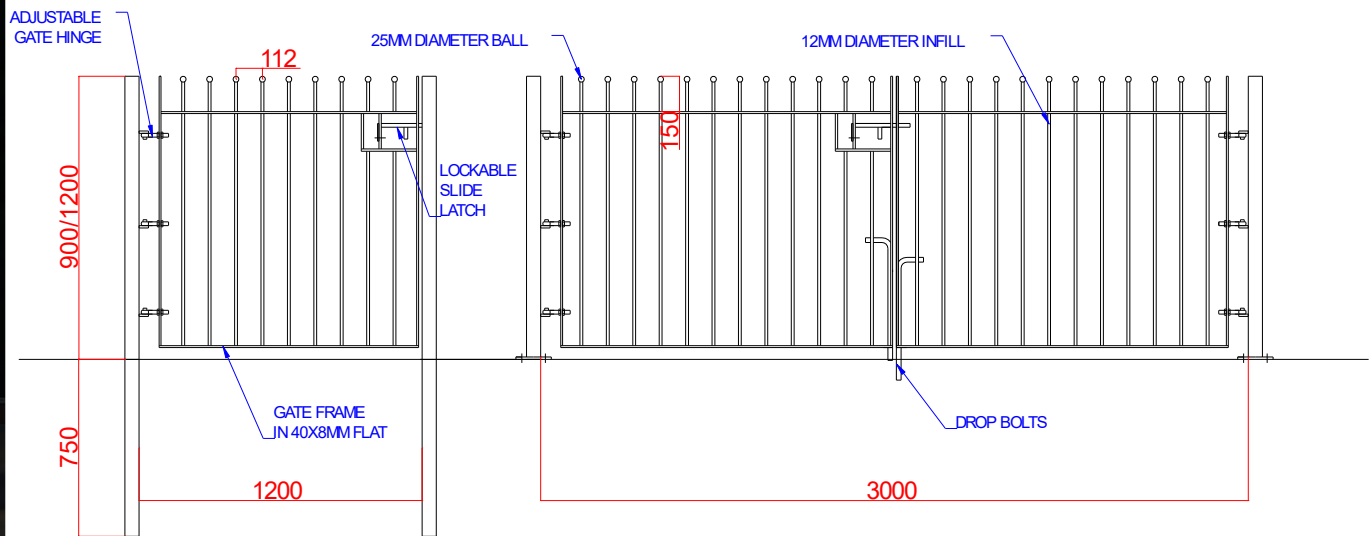

			Gate width	
			1200mm Single	3000mm double
Height	900mm	Galvanised Only	#900SLBALL1200_GO	#900DLBALL3000_GO
	900mm	Galv & PPC	#900SLBALL1200	#900DLBALL3000
	900mm	Galvanised Only - Bolt Down	#900SLBALL1200_BD_GO	#900DLBALL3000_BD_GO
	900mm	Galv & PPC - Bolt Down	#900SLBALL1200_BD	#900DLBALL3000_BD
	1200mm	Galvanised Only	#1200SLBALL1200_GO	#1200DLBALL3000_GO
	1200mm	Galv & PPC	#1200SLBALL1200	#1200DLBALL3000
	1200mm	Galvanised Only - Bolt Down	#1200SLBALL1200_BD_GO	#1200DLBALL3000_BD_GO
	1200mm	Galv & PPC - Bolt Down	#1200SLBALL1200_BD	#1200DLBALL3000_BD