

Welcome to Year 5



Mrs Moore, Miss Lore,
Mr Mateus, Mrs Whitley &
Mrs Prynn (Sycamore Wednesday PM)

Wood End School Motto

Learning Together,
Respecting Each Other

Communication

- Children should arrive at school from 8:40 onwards as this is when staff are on duty to supervise the playgrounds
- When the bell rings children should line up in alphabetical order sensibly, ready for a prompt start

Responsible independent learners

- Children responsible for communicating messages to the teacher
- Non-confidential messages can also be recorded in the reading records - please
- If parents need to speak to a teacher then please make an appointment through the school office or via a note in their reading record

Responsibilities

Responsible for their...

- Correct School Uniform...(named please)
 - School uniform/shoes
 - PE kits and separate kit for clubs
- Equipment - that works and fits in a tray
 - Small pencil case with basic equipment for daily use
- Homework being handed in on time

Behaviour

- The children are responsible for their own behaviour (YOYOB - You Own Your Own Behaviour)
- The school behaviour policy is adhered to. All incidents are fully investigated by the staff and we would appreciate your support on the rare occasions when sanctions have to be given.

Independent Learners

Presentation - be proud of your work

English expectations -

- Handwriting must be joined and legible
- Reading a range of age appropriate genres that improve their vocabulary and understanding about a range of topics, both fiction and non-fiction
- Spelling - for the children to be 'age related' by the end of Key Stage 2 they need to be able to self correct age appropriate words from the Year 5/6 spelling list and spelling patterns that have been taught
- Writing needs to be grammatically correct, include specific vocabulary and organised into cohesive paragraphs, that suits the purpose

Maths expectations

- **Multiplication facts**

Children are responsible for their learning and therefore must ensure that they spend time consolidating areas that they find challenging.

We will put a note in their Reading Record if there is an area that needs further consolidation so that you can support them at home if you would like to.

Curriculum

- We provide a broad and balanced curriculum and our intention is to prepare the children for their futures.
- Children are continually assessed, we attach a great deal of importance to teacher assessment and identifying the next steps in their learning.
- Maths groups
- Spelling groups

Homework Expectations

- Standards of presentation
- Usually 20-30 minutes
- Children are responsible for seeking guidance in advance of the hand in date
- Homework to be completed at lunchtime if not handed in on time
- Reading records will be checked in school on a Friday to enable us to monitor reading regularity

Homework

- If research has been set as a homework then that research will not be marked. It will be incorporated into a larger piece of work which will then be marked.

Homework

<p>Maths English/Topic</p>	<p>Available on the class page: Thursday</p>	<p>Due in: Tuesday</p>
--------------------------------	--	----------------------------

Reading

- Each book read needs to be written in the reading record and recorded on the list in the classroom by the children.
- Every child should be encouraged to read daily.
- Please listen to your child read/discuss their book with them at home at least three times per week to check their understanding of the text.
- A comment should be written in their reading record each time, to show that the book has been read or discussed with an adult at home.
- If your child is a free reader then they should still be reading to an adult at home on a regular basis
- A wide range of fiction and non-fiction texts should be read.

Volunteering in Year 5

- Up to date DBS
- Listening to individual readers at 8:50 until 9:20 on a Tuesday, Wednesday or Friday
- Trips - Enrichment days
- We would welcome visitors who can share their expertise in any of our curriculum areas

Any other information

PSHE - Health Education

- Puberty in the Summer term

E-Safety

Educational Residential Trip - Kingswood, Cromer

- Week commencing **Monday 1st October**
- Monday to Wednesday

Enterprise Sale dates:

- Friday 9th November at 3:15 in the KS2 Hall
- Friday 1st March

International Space Centre, Leicester

- Thursday 7th November
- 8:00 am until 5:00 pm

British Museum, London - Anglo Saxon and Ancient Egyptian

- Date tbc - Possibly early January



Kingswood
Inspiring Learning



Teaching Staff

Lead - Mrs Moore

- Mrs Whitley
- Miss Lore
- Mr Mateus
- Mrs Law
- Mrs Middleton

Things to remember

- Calpol permission slip available today
- Medication – Original packaging and clearly labelled handed into Mrs Whitley on the day
- Little things that may be useful to know
- Bags – Children should pack them themselves and be able to carry them up and down stairs

Monday morning

- Meet in KS1 Hall at 8:30
- Coach due to depart at 9:00
- Comfort break at Barton Mills – Toilet, drink and a snack
- Due to arrive at 12:30
- Packed lunch needed
- Travel sickness tablets to be taken at home
- Comfortable backpack - full water bottle, waterproof jacket etc
- Suitable clothing for activities

Wednesday afternoon

- Due back around 4:30, depending on traffic, we will inform the school if there are any significant changes

Step 1

Turn the duvet cover inside out and attach the ties to the comforter.

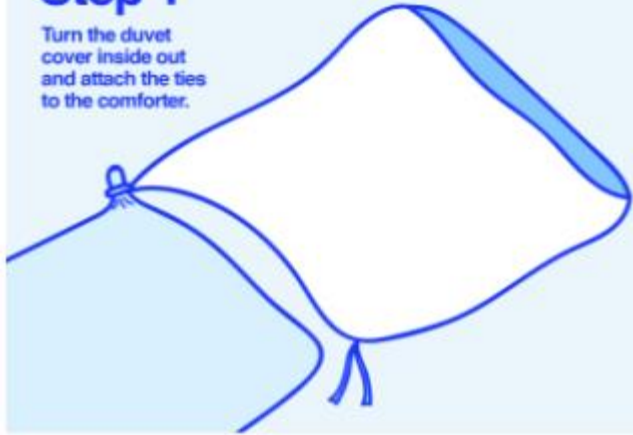

Step 2

Reach inside the duvet cover and grab the comforter corners.



Step 3

While holding the corners, lift the comforter and shake it. This will let the cover fall down over the comforter.



Step 4

Close the cover's opening and enjoy.



Thank you for coming...



...We thank you in advance for your support and look forward to an enjoyable year working in partnership with you.