



Features		
ENGINE		
No. of Cylinders / Capacity (cc) / Emissions Level	3 / 1642 / StageV	
Rated Engine Power (kw/HP)	23.8 /32	
Rated Engine Speed	2600	
Max. Torque (Nm)	109.4 @1690	
Aspiration	Natural Aspirated	
Air Cleaner	Dry Air Cleaner	
Exhaust	Underhood	
Fuel Tank Capacity (L)	38	
TRANSMISSION		
Drive	4WD	
Gear Box	Synchromesh Transmission	
No. of Speeds	8F+8R	
SPEEDS (FORWARDS)		
Minimum Speed (km/hr.)	1.59 (with Agri Tyres)	
Maximum Speed (km/hr.)	18.03 (with Agri Tyres)	
FRONT AXLE		
4WD Front Axle	Portal Type Axle	
Differential Lock	Mechanical, Foot Operated	
Brake Actuation	Pedal Operated (Mechanical)	
Parking Brake	Independent Parking Brake	
PTO		
PTO RPM	540 @2360	
PTO Actuation	Mechanical Lever Operated	
STEERING		
Steering	Power Steering	
ELECTRICAL		
Battery	85A	
Alternator	40A	

Features		
HYDRAULICS		
3 Point Linkage	CAT 1	
Auxiliary Hydraulic Circuit	1DA	
Stay Bars	Check Chain Adjustable Type	
Lifting Capacity (kg)	1000	
LPM (Litre Per Minute)	For Steering Flow 17 lpm For Hydraulics Flow 28 lpm	
TYRE		
Front	7.00-16	
Rear	11.2-24	
WEIGHT & DIMENSIONS (mm)		
Weight (kg)	1270	
Wheelbase (mm)	1650	
Overall Length (mm)	3100 (without Front Weight)	
Overall Width (mm)	1360	
Height (mm) up to ROPS	2500	
Min. Ground Clearance (mm)	340 mm with 11.2 x24 Tyre	
Front Track (mm)	1071 mm ± 15 (Tyre 7.00-16)	
Rear Track (mm)	1080 mm ± 15 (Tyre 11.2-24)	
Turning Radius (m)	2.5m (with Brakes)	
OTHERS		
Trailer Hitch - Option 1	Clevis Hitch	
Option 2	Swinging Draw Bar	
Front Toe Hook	Yes	
OPTIONAL TYRES		
INDUSTRIAL	Front: 27x10.5-15	
	Rear: 15-19.5	
TURF	Front: 25x8.50-14	
	Rear: 13.6x16	

*Data and specifications are subject to change without any advance notice due to continuous product improvement and development. All Dimensions are with standard tyres.



MECHANICAL TRACTORS



SMART TECHNOLOGY FOR BETTER COMFORT AND EFFICIENCY



INTERNATIONAL TRACTORS LIMITED

International Business Office: Teri School of Advanced Studies, Plot No.10, Institutional Area, Vasant Kunj, New Delhi-110070 (India) **Phone:** +91 11 66 45 5200

Work: Jalandhar Road, Hoshiarpur - 146022, Punjab (India) | **Phone:** +91-01882-522220/ 522221 | **Fax:** +91- 01882-522222 | **Email:** info@solisworld.com | **URL:** www.solistractors.com

Follow us on:

 www.facebook.com/SolisTractors/  www.twitter.com/SolisTractor  www.linkedin.com/company/solis-tractors-international  www.instagram.com/solis_tractors  www.youtube.com/c/SolisTractors

www.solistractors.com



S-TECH TURBO ENGINE

Experience robust and reliable performance with the Solis S40, engineered to handle all farming tasks efficiently while maximizing fuel efficiency and smooth operations.

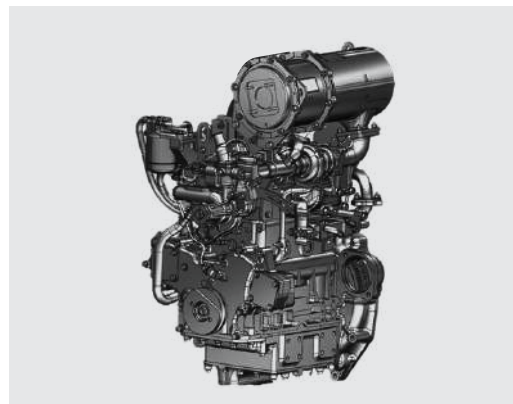

HIGH-END TORQUE OF 109.4 NM

With a high-end torque of 109.4 Nm, the S40 provides strong pulling power and effortless acceleration. This ensures even heavy-duty tasks are handled with ease and precision.



3-CYLINDER STAGE V YANMAR TURBO ENGINE

Solis S40 is powered by a robust 3-cylinder Stage V Yanmar turbo engine, designed for consistent and reliable performance. It ensures smooth operation across all farming tasks while delivering the efficiency modern agriculture demands.

FLAT TORQUE CURVE

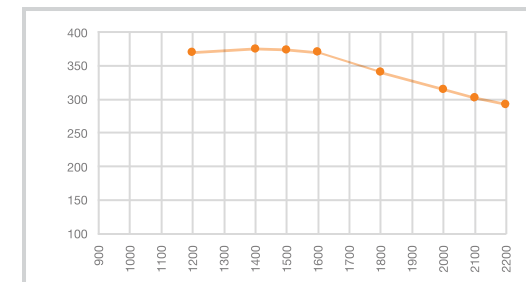

BIGGER AIR CLEANER

Featuring a bigger air cleaner, the S40 keeps the engine protected from dust and debris. This enhances durability and maintains peak performance even in tough field conditions.



BEST-IN-CLASS OPERATIONAL TORQUE

Its best-in-class operational torque delivers unmatched control and efficiency during intensive farming operations. Operators can rely on consistent power for plowing, hauling, and other demanding tasks.



WIDE OPTIONAL RANGE

The S40 offers a wide range of optional features to meet diverse farming needs, allowing farmers to customize their tractors for optimal productivity and versatility.





TRANSMISSION

S40's advanced transmission system offers smooth gear shifts and excellent traction, providing control and reliability for even the most challenging farming conditions.

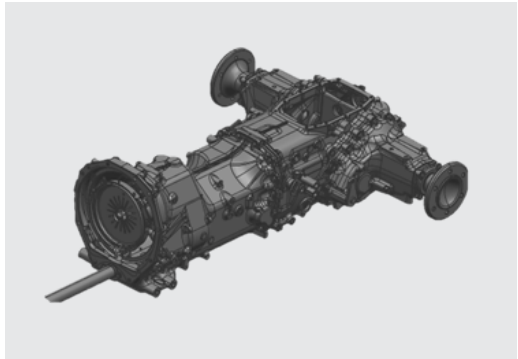

8 FORWARD + 8 REVERSE SYNCHROMESH TRANSMISSION

Solis S40 is equipped with an 8F+8R synchromesh transmission, offering smooth and precise gear shifts for effortless operation. This feature ensures superior control and adaptability, making it easier to tackle a wide range of farming tasks with confidence.

SIDE SHIFT TRANSMISSION

With the side-shift transmission, the S40 enables quick and flexible maneuvering, allowing operators to adjust speed and direction seamlessly. This enhances efficiency and precision when working with implements or navigating challenging fields.



NEWLY OPTIMIZED SPEED RANGE

The newly optimized speed range delivers the ideal balance of power and speed for every operation. Whether performing heavy-duty work or transporting loads, it ensures maximum productivity, fuel efficiency, and consistent performance in all conditions.





HYDRAULICS

Designed for versatility, the Solis S40 delivers effortless handling and superior stability across all terrains, making every implement operation easier and more productive.



HEAVY-DUTY PORTAL 4WD AXLE

Featuring a heavy-duty portal 4WD axle, the S40 provides superior traction and stability across all terrains. It ensures you stay in control, even on rough or challenging fields.



BALANCED STEERING

Equipped with balanced steering, the S40 offers responsive and smooth maneuverability. Operators can navigate tight spaces and challenging terrain with ease and precision.

BEST-IN-CLASS HYDRAULIC LIFTING CAPACITY

Solis S40's best-in-class hydraulic delivers unmatched lifting power, handling up to 1000 kg with ease. This makes loader operations and heavy-duty tasks smoother, faster, and more efficient.



BEST-IN-CLASS GROUND CLEARANCE

With best-in-class ground clearance, S40 easily navigates uneven or obstructed terrain. This feature keeps your work uninterrupted and prevents obstacles from slowing you down.



1DA AUXILIARY HYDRAULIC CIRCUIT

The 1DA auxiliary hydraulic circuit allows seamless operation of multiple implements. It enhances versatility and ensures precise control for a wide range of farming tasks.



CAT-I THREE-POINT LINKAGE

The CAT-I three-point linkage enables quick, secure, and reliable attachment of implements. This feature simplifies operations and boosts productivity across various farming applications.



LOW MAINTENANCE

Designed for durability, the S40 is a low-maintenance machine that reduces downtime and operational costs while maintaining high productivity throughout the farming season.

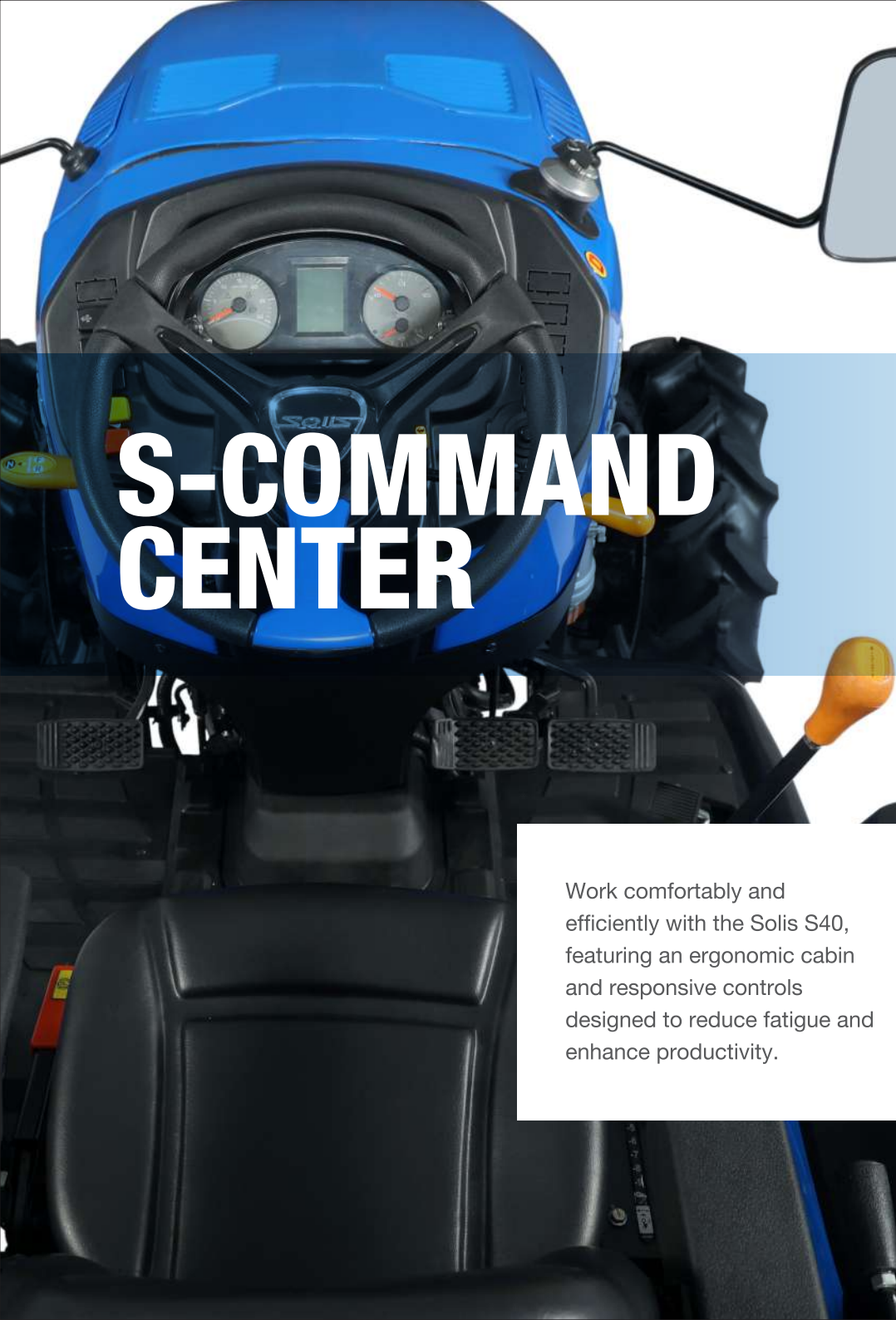

S-COMMAND CENTER

Work comfortably and efficiently with the Solis S40, featuring an ergonomic cabin and responsive controls designed to reduce fatigue and enhance productivity.



COMFORTABLE SEAT

With a comfortable, ergonomically designed seat, the S40 offers excellent support for the operator. This feature enhances comfort during extended work periods, reduces fatigue, and allows for focused, productive operations.



POWER STEERING

Solis S40 features power steering, ensuring smooth and effortless maneuverability. Operators can handle tight corners, navigate challenging terrains, and operate implements with precision, thereby reducing strain and improving overall efficiency during extended periods in the field.



WIDER PLATFORM

The wider platform of the S40 provides ample space and stability for the operator, ensuring a secure and balanced stance while working. It improves comfort, control, and safety, making every task easier and more efficient.





Achieve consistent and efficient power delivery with the S40's PTO, ensuring smooth operation of a wide range of implements while boosting productivity and minimizing wear.



BEST-IN-CLASS PTO POWER

Solis S40 comes with best-in-class PTO power, delivering consistent and reliable energy to drive a wide range of implements. This ensures the smooth and efficient operation of mowers, tillers, harvesters, and other equipment, helping you complete tasks more quickly. With optimized power transfer and precision control, the PTO enhances productivity while reducing fuel consumption and wear, making every farming operation more efficient and dependable.



ALL-ROUND VERSATILITY IN ONE TRACTOR



Key Attachments: Ploughs, seed drills/planters, mowers, trailers, a loader for feed/manure

Value Proposition:

The S40 is designed as a multi-tasker, featuring one machine that can perform ploughing, seeding, mowing, hauling, and loader work. It delivers the right balance of power and torque for common implements while keeping the purchase price, fuel use, and running costs lower than those of larger tractors. Perfectly sized for family farms that need efficiency without overspending.



Key Attachments: Flail mowers, sprayers, orchard flails, narrow tiller, inter-row mowers, loader for material handling

Value Proposition:

With its compact size, agility, ground clearance, and optimized PTO speeds, the S40 excels in orchards and vineyards. It can navigate tight rows, protect roots with its manageable weight, and handle light loader duties with ease, making it an ideal fit for high-value crop operations.



Key Attachments: Mowers, loader bucket, snow plough, trailers, brush cutter, post hole digger

Value Proposition:

For hobby farmers and estate owners, the S40 brings versatility and simplicity in one dependable package. Whether mowing, snow clearing, or handling property maintenance, it is easy to operate, reliable, and cost-efficient, meeting the needs of users who value functionality over luxury.



Key Attachments: Snow removal units, road brush, verge mowers, leaf collectors, loader for municipal supplies

Value Proposition:

The S40 is built for year-round municipal tasks. From winter snow clearing to summer roadside mowing, it adapts seamlessly with multiple attachments. Its lower fuel and maintenance costs make it a budget-friendly workhorse for municipalities and contractors needing reliable performance across all seasons.



Key Attachments: Hay mowing/harvesting units, bale handlers, manure spreaders, feed transport trailers, and loaders for silage and handling

Value Proposition:

With strong PTO power, loader compatibility, and attachment versatility, the S40 is well-suited for livestock farms. It efficiently manages hay work, bale movement, feed handling, and manure spreading, delivering dependable throughput without the need to upgrade to a larger tractor.



**BUILT
TO MEET
EVERY
NEED**

