

WB6/8

WALL BRACKET FOR ADORN A80T, BLACKLINE X8, CDD6, CDD8, CDD-LIVE8, FP6 AND FP8

Features

- Wall bracket, supplied with Adorn A80T and available as an optional accessory for Blackline X8, CDD6, CDD8, CDD-LIVE8, FlexPoint FP6 and FP8
- Allows tilt and pan
- Weatherised for outdoor installation
- Available in black (WB6/8B), white (WB6/8W) or custom RAL colours
- Wall spacers are available as an optional accessory for the latest version of this bracket (see next page)

Applications

- Fixed installation

Contents

- 1 x WB6/8
- 4 x countersunk socket screws (M6 x 20 mm)

Technical Specifications

WEIGHT	0.64 kg (1.41 pounds)
MATERIAL	Weatherised polyester powder coated steel

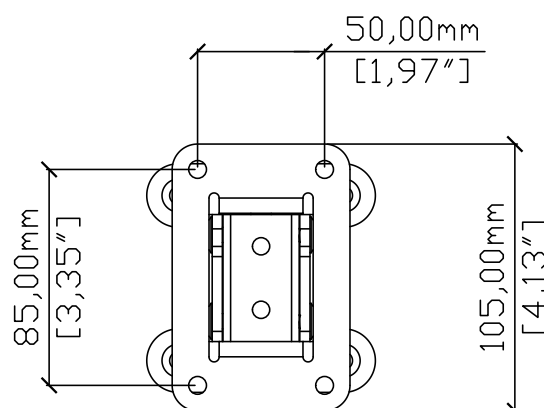
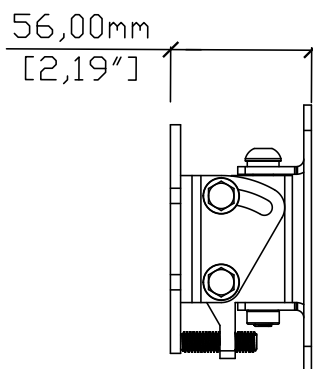
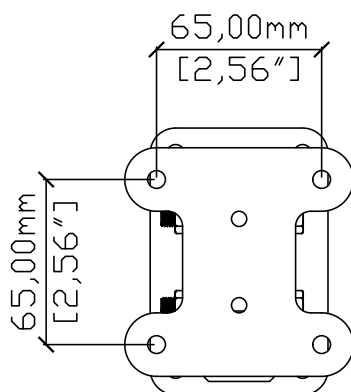
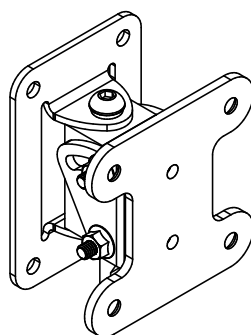
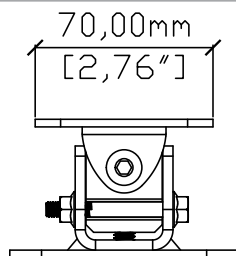

WB6/8

WALL BRACKET FOR ADORN A80T, BLACKLINE X8, CDD6, CDD8, CDD-LIVE8, FP6 AND FP8

Wall spacer accessory kit

- Optional accessory kit containing a pair of spacers
- Allows you to increase the horizontal angle of the speaker
- Fit one or two spacers behind each bracket, as required
- Available in black (SP6/8-B) or white (SP6/8-W)
- Compatible with the latest version of this wall bracket only. This version has four notches in the outer edge of the wall section (see picture below). Each spacer has four lugs on the front that fit into the notches in the bracket and four notches on the back that fit to the lugs on the second spacer
- Not compatible with the previous version of this wall bracket, which does not have notches (see pictures on the previous page)

