



# LET'S GET FACTUAL.



## CROWNE PLAZA LONDON - THE CITY

Set in the centre of London and a stone's throw from the River Thames, this impressive Grade II listed building offers a truly exemplary events space, superlative ambiance and high-tech facilities while steeped in regal history. The four star deluxe hotel resides on the former grounds of King Henry VIII's Bridewell Palace with 204 elegantly appointed bedrooms.

### ADDRESS

Crowne Plaza London - The City is located in London's historic Square Mile, opposite Blackfriars station. With access to the Circle and District lines on the underground and direct rail links to London Gatwick Airport and St Pancras International, home to the Eurostar. The hotel is within 60 minutes reach of London's three major international airports: London Heathrow, London City and London Gatwick.

### MEETINGS & EVENTS

- The Bridewell Suite accommodates business and social functions of up to 200 guests in 190 m<sup>2</sup> and can be divided into two sections
- Three boardrooms offer an additional 59 m<sup>2</sup> for more private affairs
- The 236 m<sup>2</sup> Conference Floor offers a spacious location for receptions or additional gathering space
- All conference venues are complemented by a spectrum of audio and visual services
- Custom designed theme events and catered social affairs
- Unobtrusive and professional catering and banquet staff
- Elegant culinary experiences tailored for group needs
- Business centre with computers and printing services

## DINING & ENTERTAINMENT

- Chinese Cricket Club Restaurant serves Sichuan cuisine and hand-crafted dim sum, whilst celebrating Chinese festivals
- Diciannove Italian Restaurant offers pasta made daily in-house and a series of authentic regional gourmet specialities
- Voltaire Cocktail Bar features a chic lounge complete with booths and private historic vaults located on a cigar terrace.
- The City Lounge is a buzzing spot for morning coffee to a relaxing affair for dinner and cocktails by the fire place
- The Club Lounge is accessible by Club and Suite guests only, including breakfast, refreshments and alcoholic beverages
- Private Dining can be enjoyed in several restaurants or bars in the hotel for up to 100 seated guests or 200 guests for a reception.
- Interactive Master Classes are ideal for team building from cocktails, to dim sum or pasta making with our expert team.

## GUEST SERVICES & FACILITIES

- Fitness centre with sauna, open 24-hours
- Run Station with route maps, towels, water and fresh fruit
- Complimentary Wi-Fi throughout the hotel
- Complimentary smart phone with free calls and 3G data
- Concierge, available 24 hours
- Business Services
- 24-hour room service
- Valet service
- Turndown service available upon request
- Complimentary daily newspaper
- Transportation by luxury car with driver
- IHG Rewards Club - Earn free nights worldwide
- IHG Business Advantage - Tame expenses online

## CONFERENCE FLOOR PLAN

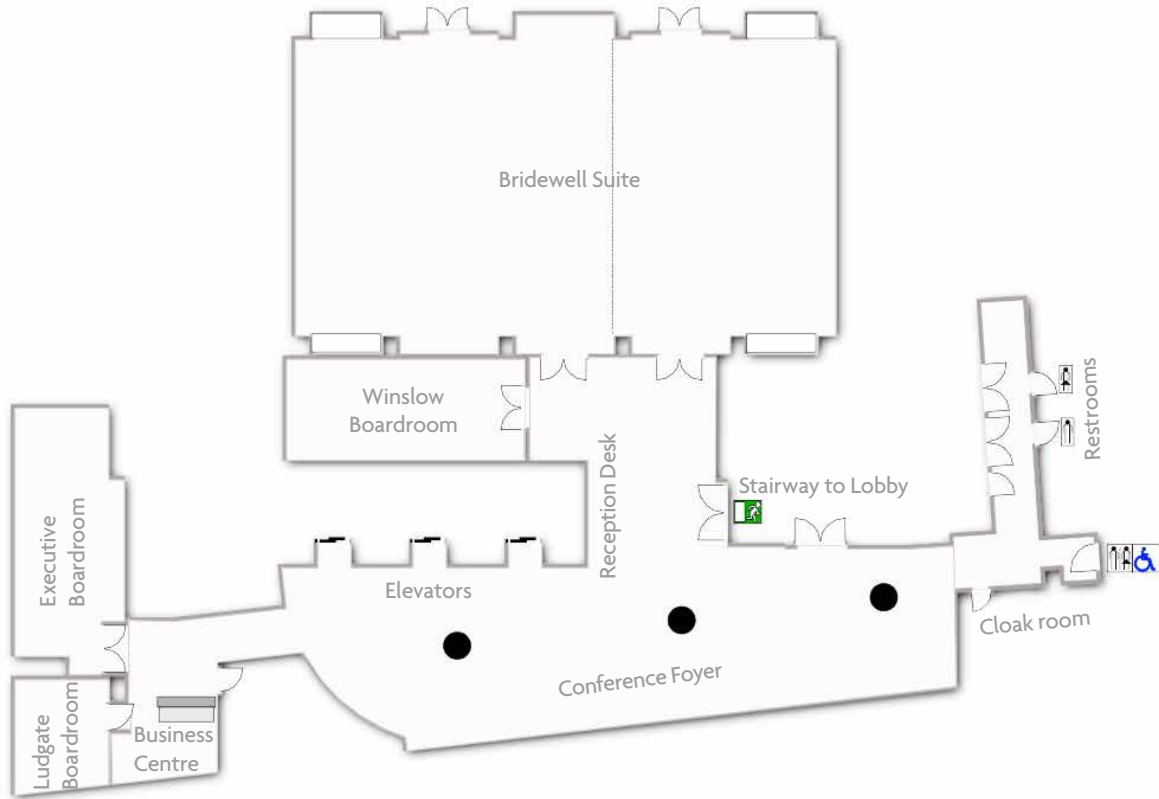

## ROOM CAPACITIES

Name	Area (sqm)	Size (L x W)								
			Theatre	Banquet	Cabaret	Classroom	Boardroom	Hollow	U-shape	Reception
<b>Bridewell Suite</b>	185	10 x 18.5	180	144	120	90	50	50	40	200
<b>Bridewell 1</b>	125	9.96 x 10.92	90	50	50	50	28	35	30	100
<b>Bridewell 2</b>	60	9.96 x 7.08	70	30	35	25	24	30	25	80
<b>Executive</b>	30	8 x 3	-	-	-	-	18	-	-	-
<b>Winslow</b>	27	7.75 x 3.5	-	-	-	-	18	-	-	-
<b>Ludgate</b>	2.75	2.5 x 3	-	-	-	-	6	-	-	-



**CROWNE PLAZA**  
LONDON - THE CITY

19 New Bridge Street, London, EC4V 6DB, United Kingdom

+44 (0)20 7438 8000 | [loncy.conference@ihg.com](mailto:loncy.conference@ihg.com)

[crowneplaza.com/londonthecity](http://crowneplaza.com/londonthecity)

CrownePlazaLondonCity
 CPLondonCity
 CrownePlazaLondonCity  
 Crowne Plaza London - The City