

# GLENEAGLES

*Meetings & Celebrations*

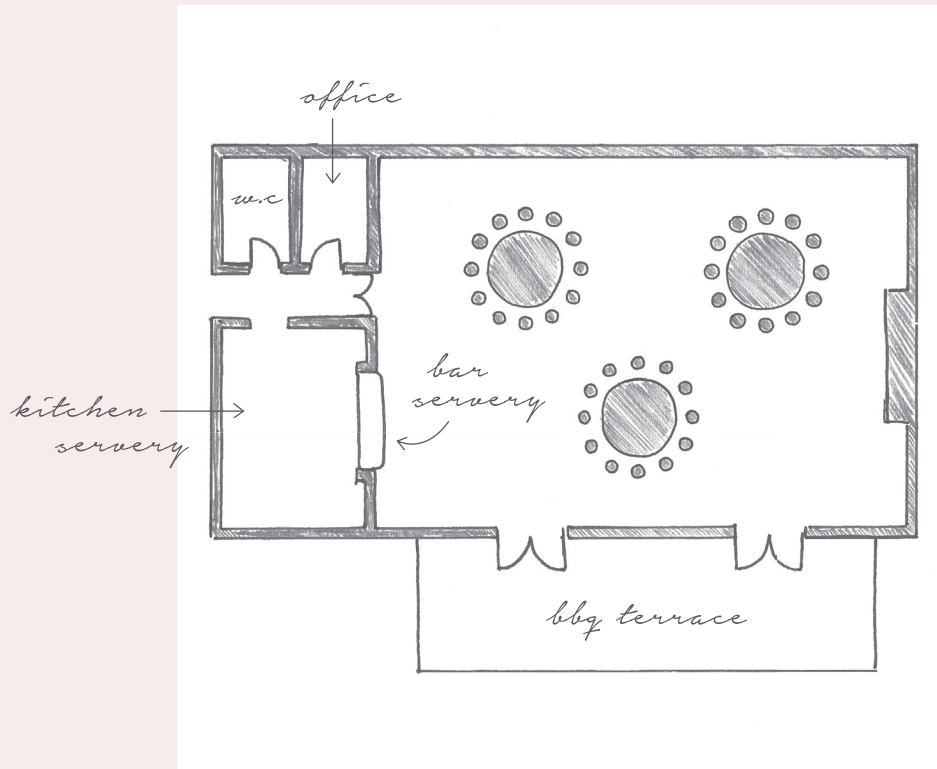

## THE SHOOTING LODGE



98.04m<sup>2</sup> | w: 8.60m | l: 11.40m

1055.29 ft<sup>2</sup> | w: 28.21f | l: 37.40f

### *The Shooting Lodge Set Up & Capacity*

Set Up	Cocktails	Buffet BBQ	Dining
			
Capacity	60	200	30