

THE FARMERS SUITE

CUMBER ROOM & HUDSON ROOM

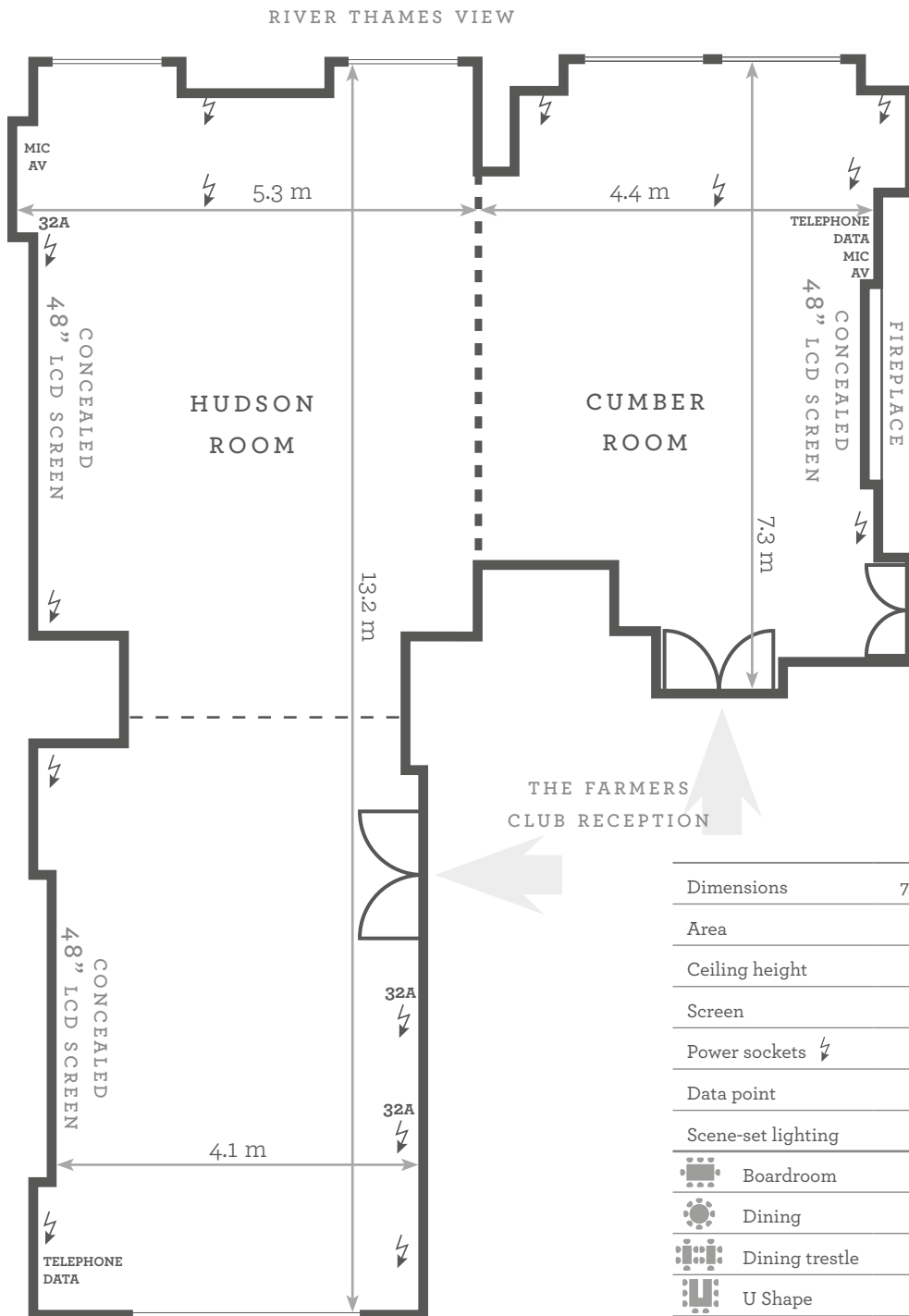

The Farmers Suite is a bright, airy room with natural daylight and stunning views of Embankment Gardens and The River Thames. This versatile room, close to Reception can be divided into two rooms if required; The Cumber and The Hudson. It features hi specification, flexible, integrated audio visual, scene-set lighting and sound capability and is ideal for lunches, dinners or meetings.

THE FARMERS CLUB RECEPTION

	CUMBER ROOM	HUDSON ROOM	THE FARMERS SUITE
Dimensions	7.3 x 4.4 m	13.8 x 5.3 m	13.8 x 10.0 m
Area	32.12 m ²	62.88 m ²	95 m ²
Ceiling height	3.3 m	3.3 m	3.3 m
Screen	48"	48"	48"
Power sockets ⚡	Yes	Yes	Yes
Data point	Yes	Yes	Yes
Scene-set lighting	Yes	Yes	Yes
Boardroom	16	26	42
Dining	16	32	56
Dining trestle	N/A	50	75
U Shape	12	14	18
Classroom	N/A	18	45
Theatre	20	40	50
Cabaret	N/A	24	36
Reception	30	80	110

Please speak to a member of the team regarding capacities as these may vary depending on the individual requirements.