



# CATHEDRAL

IN THE HANGING GARDEN

# CATHEDRAL

The 18-metre tall structure on the lower tier with a new summer garden fit-out that can be accessed via Liverpool Street or the Garden. This space can be hired for private events on any day of the week.

## GROUP BOOKINGS

We operate as a predominantly walk-in venue but group bookings can be made on the Cathedral lawn for a minimum of 10 guests.

## PRIVATE AREA HIRE

We offer an area on the Cathedral lawn for your guests with access to a private bar. Please get in touch with us to discuss your capacity requirements.

## PRIVATE VENUE HIRE

The Cathedral can be booked out for cocktail style, theatre style and banquet style private events. Please get in touch with us to discuss your capacity requirements.

## FOOD

Food can be ordered from our kitchens in the Garden, or pre-ordered food can be arranged. Guests can bring their own food, but some restrictions apply.

## ACCESSIBILITY

The Cathedral is fully accessible with an accessible toilet.

## BOOKINGS

Please email our events team at [events@inthehanginggarden.com.au](mailto:events@inthehanginggarden.com.au), and we will be in touch to discuss your request.

# PRECINCT MAP

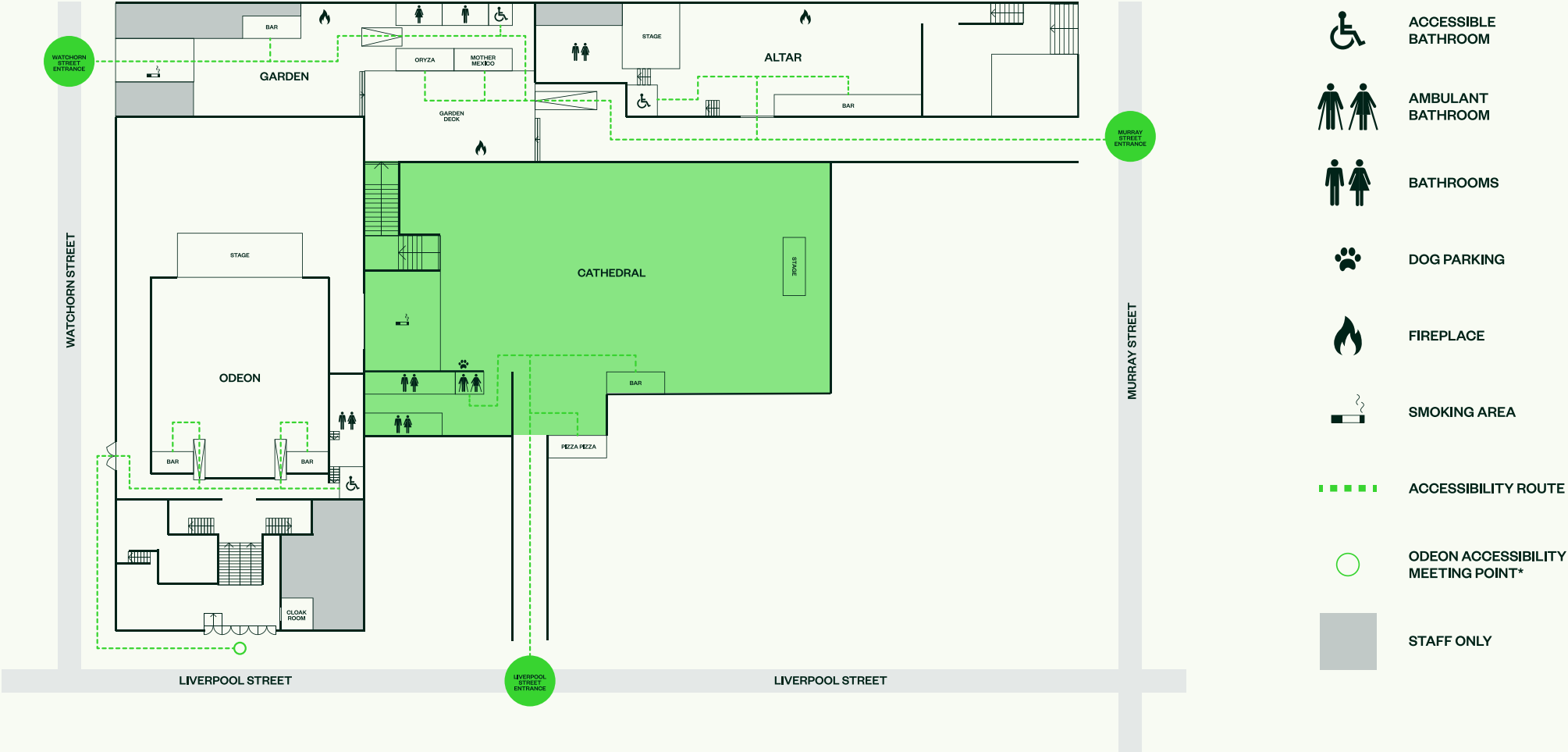



The Cathedral boasts a large, outdoor space, protected from the elements.



The Cathedral, by day is a sun-filled venue for all ages.



The Cathedral is a verdant sanctuary, suitable for any weather.



The Cathedral comes alive at night with live DJs Friday + Saturday.