



# THE LODGE HOTEL



## MEETING AND EVENT SPACES

THE LODGE HOTEL 52-54 UPPER RICHMOND ROAD, PUTNEY, LONDON SW15 2RN

call: 020 8874 1598 • e-mail: [events@thelodgehotellondon.com](mailto:events@thelodgehotellondon.com) • [www.thelodgehotellondon.com](http://www.thelodgehotellondon.com)



THE LODGE HOTEL

## KH SUITE

A stunning, versatile meeting and events space in the heart of South London.  
This self-contained, air conditioned area offers an abundance of natural daylight with direct access to a private terrace and views over landscaped gardens.



The KH suite is more akin to an art gallery than a hotel conference room.

A 1450 sq. ft. blank canvas, with flexible room dividers, immaculate furnishings and its own private terrace.

We can host events up to 200 people, theatre style conferences up to 120, and weddings & banquets up to 80 people.

call: 020 8874 1598 • e-mail: [events@thelodgehotellondon.com](mailto:events@thelodgehotellondon.com) • [www.thelodgehotellondon.com](http://www.thelodgehotellondon.com)



# THE LODGE HOTEL

## KH SUITE

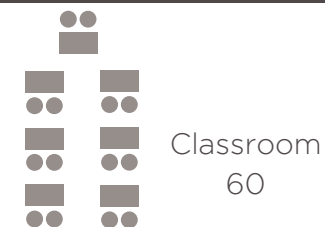
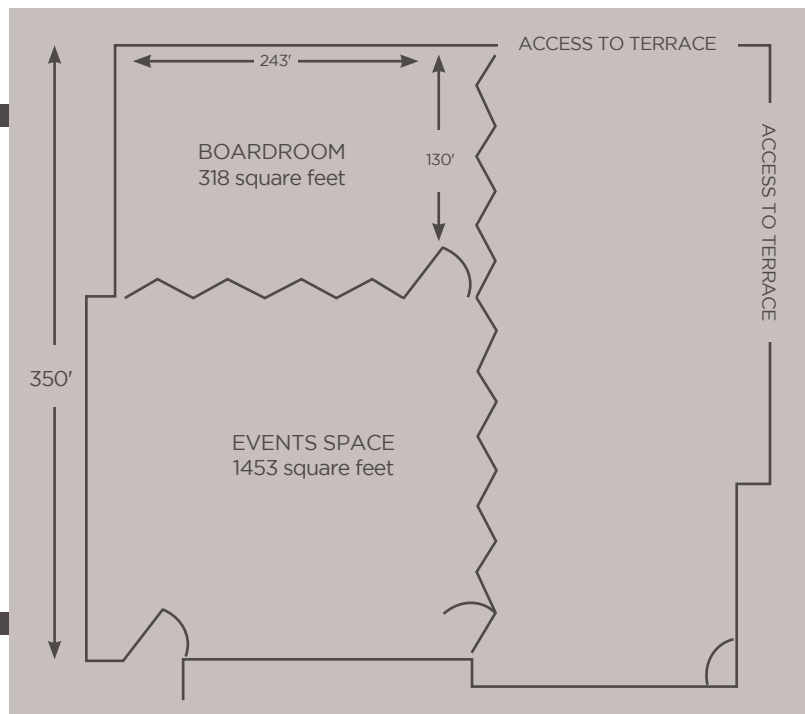

The flexible space offers multiple seating layout options and the ability to divide the boardroom from the rest of the space.

You will also benefit from:

- Private car park with access directly to conference suite
  - Fibre optic WiFi throughout
  - Soundproof dividable space
  - Adaptable lighting and power



THE LODGE HOTEL

## THE LIBRARY

An intimate and stylish room featuring over 850 vintage leather bound books, an original Victorian fresco ceiling, crystal chandeliers, and tartan armchairs.

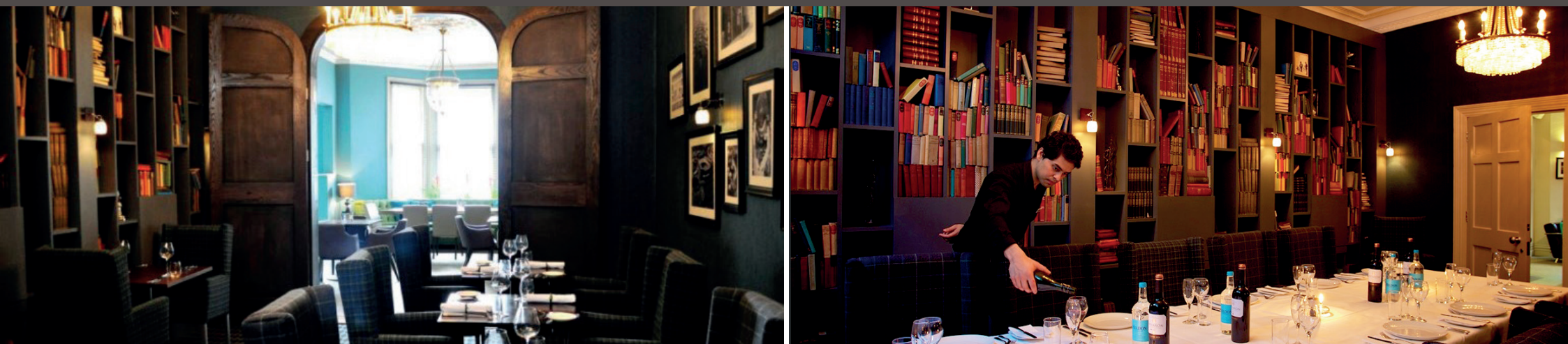

The Library is a flexible space, ideal for boardroom style meetings (seating up to 15 delegates).  
It is also ideal for private dining, receptions and networking events.  
Perfect for up to 20 people seated, 35 standing reception.



THE LODGE HOTEL

## THE RAMSEY AND WIMBLEDON SUITES

Two bright and airy rooms, perfect for smaller groups.



The Ramsey is a private boardroom with 3m ceilings.  
It can also be used as a private viewing room/cinema for up to 14 people seated.

The Wimbledon Suite can seat up to 10 people (boardroom style)

Please contact the events team to discuss hourly rates for both The Ramsey and Wimbledon Suites.

call: 020 8874 1598 • e-mail: [events@thelodgehotellondon.com](mailto:events@thelodgehotellondon.com) • [www.thelodgehotellondon.com](http://www.thelodgehotellondon.com)



## THE LODGE HOTEL

### DAY PACKAGES

We offer a range of conference packages which include catering, for a set Delegate Day Rate, from a sandwich lunch to a full hot buffet.



**Sandwich Package** from £45 per person

Lunch: Sandwiches, crisps and salads  
Two servings of tea and coffee and jugs of water throughout the day

**Finger Food Buffet** from £55 per person

Finger food buffet lunch including crisps and salads  
Two servings of tea and coffee and jugs of water throughout the day

**Hot Fork Buffet** from £65 per person

Finger food buffet lunch including crisps and salads  
Two servings of tea and coffee and jugs of water throughout the day

All packages include hire of the space, a projector and screen\*, Wi-Fi, a flip chart and pencils and paper for your delegates.  
A laptop is available to hire at an additional rate of £100 per day\*  
Flipchart hire: £20 per day • Screen & projector: £50 per day

Fruit juices and extra servings of tea and coffee can be added to your package at a rate of £1 per person for fruit juice (or £5 per jug) and £2.50 per person for tea and coffee.

\*Please note, VGA and HDMI cables are provided with our equipment, should you require different cables please let us know in advance. Prices will vary for additional items



# THE LODGE HOTEL

## DAY RATES & COSTS

Please call us on 020 8874 1598 to discuss your specific requirements.

**KH SUITE**      **SPACE HIRE ONLY**  
9.00am – 5.30pm . . . . . £600 per day  
7.00pm – 12.00am . . . . . £400 per evening

**LIBRARY**      **SPACE HIRE ONLY**  
9.00am – 5.30pm . . . . . £400 per day\*  
7.00pm – 12.00am . . . . . £200 per evening

**THE RAMSEY**      **SPACE HIRE ONLY**  
9.00am - 5.30pm . . . . . £400 per day\*

**THE WIMBLEDON** **SPACE HIRE ONLY**  
9.00am - 5.30pm . . . . . £350 per day\*

**DAY PACKAGES** Sandwich Package . . . . . £45 per person  
Finger Food Lunch . . . . . £55 per person  
Hot Fork Buffet . . . . . £65 per person

**Additional Food & Drink**  
Additional Tea/Coffee . . . £2.50 per person  
Fruit Juices . . . . . £1.00 pp/£5 per jug  
Handmade Cookies . . . . . £1.50 per person  
Flapjacks . . . . . £1.50 per person  
Muffins . . . . . £1.50 per person

**CATERING**      Dinners 20-49 people . . . . . From £54 per person  
Dinners 50 – 90 people . . . . . From £44 per person

Summer BBQ  
(min. 50 people) . . . . . From £25 per person

Private Canapé Receptions  
(min. 50 people) . . . . . From £20 per person

**Additional Food & Drink**  
Bottle of House Wine . . . . . £18.00  
House Spirits . . . . . £6.00/£10.00  
Tea/Coffee . . . . . £2.50 per person  
Fruit Juices . . . . . £1.00pp/£5 per jug

**Bedroom Rates**  
Standard Double . . . . . £130.00  
Executive Double . . . . . £145.00  
Superior Garden . . . . . £150.00

\* Please contact the events team for half day and hourly room rates



# THE LODGE HOTEL



Situated in Putney, moments from the River Thames and the tube and a short walk from Putney's most popular bars, cafés and restaurants, The Lodge Hotel in London provides an ideal base in South West London for business and pleasure. Perfectly located for sightseeing, shopping and socialising in London.

THE LODGE HOTEL 52-54 UPPER RICHMOND ROAD, PUTNEY, LONDON SW15 2RN

call: 020 8874 1598 • e-mail: [events@thelodgehotellondon.com](mailto:events@thelodgehotellondon.com) • [www.thelodgehotellondon.com](http://www.thelodgehotellondon.com)