

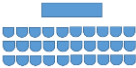



Room Layouts

Room Layout	Theatre	Banquet (single tables)	Banquet (double tables)	Cabaret (chairs on 3 sides of the table)	Classroom (chairs on 1 side of the table)
					
Auditorium 29 x 27m	580	352	170	160	96

Room Layout	Theatre	Banquet	Cabaret (chairs on 3 sides of the table)	Classroom (chairs on 1 side of the table)	Boardroom	U shape (chairs only)	U shape (with tables)
							
Shaftesbury 16 x 11.5m	175	160	100	72	60	50	37
Wilberforce 12 x 11.7m	110	65	50	55	30	40	33
Fry 9.3 x 8.8m	60	32	40	30	20	31	21
More 11.6 x 6m	35-40	24	25-30	25-30	22	14	21
Nightingale 8.9 x 6.4m	30-35	32	25-30	20-25	22	25	21
Seacole 9.4 x 4.6m	30-35	24	20	20-25	22	25	21
Gordon 10.6 x 4.6m	30-35	24	20	20-25	22	20	15
Booth 11.6 x 6m	30	24	30	20	22	25	21
Cadbury 7.7 x 5.9m	30	24	30	15-20	22	20	15
Cavell 4.08 X 2.97m	8	n/a	n/a	5	4 - 8	n/a	n/a

Room Facilities

	Stage	Sound system	Lighting system	Projector		Projector Display		Lift access	Natural light	Air - Con	Hard Floor	Carpeted Floor	OTHER DETAILS	Room Size
				portable (2 available)	Ceiling	Screen	White Wall							
Auditorium	13 x 5 m	1000w	✓		✓	✓	✓	Ground floor				✓	Large roller doors to one side of the stage	29m x 27m (narrows down to 25.6) (by kitchen, 13.5m from stage to back wall)
Shaftesbury	Small, low (12cm) portable stage available for hire	✓	Coloured lighting (wall wash)		✓		✓	Ground floor	✓	✓	✓		Paved patio	16m x 11.5m
Wilberforce		Portable system available for hire			✓		✓	✓	✓	✓	✓	Balcony and stairs to paved patio	11.7m x 12m	
Fry					✓		✓	✓	✓		9.4m x 8.6m			
More				✓			✓	✓		✓	Sofas	11.6m x 6m		
Nightingale				✓		✓	✓		✓	8.9m x 6.5m narrows to 6m (L shaped room)				
Seacole				✓		✓	✓		✓	9.4m x 4.6m				
Gordon				✓		✓	✓		✓	10.6 x 4.6m				
Booth			✓			✓	✓		✓	Sofas	11.9m x 5.4m			
Cadbury				✓		✓	Ground floor	✓		✓	7.7 x 5.9m			
Cavell			✓			✓	Ground floor	✓		✓	4m x 3m			
Down								Ground Floor	✓		✓	✓		4.7 x 13.7 m
Lobby to Wilberforce / Fry / More								✓	✓			✓		3.5 x 11.87 m

Floor Plan - Ground Floor

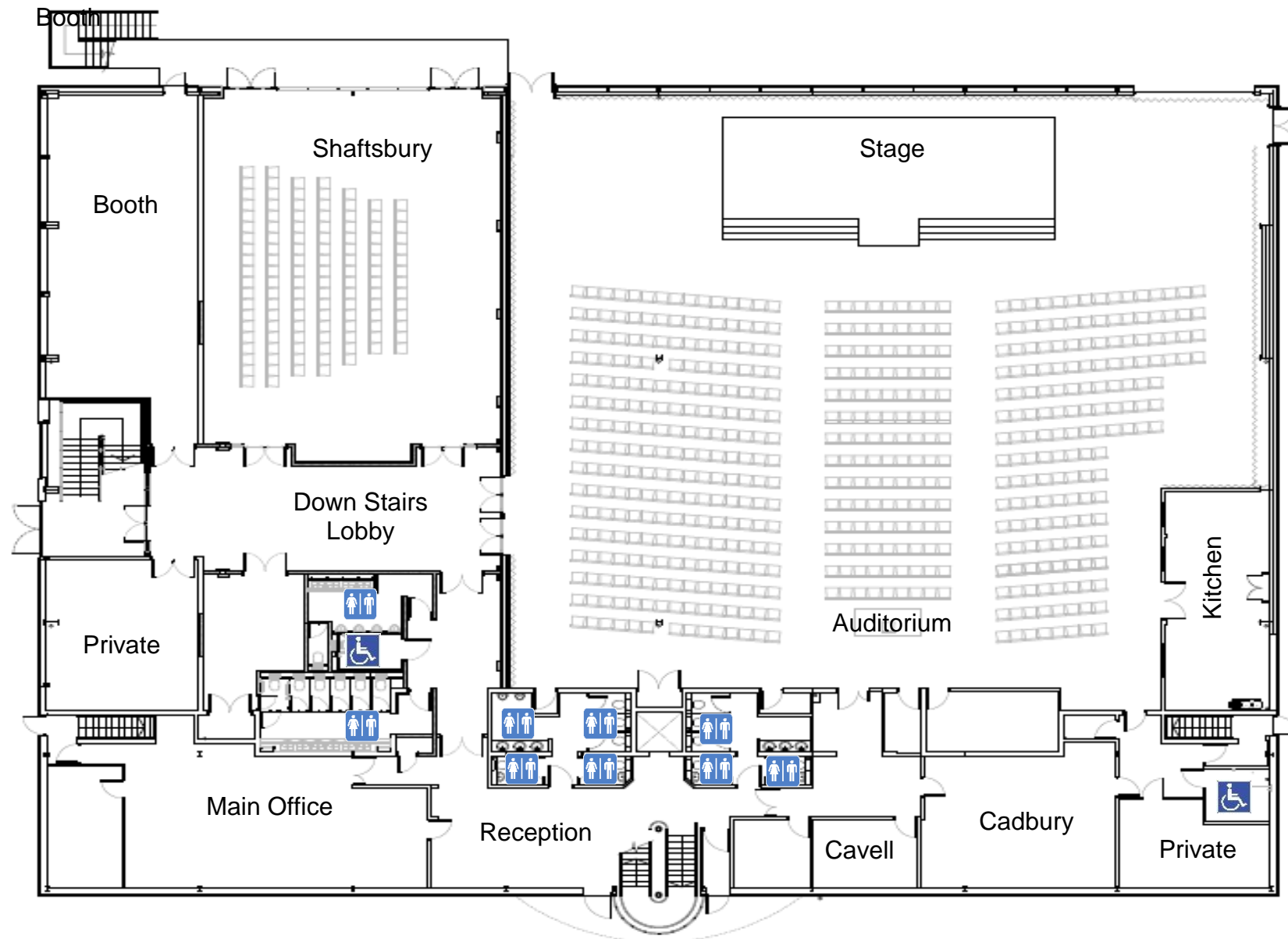

Floor Plan - First Floor

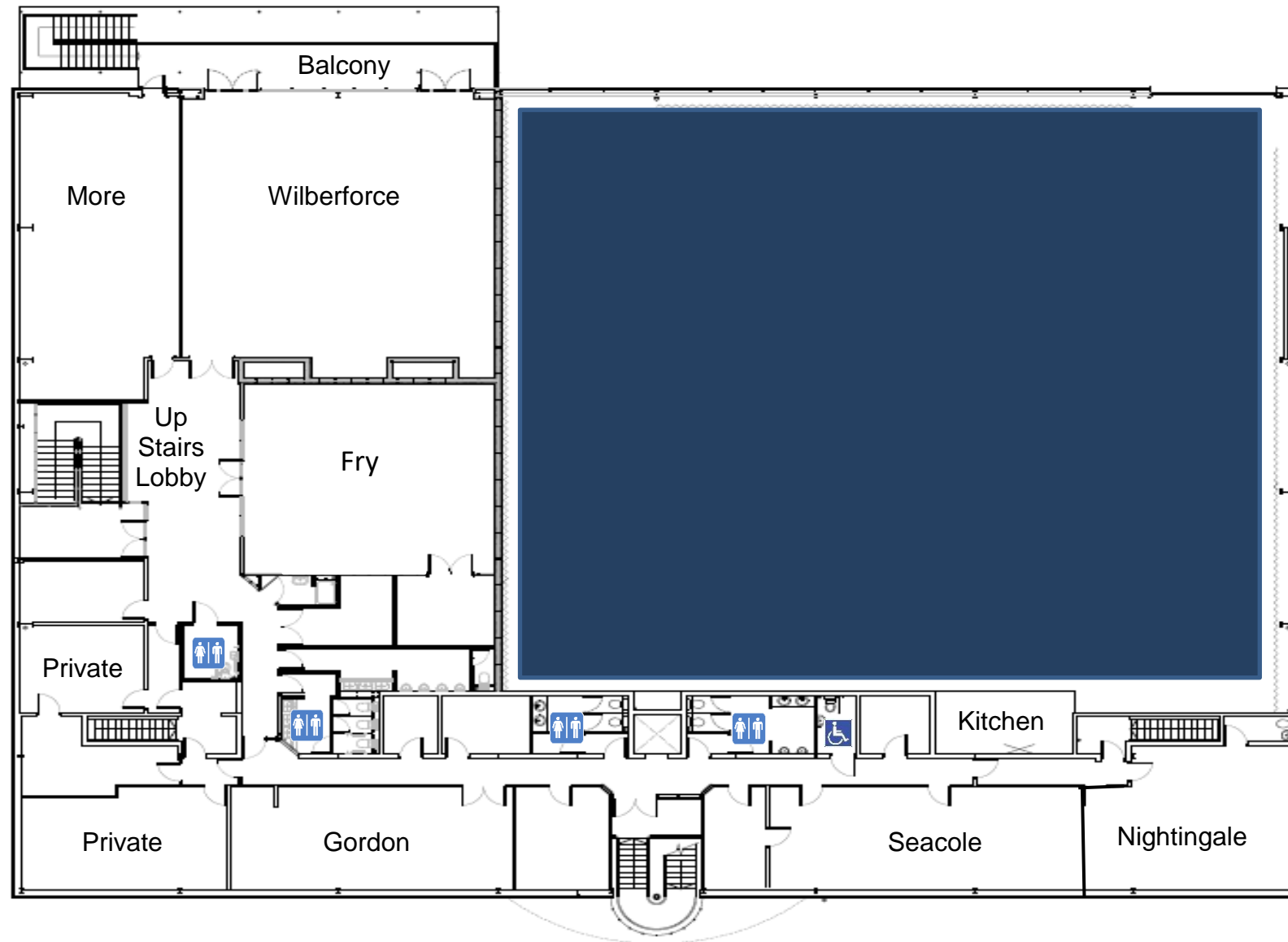

Refreshments & Catering

Catering: Refreshments	Price (Per person per serving)
Refreshments (Tea/Coffee) <i>(the first serving includes a pack of complimentary biscuits per serving)</i>	£1.35
Additional biscuit servings	£0.75
Cake Selection	£2.50
Juice Selection	£1.00
Breakfast Rolls	£3.50
Danish Pastry Selection	£2.00

Catering: Lunch Packages		Price (Per person per serving)
BRONZE	<i>An selection of homemade sandwiches, crisps or tortilla chips and fruit skewers or mini cakes.</i>	£5.95
SILVER	<i>A selection of homemade sandwiches or wraps, a selection of savoury finger foods, crisps, crudités and fruit skewers or mini cakes.</i>	£7.95
GOLD	<i>A selection of finest homemade sandwiches or wraps, a large selection of savoury finger foods, crisps, crudités, fruit platters and cake selection.</i>	£9.95
EXECUTIVE GOLD	<i>A composition of luxury sandwiches on speciality breads, antipasti selection, a variety of indulgent salads, speciality crudités and crisp breads with dips, fresh fruit salad and a selection of mousses.</i>	£14.95
HOT FOOD BUFFET	<i>A selection of meat and vegetarian chilli or Spanish chicken served with rice and bread rolls.</i> <i>(min 30 people, max 50 people)</i>	£12.50