



INNOVATIVE SPACES. INSPIRED EXPERIENCES.

Discover the comforts of Bethesda North Marriott Hotel & Conference Center, one of the premier hotels in Bethesda, MD.

Boasting over 60,000 square feet of versatile, high-tech event space, a state-of-the-art fitness center, the M Club lounge, and The Corby Kitchen Restaurant and Bar, our hotel is conveniently located to serve both business and leisure travelers.

Offering everything you need for a remarkable stay, we provide the perfect setting for work, relaxation, and everything in between.



MARRIOTT
BETHESDA NORTH

NEW SPACE, NEW ENERGY FOR YOUR MEETING & EVENT

Elevate your next event with our premier versatile event space, featuring innovative culinary menus and sustainable initiatives, top-tier audiovisual services, high-speed Wi-Fi, and the support of our expert event production team to create a memorable conference experience. Energize your guests with inspiring coffee breaks, lunches, or full banquets, expertly crafted by our catering team. We look forward to welcoming you to the Bethesda North Marriott Hotel & Conference Center.



MEETING ROOM	DIMENSIONS		CAPACITY					
	W x L x H	Sq. Ft.	Theater	Schoolroom	Conference	U-Shape	Reception	Banquet
GRAND BALLROOM	209x112x23	23,408	2500	1520	—	—	2500	1620
SALONS A,B,C,F,G OR H (EACH)	52x37x23	1,924	194	128	46	50	200	120
SALON D OR E (EACH)	52x112x23	5,824	594	360	—	—	600	400
SALONS DE	112x105x23	11,760	1188	720	—	—	1200	800
SALONS A-D OR E-H	105x112x23	11,760	1169	685	—	—	1200	760
SALONS A-E OR D-H	156x112x23	17,472	1800	1050	—	—	1800	1160
SALONS A-C OR F-H	52x112x23	5,824	575	325	—	—	575	360
GRAND FOYER	—	10,500	—	—	—	—	—	—
TERRACE	—	6,800	600	—	—	—	600	560
BROOKSIDE BALLROOM	85x61x13	5,185	500	261	—	—	500	330
BROOKSIDE A OR B	35x30x13	1,050	102	48	28	27	75	50
BROOKSIDE AB	35x60x13	2,100	204	96	56	54	150	100
BROOKSIDE C	61x51x13	3,111	252	172	60	60	250	180
BROOKSIDE BALLROOM FOYER	117x36x13	2,530	—	—	—	—	—	—
WHITE OAK	54x76x11	4,104	—	—	—	—	400	310
WHITE OAK A	76x28x11	2,128	185	112	60	60	200	140
WHITE OAK B	120x90	1,976	185	112	60	60	200	140
WHITE OAK FOYER	65x23x13	1,495	—	—	—	—	—	—
SENECA BOARDROOM	32x27x13	864	18	—	18	—	—	—
OAKLEY	24x27x13	648	45	30	20	21	50	40
GLEN ECHO	31x41x13	1,271	127	72	34	36	90	80
FOREST GLEN	41x31x13	1,271	127	72	34	36	90	80
GREAT FALLS	28x17x13	476	36	28	20	18	36	30
MIDDLEBROOK	28x17x13	476	36	28	20	18	36	30
TIMBERLAWN	28x17x13	476	36	28	20	18	36	30
LINDEN OAK	43x25x13	1,075	90	62	36	39	90	80
STRATHMORE	26x59x12	1,534	140	92	54	54	130	120
STRATHMORE A	31x25x12	775	70	51	30	30	75	60
STRATHMORE B	27x27x12	729	60	42	24	24	55	40



MAIN LEVEL

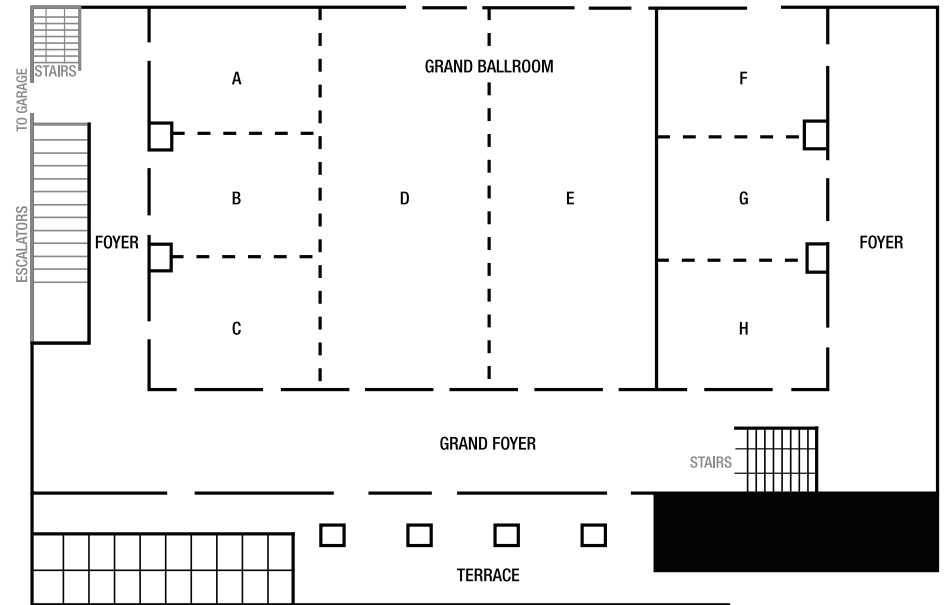

LOWER LEVEL

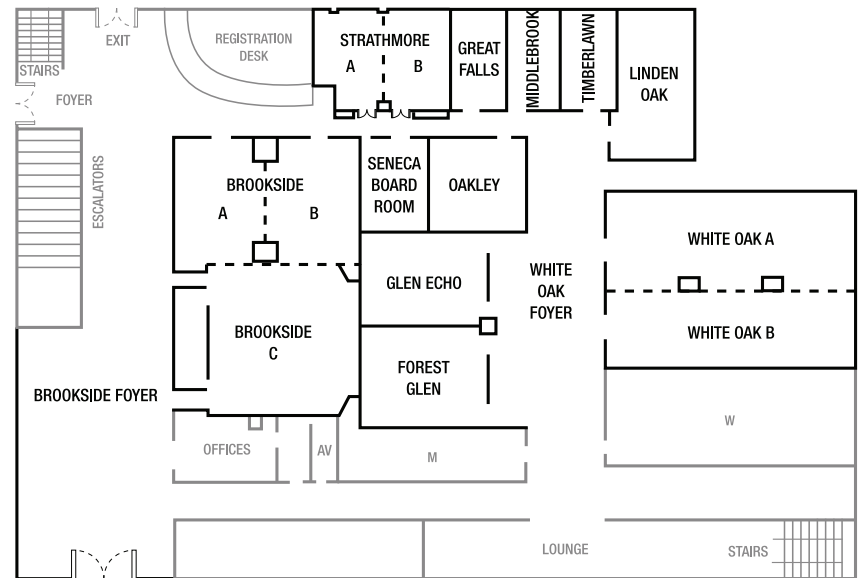

BETHESDA NORTH MARRIOTT HOTEL & CONFERENCE CENTER

5701 Marinelli Road

North Bethesda, MD 20852

T: 301.822.9200

marriott.com/WASBN

 @BethesdaNorthMarriott

 @BethesdaNorthMarriott

GUEST SERVICES

Guest Computer Station with Printer • 24 hour Modern Fitness Center, featuring Peloton bikes • The Corby Market, grab and go hot and cold snacks, sandwiches and beverages. Featuring Illy coffee with outdoor seating available • MClub Lounge, exclusively for our Bonvoy Platinum and above Elite members • Cash machine/ATM • 5 Water Filling Stations • Pharmacy Kiosk • Off-site dry cleaning • Mobility accessible

ACCOMMODATIONS

455 Guest Rooms • 13 Mobility and Hearing Accessible Guest Rooms • 6 Doubles, 6 Kings and 1 Suite • 1 Presidential Suite • 1 Vice Presidential Suite • 1 Double Bed Suite • 11 Standard Suites • Marriott Signature Bedding Package • Plug In Technology Panel • SMART 55 inch TV • On Demand Streaming Services • In-Room Dining • Mini fridge • In-Room safe, desk • 10 USB plugs • Internet Browser/Web TV • Individual Climate Control • AM/FM Alarm Clock Radio • Smoke Free Policy in all Guestrooms and Public Spaces

RESTAURANT+BAR & TOPGOLF

Savor the best of regional dining at The Corby Kitchen, featuring locally sourced cuisine inspired by the Chesapeake Bay. Enjoy our semi-private dining room, accommodating up to 10 guests, and elevate your leisure time with the on-site Topgolf Swing Suite.

ATTRACTIONS

Pike & Rose, Dining and Shopping Center • The Music Center at Strathmore • Cabin John Regional Park • Westfield Montgomery Mall • Downtown Bethesda • Washington, DC Monuments & Attractions • National Zoo

MEETING FACILITIES

24 Event Spaces, over 60,000 sq. ft. of Total Meeting Space • Largest Meeting Room is Grand Ballroom with Maximum Meeting Space of 23,408 sq. ft. and Maximum Seating Capacity of 2,500 • Newly Renovated in 2025, Brookside Ballroom, offers 5,185 sq. ft. • Meeting Rooms with High-Speed Internet Access • Encore A/V Services Available On-Site • Marriott Meeting Services App Available.

LOCATION

Located in one of Washington, DC's surrounding suburbs, our hotel is close enough to all that you want to see; yet more comfortable and accessible than other metropolitan locations. Adjacent to the Metrorail's Red Line, the entire greater Washington, DC area is just 4 metro stops away. With our proximity to the I-270 Technology Corridor and the restaurants and activities of downtown Bethesda, our hotel is the perfect location for both work and play. The possibilities are endless.



Go There With

MARRIOTT BONVOY™

