



MERCURE LONDON HYDE PARK



The Churchill



DIMENSIONS

Area: 19.9sqm / 214sqft

Height: 3m / 9' 8"

Width: 4.10m / 13'45"

Length: 4.62m / 15'16"

Up to 12 delegates



①

THE CHURCHILL

12 SEAT MEETING ROOM

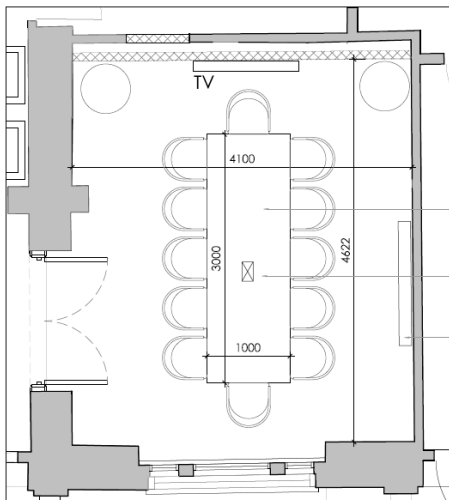

AREA: 19.9 SQ.M

CEILING HEIGHT: 3.00 M

EXTENDING CONSOLE-
BOARD ROOM TABLE

4 X POWER TO FLOOR
BOX IN CARPET

FIREPLACE



MERCURE LONDON HYDE PARK



The Hyde

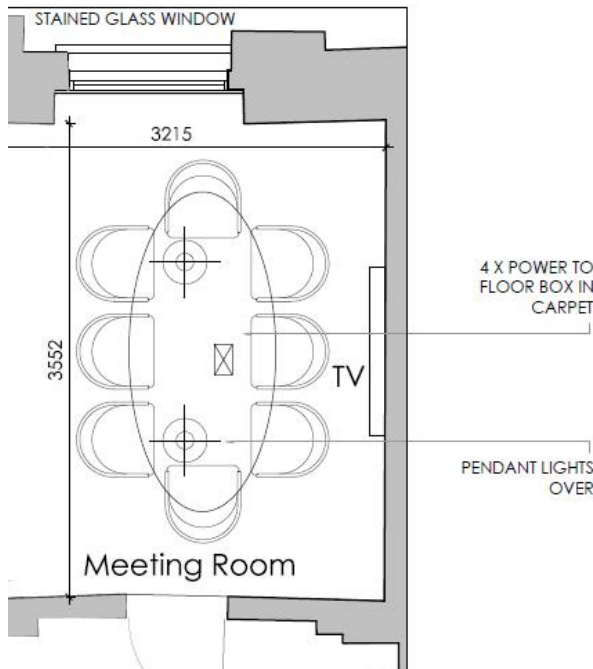

DIMENSIONS

Area: 12sqm / 130sqft

Height: 2.95m / 9'7"

Width: 3.22m / 10'56"

Length: 3.55m / 11'65"

Up to 8 delegates



MERCURE LONDON HYDE PARK



The Serpentine 2



DIMENSIONS

Area: 54.9sqm / 590.94sqft

Height: 2.34m / 7'7"

Width: 4.23m / 13'88"

Length: 11.60m / 38'06"

Up to 30 delegates

55" TV TO
CENTRE
PANEL IN
WENGE
FINISH

FLOOR
SOCKET
x 4
POWER
POINTS

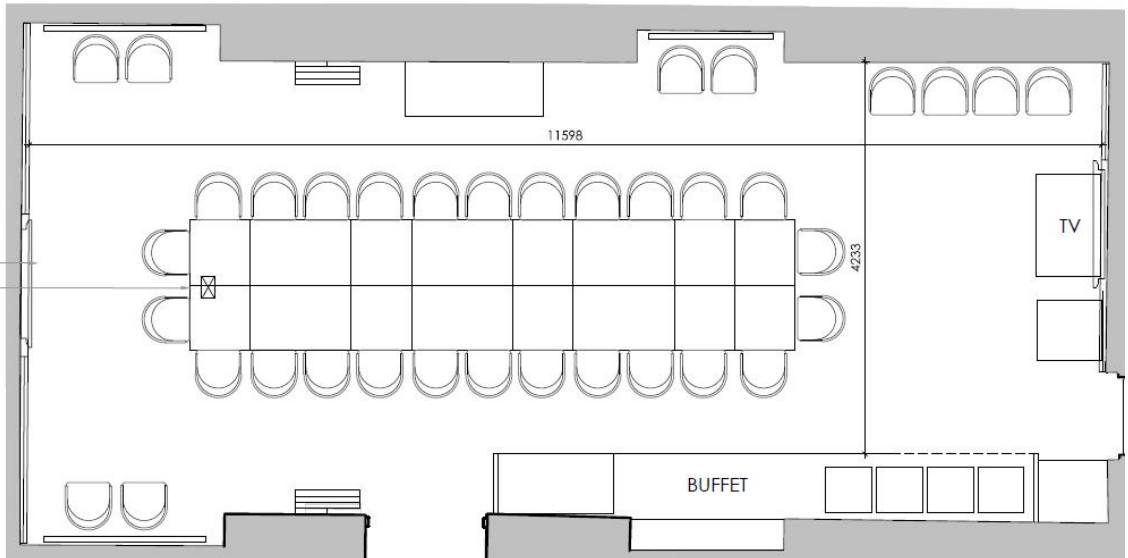



MERCURE LONDON HYDE PARK



The Serpentine 1

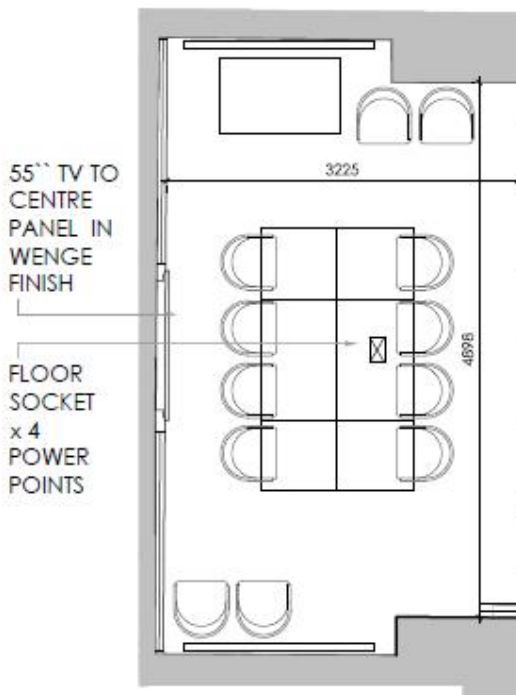

DIMENSIONS

Area: 17.8sqm / 192sqft

Height: 2.34m / 7'7"

Width: 3.23m / 10'60"

Length: 4.90m / 16'08"

Up to 14 delegates



HOTEL INFORMATION

A PRIME LOCATION

Moments away from Hyde Park, set in a tranquil & beautiful garden square, a venue like no other.

Step into the elegance of a London townhouse hotel, nestled seconds away from the bustle of Paddington station, for the perfect London retreat. Historic and traditional English class with contemporary twists await you...



- Brand new hotel (opened November 2016)
- 72 non smoking boutique guest bedrooms, including suites overlooking garden square
- Air conditioning throughout the hotel
- Wi-Fi in public areas & bedrooms
- 7 floors
- Lift to all floors
- Restaurant & Bar
- Fitness suite
- 4 meeting spaces for up to 26 delegates



- Hyde Park within 2 minutes' walk
- In proximity of Marble Arch, Notting Hill and Paddington Basin
- Lancaster Gate Tube Station: 2 mins
- Paddington Tube Station: 2 mins
- National Rail (London Paddington): 2 mins
- Heathrow Airport: 15 mins (Heathrow Express Train)