

WELCOME GUIDE

* For safety issue, the product remains low capacity during shipping. Please fully charge the product before initial use!

Smart  Shaver

Please read this Guide carefully
before using the product

Package Contents



Product Overview

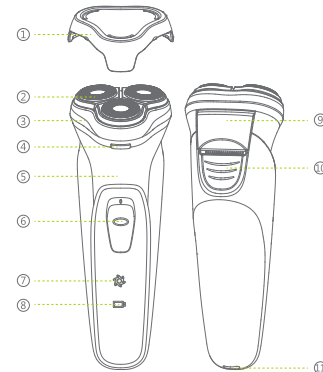

- ① Protective Cap
- ② Shaving Unit
- ③ Shaving Unit Cap
- ④ Release Button
- ⑤ Body
- ⑥ On/Off Button
- ⑦ Indicator
- ⑧ Power Level
- ⑨ Sideburn Razor
- ⑩ Push Pedal Of The Sideburn Razor
- ⑪ Type-C Port

Steps for Using

Nominal Voltage: 5V
Rated Power: 5W
Charging Time: 1 Hour

Steps for Using



Step 1
Turn the shaver on by pressing the on/off button and slightly pushing the on/off push pedal.



Step 2
Shave against the direction of the beard growth on your skin using both straight and circular movements.



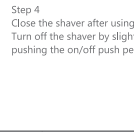

Step 3
Push the push pedal of the sideburn razor downward to eject the razor, then start to trim your sideburns.



Step 4
Close the shaver after using it. Turn off the shaver by slightly pushing the on/off push pedal.

Charge Your Trimmer

Trimmer Status Indicator		Status
	Flashing and blinking	Being charged
	Flashing and blinking	Low battery
	Steady light	Fully charged

Cleaning and Maintenance

Warning:

This product is non-waterproof. Do not clean the shaver's body with water.

- The shaver must be turned off when being cleaned.
- Regular cleaning of the shaver can ensure better shaving performance.
- Cleaning of parts of the shaver:
 - Clean the shaving unit once a week, clean the razor net every two months.
 - Use the brush supplied with this product and start the cleaning from its top.
 - Press the release button and remove the shaving unit.
 - Brush clean the hair pouch and re-install the shaving unit back on the shaver.
- Cleaning of the shaver's razor net:
 - Press the release button and remove shaving unit. Rotate counterclockwise to remove the fixture.
 - Remove the razor net from the head cap in sequence (Do not switch the razor net or the net cover because it will affect the shaving performance).
 - Clean the razor net and net cover with the brush supplied.
 - Install the razor net back into the head cap and then install the fixture back onto the shaving unit.
- Replacement of shaving unit:
 - Remove: press the release button, gently pull it upward to remove the shaving unit.
 - Install: Align the shaving unit to the interface of storage pouch and slightly press it down to put it back on the shaver.



Cleaning and Maintenance

- Remove the front trim with a screwdriver.
- Use a cross screwdriver to unscrew the screw on the front panel and remove the back panel.
- Use a cross screwdriver to unscrew the two screws on the circuit board and take out the circuit board.
- Cut off the electricity contact piece on the battery, take out the battery and dispose it properly.

Note: Do not let the electricity contact piece of the battery short.

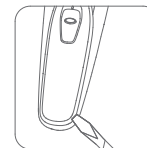

Note

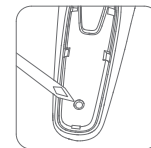

Unscrew

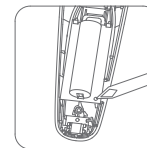

Unscrew

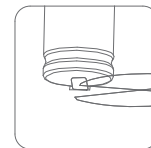

Cut

Important Safety Instructions

When using this product, basic precautions should always be followed, including the following:

Danger:

- This product and its accessories are not toys. Please put them out of the reach of children to avoid danger.
- Do not use wet hand to plug and pull the power cord, keep the power cord away from sticky liquid or other liquid.
- Make sure to keep the shaver's body, adapter and power cord dry. Do not use it in bathroom.
- This product contains a built-in rechargeable battery. Do not drop the battery into fire and never charge, use or place it at the place where temperature is high.
- Do not use the shaver when its power cord or adapter is damaged or when the connection between it and the electric outlet is loose.

The symbol on the right indicates that the shaver's body cannot be cleaned under a running tap.

Warning: Please keep the shaver's body dry.

Warning:

- Ensure to keep the power cord and this product dry. Do not clean the shaver with water.
- Before connecting the power cord and charging, make sure that the voltage marked on the body of this product matches the local power supply voltage.
- If the power cord is damaged or lost, please purchase the original model from the manufacturer or after-sales maintenance department for replacement.
- Please use and store this product at a place where the temperature is between 5°C and 35°C.
- When any abnormality or malfunction of this product is found stop using it immediately. Please deal with the problem according to the type of malfunction and if necessary, take it to the maintenance department of our company for repair.
- Do not press this product too hard on your lips or any other part of your face and do not directly contact your scar or damaged skin with the razor net.
- Do not disassemble the shaver's body for battery replacement.
- Do not immerse this product in water or any liquid.

9. Do not knock down or drop this product. If it is damaged due to collision or fall, please stop using it.

10. Persons with physical disabilities, mental disorders or lack of relevant experience and knowledge(including children)should use this product under the supervision and guidance of their guardians.

11. Before taking out the battery, the motor must be power off.