



## WELCOME GUIDE

\* Please read the instructions carefully before using the product and keep the user manual in a safe place for future reference.



### Package Contents

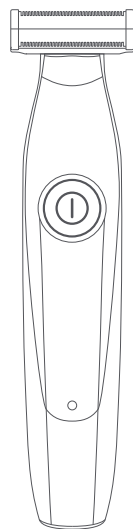

Groomer x 1

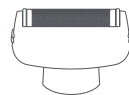

Mesh Shaving Head X 1



Cleaning Brush X 1



Oil Bottle X 1

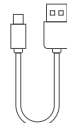

Type-C Charging Cable x 1



1mm Comb X 1



3mm Comb X 1



5mm Comb X 1



Welcome Guide x 1

### Product Overview

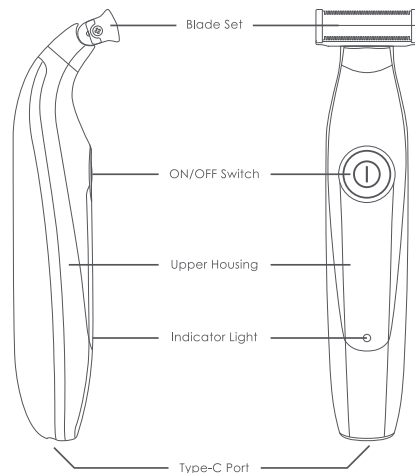

### Specification

Motor's Voltage: DC 3.6V; Rated Power: 5W;  
Charging time: 1.5 hours; Working time: ≥ 60 minutes  
\* oraimo Lab test result

### How to Use

1. Connect the small end of the Type-C cable to the battery pack socket at the bottom of the machine, and connect the other end of the Type-C cable to the power supply (5V/1A).When charging, the indicator light shows red. Display light will show green color when fully charged. When the power is low, the red light will flash. The full charging time is 1.5 hours, when fully charged it can work more than 60 minutes.
2. Push the switch button for working and stopping.

#### How to use the comb attachment:

Please make sure the device is turned off before you use the comb attachment.

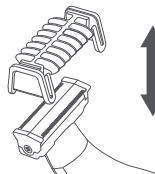

1. Hold the both end of the comb with your fingers, put on the blade set with correct direction.
2. Hold the both end of the comb with your fingers, pull from the blade.

### Cleaning and Maintenance

1. Hold the unit, and pull the blade set upwards. The blade unit can be removed and cleaned by using the supplied cleaning brush, and use the supplied oil container, add 2 to 3 drops of lubricating oil onto the movable parts and stationary blades.
2. The blades must be cleaned regularly. Insert the blade unit back into the trimmer and push it in the direction of the arrow.

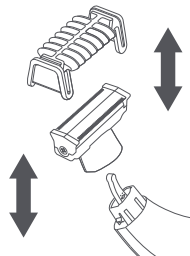

### When Charging:

Please stop charging if the temperature is lower than 0°C or higher than 40°C.  
Please stop charging if it is nearby the sunlight perpendicular incidence or the heat source radiates.  
The standard charging time is 1.5hours. In order to avoid mangling the batteries, please don't extend the charging time.

#### Cautions:

Clean the case only with a slightly damp cloth or a mild soap solution. Never use caustic solutions.  
Never submerge the product in water. Keep away from the children.  
This product may become warm during operation and/or charging, this is normal. When in use, do not hold the power cord to avoid injury and accidents  
Never tamper with moving parts.

This appliance is not intended for use by persons (including children) with reduced physical, sensory or mental capabilities, or lack of experience and knowledge, unless they have been given supervision or instruction concerning use of the appliance by a person responsible for their safety;  
Children should be supervised to ensure that they do not play with the appliance.  
To prevent possible harm to the environment or human health from uncontrolled waste disposal, recycle it responsibly to promote the sustainable reuse of material resources. To return your used device, please use the return and collection systems or contact the retailer where the product was purchased. They can take this product for environmental safe recycling.



Not to be used in bath or shower  
**WARNING:** Keep the appliance dry.

### Important Safety Instructions

When using this product, basic precautions should always be followed, including the following:

#### Warning:

1. Ensure to keep the charging cable dry.
2. Before connecting the power cord and charging, Make sure that the voltage marked on the body of this product matches the local power supply voltage.
3. If the power cord is damaged or lost, please purchase the original model from the manufacturer or after-sales maintenance department for replacement.
4. Please use and store this product at a place where the temperature is between 5°C and 35°C.
5. When any abnormality or malfunction of this product is found, stop using it immediately. Please deal with the problem according to the type of malfunction and if necessary, take it to the maintenance department of our company for repair.
6. Do not press this product too hard on your lips or any other part of your face and do not directly contact your scar or damaged skin with the razor net.
7. Do not dissemble the shaver's body for battery replacement.
8. Do not immerse this product in water or any liquid.
9. Do not knock down or drop this product. If it is damaged due to collision or fall, please stop using it.
10. Persons with physical disabilities, mental disorders or lack of relevant experience and knowledge (including children) should use this product under the supervision and guidance of their guardians.
11. Before taking out the battery, the product must be power off.

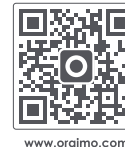

www.oraimo.com



oraimo accessories

**Keep Exploring**