

110mm Outlet EF Branch Saddles

Advanced saddles with features to benefit the installer, single bolt clamping, built-in test connection and SmartFuse welding.

PLASSON's EF branch saddle range with 110mm outlets has a built-in clamping facility so no separate clamping tool is required.

The saddle has an integrated pressure test facility usually only found in the large diameter saddles and allows testing before a flange adapter and valve are fitted.

The saddle's built-in clamping system features a single bolt clamp that tightens onto the main using only a 6mm Allen key and does not need to be removed after the weld process.

A secure weld is easy to achieve thanks to the saddle's large weld area.



KEY FEATURES

- Manufactured in high performance black PE100.
- Approved to EN12201 and EN1555.
- Accepted for use with potable water according to BS6920.
- Rated PN16 and is suitable for pipes from SDR7.4 to SDR17.



110mm Outlet EF Branch Saddles

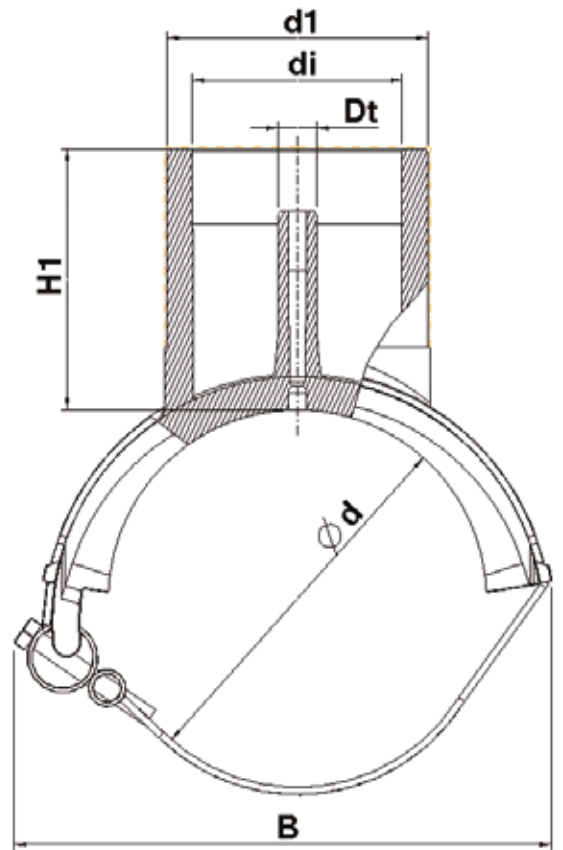
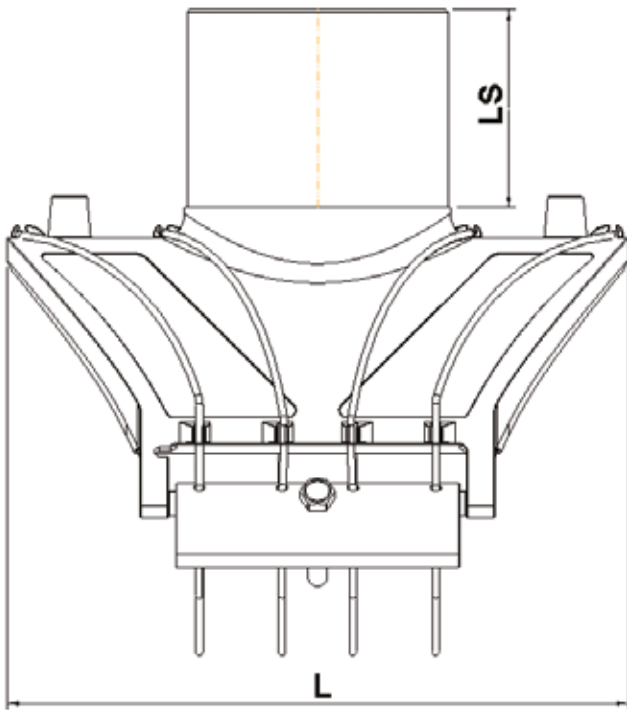

495804 EF Branch Saddles

160, 180, 200, 225, 250 x 110mm outlet.



Code	d	d1	B	L	LS	H1	Dt	di
PF4958X4125110T	125	110						
PF4958X4140110T	140	110						
PF4958X4160110T	160	110	219	263	84	110	16	89
PF4958X4180110T	180	110	229	263	84	110	16	89
PF4958X4200110T	200	110	277	295	84	111	16	89
PF4958X4225110T	225	110	272	295	84	111	16	89
PF4958X4250110T	250	110	280	295	84	111	16	89

Technical Details:

Voltage:	40 Volts + 0.5 Volts.
Welding Data Input:	SmartFuse, Barcode, Manual.
Pipe SDR Compatibility:	SDR 7.4 to SDR 17.6.
Pressure Rating:	Water PN16, Gas PE100 SDR11.
Raw Material:	PE100