



Tropical Cyclone Idai Response | Mozambique

Shelter Cluster Coordination Meeting

16 December 2019, DPOPHR Office, Beira

Agenda proposta:

- 1. Atualizações sobre lacunas e necessidades**
- 2. Atualizações no SAG Maputo: planos de doadores**
- 3. Atualizações sobre reassentamentos (atividades da OIM, Grudja,)**
- 4. Pontos técnicos:**
 - Revisão Técnica
 - ONU-Habitat: treinamento técnico + projetos abrigos
 - PNUD: projeto abrigos em curso
 - Atualizações sobre a casa evolutiva do SC



SOFALA – MANICA - ZAMBEZIA

IM Updates (Shelter data is completed. NFI is still ongoing....)

Total of HHs reached with Shelter support

130,178

Total of NFIs distributed

280,432

Shelter Coverage

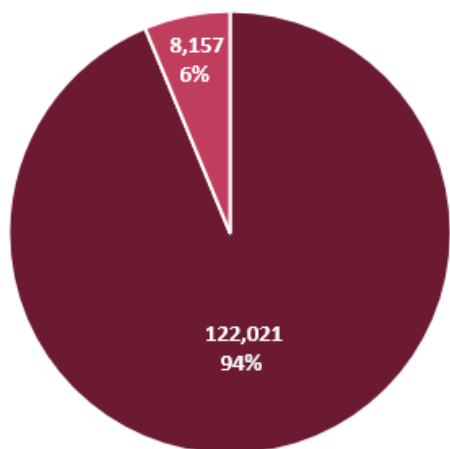

■ Temporary Shelter (HHs) ■ Permanent Shelter (HHs)

NFIs Distributed

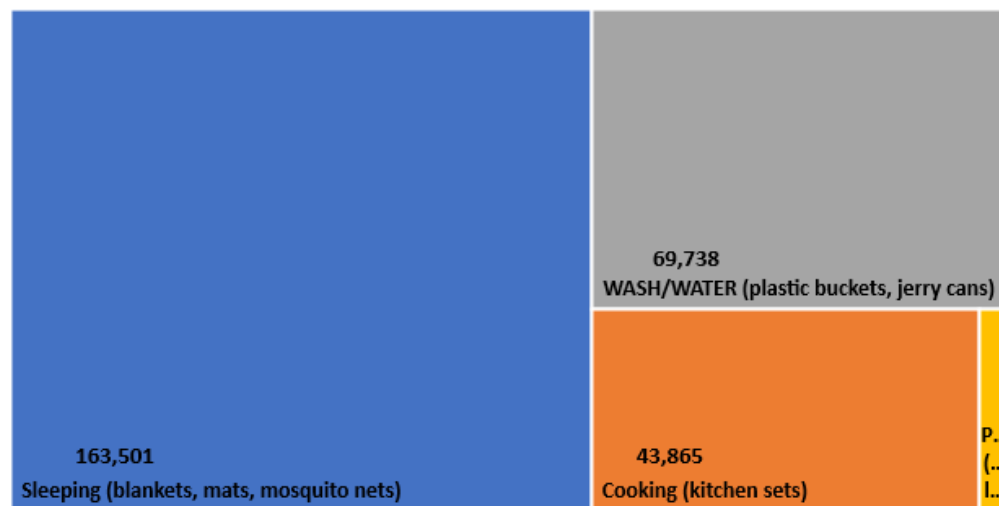

■ Sleeping (blankets, mats, mosquito nets) ■ Cooking (kitchen sets)
■ WASH/WATER (plastic buckets, jerry cans) ■ Protection (solar lights)



IM Updates (Number of HHs that chose Shelter as their priority 1 & 2)

Data source: DTM (Nov)

Shelter priority needs

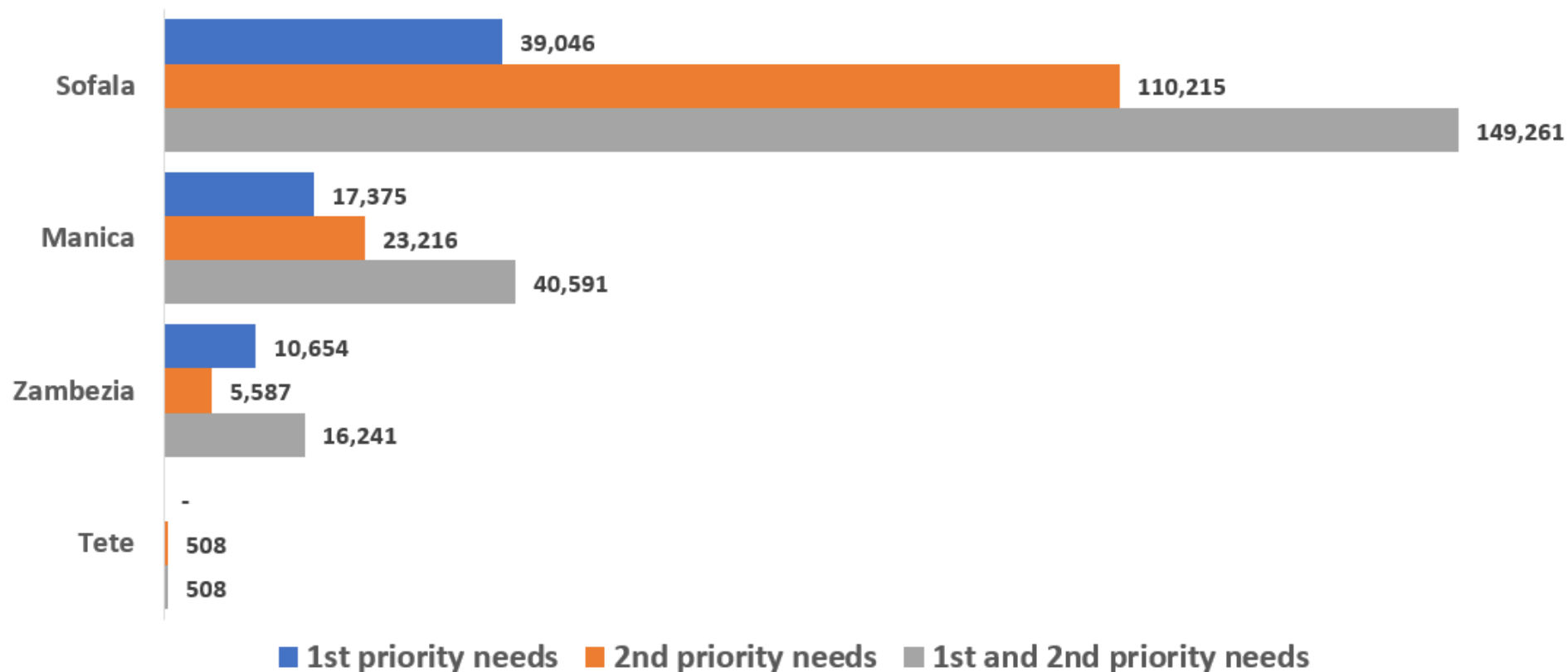



Location	1st priority needs	2nd priority needs	1st and 2nd priority needs
MANICA	17,375	23,216	40,591
Gondola	-	7,999	7,999
Macate	8,494	2,191	10,685
Machaze	-	126	126
Manica	-	1,631	1,631
Mossurize	2,865	5,575	8,440
Sussundenga	6,016	5,694	11,710
SOFALA	39,046	110,215	149,261
Buzi	-	33,082	33,082
Chibabava	-	4,494	4,494
Cidade da Beira	28,439	33,647	62,086
Dondo	-	22,575	22,575
Machanga	258	1,582	1,840
Muanza	2,614	1,231	3,845
Nhamatanda	7,735	13,604	21,339
TETE	-	508	508
Mutarara	-	508	508
ZAMBEZIA	10,654	5,587	16,241
Derre	212	-	212
Maganja da Costa	-	856	856
Mocuba	-	430	430
Morrumbala	2,032	-	2,032
Namacurra	1,232	4,301	5,533
Nicoadala	7,178	-	7,178
Grand Total	67,075	139,526	206,601



- Province
- (Blank)
 - Manica
 - Sofala
 - Zambezia

Distrito

All

- Status
- (Blank)
 - Closed
 - Open

- Type of case
- Assistance Quality
 - Assistance Request
 - Fraud
 - Inclusion Error

Total number of cases

69

COMPLAINTS FEEDBACK REPORT FOR IDAI CYCLONE

Shelter case overview for areas affected by cyclone Idai.

**Use the filters above to explore the dashboard data below.*

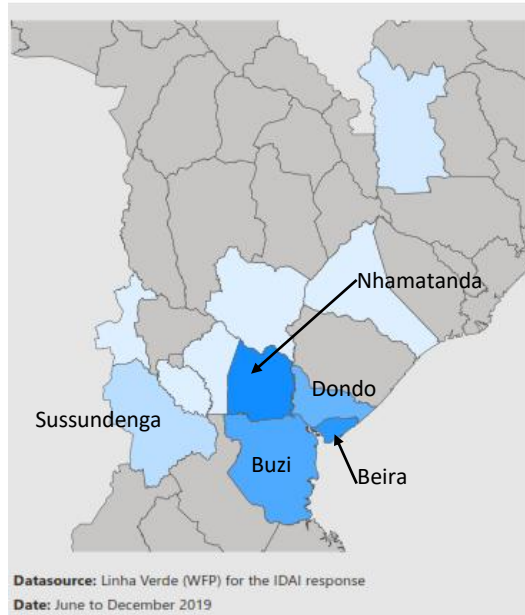

WHAT ARE THEY REQUESTING?

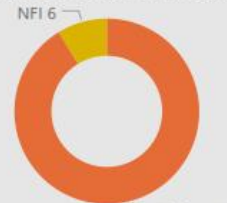

Shelter requests are more recurrent, specially in Sofala

TOP 4 REPORTED ISSUES

Type of case	Count of Ord.
Assistance Quality	1
Assistance Request	52
Fraud	8
Inclusion Error	8
Total	69

WHO ARE THEY?

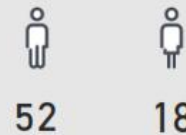

CASES STATUS

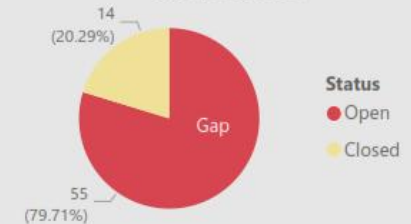

MONTHLY VOLUME OF CASES RECEIVED

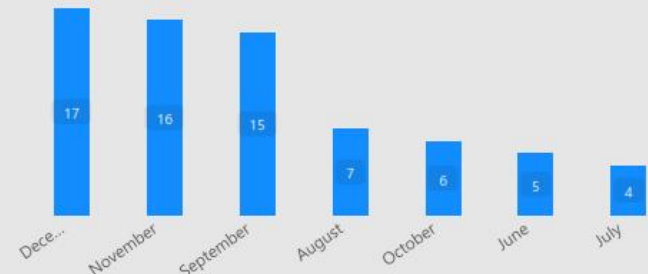

Categorias Principais	Nr. De Casos	SOFALA						MANICA				ZAMBÉZIA	NOTAS
		Beira	Buzi	Cheringoma	Dondo	Gorongosa	Nhamatanda	Gondola	Macate	Manica	Sussundenga	Morrumbala	
TOTAL POR DISTRITO		16	13	1	11	1	18	1	1	1	4	2	Morrumbala: - INGC (april 2019) - no available data on the first analysis; - DTM: 2032 HH Shelter Needs (nov. 2019).
Falta de Assistência/Distribuição Abrigo	51	16	6	1	7	1	15	1	1	1	1	1	
Falta de Assistência/Distribuição NFI	6	0	3	0	1	0	0	0	0	0	1	1	
Fraude	6	0	3	0	1	0	2	0	0	0	0	0	
Seleção de Beneficiários	6	0	1	0	2	0	1	0	0	0	2	0	
Queixas Gerais	0	0	0	0	0	0	0	0	0	0	0	0	
TOTAL GLOBAL	69	44						7				2	

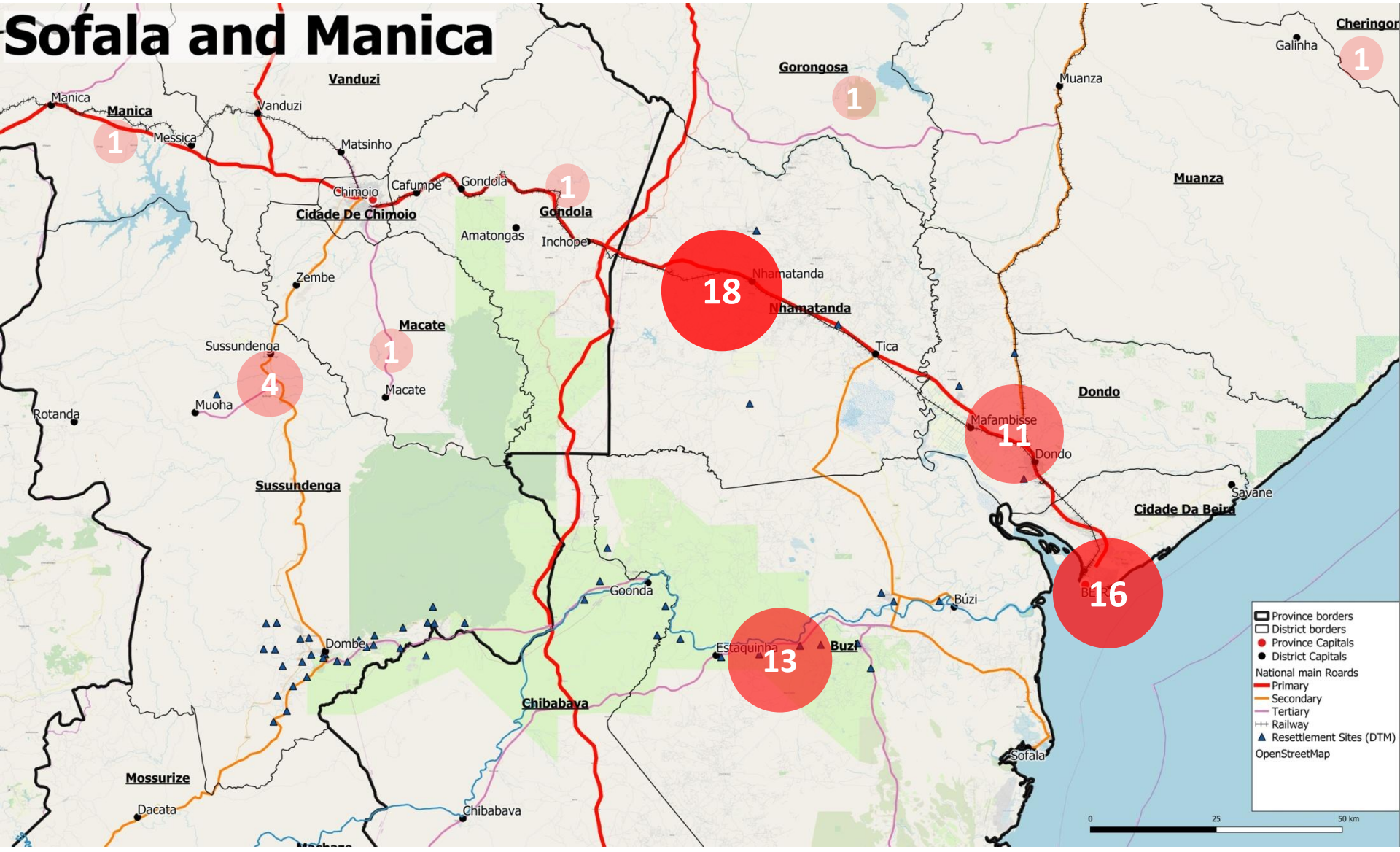



SAG Maputo

- GREPOC:
 - Need to reinforce reporting system from the SC Partners to the GREPOC and Shelter Cluster
 - Reconstruction: plan for houses implementation will include resources for infrastructures (roads, drainages, sewage systems, WASH,....)
- Shelter Cluster updates:
 - Prioritisation exercise: 95,000HH with high shelter needs
 - Emergency still ongoing in some areas: e.g. in some areas of Buzi the people received support in April and are now falling again into emergency after first heavy rains
- Discussion of reconstruction:
 - PALPOC: ongoing finalization (GREPOC, UN-Habitat updates)
 - WORLD BANK PLANS:
 - USD 42 million: core house/community infrastructure/retrofitting
 - 15,000 HH/5 years in Sofala & Cabo Delgado
 - Cost of the houses = 2'800 USD/house (including WASH, infrastructures,...)
- Need for low cost early recovery options, due to reduced available funds: transitional/resilient shelters, core houses (casa evolutiva) could represent valid alternatives for recovery intervention

ONU-Habitat: casa evolutiva em curso de finalização

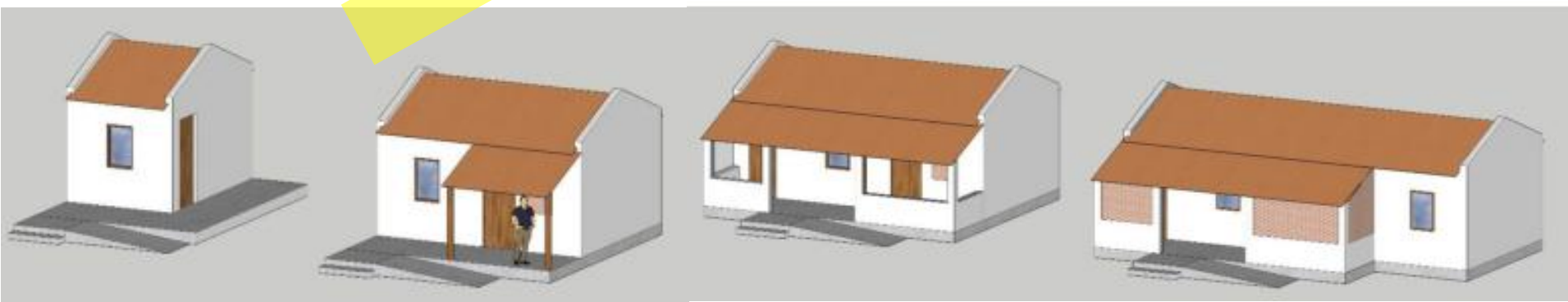
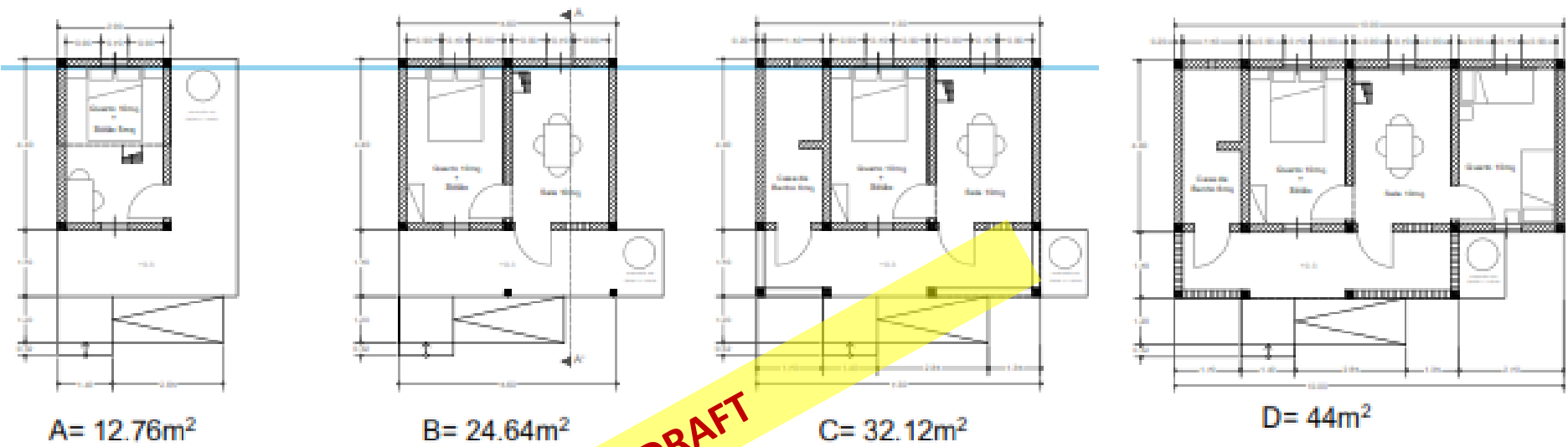

**SHELTER CLUSTER – CASA EVOLUTIVA:
OBJECTIVO DEFINICAO TIPOLOGIA COM CUSTO MAXIMO 1'500 – 1'600 USD**

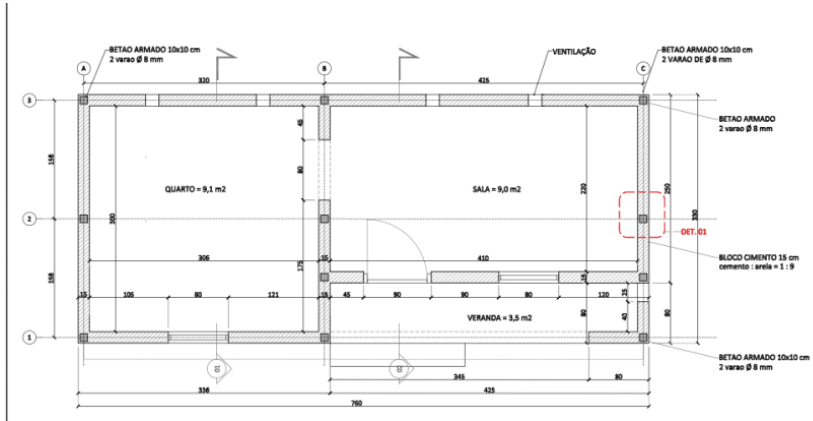



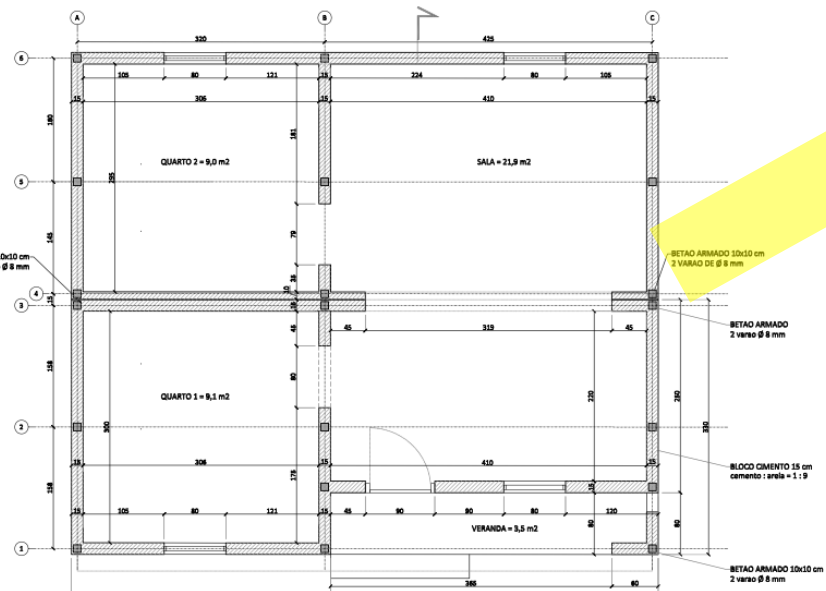
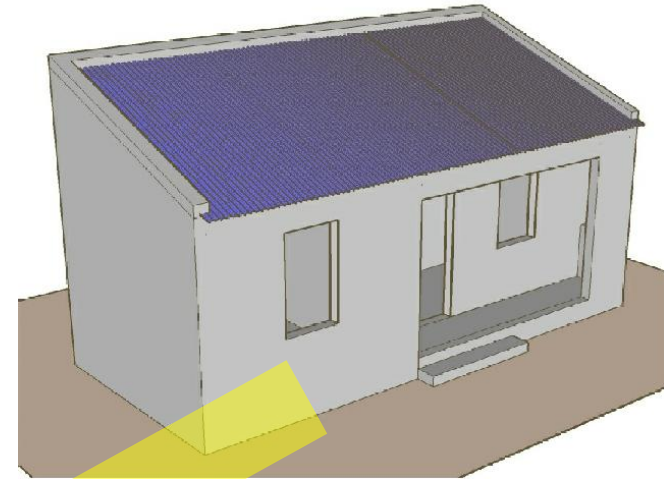

Fase 1: 18 m2

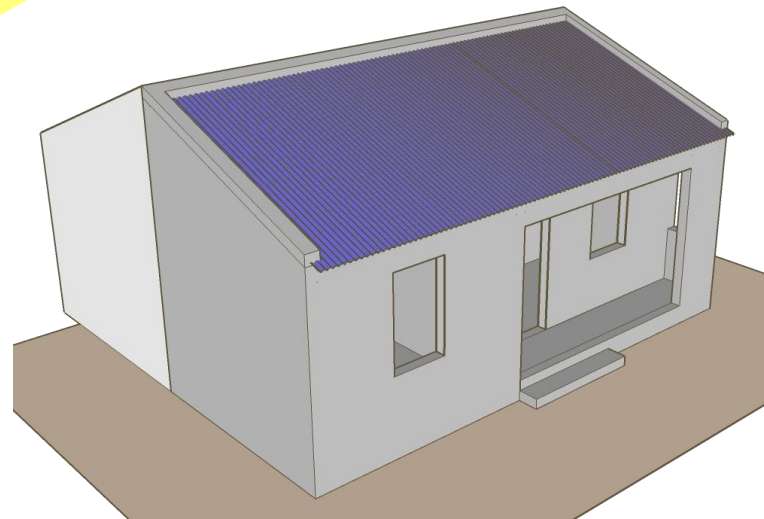

Fase 2: 40 m2







DRAFT

  	
SC CATEGORY: 5. TRANSITIONAL / RESILIENT SHELTER RURAL Sticks Adobe / Thatched roof Pau-a-pique matricado / Capim	
	
+	Economic / Adapted to rural context Local and neighboring resources / traditional knowledge WALLS / STRUCTURE Good resistance of the walls' structure to the cyclone (net effect) when new Easy to repair when the earth in the lower part is washed away by rain / flood THATCHED ROOF: good insulation from heat 4 aguas: good resistance to strong wind
-	WALLS / STRUCTURE: Durability depends on wooden structure directly inserted in the ground THATCHED ROOF: risk of fire (especially in windy areas) Requires constant maintenance Thatch is seasonal: not available ½ of the year PROTECTION: Door is not included
Cyclones	Roof risk to fly away
Flooding	Plaster is washed away. Structure may resist to minor flooding
Environment	High use of timber

REVISAO TECNICA :

- Revisão técnica de projetos de construção em curso
- Participação de GREPOC, DPOPHRH Sofala, ONU-Habitat, Shelter Cluster
- Foram visitados 2 projetos: IFRC (Chinamacondo) e CRS / CARITAS (Tica)
- Em curso finalização do documento técnico e compartilhamento de recomendações aos Parceiros

   	
SC CATEGORY: 5. TRANSITIONAL / RESILIENT SHELTER RURAL Fired Bricks / Adobe Walls/ Wooden Roof structure/ CGI Roof Tijolo queimado/ Paredes de Adobe/ Teto de Estacas / Chapas	
	
TECHNICAL DATA – SHELTER PROJECTS	
Area	22 m2 (3 quartos) = Max. 6 people
Walls	Adobe Blocks (40 x 13 x 15 cm)
Roof	4 pitches Structure: Wooden sticks / Cover: CGI Sheet 0,7 x 3.60 mts (0,4 mm)
Cost	1300 USD (materials + labor)
Timeframe	1 month to complete the construction (+ time for adobe blocks)
Labor	Local trained carpenters
+	Local materials; Earth used for blocks from local community (15 x 18 x 40cm Adobe Blocks) Easy to superficially repair walls Good foundation and floor is elevated from the ground Good quality IBR/ CGI Sheets (90cm x 3m) @ 0.4mm Thick Good Coverage with Roof of the walls Good ventilation and good plan/ layout
-	Durability depends on wooden structure directly inserted in the ground Design with veranda all around the house could act to catch wind and lift roof in cyclone/ high wind Quality of the earth used to make the blocks needs to be good Difficulty to ensure good drying- 5 Days drying time uninterrupted by rain needed Difficult to build during rainy season as mortar is not allowed to dry and adobe blocks can be damaged before roof is installed Connection between traditional wooden structure and conventional zinc roof sheets difficult to maintain uniformity
Accessibility	Steps up to main entrance: to improve access for people with reduced mobility
Protection	Doors are to be installed
Cyclones	Roof risk to fly away (Sail affect): large veranda increase the risk
Flooding	Foundation and floor is strong but if waters get as high as the adobe blocks above, damage could occur to the structure, which is reliant on adobe blocks
Environment	Good
Ciclone Idai - Mozambique 03/12/2019 www.sheltercluster.org	