



**GLOBAL  
SHELTER CLUSTER**

Coordinating Humanitarian Shelter and Settlements

Technical  
Community of Practice



# **DAMAGE ASSESSMENT**

## **Technical Sub-Community of Practice**

1st meeting – 28 August 2025 – 13.00-14-15 (Geneva)

# AGENDA

---

1. Introduction to the Damage Assessment Technical Sub-Community of Practice (T.S-CoP) & committee (10 min)
2. Present the Terms of Reference (ToR) of the Damage Assessment S-TCoP (10 min)
3. Share the topics survey results (15 min)
4. **Plenary discussion** : Q.&A., collect your suggestions, comments, survey results feedback, any additional topics of interest and expectations for our community (25 min)
5. Next steps (5 min)
6. AoB (5 min)

# Damage Assessment T.S-CoP ToR

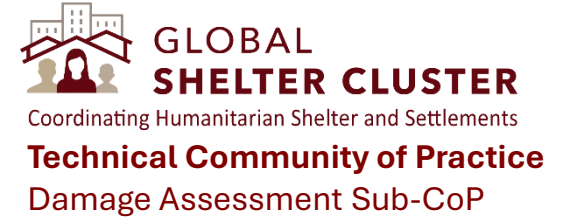

## Damage Assessment S-TCoP chair/co-chairs:

Committee members	Affiliation	Specialization	Contact
<b>Pascal Panosetti</b>	IFRC / GSC	Shelter Expert, GSC T.CoP moderator & Technical Coordinator	<a href="mailto:pascal.panosetti@ifrc.org">pascal.panosetti@ifrc.org</a>
<b>Arnold Njogu</b>	UNDP	IM/GIS Officer	<a href="mailto:arnold.njogu@undp.org">arnold.njogu@undp.org</a>
<b>Regina Wenk</b>	SDC / SHA	Structural civil engineer	<a href="mailto:Regina.wenk@aarau.ch">Regina.wenk@aarau.ch</a>
<b>Mamuney Legesse</b>	IOM	Civil Engineer	<a href="mailto:mamuney121421@gmail.com">mamuney121421@gmail.com</a>
<b>Dr Chathu Jayakody</b>	Birmingham City Uni	Senior Lecturer in Built Environment	<a href="mailto:chathu.jayakody@bcu.ac.uk">chathu.jayakody@bcu.ac.uk</a>
<b>Dr Heba Iskandarani</b>	Birmingham City Uni	Lecturer in Construction and Architectural Technology	<a href="mailto:heba.iskandarani@bcu.ac.uk">heba.iskandarani@bcu.ac.uk</a>
<b>William Rogers-Tizard</b>	RedR UK	Climate and Engineering expert	<a href="mailto:william.rogers-tizard@redr.org.uk">william.rogers-tizard@redr.org.uk</a>
<b>Noor Kuchai</b>	RedR UK	Technical Programs Coordinator	<a href="mailto:noor.kuchai@redr.org.uk">noor.kuchai@redr.org.uk</a>

# Introduction: Damage Assessment T.S-CoP

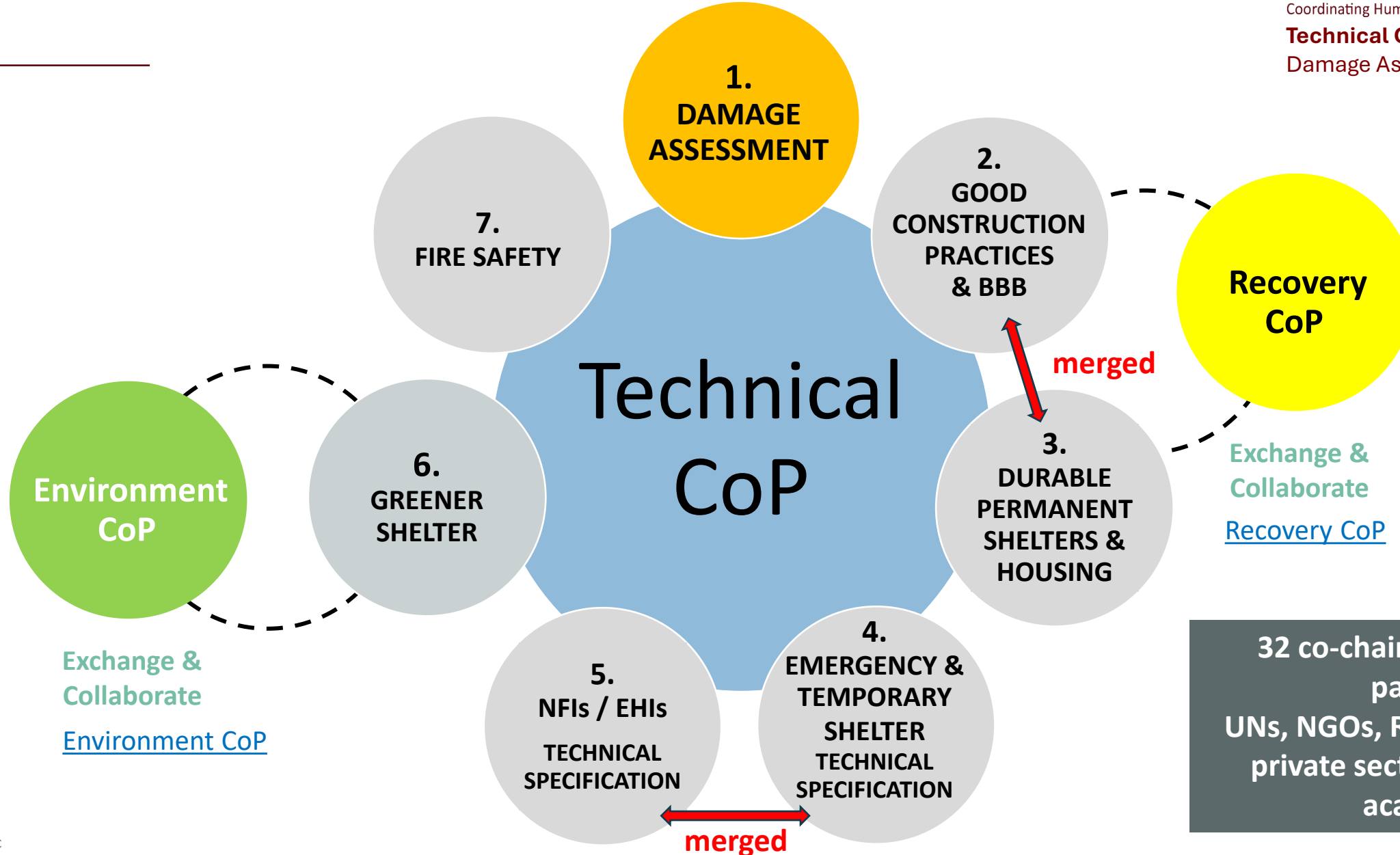

# Technical CoP page (webinars/comm.)

## Technical Community of Practice

[Technical CoP webpage](#)

- ▶ ADD CONTENT
- Administer Group
- Un-follow this community of practice
- Dashboard
- Documents (11)
- Discussions (1)
- Events (5)
- News (10)
- Followers (51)

### DAMAGE ASSESSMENT - T.SUB-COP

#### PARENT PAGE

- [Webinars Technical CoP](#)

All recorded meetings and webinars concerning **Damage Assessment** will be published on this page including the HNPW 2025 session : Striking the right balance: Rapid vs. Detailed Damage Assessments for Effective Shelter Programming.

*Note: viewing the recording on YouTube allows you to select the chapters of the session.*

**All resources** concerning this theme can be found on the [Technical Toolkit](#) page on the left menu.

#### Damage Assessment Technical Sub-CoP committee :

Pascal Panosetti - IFRC/GSC - [pascal.panosetti@ifrc.org](mailto:pascal.panosetti@ifrc.org) - chair

Regina Wenk - SDC/SHA, Shelter Expert Group - [regina.wenk@aarau.ch](mailto:regina.wenk@aarau.ch) - co-chair

Arnold Njogu - UNDP - [arnold.njogu@undp.org](mailto:arnold.njogu@undp.org) - co-chair

Mamuney Legesse Nigusse - IOM Ethiopia - [mnigusse@iom.int](mailto:mnigusse@iom.int) - co-chair

Showing 1–2 of 2 documents.



low bandwidth

#### MEETINGS +

##### Webinars Technical CoP

- **Damage Assessment - T.Sub-CoP**
- Emergency and Temporary Shelter Technical Specifications - T.Sub-CoP
- NFIs / EHIs technical specifications - T.Sub-CoP
- Durable Permanent Shelter & Housing - T.Sub-CoP
- Construction Good Practices / Build Back Better (BBB) - T.Sub-CoP
- Greener Shelter - T.Sub-CoP
- Fire Safety - T.Sub-CoP
- Hosting Assistance - T.Sub-CoP

#### TECHNICAL TOOLKIT +

- Technical Toolkit



**HNPW 2025\_SESSION REPORT\_ STRIKING THE RIGHT BALANCE\_ RAPID VS. DETAILED DAMAGE ASSESSMENTS\_GSC**

25 Mar 2025 · English · Shelter Cluster



**HNPW 2025 SESSION PRESENTATION : STRIKING THE RIGHT BALANCE: RAPID VS. DETAILED DAMAGE ASSESSMENTS FOR**

25 Mar 2025 · English · Shelter Cluster

# Technical Toolkit (resources)



In region Resources and in group Resources

## Technical Toolkit [Technical Toolkit webpage](#)

### Follow this toolkit

Dashboard

Documents (3)

### TECHNICAL THEMES +

- **Damage Assessment Resources**
- Emergency and Temporary Shelter Technical Specification Resources
- Durable Permanent Shelter & Housing (Sustainable Solutions) Resources
- Construction Good Practices / Build Back Better (BBB) Resources
- NFI/EHI Technical Specification Resources
- Greener Shelter Resources
- Fire Safety Resources
- Settlement Planning Resources

### ADDITIONAL RESOURCES +

- IEC Compendium
- Technical Resources curated
- Flood technical resources

### DAMAGE ASSESSMENT RESOURCES

Documents related to damage assessment

Showing 1–10 of 10 documents.

low bandwidth

 **EVALUATION DÉTAILLÉE DES DOMMAGES HAÏTI 2020 - MANUEL DE TERRAIN**  
Resources  
1 Aug 2025 · French · Shelter Cluster and Miyamoto International  
Technical Support and Design  
Assessment, Monitoring, and Evaluati... Technical Guidance

 **HOUSEHOLD AND BUILDING DAMAGE ASSESSMENT (HBDA) OVERVIEW - 2025**  
27 Jun 2025 · English · Shelter Cluster UNDP  
Technical Support and Design  
Assessment, Monitoring, and Evaluati... Technical Guidance

 **QUESTIONNAIRE HOUSING BUILDING DAMAGE ASSESSMENT (HBDA) - UNDP - VANUATU EARTHQUAKE 2024**  
1 Jun 2024 · English · Shelter Cluster UNDP  
Technical Support and Design  
Assessment, Monitoring, and Evaluati... Curated

 **RDNA STATE QUESTIONS\_UKRAINE CABINET OF MINISTERS - 2024**  
Bangladesh Flash Flood 2022  
1 May 2024 · English · Shelter Cluster  
Technical Support and Design  
Assessment, Monitoring, and Evaluati... Shelter Programming

 **REMOTE SENSING STRUCTURAL DAMAGE ASSESSMENT TO DETERMINE PROBABLE SHELTER NEEDS IN THE GAZA STRIP - 2024**  
Palestine  
7 Mar 2024 · English · Shelter Cluster and Miyamoto International  
Information Management Technical Support and Design

 **★ SHELTER DAMAGE AND NEEDS ASSESSMENT - FLASH FLOOD 2022**  
Bangladesh Flash Flood 2022  
15 Sep 2022 · English · Shelter Cluster  
Technical Support and Design

# Damage Assessment T.Sub-CoP ToR

[ToR Damage Assessment Technical Sub-CoP - V1](#)

# Damage Assessment T.S-CoP ToR

---

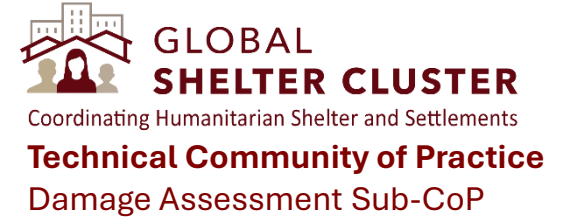

## BACKGROUND

- The **Damage Assessment T.S-CoP** is a **voluntary community** focused on technical aspects of shelter and settlements programming, with emphasis on damage assessment.
- **Open to all individuals**, regardless of agency or organizational affiliation.
- The group's strength comes from **active member participation**.
- Members contribute **knowledge and experience** from relevant roles and subject areas within the T.S-CoP

# Damage Assessment T.S-CoP ToR

---

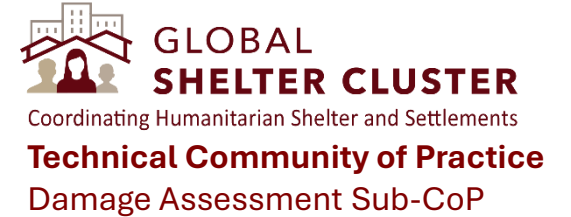

## BACKGROUND

- **Critical role:** Damage assessment is essential in humanitarian shelter and settlements after crises.
- **Purpose:** Provides accurate, timely data on destruction to guide priorities and resource allocation.
- **Value:** Informs planning and implementation of shelter solutions.
- **Impact:** Addresses immediate needs while supporting long-term recovery and resilience.
- **Local engagement:** Involving local experts ensures context-appropriate methods and sustainable responses

# Damage Assessment T.S-CoP ToR

---

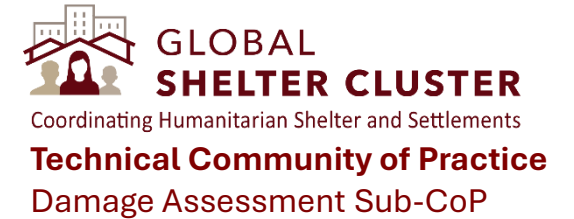

## OBJECTIVE AND SCOPE

- **Collaborative platform** for sharing knowledge, resources, and technical support in shelter and settlement programs.
- **Connects individuals, private sector, academia, donors, LNGOs, INGOs and agencies** to exchange experiences and collaborate.
- **Promotes accurate and efficient damage assessment methodologies** to ensure effective and sustainable humanitarian responses
  1. Provide guidance on damage assessment methodologies across different contexts (*flood, earthquake, conflict, etc.*).
  2. Strengthen technical capacity.
  3. Promote collaboration and coordination in damage assessments.
  4. Collect, develop\* and share tools and resources through the GSC Technical Toolkit.
  5. Advocate for context-specific approaches.
  6. Facilitate information sharing.
  7. Support country-level shelter cluster response in developing and reviewing damage and shelter needs assessments upon request.

# Damage Assessment T.S-CoP ToR

---

## PARTICIPATION AND MEMBERSHIP & RESPONSABILITIES

### 1. Active Member Participation

- Contribute to thematic presentations within sub-groups.
- Share experiences and resources (*e.g., tools, documents, designs*).
- Engage actively in meetings, webinars, and discussions.

### 2. Committee Chair & Co-chair Responsibilities

- Lead bi-weekly meetings to define topics, ToR, and workplans.
- Facilitate and co-organize meetings and webinars.
- Review, validate, and endorse shared resources.

### Join the Technical CoP :

- Create a GSC account on [www.sheltercluster.org](http://www.sheltercluster.org) webpage
- Click 'Follow' on the left-hand side of the [Technical Community of Practice](#) webpage
- Click 'Follow' on the left-hand side of the [Technical Toolkit](#) webpage to receive resources updates

# Damage Assessment T.S-CoP ToR

---

## FREQUENCY OF MEETINGS

- **Quarterly meetings/webinars** with the broader Damage Assessment Technical Sub-CoP members.
- **Bi-weekly meetings** with the committee co-chairs of the Damage Assessments T.S-CoP to manage the functions of the sub-group.
- **Quarterly meetings** with Technical Sub-CoP committees' members to coordinate, share and exchange information, lessons learnt and experiences.

## KEY LINKS – GSC WEBSITE

- Publication of Damage Assessment T.S-CoP meetings / webinars recordings and meetings notes classified on the left menu under "Meetings" of the T.CoP page : [Damage Assessment - T.Sub-CoP](#).
- Publication of all technical resources related to Damage Assessment available on the the Technical Toolkit : [Damage Assessment Resources](#).

# Topics and sub-topics survey results

# Topics and sub-topics survey results

## Damage Classification Topics of Interest

Respondents are mostly interested in Assessment methodologies, Damage classification standards, and Capacity building topics

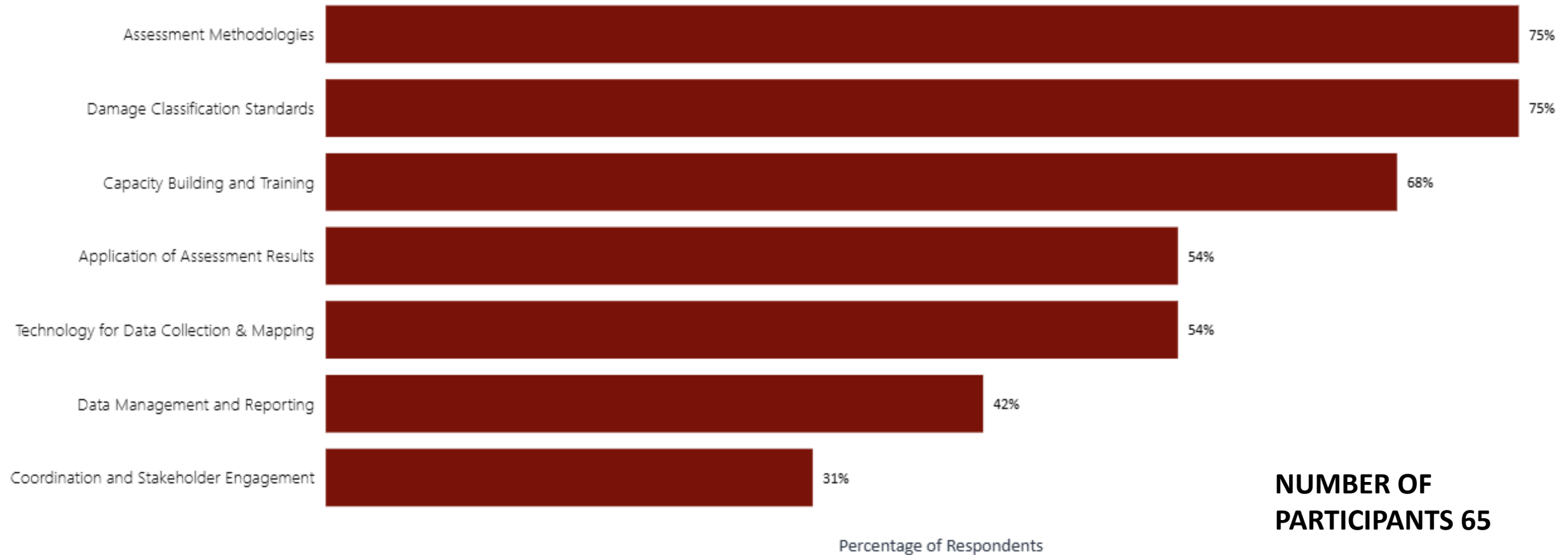

# Sub-topics of Interest

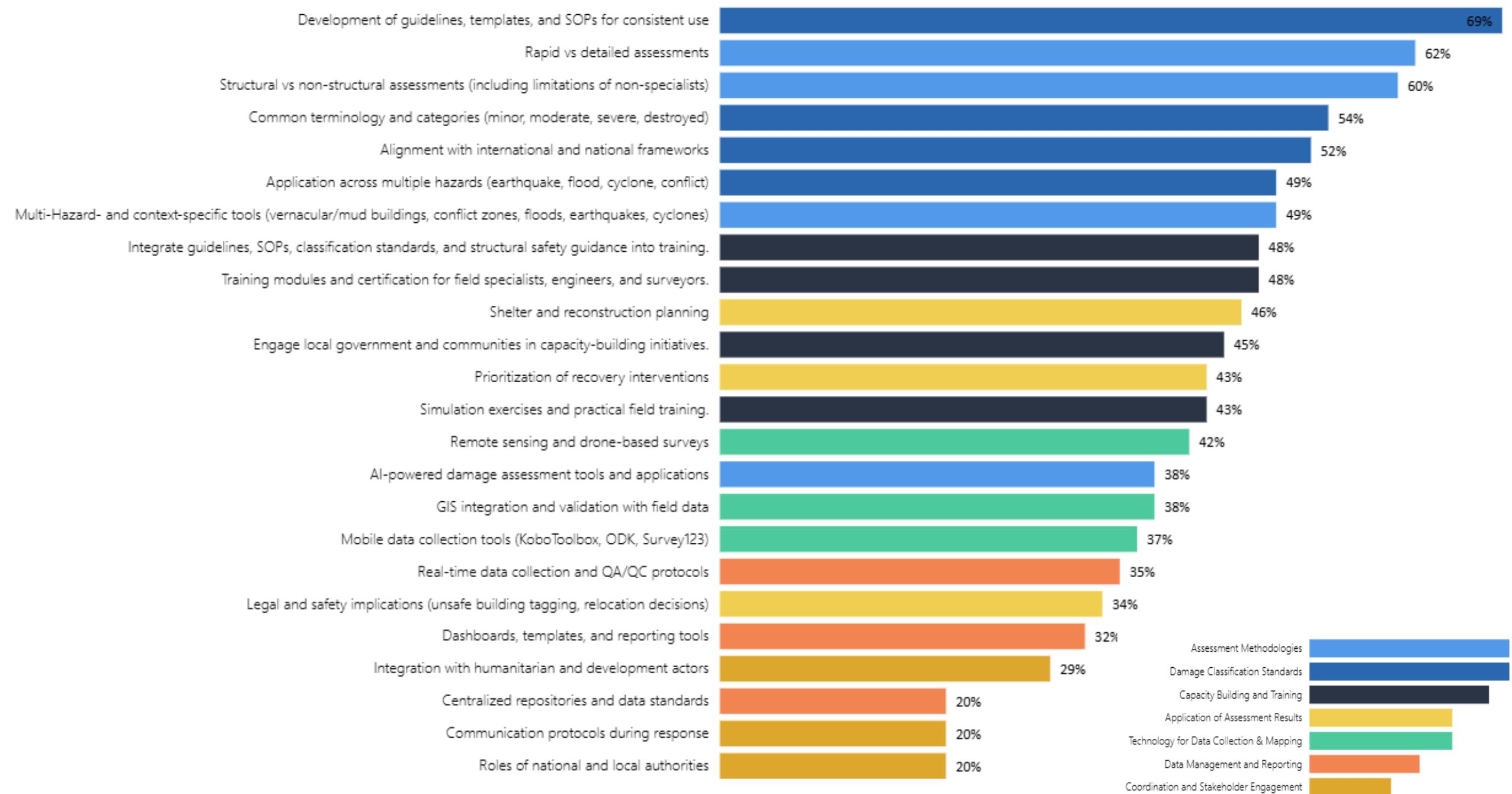

# Topics and sub-topics survey results

## Top 10 Sub-topics of Interest

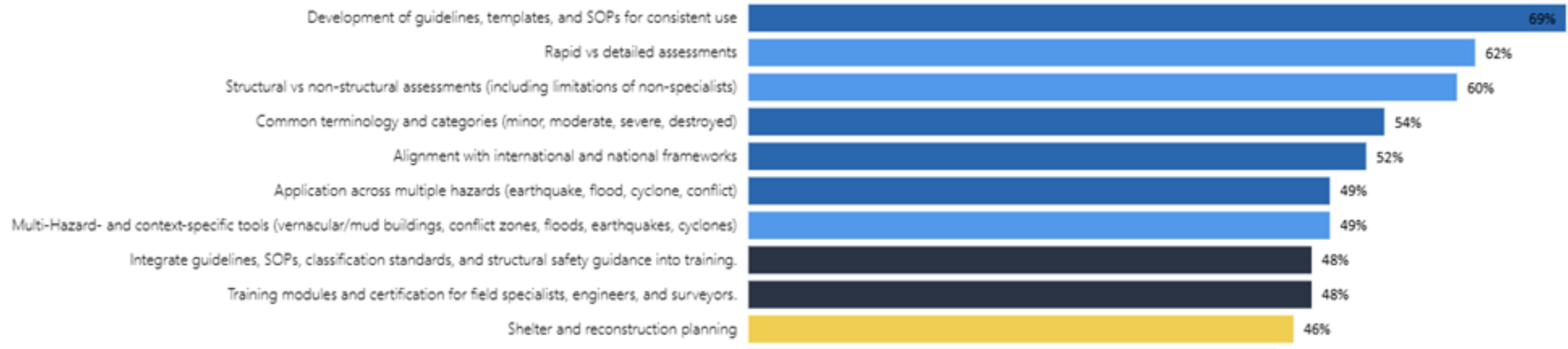



# Comments and suggestions survey results

---

## Do you have any comments, questions or suggestions concerning the damage assessment thematic sub-CoP? (Open-ended)

### 1. Define Scope & Clarity

- Clarify Purpose
- Define Audience

### 2. Enhance Knowledge Sharing & Resources

- Create a Resource Hub
- Record Sessions

### 3. Provide Training & Capacity Building

- Organized Trainings
- Case-Based Webinars

### 4. Foster Collaboration & Engagement

- Regular Meetings: Involve External Experts
- Joint Field Work

# PLENARY DISCUSSION

Questions, suggestions, comments, survey results feedback, any additional topics of interest and expectations for our community

# EasyRetro : Member's feedback

Survey feedback, additional topics, questions, suggestions and comments

---

Use the QR code



Or connect to

<https://easyretro.io/publicboard/yBBPzto15yZxfjHAnZ0kniTRgzO2/25ad1158-9aec-479e-8aee-8acc3ed3dd50>



[Damage Assessments Topics Survey](#)

<https://ee-eu.kobotoolbox.org/x/4jkaWyQ4>



**Deadline: Wednesday, 3 September 2025**



**Estimated Time: Max. 10 minutes**

# Easyretro on laptop

*Mention your name and any additional topics you would like us to cover, as well as any questions, suggestions and comments you'd like to share*

EasyRetro Feedback D.A. T.S-CoP meeting 28.08.25 Prime Directive Global Shelter Cluster

Mention any additional topics you would like us to cover, as well as any questions, suggestions, comments or questions you'd like to share

Search Sort by votes Add Share Settings

**Additional topics**

- Robert : Blast or bombing building Damage assessment  
Anonymous  
2 Jul 2 0
- Fatoumata : drone assessment  
Anonymous  
2 Jul 1 0
- Zina : damage assessment of building affected by flood  
Anonymous  
2 Jul 0 0

**Questions**

Type something... Save

Pascal : is it possible to .....?  
Anonymous  
2 Jul 2 0

**Suggestions**

Sahra : I would suggest the CoP could .....  
Anonymous  
2 Jul 0 0

**Comments**

Ahmed : xlkéajskjafsékafjkasfjsaklaksf  
Global Shelter Cluster  
26 Aug 0 0

Boubacar : I think that .....  
Global Shelter Cluster  
26 Aug 0 0

*Type your question, comment or suggestion by clicking on the "+" and mentioning your name before clicking "save."*

*Click "thumbs up" on the questions, comments or suggestion you prefer; the most selected will be prioritized.*

*You can add a comment to the question, comment or suggestion .*

Public

# Easyretro on mobile phone

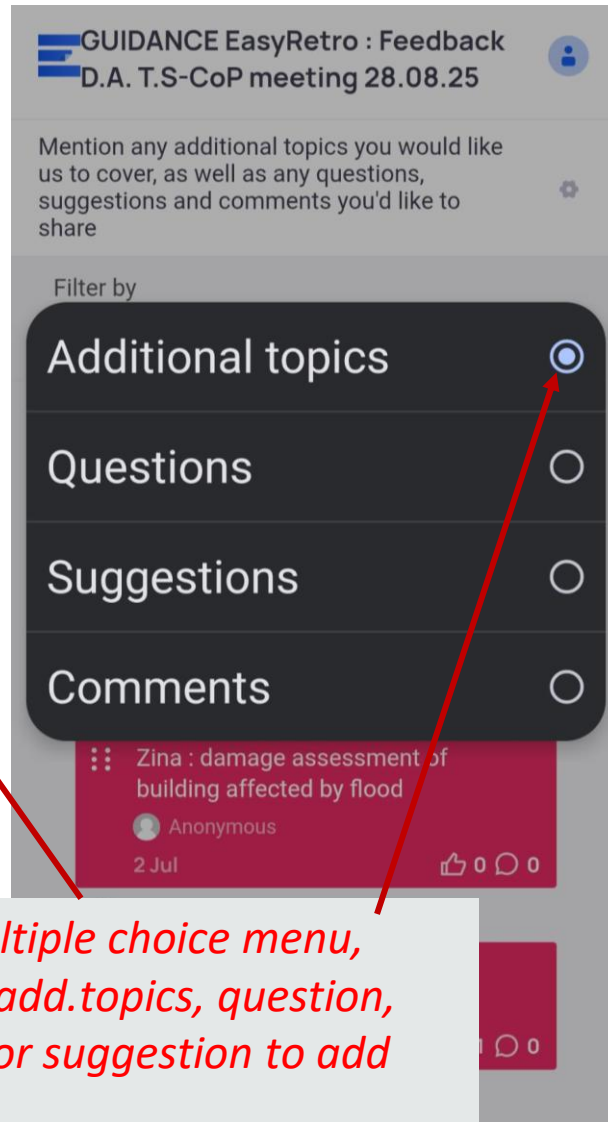
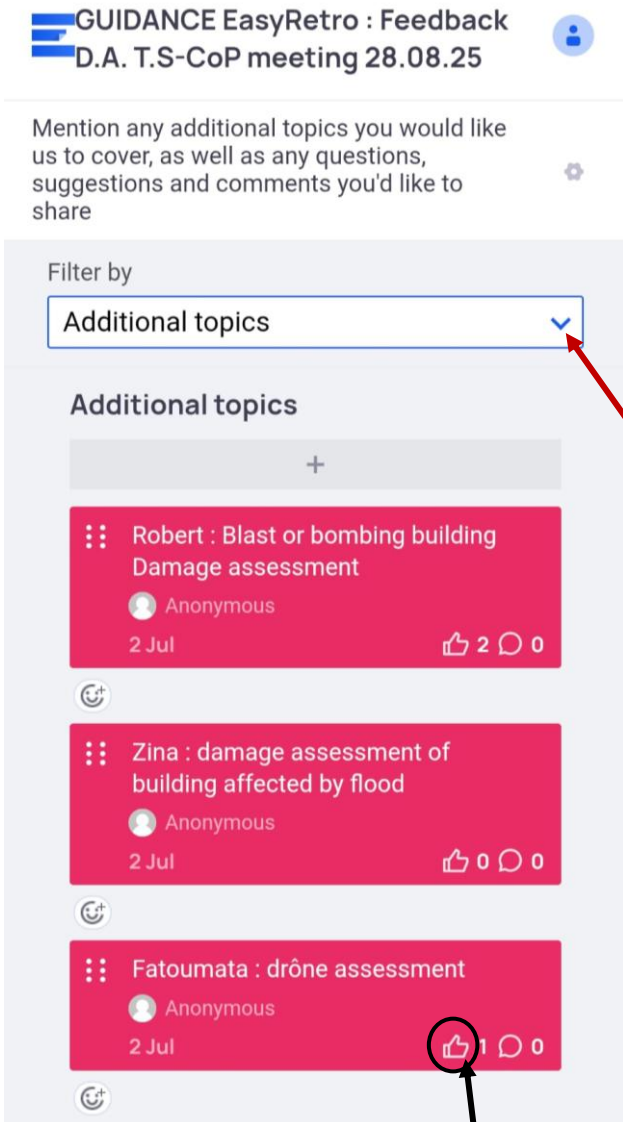

*On the multiple choice menu, select the add.topics, question, comment or suggestion to add your input*

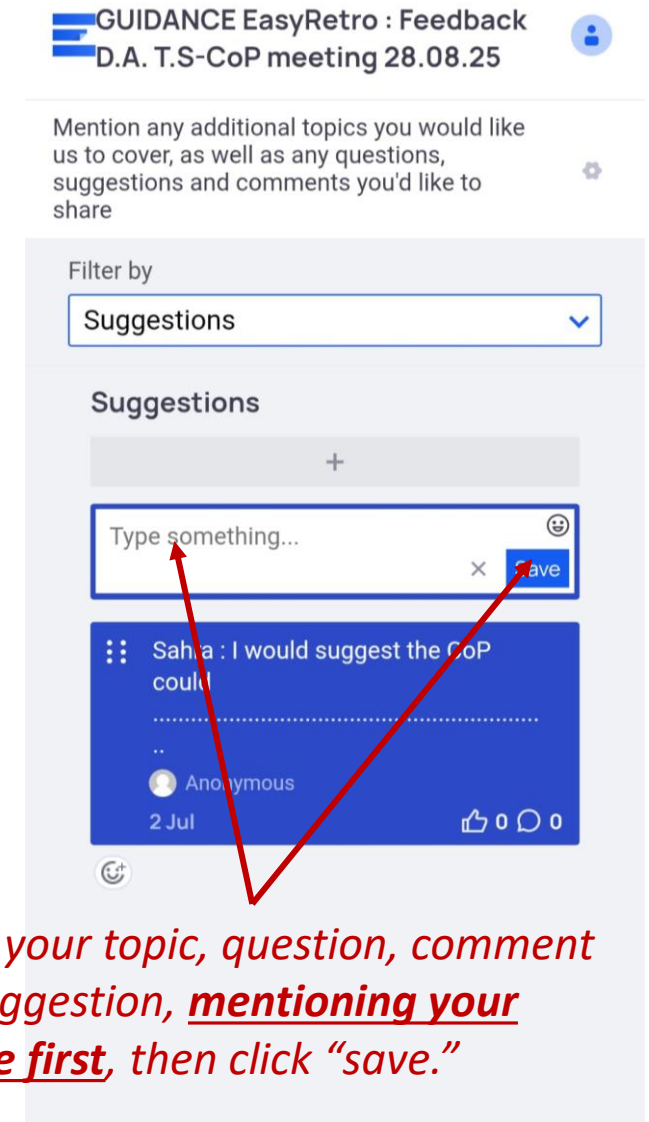

*Type your topic, question, comment or suggestion, mentioning your name first, then click "save."*

*Click "thumbs up"*



*on the questions, comments, or suggestion you prefer; the most selected will be prioritized.*



## EasyRetro access

<https://easyretro.io/publicboard/yBBPzto15yZxfjHAnZ0kniTRgzO2/25ad1158-9aec-479e-8aee-8acc3ed3dd50>



# PLENARY DISCUSSION

Questions, suggestions, comments, survey results feedback, any additional topics of interest and expectations for our community

# NEXT STEPS & REMINDER

# NEXT STEPS

---

- **Webinar in October 2025** (90 min) and **December or January**
  - Select the topics and sub-topic to cover
  - Collect member's interest to present and selection
  - Prepare, coordinate and conduct the webinar
- **Resources**
  - Collect tools and resources from DA T.S-CoP the members
  - Publish the curated resources on the Technical Toolkit
- **Suggestion from the T.S-CoP members ?**

# Reminder

---

## 1. Please complete the survey if not done yet:

 [Damage Assessments Topics Survey](https://ee-eu.kobotoolbox.org/x/4jkaWyQ4) <https://ee-eu.kobotoolbox.org/x/4jkaWyQ4>

 **Deadline: Wednesday, 3 September 2025**

 **Estimated Time: Max. 10 minutes**

## 2. D.A. T.S-CoP important links :

- [Technical Community of Practice](#)
  - [Damage Assessment - T.Sub-CoP.](#)
- [Technical Toolkit](#)
  - [Damage Assessment Resources.](#)
- [ToR Damage Assessment Technical Sub-CoP - V1](#)

# Technical CoP registration

**BEST OPTION :**  
**by creating a GSC**  
**account**

- Subscribe to the Technical CoP to receive **automatic** notifications, when new **Documents, Discussions, Events and News** are published.



[Technical CoP webpage](#)

**without and account**  
**not recommended !!**

You can also follow also of the [Technical Toolkit](#) > Click 'Follow' on the left-hand side of the page

In group Global Shelter Cluster

## Technical Community of Practice

Subscribe to **notifications** about this community of practice by creating an account or logging in (recommended).

**Sign up or log in**

Or enter your email address to subscribe without a user account

Panosetti Pascal

CAPTCHA

I'm not a robot

reCAPTCHA  
Privacy Terms

This question is for testing whether or not you are a human visitor and to prevent automated spam submissions.

**Subscribe without an account**

Dashboard
Documents (2)
Discussions (1)
Events (2)
News (4)

# AOB & closing



Technical  
Sub-Community of Practice  
**DAMAGE ASSESSMENT**

**THANK YOU**



**GLOBAL  
SHELTER CLUSTER**

Coordinating Humanitarian Shelter and Settlements

**Technical Community of Practice**