



**Shelter Cluster Yemen**  
ShelterCluster.org  
Coordinating Humanitarian Shelter

# Shelter Cluster Monthly Meeting

14<sup>th</sup> December 2021

14:00 PM – 16:00 PM

1. Review of Previous Meeting Action Points – 5 minutes
2. Quick review of SC Mission to Aden hub – 20 minutes
3. Exhibition and T shelter design, Shelter types 2021 – 15 minutes
4. 2022 HNO updates – 10 minutes
5. CERF and YHF updates – 10 minutes
6. CBI – The Survival Minimum Expenditure Basket – 5 minutes
7. SRP – Shelter Profiling Yemen – Craterre Univ. work – 5 minutes
8. Strategy - update on UNHCR discussions – 5 minutes
9. AOB (Shelter partner retreat dates discussion, CCPM) – 5 minutes

No.	Description of Action Point	By Whom	Update	Status
1	SCT to share with partners the draft methodology notes and indicators for 2022 HNO	SCT	The methodology is being revised to highlights two scenarios: A) if the MCLA was conducted, B) if there is no MCLA	Ongoing
2	SCT to develop the roadmap of the new multi-year strategy	SCT		Pending
3	SCT to inform partners on the shelter solutions exhibition opening	SCT		Done

# Review action points from previous meeting

## Shelter Cluster Coordination Structure (as of December 2021)

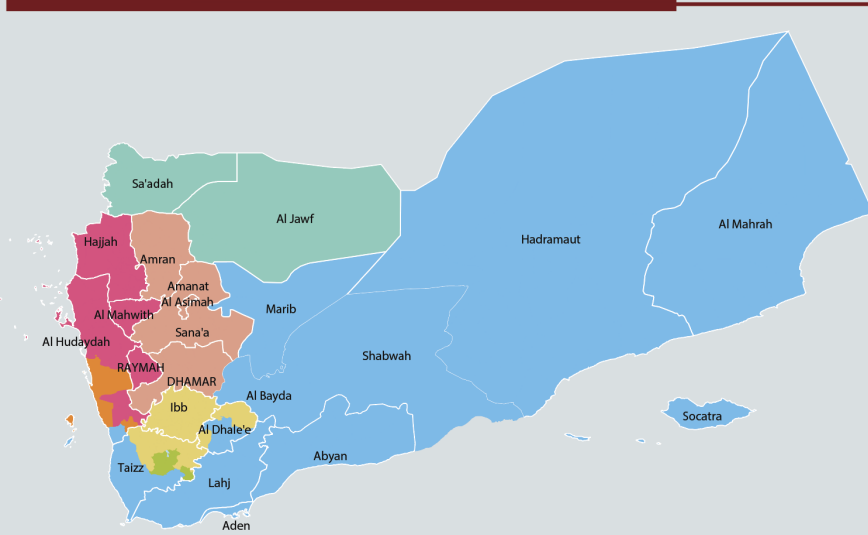

### National Cluster Coordination Team

**John Wain (UNHCR)**  
National Cluster Coordinator  
Mobile: +967712225166  
Email: [coord.yemen@sheltercluster.org](mailto:coord.yemen@sheltercluster.org)

**Monir ALSobari (UNHCR)**  
Deputy National Cluster Coordinator  
Mobile: +967712225045  
Email: [depcoord.yemen@sheltercluster.org](mailto:depcoord.yemen@sheltercluster.org)

**Ali Al-Eryani (UNHCR)**  
Information Manager  
Mobile: +967712225122  
Email: [im.yemen@sheltercluster.org](mailto:im.yemen@sheltercluster.org)

**Essam Al Washaly (UNHCR)**  
Technical Support Specialist  
Mobile: +967712225106  
Email: [tech.yemen@sheltercluster.org](mailto:tech.yemen@sheltercluster.org)

**Shared Locations**

- Taizz - Aden
- Al Hudaydah-Aden
- Sana'a-Aden



Update date: 13 Dec 2021 Sources: Cluster Coordination team. Feedback: [im.yemen@sheltercluster.org](mailto:im.yemen@sheltercluster.org) <http://www.sheltercluster.org> <https://www.humanitarianresponse.info> <http://reliefweb.int/>  
"The boundaries and names shown and the designations used on this map do not imply official endorsement or acceptance by the United Nations." Twitter: @ShelterClusterYE

## Mission schedule

22 days in the field

6 Governates – Aden, Taizz, Lahj, Al Dhalee, Abyan, Marib

Executive Unit and Governor meetings – 4

OCHA meetings – 4

Deputy HC – 1

Shelter/nfi cluster meetings – 4

IDP site visits – 15

IDP rental & collective centre locations - 5

Shelter Cluster Mission to Aden Hub 9-23 November 2021						
Date	Arrival Time	Departure Time	Duration of Activity	Activity	Venue	
11-Nov				Travel from Sana'a to Aden		
				Briefing session with UNHCR Head of Office + Security	UNHCR Aden Office	
				Meeting with the national ExU	Ex Unit Office -Aden	
12-Nov			9:00-10:00	Meeting with OCHA in Aden	UNHCR Office in Aden	
			10:00-12:00	Field visit to IDP sites	Al Shi'ab 1, Al Buraigah	
			14:00-16:00	Meeting with UN Deputy HC	UNHCR	
13-Nov	08:30	08:30	9:00-9:30	Visit a Shelter Cluster Common Pipeline Warehouse	Khurmaksar-Al Arish-Aden	
			9:30-15:00	Field visit to IDP sites in Lahj Governorate	Al Rebat IDPs Site, Tuban-Lahj Al Meshqafah IDPs site Tuban- Alteera IDPs site-Tuban Lahj	
14-Nov	07:00	07:30	7:00-11:30	Travel to West Coast		
	14:00	14:00	14:00-16:00	Internal Meeting between the team (Optional)	WFP Guesthouse Mukha	
15-Nov	07:00	07:30	8:30-10:00	Meeting with cluster partners and ExU Khawkhah FP	Ex Unit Office-Khawkhah	
			10:00-13:00	Field visit to IDP sites in South Al Hudaydah	Al-gasha, Al Khawkhah Al-irili, Al Khawkhah Khawkhah Khawkhah	
		13:15	13:15-14:15	Back To Mukha		
16-Nov	08:00	08:30	8:30-9:30	Meeting with cluster partners and ExU Mukha FP	GWQ Office	
		09:30	9:45-13:00	Field visit to IDP sites in Mukha district	Al Shatheli, Mukha Al Shahid Hamood, Mukha Al Sewais IDPs Site-Mukha	
		13:00	13:00-17:00	Back to Aden		
17-Nov	07:00	07:00	7:30-12:00	Travel to Al Turbah		
			13:00-14:00	Meeting with cluster partners and ExU Al Turbah	UNHCR Guest House	
			14:00-16:30	Field visit to IDP sites in Ash Shamyatin district	Al Qahfa Al Hamra2 IDP site in Dc	
18-Nov	07:00	07:30	8:00-13:00	Field visit to IDP sites in Ash Ma'afir district	Al Misar IDP site in Al Barakani s	
		13:00	13:15-17:00	Back to Aden		
19-Nov			14:00-16:00	Meeting with KSRC Representative	UNHCR GH	
20-Nov			7:00-8:00	Travel to Abyan		
			8:00-10:00	Field visit to IDPs hosting sites-Khanfir district	Joa Al Sadah-Al Wadi IDPs hosting	
			10:00-12:00	Meeting with Ex Unit/Local Authorities in Abyan	Al Musameer IDPs hosting site	
21-Nov			7:00-11:00	Travel to Al Dhalee	Abyan Governor Office	
			11:00-12:00	Field visit to IDPs hosting sites-Al Dhalee district	Al Jomrook IDPs site-Al Dhalee Assaqah IDPs sites	
			12:00-13:00	Meeting with Ex Unit/Local Authorities in Al Dhalee	Al Dhalee Governor Office	
22-Nov	Mon	08:00	12:00	n/a		
				Travel from Aden to Marib		
23-Nov	Tue	08:00	08:30	9:00-11:00	Meeting with Ex Unit/local authorities in Marib City	Deputy Governor Office
			13:00	14:00-16:00	Field visit to IDP sites in Marib City	Al-Jufaina
24-Nov	Wed	08:00	08:30	10:00-12:00	Meeting with Partners in Marib City	Louver Basement Hall
			14:00	14:00-16:00	Meeting with OCHA in Marib	OCHA Office
25-Nov	Thu	08:00	08:30	9:00-13:00	Field visit to IDP sites in Marib City	Al-Sowayda Alrawdha Aljadedda Istanbul
26-Nov	Fri	08:00	08:30	9:00-13:00		
27-Nov	Sat	08:30	08:30	9:00-14:00	Field visit to IDP sites in Al Wadi district	Alkharashi Altdamon Alsit
28-Nov	Sun	08:30	9:00-13:00	Field visit to IDP sites in Al Wadi district	Aleiq Alsharqi	
			14:00-16:00	Internal Meeting between the team	UNHCR Office in Marib	
29-Nov		08:00	12:00	Travel from Marib to Aden		
30-Nov			7:00-11:00	Field visit to Lawdar district	Am Surah-Lawdar	
			11:00-13:00	Field visit to Lawdar district	Al Nagdah-Amhodhn site	
01-Dec			10:00-12:00	Meeting with SN Shelter/NFIs cluster partners	UNHCR Aden Office	
			14:00-16:00	Debriefing session with UNHCR Head of Office	UNHCR Aden Office	
02-Dec	08:00	12:00		Travel from Aden to Sana'a		

## Mission schedule

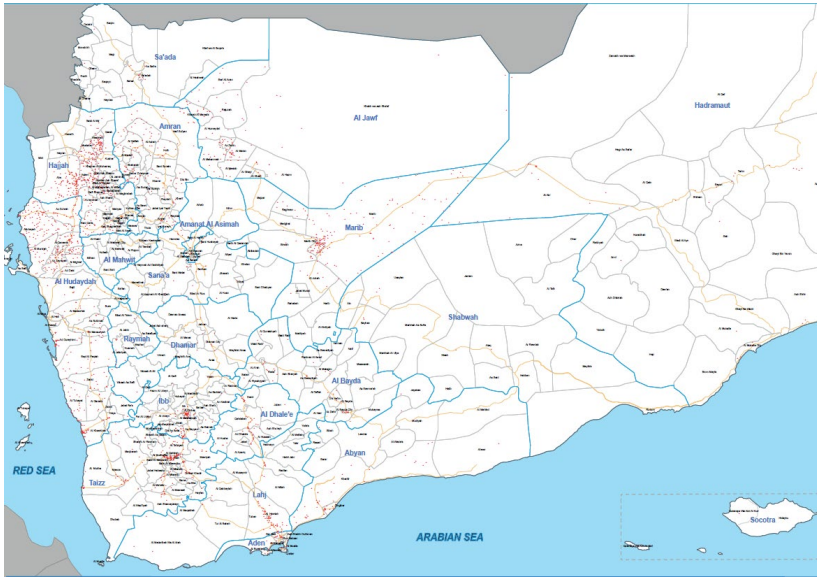

## Local Authority and funding

- Emergency shelter (es) solutions need improving / upgrades
- More durable solutions necessary – T shelter
- Promotion of available options – exhibition
- Localised solutions
- Tent quality
- EXU displacement figures V DTM disparity e.g. Marib 14000 h/h v 4500 h/h
- Positioning of NFI pipeline stocks closer to displaced locations
- Winterization – flooding
- Security of tenure – HLP
- Cash for rent – conditional e.g. rental agreements
- Priority – Food, WASH, Shelter/NFI

## HUMANITARIAN RESPONSE PLAN FUNDING RECEIVED BY CLUSTER

*US\$ million*

Sector/Cluster	Overall covered	Funding Received	Requirements	Unmet Funding
FSAC <sup>1</sup>	61%	1,041	1,708	667
Nutrition	54%	238	442.9	204.9
Health	21%	90.1	438.8	348.7
WASH <sup>2</sup>	14%	45.8	330.7	284.9
Education	35%	90.1	257.8	167.7
Protection	41%	88.6	218	129.4
Shelter and NFI <sup>3</sup>	18%	38	207.6	169.6
CCCM <sup>4</sup>	9%	5.2	61.3	56.1
Refugees & Migrants <sup>5</sup>	5%	2.8	58.7	55.9
Logistics	47%	24	51.2	27.2
RRM <sup>6</sup>	19%	7.1	37.6	30.5
Coordination	90%	33.9	37.5	3.6
Emergency Telecom.	+100%	3.4	3.3	-
Multiple Field clusters		171.3	NA	NA
Unspecified clusters		331.2	NA	NA

## Observations

- Data idps in sites 1.3 m in 2000 sites where are the balance 2.7 m
- No camp policy in Yemen 2015?
- Emergency shelter jaded – upgrades
- NFI & bedding kits
- Security of tenure

### Site assessment Checklist

#### Notes:

#### Guidelines

Red lines are alerts flagging critical issues rendering the site unsuitable for development.

Orange lines are alerts flagging that heavy mitigation activities will be required to enable development of the site.

#### 1 INFORMATION

1.1 Response / Operation:	Al Jubah Displacement Response (Marib)
1.2 Government counterpart:	EXU
1.3 Assessment team:	Sub National Shelter Cluster Team
1.4 Date:	25 November 2021
1.5 Prepared by:	Saleem Al <del>Al</del> & Abdullah <del>M</del>

#### 2 KEY PLANNING FIGURES

2.1 # of refugees / IDPs / Planning figures:	63 HHs
2.2 Average No. of people per HH:	5
2.3 # of shelter planned to be distributed:	34 of family Tents
2.4 What is the type and dimensions of the shelter?	Family Tents (6*4 m)

#### 3 SITE LOCATION

3.1 Site name:	Al <del>Al</del> site
3.2 GPS Coordinates:	15.438218, 45.344739
3.3 District:	Marib city

#### 4 SUMMARY OF ASSESSED RED LINES AND ORANGE LINES

Red lines are alerts flagging absence of critical elements to enable the development of the site

4.1 Is there any information about potential existence of land mines and UXOs within and/or near this site?	Yes <input checked="" type="checkbox"/> )	No <input type="checkbox"/> )
4.2 Is this site vulnerable to significant security risks?	Yes <input checked="" type="checkbox"/> )	No <input type="checkbox"/> )
4.3 Is road and route access compromised for the provision of humanitarian life-saving assistance all year round?	Yes <input checked="" type="checkbox"/> )	No <input type="checkbox"/> )
4.4 Is access to sustainable and sufficient water source(s) compromised?	Yes <input checked="" type="checkbox"/> )	No <input type="checkbox"/> )
4.5 Does historical data indicates that the area is prone to natural disasters or flooding?	Yes <input checked="" type="checkbox"/> )	No <input type="checkbox"/> )

Orange lines are alerts flagging that heavy mitigation activities will be required to enable the development of the site

4.6 Is the travel distance between the proposed site and existing health facilities greater than 7 Km?	Yes <input type="checkbox"/> )	No <input type="checkbox"/> )
4.7 Is the travel distance between the proposed site and existing primary education facilities greater than 2 Km?	Yes <input type="checkbox"/> )	No <input type="checkbox"/> )

### Site assessment Checklist

4.8 Is the travel distance between the proposed site and existing markets and commercial centres greater than 7 km?	Yes <input type="checkbox"/> )	No <input type="checkbox"/> )
4.9 Is the percentage of the slope indicating a flat (0%-2%), steep (6%-8%) or severe topography (> 10%)	Yes <input type="checkbox"/> )	No <input type="checkbox"/> )
4.10 Is the soil assessed indicating sand or rock soil type?	Yes <input type="checkbox"/> )	No <input type="checkbox"/> )
4.11 Is the water table less than 3 meters below the ground level?	Yes <input type="checkbox"/> )	No <input type="checkbox"/> )

#### 5 CONCLUSIONS AND RECOMMENDATIONS

4.1 Is this site suitable?	Yes <input type="checkbox"/> )	No <input type="checkbox"/> )
4.2 What is the capacity of the existing site? Elaborate on critical considerations and assumptions for the capacity definition.	The capacity of site will be enough to host 34 HHs	
4.3 Is the space sufficient to add a shelter to the site and how many can be added if the shelter is 6 meters long, 4 meters wide, and with distances of not less than 3 meters between each shelter	Yes, for 34 tents	
4.4 Who owns the land and is there any objection from the landowner to adding shelter to the site?	The landowner allowed to use this land (informed by Ex unit)	

## 1. Emergency shelter Kits

**Contexts:** newly displacement

**Size:** 3m\*5m (15m<sup>2</sup>) for 4-5 family members

**Material:** Wood framed wall covered by plastic sheet

**Time to Build:** half day

**Life Span:** 6 months

**Construction Team:** 1 skilled and 1 labourer

**Cost:** \$250



## 2. Transitional Shelter

**Type 1** – Mud & Khazaf walls with Halfa roof.

**Contexts:** Hot Climate (35°-40°)

**Area:** Such as Hodidah and Hajjah

**Size:** 3.55 m\* 6 m (21m2) for 7 family members

**Material:** Wood framed structure with walls covered by (Mud and Khazaf with Galvanized Metal Mesh), Wooden Roof (covered by plastic sheet and local material- Halfa).

**Time to Build:** one day and half

**Life Span:** 3-5 Years

**Construction Team:** 1 skilled and 3 general laborers

**Cost:** \$870 - For the modified design (shelter pilot should be done before the final approval)



## Technical Drawing

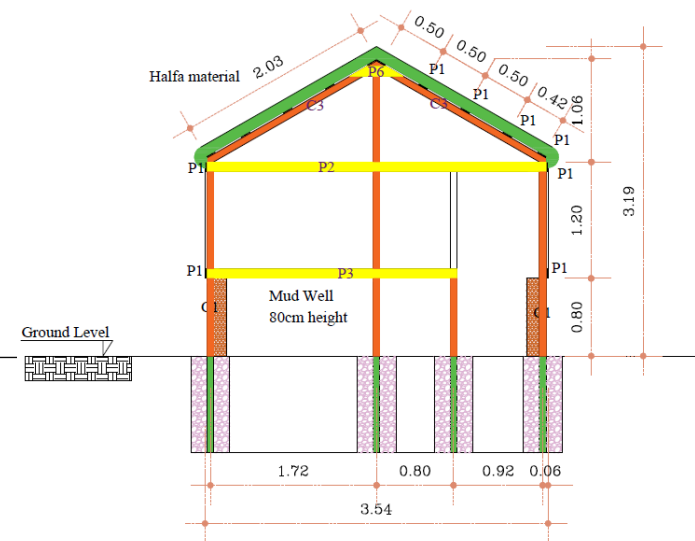
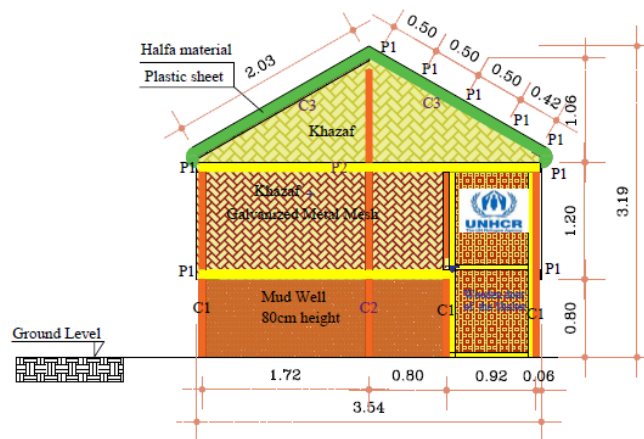
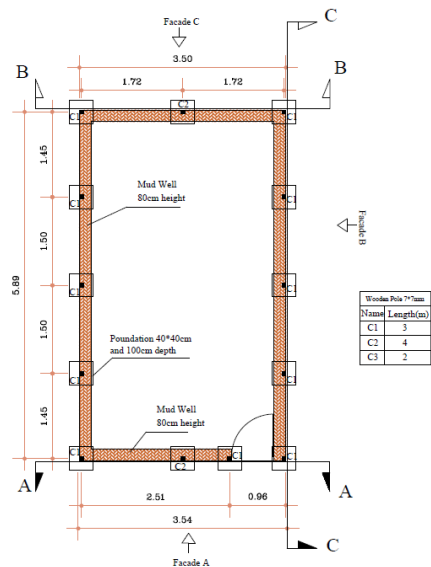

## 2. Transitional Shelter

**Type 2** – Mud & polywood & Khazaf walls with Halfa roof.

**Contexts:** Hot Climate (35°-40°)

**Area:** Such as Hodidah and Hajjah

**Size:** 3 m\* 5 m (15m<sup>2</sup>) for 6 family members

**Material:** Wood framed structure with walls covered by (Mud+plywood and Khazaf with Galvanized Metal Mesh), steel bars Roof (covered by plastic sheet and local material- Halfa)

**Time to Build:** one day

**Life Span:** 3-5 Years

**Construction Team:** 1 skilled and 3 general laborers

**Cost:** \$821



nnex 4

## Technical Drawing

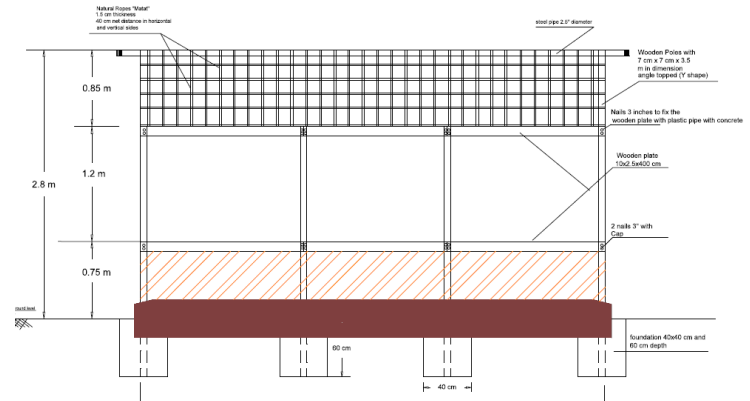
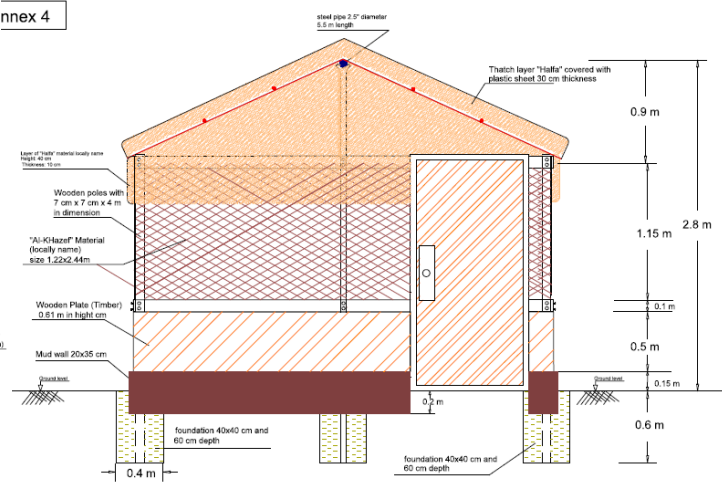
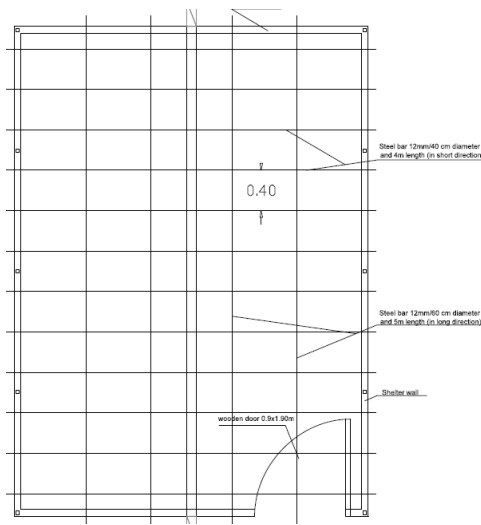

## 2. Transitional Shelter

**Type3** - Mud block and plywood walls with CGI roof.

**Contexts:** Temperate climate (25°)

**Area:** Such as Sana'a, Amran and Dhamar

**Size:** 3.55 m\* 6 m (21m2) for 7 family members

**Material:** Wood framed structure with walls covered by (Mud wall and Plywood panels), Wooden Roof (covered by Iron Sheets).

**Time to Build:** one day

**Life Span:** 3-5 Years

**Construction Team:** 1 skilled and 2 general laborer's

**Cost:** \$895 - For the modified design (shelter pilot should be done before the final approval)



## Technical Drawing

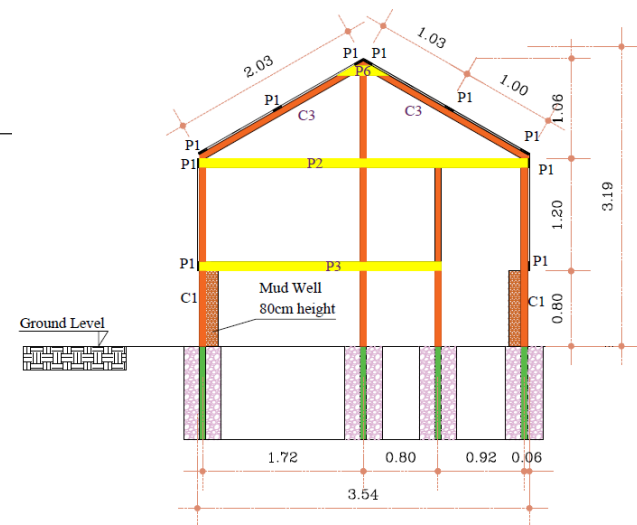
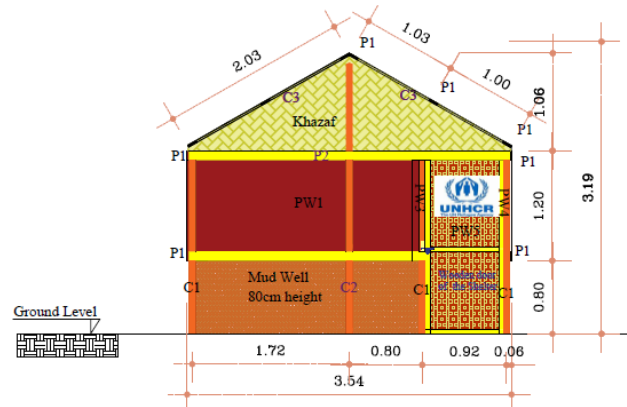
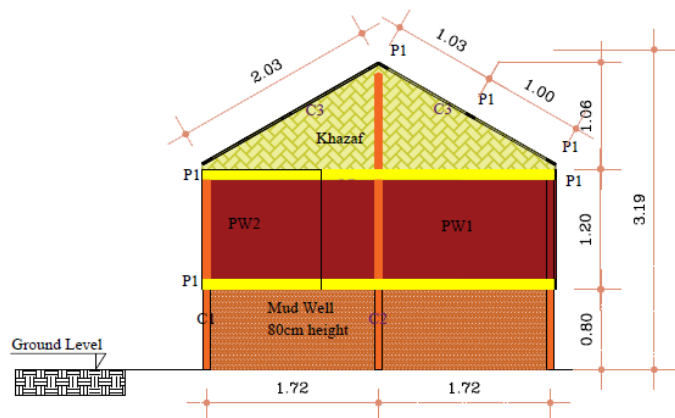
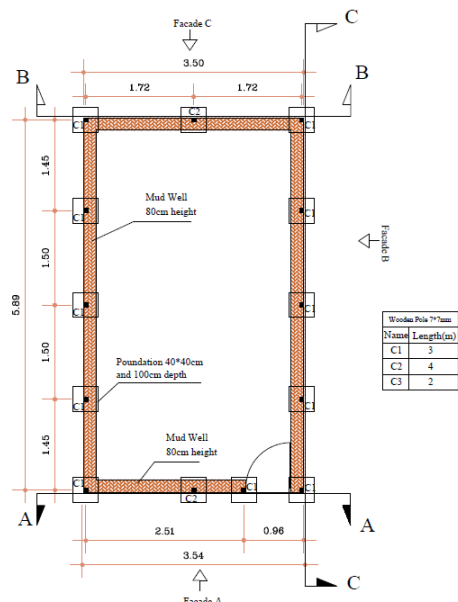

- Shelter solutions exhibition in Aden and Marib still in progress

- Methodology notes is being revised to reflect two scenarios in case the MCLA did not go through
- Population Taskforce Working Group still working on the projected population of Yemen for 2022 including IDPs
- MCLA still pending

## YHF 2<sup>nd</sup> SA Priority 1:

- Total allocation fund: \$ 37 M
- Shelter Cluster: \$ 6.5 M
- Total number of projects for the priority: 38
- Locations: Al Hudaydah (Al Khukha, Az Zuhrah and Bayt Al Faqih), Marib (Marib, Marib City, Sirwah and Rahbah districts), Shabwah (Ataq and Nisab districts), Taiz (Al Mukha, Dhubab, Jabal Habashi and Maqbanah districts)
- Activities: Non-Food items, Emergency Shelter, Shelter maintenance, transitional shelter and flood prevention

## YHF 2<sup>nd</sup> SA **Priority 2:**

- Total allocation fund: \$ 6.5 M
- Shelter Cluster: \$ 1.56 M
- Total number of projects for the priority : 6
- Locations for Shelter Cluster: Taizz (Al Qahirah and Al Mudhaffar) and Al Jawf (Al Hazm district)
- Activities: Rehabilitation of houses

## SMEB BASED TRANSFER VALUE NORTH

Sector	Item	Quantity for a family of 7 per month	Unit	Price monitoring (Yes/No)	Price per item	Cost of Commodity /Family per Month (YER)	Buffer/ Top up	Total Cost per Commodity	Totals
NFI/ Shelter	(Cooking Oil, Rent, other NFI/ recurring costs)	1	Lump sum	KAP Survey	25000	25,000.00	10%	27,500	YER 28,000
<b>Total</b>								<b>Rounded off value</b>	<b>YER 28,000</b>

SMEB BASED TRANSFER VALUE SOUTH									
Sector	Item	Quantity for a family of 7 per month	Unit	Price monitoring (Yes/No)	Price per item	Cost of Commodity /Family per Month (YER)	Buffer/ Top up	Total Cost per Commodity	Totals
NFI/ Shelter	(Cooking Oil, Rent, other NFI/ recurring costs)	1	Lump sum	KAP Survey	28750	28,750	10%	31,625	YER 32,000
<b>Total</b>								<b>Rounded off value</b>	<b>YER 32,000</b>

CRATERre, together with interested partners, including the Global Shelter Cluster, IFRC, CARE, AE&CC Laboratory (University of Grenoble), CENDEP (Oxford Brookes University), and UNHCR among others, has been working for several years on developing a methodology to identify Local Building Practices, in particular looking at their contribution to Disaster Risk Reduction (DRR). The aim is to facilitate the identification of the strengths and weaknesses of these practices and the opportunities they offer, to make the best use of them – in an adapted version if necessary – in shelter reconstruction, retrofitting or improvement projects. SRPs constitute part of a collection of documents and resources promoting the theme of “Local Building Cultures for sustainable and resilient habitats”. Since 2016, eight SRPs have been produced (Fiji, Ecuador Coastal region, Haiti, Bangladesh, Ethiopia, East of the Democratic Republic of Congo, Tonga -in progress-, and Malawi -in progress-).

The below table summarized the activity matrix for 2022

#	Activity	Definition	Modality of Implementation	Cost (USD) per kit/HH
1	Household NFI Kit	Provision of essential household items such as Blankets +Mattresses+Kitchen Sets+ Bucket+Cooking Stoves+sleeping mat+Solar Lamps	In-kind, Cash and Voucher	\$175-200
2	Winterization support	Provision of essential household items such as winter cloathing+high thermal blankets & Shelter insulation activities, focusing on roof + cladding	In-kind, Cash and Voucher	\$200-300
3	Shelter maintenance and upgrades	Basic maintenance / upgrade of sub-standard shelter in IDP hosting sites or collective centers including (but not limited to) repairing walls & roofs, fixing broken doors & windows, installing locks, works needed to ensure safety and security as well as protection from harsh climatic conditions.	In-kind preferred, Cash and Voucher	\$100-200
4	Cash for Rent	Securing adequate shelter as a response for most vulnerable families displaced in an urban or peri-urban context. Families not able to afford the rental payment or facing eviction threats. Conditional cash grant matching average rent in the location based on a proper market assessment.	Cash	\$100 per month (average)

#	Activity	Definition	Modality of Implementation	Cost (USD) per kit/HH
5	House Rehabilitation (minor works)	House rehabilitation works including (but not limited to) minor structural repairs, roof, cladding, window and door repairs, partial insulation, basic sanitation (excluding any major structural elements, finishes or expansions)	Cash or contractor or mixed modality	\$2000 to \$2500
6	House Reconstruction (major works)	House reconstruction works including (but not limited to) structural repairs, roof, cladding, window and door repairs, reconstruction of parts of the structure. Concrete column, beams, slab and appropriated retrofitting for the structure. Average 10 to 12 m2 per person (gross surface) insulated with sanitation.	Cash or contractor or mixed modality	Up to \$5000 - 7500
7	Flood Mitigation Basic Work	Flood mitigation support including (but not limited to): Shelter level, sandbag and localised drainage solutions. Site level, drainage and basic flood prevention support.	In-kind or cash	\$ 75 - 150
8	Emergency Shelter Type one : emergency shelter Kits Type two: Tahama emergency shelter kits	Provision of emergency shelter kits with 15m2 surface area. Materials provided include Plastic Sheets, Saw, Hammer, Pickaxe, Sisal Rope, Nylon Rope, Nails Box, Wooden Plate, Wooden Plates (Timber), Metal Pegs and Utility Knife.	In-kind	Type one \$250 Type two \$400

#	Activity	Definition	Modality of Implementation	Cost (USD) per kit/HH
10	Housing, Land and Property counselling and legal assistance	Mitigate eviction process in sites or individual accommodation. Counselling on relocation, legal advise for return/reconstruction.	N\A	
11	Family Tents	Tents may be distributed in exceptional conditions during emergencies as a last resort following pre-requirements of the tent distribution policy	In-kind	\$400

(i) prices are not taking account of any implementation and overhead

(ii) max. operational cost 30% for in-kind assistance and 15% cash modality

(iii) due to location and important price variation, average must probably be recalculated per city at the beginning of the projec

1. Shelter partner retreat dates discussion
2. CCPM

# Thank You

Materials of this meeting are available at:

<https://www.dropbox.com/sh/nkzl428ohtmg9pi/AADi4XXwb-ro9Ky9OQBGJvQma?dl=0>

More Info.:

<https://www.sheltercluster.org/response/yemen>

Follow us on Twitter:

**@ShelterClustYE**