

POLARSIRKELEN

DYNAMISKE SPORTSKYTTERE

MATCHBOOK

Matchname

NNM Rifle - PDS - Mo i Rana

Discipline

Rifle

Region

Norway

City

Mo i Rana*

Club

Polarsirkelen Dynamiske Sportskyttere

Match Dates

Prematch: 1. September

Main Match: 2. September

*

The match takes place near Storforshei, about 25km North of Mo i Rana.

Drive towards Storforshei and take off towards Arctic Circle Raceway and follow the signs from the main gate. A rough map is also attached to this document.

All pictures are guidelines only. Stage may differ from picture provided.

Ranges will be given in briefing on matchday.

SPONSORS FOR THIS MATCH IS



To get to the range drive North from Mo i Rana towards Storforshei. Turn off towards Arctic Circle Raceway. When you get to the main gate follow the IPSC targets that we will have placed. There is also a reference map below.



Here is a brief overlook of our areas and where you can park when at the range.



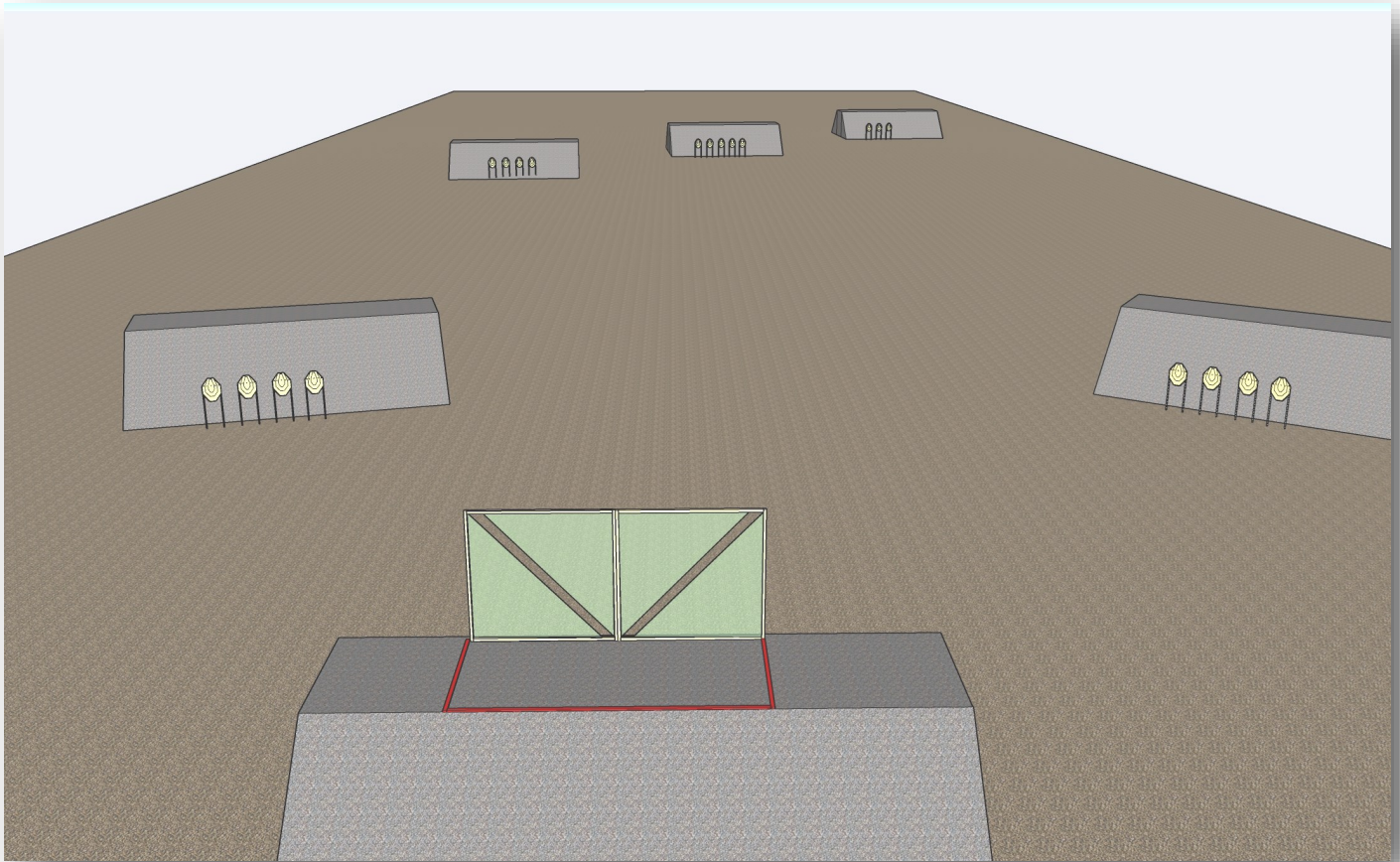

TARGETS:	20 IPSC Mini targets
ROUNDS TO BE SCORED:	40
START POSITION:	Anywhere
RIFLE READY CONDITION:	Option 1
TIME STARTS:	Audible signal
PROCEDURE:	Engage all targets through apertures. Color of aperture shows which target group can be engaged.
SAFETY ANGLES:	Indicated by marks

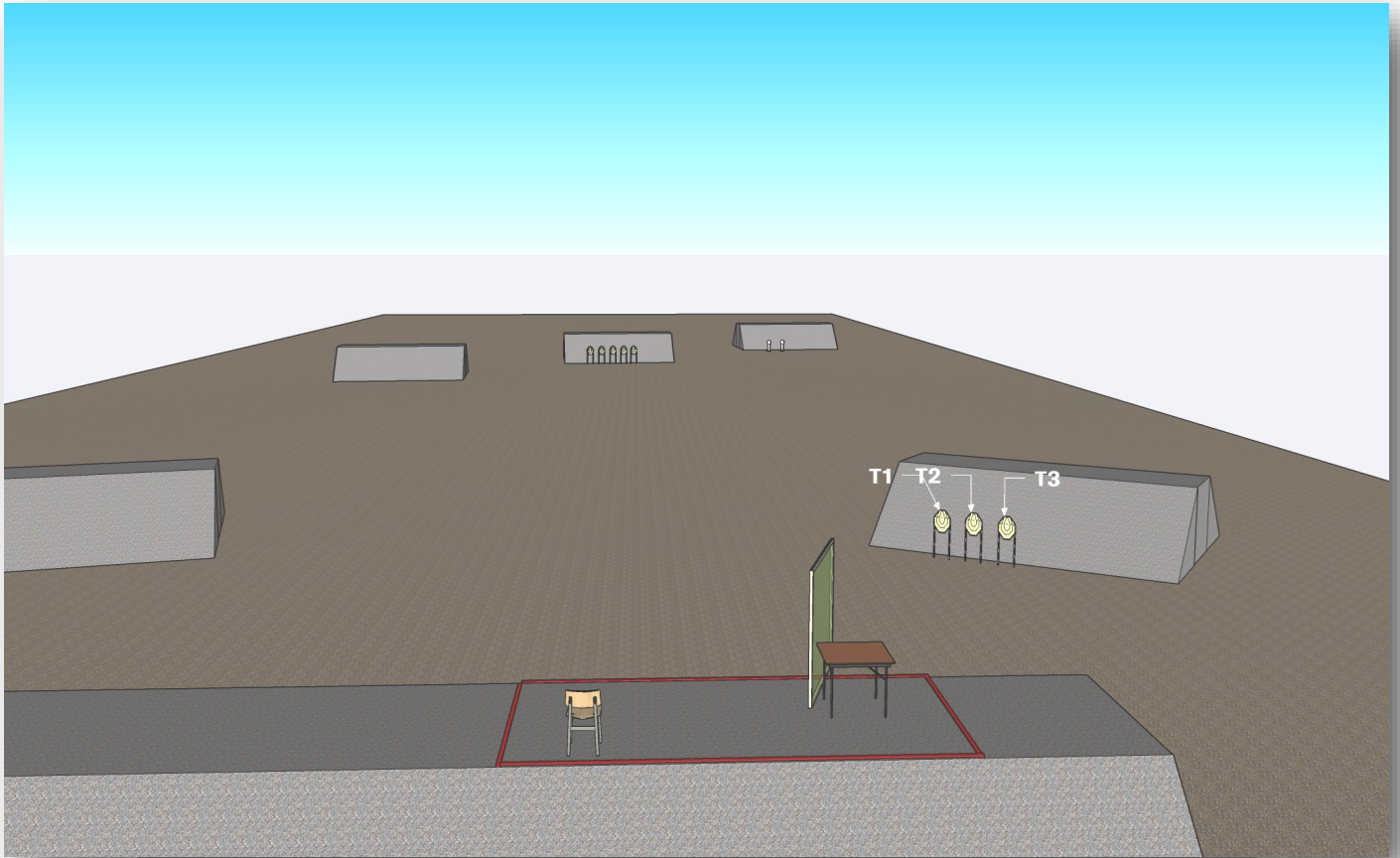

TARGETS:	8 IPSC Mini targets. 2 Mini poppers
ROUNDS TO BE SCORED:	18
START POSITION:	Sitting on chair as demonstrated by RO
RIFLE READY CONDITION:	Option 2
TIME STARTS:	Audible signal
PROCEDURE:	Engage all targets as they become visible. Target T1 -T3 must be shot sitting on chair. Popper P1 and P2 must be shot over the table.
SAFETY ANGLES:	Indicated by marks L\R

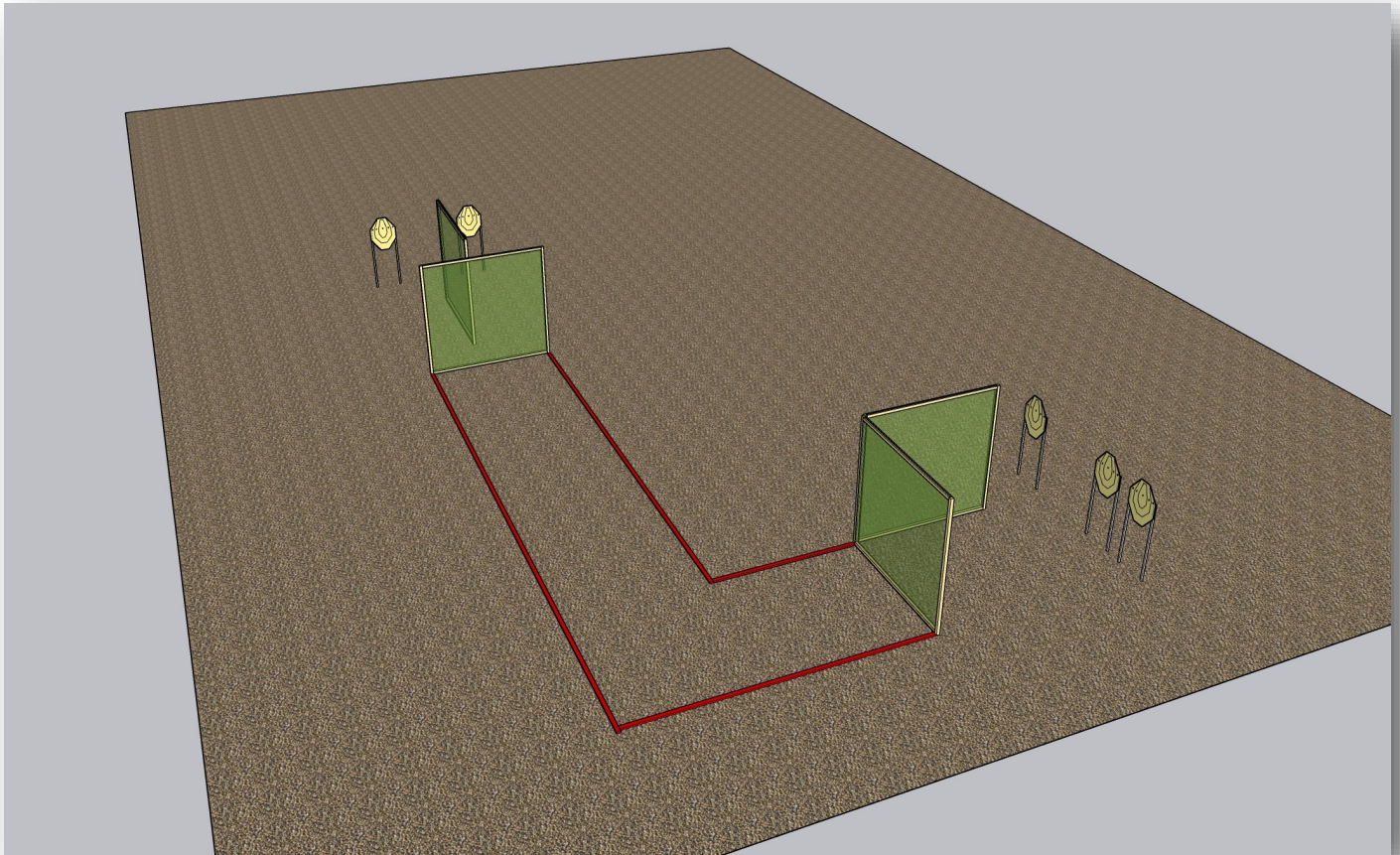

TARGETS:	5 IPSC Mini targets
ROUNDS TO BE SCORED:	10
START POSITION:	Anywhere
RIFLE READY CONDITION:	Option 1
TIME STARTS:	Audible signal
PROCEDURE:	Engage all targets as they become visible
SAFETY ANGLES:	Indicated by marks L\R

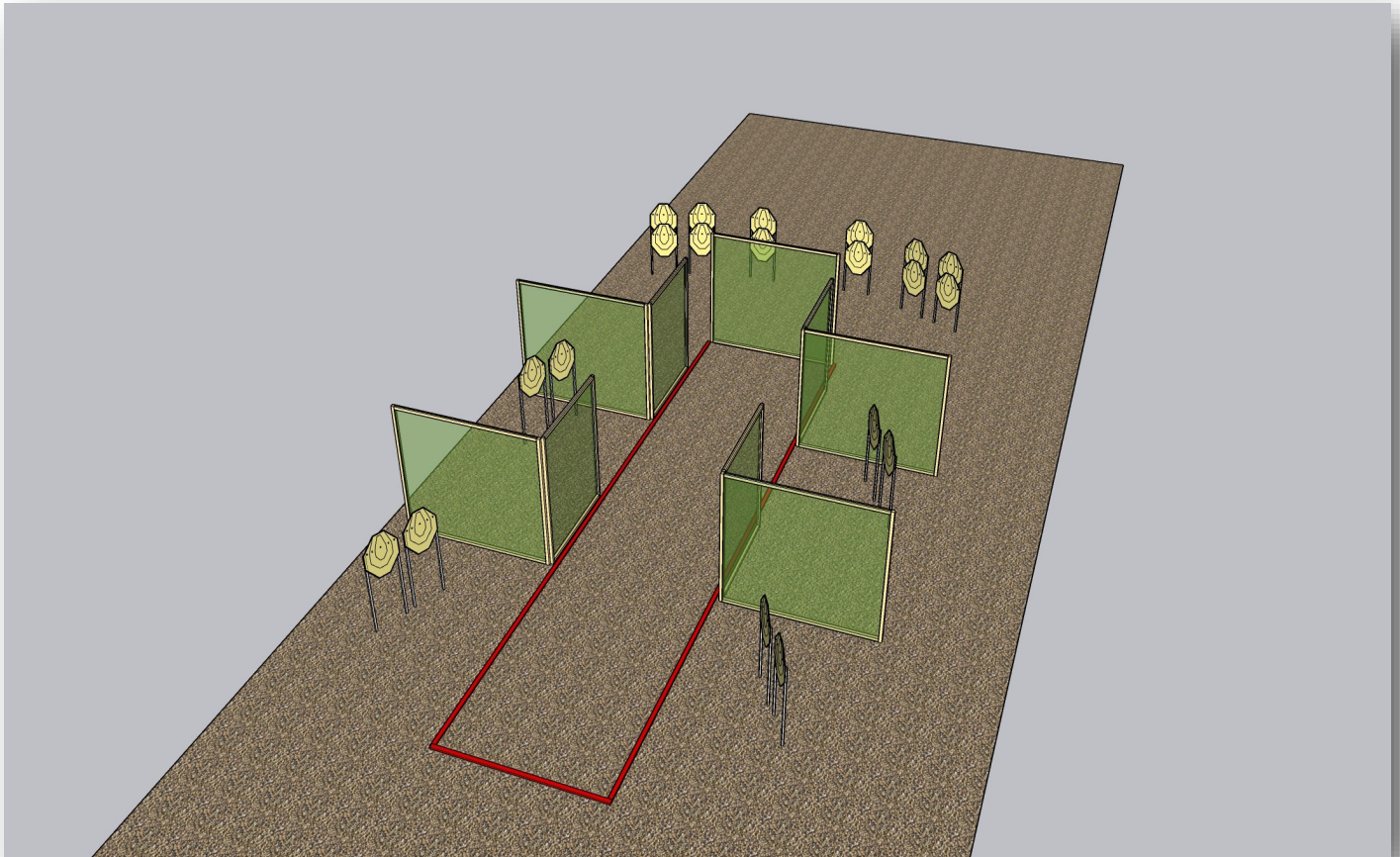

TARGETS:	20 IPSC Mini targets
ROUNDS TO BE SCORED:	40
START POSITION:	Anywhere
RIFLE READY CONDITION:	Option 1
TIME STARTS:	Audible signal
PROCEDURE:	Engage all targets as they become visible
SAFETY ANGLES:	Indicateed by marks L\R

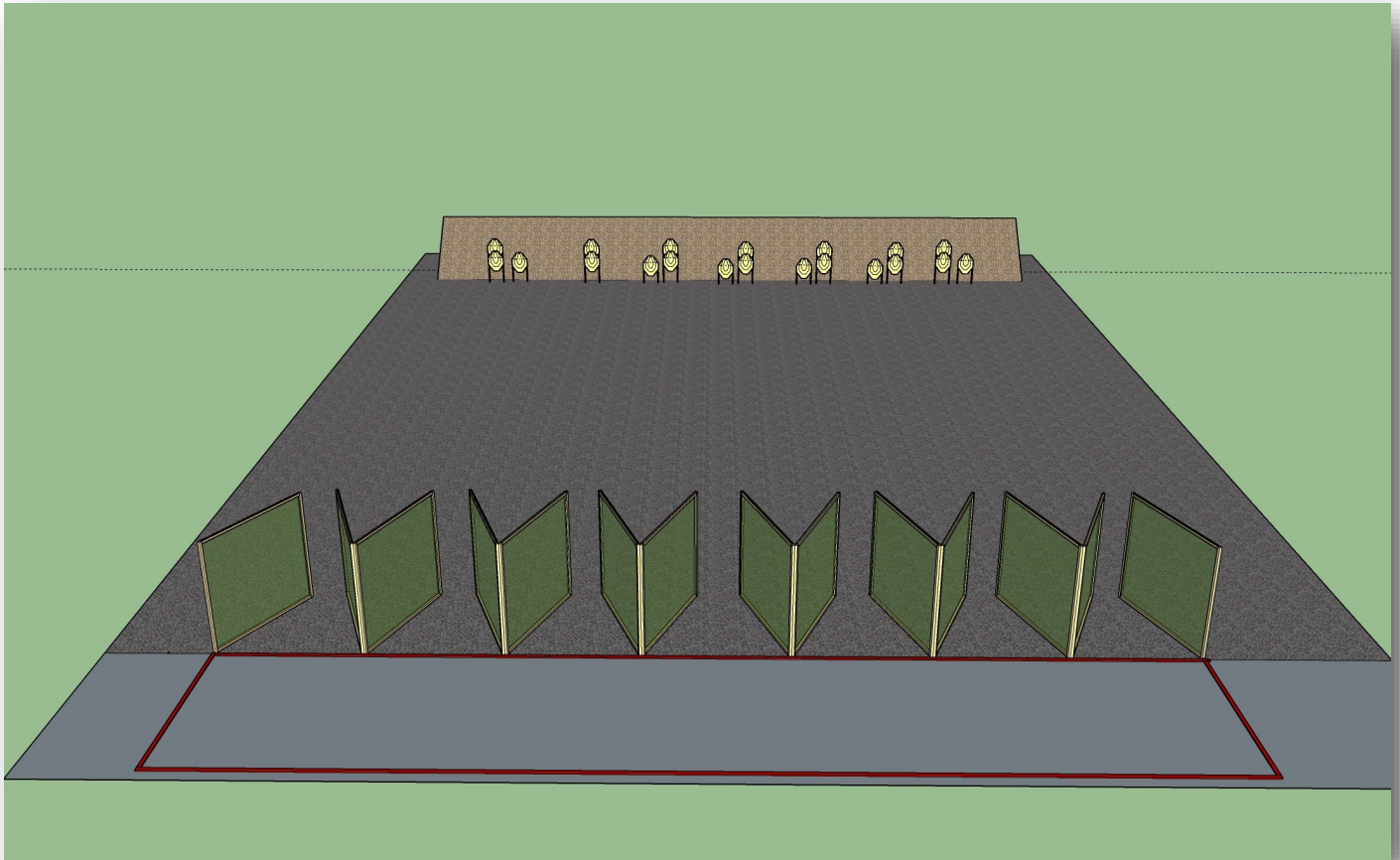

TARGETS:	20 IPSC Mini targets
ROUNDS TO BE SCORED:	40
START POSITION:	Anywhere
RIFLE READY CONDITION:	Option 1
TIME STARTS:	Audible signal
PROCEDURE:	Engage all targets as they become visible.
SAFETY ANGLES:	Indicated by marks L\R

Placeholder image

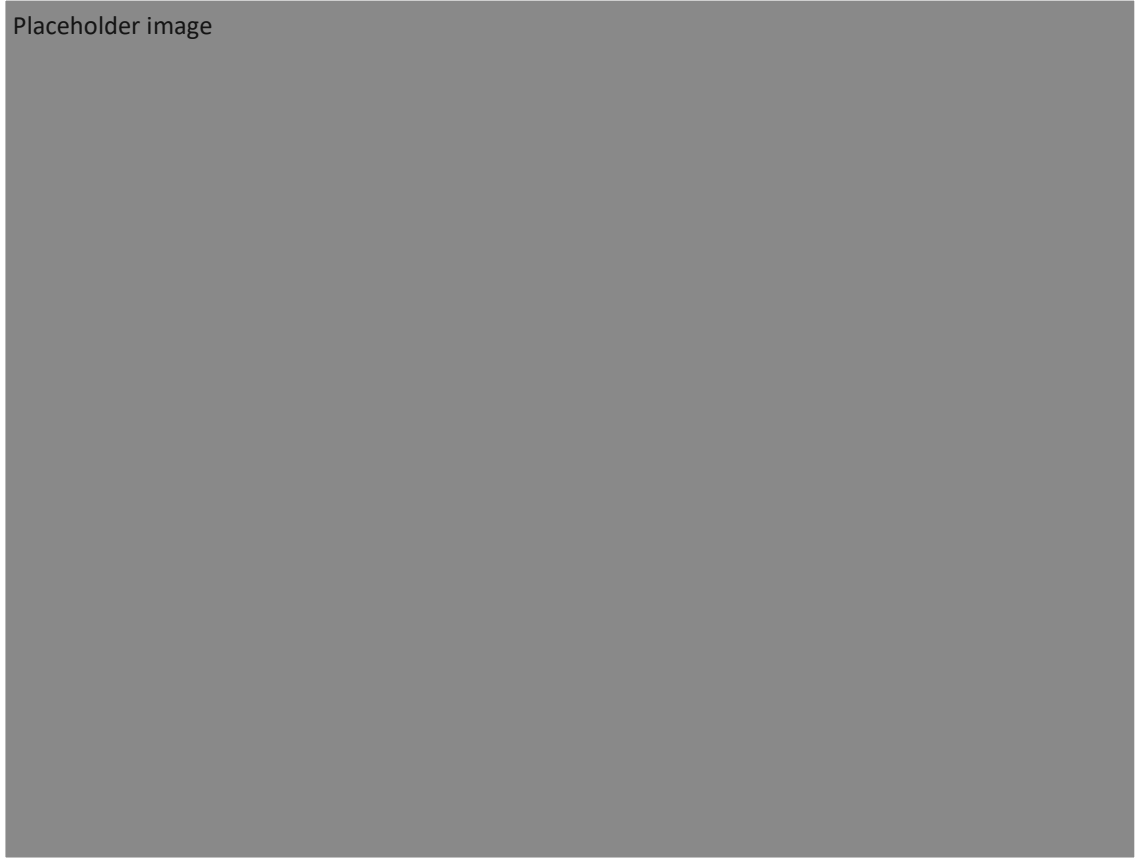

TARGETS: 8 IPSC Mini targets

ROUNDS TO BE SCORED: 16

START POSITION: Anywhere

RIFLE READY CONDITION: Option 1

TIME STARTS: Audible

PROCEDURE: Engage all targets as they become visible

SAFETY ANGLES: Indicated by marks L\R

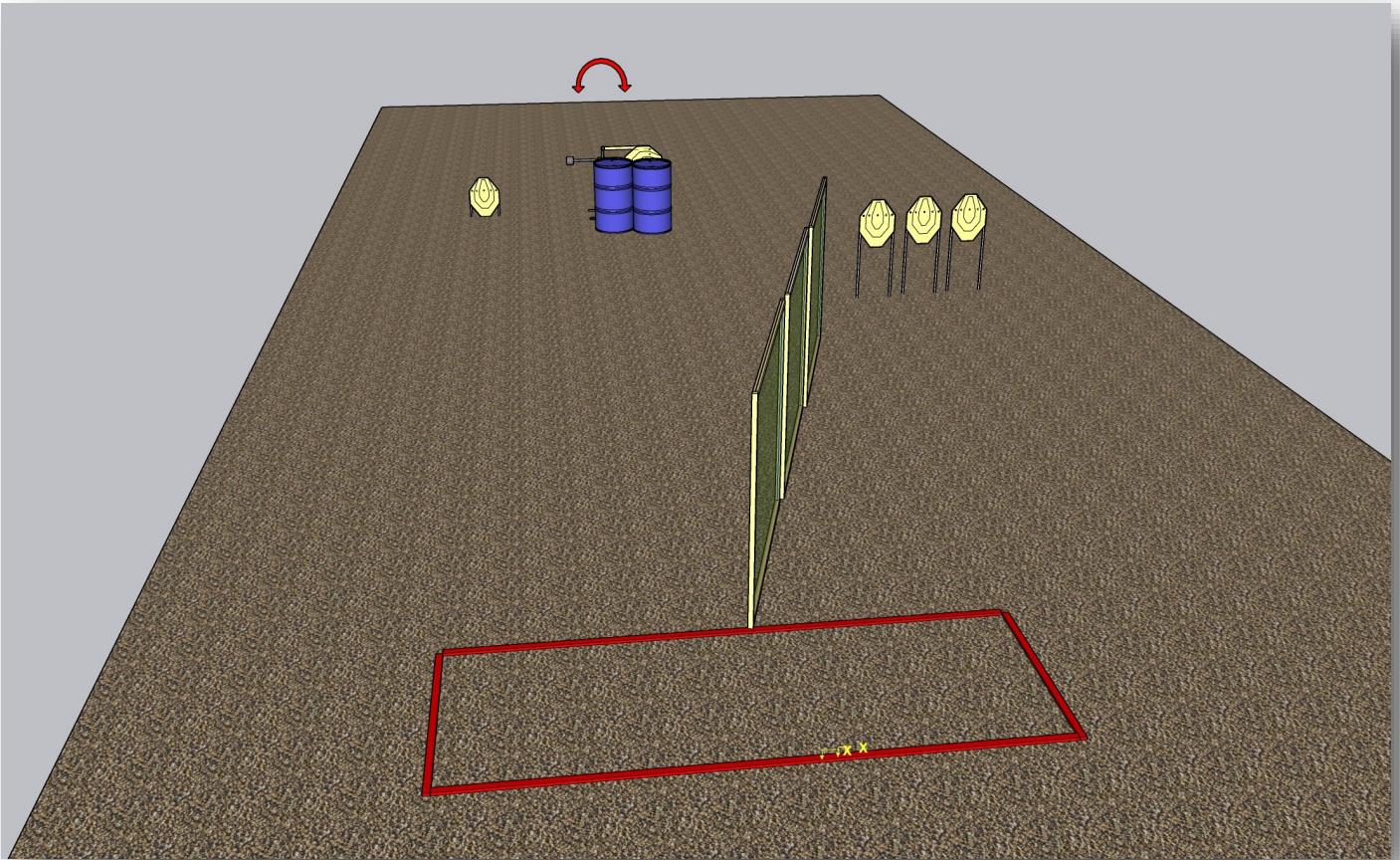

TARGETS:	5 IPSC Mini targets
ROUNDS TO BE SCORED:	10
START POSITION:	Heels touching marks, as demonstrated by RO
RIFLE READY CONDITION:	Option 2
TIME STARTS:	Audible signal
PROCEDURE:	Engage all targets as they become visible. Rope releases swinger. Swinger is visible at rest
SAFETY ANGLES:	Indicated by marks L\R

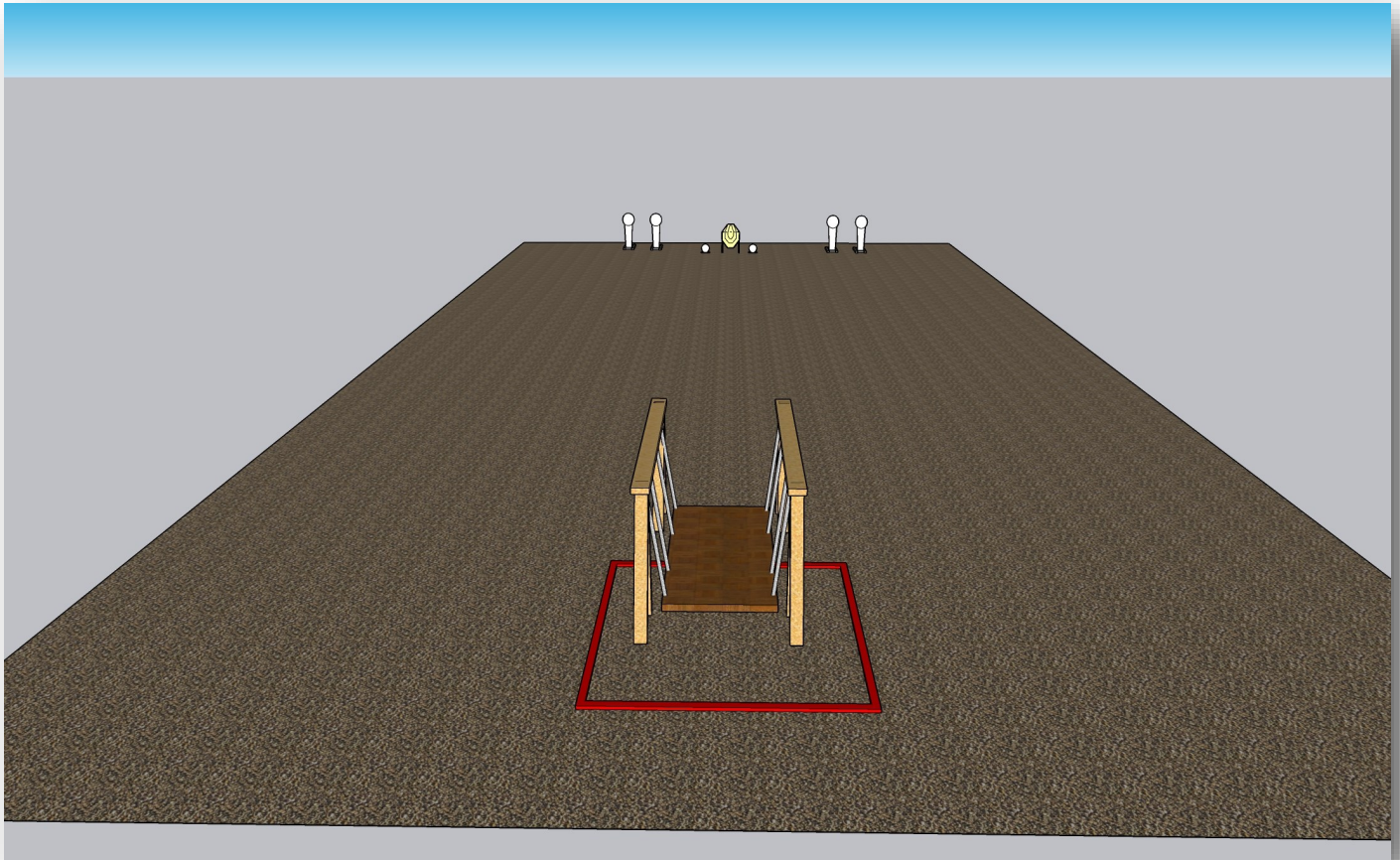

TARGETS:	1 IPSC Mini Target 2 IPSC plates 4 Mini popper
ROUNDS TO BE SCORED:	8
START POSITION:	Standing erect anywhere in demarcated area.
RIFLE READY CONDITION:	Option 3
TIME STARTS:	Audible signal
PROCEDURE:	Engage all targets as they become visible. All magazines to be used laying in box on left or right side. Gun laying flat, triggerguard on mark. All shooting must be done inside bed.
SAFETY ANGLES:	Indicated by L\R marks.

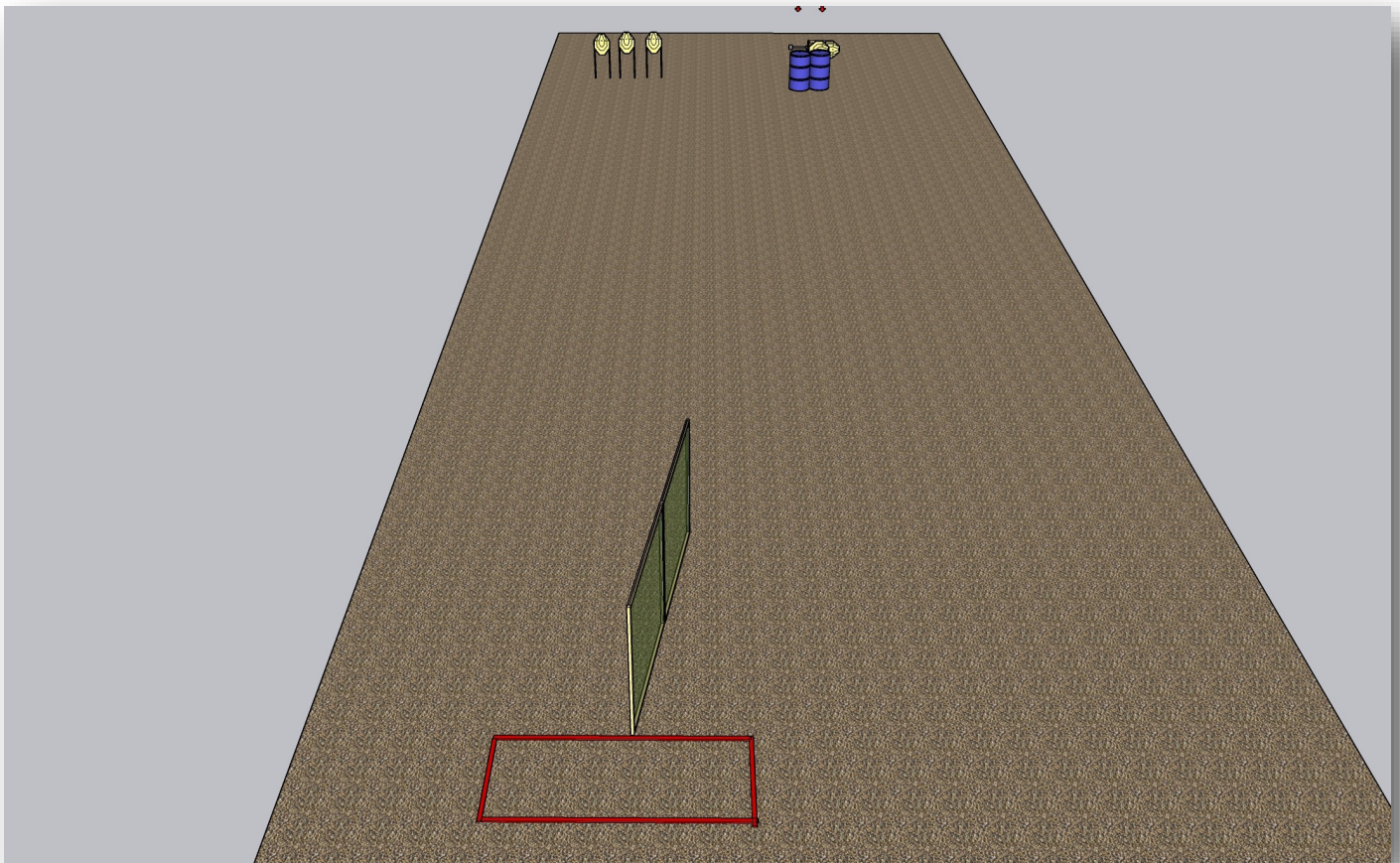

TARGETS:	5 IPSC Minitargets
ROUNDS TO BE SCORED:	10
START POSITION:	Anywhere
RIFLE READY CONDITION:	Option 1
TIME STARTS:	Audible signal
PROCEDURE:	Engage all targets as they become visible. Rope releases swinger. Swinger is visible at rest
SAFETY ANGLES:	Indicated by L\R Marks.

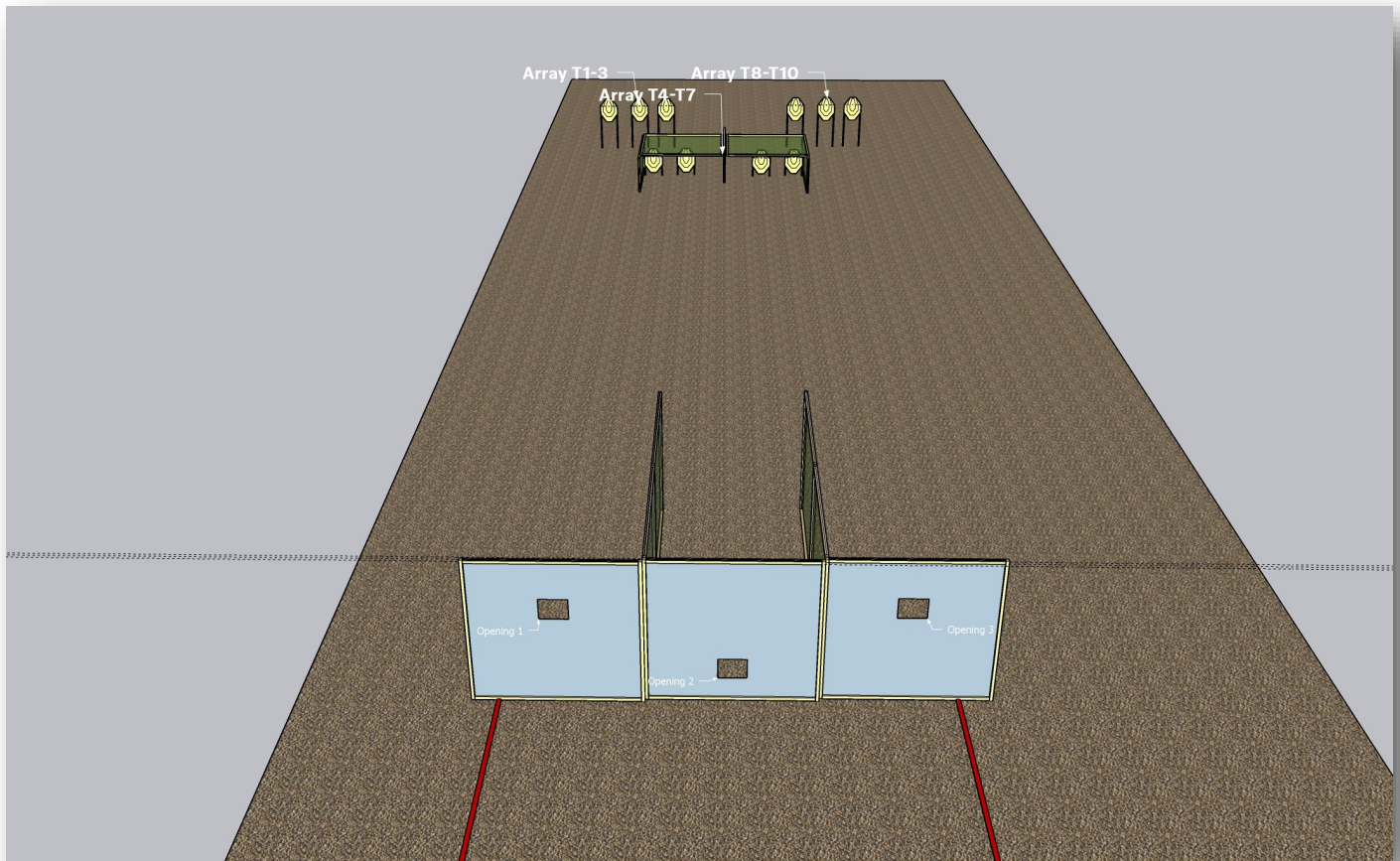

TARGETS:	10 IPSC Minitargets
ROUNDS TO BE SCORED:	20
START POSITION:	Anywhere
RIFLE READY CONDITION:	Option 1
TIME STARTS:	Audible signal
PROCEDURE:	Engage T1-3 through opening 1. Engage T4-6 through opening 2. Engage T7-10 through opening 3.
SAFETY ANGLES:	Indicated by marks L\R