

Job Name:	
Submitted By:	



Submittal Sheet For:	WT012GLSI20HLF / YN012GLSI20RPF
----------------------	--

Date _____

Ref. _____

Wall-Mounted Ductless 20SEER Inverter Heat Pump

System Full Set Model: **WYT012GLSI20RL**

AHRI Reference Number: **217048743**

Cooling Mode Performance

Rated Cooling	12,000 BTU/hr
Ambient Range	5~122°F
SEER2 Rating	20.0 BTU/W·h
EER2 Rating	11.2 BTU/W·h

* 100% Capacity @ Indoor DB 80°F / WB 67°F / m.w. 16 ft. lineset

Heating Mode Performance

Rated Heating	12,000 BTU/hr
Ambient Range	-4~86°F
HSPF2 IV (V)	9.5 (8.2) BTU/W·h
COP2 (47°F)	3.41 W/W

Heating (17°F) = 10,000 BTU / Heating (5°F) = 9,000 BTU / COP2 (5°F) = 1.8 W/W



Wall-Mounted Indoor Unit



Outdoor Condensing Unit



16 ft. Installation Kit (Pipe + Cable)



Handheld Remote Controller

Electrical Information

Rated Input (W)	Cooling	Heating
	1,050	1,030
Rated Current (A)	4.8	4.7
Breaker Needed	15A (Double-Pole)	
Power Supply	208~230V, 60Hz, 1Ph	

Piping and Refrigerant

Liquid Line (OD)	1/4 in
Suction Line (OD)	3/8 in
Refrigerant Precharge	R-454b (16 ft.)
Max Length/Height Diff.	50 ft. / 33 ft.

This combination is AHRI/ETL/ISO certified.



Interior Unit (Air Handler) Specifications

Type	Heat Pump
Sound Level (dBA)	45 (Turbo) / 42 (Hi) / 35 (Med) / 30 (Lo) / 28 (Mute)
Auto Air Circulation	2-Way Louver (Up-Down + Left-Right)
Dimensions (WDH)	31-7/8 in x 8 in x 11-1/2 in
Weight (lbs)	19.8

Exterior Unit (Condenser) Specifications

Sound Level (dBA)	55
Recommended Room Size	350~500 Sq. ft.
Minimum Room Size	34 Sq. ft.
Compressor	Inverter-Driven Rotary
Dimensions (WDH)	31 in x 11-1/2 in x 19-3/8 in
Weight (lbs)	55.1

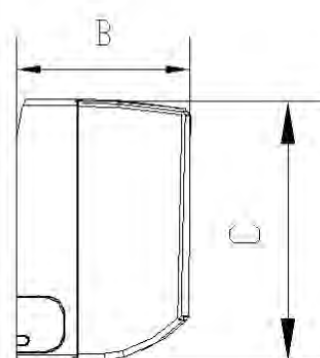
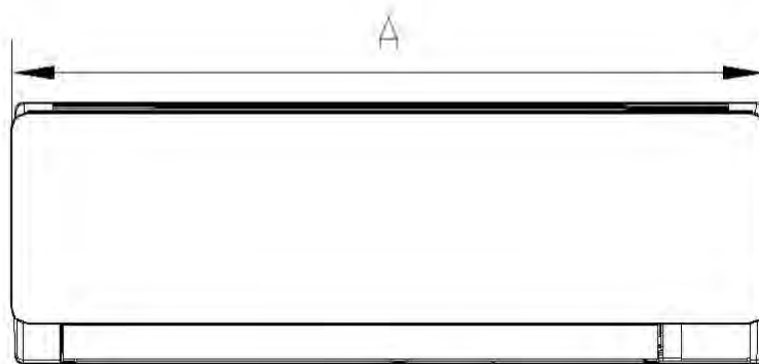
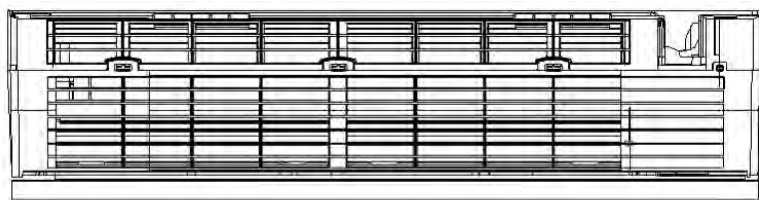

Model	A	B	C
WT012GLSI20HLF	31-7/8 in	11-1/2 in	8 in
	811 mm	292 mm	202 mm

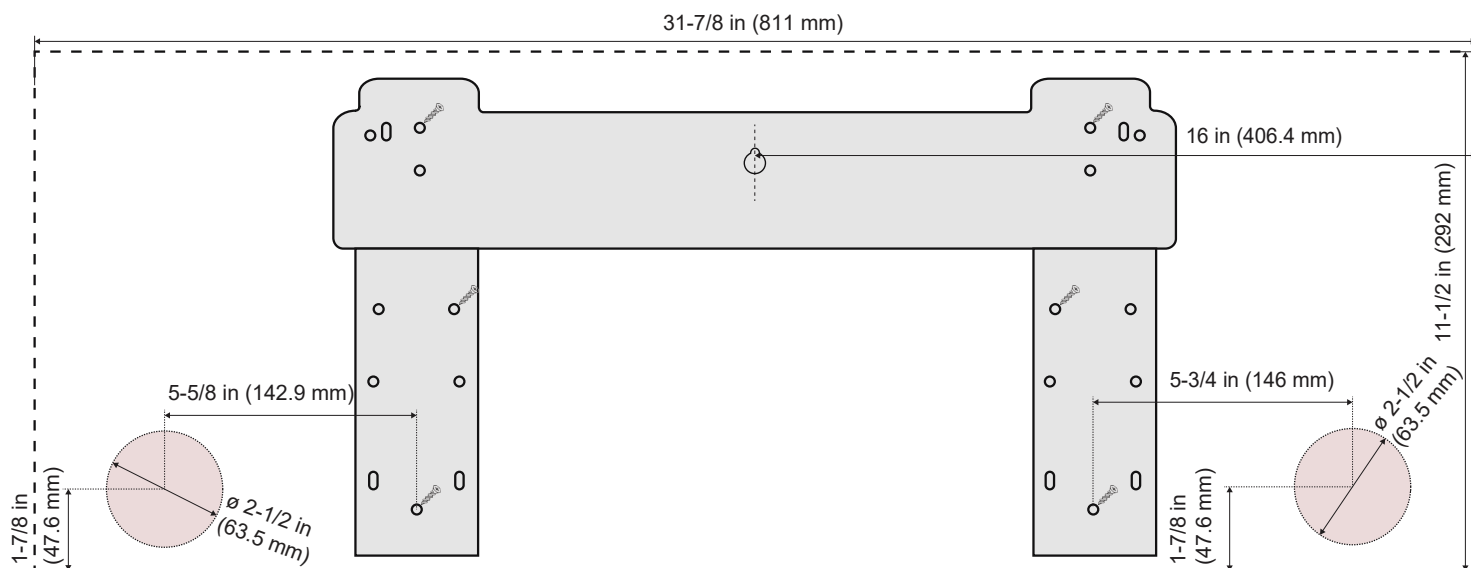

For 12K Systems
All Distances in Inches

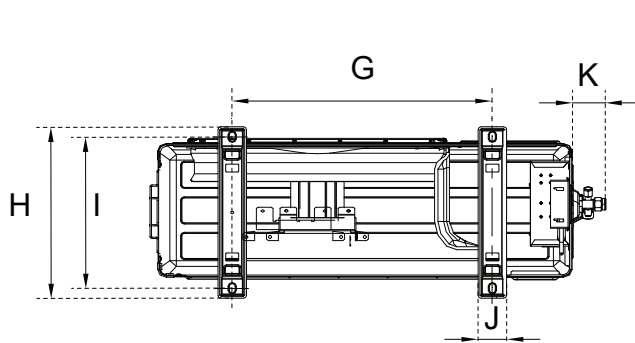

Underside View

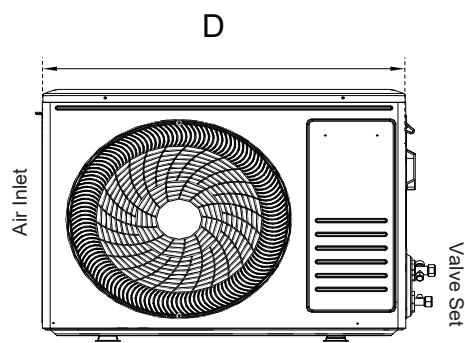

Front View

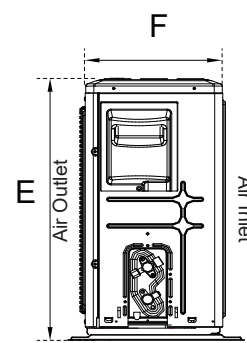

Side View

Model	D	E	F	G	H	I	J	K
YN012GLSI20RPF	28 in	19-5/8 in	9-1/4 in	16-3/8 in	11-1/2 in	10-3/8 in	1-7/8 in	2-1/4 in
	712 mm	498 mm	234 mm	415 mm	290.4 mm	263 mm	48 mm	55.9 mm

Warranty Information and Length



Complete warranty details are available with the vendor or online at <https://www.pdhvac.com/support/warranty/>. This high-quality system is eligible for up to a 5-year limited warranty on the compressor, and 5 years on other internal parts. To qualify for this warranty, the system must be installed within 90 days and registered properly. All other installations that are unregistered qualify for only 1-year parts/compressor warranty.

Outstanding Features

- LED Display
- Energy Saving
- Ultra-Thin Design
- Dual Drain Options
- Customizable Timer
- Eco-Friendly Refrigerant
- Whisper-Quiet Operation
- Power Loss Memory Recovery

Available Accessories

Part Number	Description
IKT-LCVR4P-KIT	<i>Decorative PVC Line Cover Kit</i>
IKT-LNBR-1/4-3/8	<i>BendAid Flexible Easy Bender Kit</i>
BRK-FRM-C-2P	<i>Folding Mounting Bracket w/ Leveler</i>
IKT-UVL32UL-AG	<i>UVC Bacterial Disinfection Kit</i>
IKT-SURPRK-DV2	<i>Ultimate Surge and Power Protection</i>