

Job Name:	
Submitted By:	



Submittal Sheet For:	WT012GLUI17HLD / YN012GLUI17RPD
----------------------	---------------------------------

Date \_\_\_\_\_

Ref. \_\_\_\_\_

## Wall-Mounted Ductless 17SEER Inverter Heat Pump

System Full Set Model: **WYT012GLUI17RL**

AHRI Reference Number: **217048735**

### Cooling Mode Performance

Rated Cooling	11,500 BTU/hr
Ambient Range	54~122°F
SEER2 Rating	17 BTU/W·h
EER2 Rating	9.5 BTU/W·h

\* 100% Capacity @ Indoor DB 80°F / WB 67°F / m.w. 16 ft. lineset

### Heating Mode Performance

Rated Heating	11,500 BTU/hr
Ambient Range	5~86°F
HSPF2 IV (V)	8.5 (7.1) BTU/W·h
COP2 (47°F)	3.2 W/W

Low Heat (17°F) = 8,100 BTU / COP2 (5°F) = 1.75 W/W



Wall-Mounted Indoor Unit



Outdoor Condensing Unit



16 ft. Installation Kit (Pipe + Cable)



Handheld Remote Controller

### Electrical Information

Rated Input (W)	Cooling	Heating
	1,170	1,110
Rated Current (A)	5.1	4.8
Breaker Needed	15A (Double-Pole)	
Power Supply	208~230V, 1Ph, 60Hz	

### Piping Refrigerant

Liquid Line (OD)	1/4 in
Suction Line (OD)	3/8 in
Refrigerant Precharge	R32 (16 ft.)
Max Length/Height Diff.	50 ft. / 33 ft.

This combination is AHRI/ETL/ISO certified.



### Interior Unit (Air Handler) Specifications

Type	Heat Pump
Sound Level (dBA)	45 (Turbo) / 42 (Hi) / 39 (Med) / 35 (Lo) / 33 (Mute)
Auto Air Circulation	2-Way Louver (Up-Down + Left-Right)
Dimensions (WDH)	30-1/2 in x 7-7/8 in x 9-3/4 in
Weight (lbs)	16.5

### Exterior Unit (Condenser) Specifications

Sound Level (dBA)	55
Recommended Room Size	350~500 Sq. ft.
Minimum Room Size	20 Sq. ft.
Compressor	Inverter-Driven (Rotary)
Dimensions (WDH)	31 in x 11-1/2 in x 19-3/8 in
Weight (lbs)	50.7

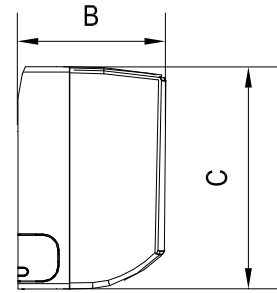
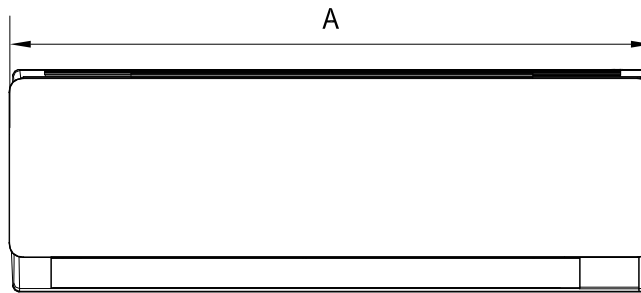
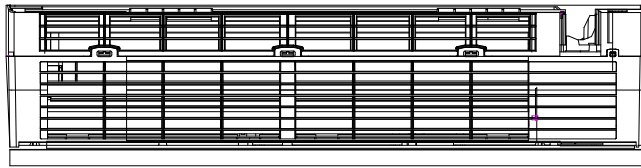

Model	A	B	C
WT012GLUI17HLD	30-5/8 in	8-1/8 in	9-3/4 in
	777 mm	205 mm	250 mm

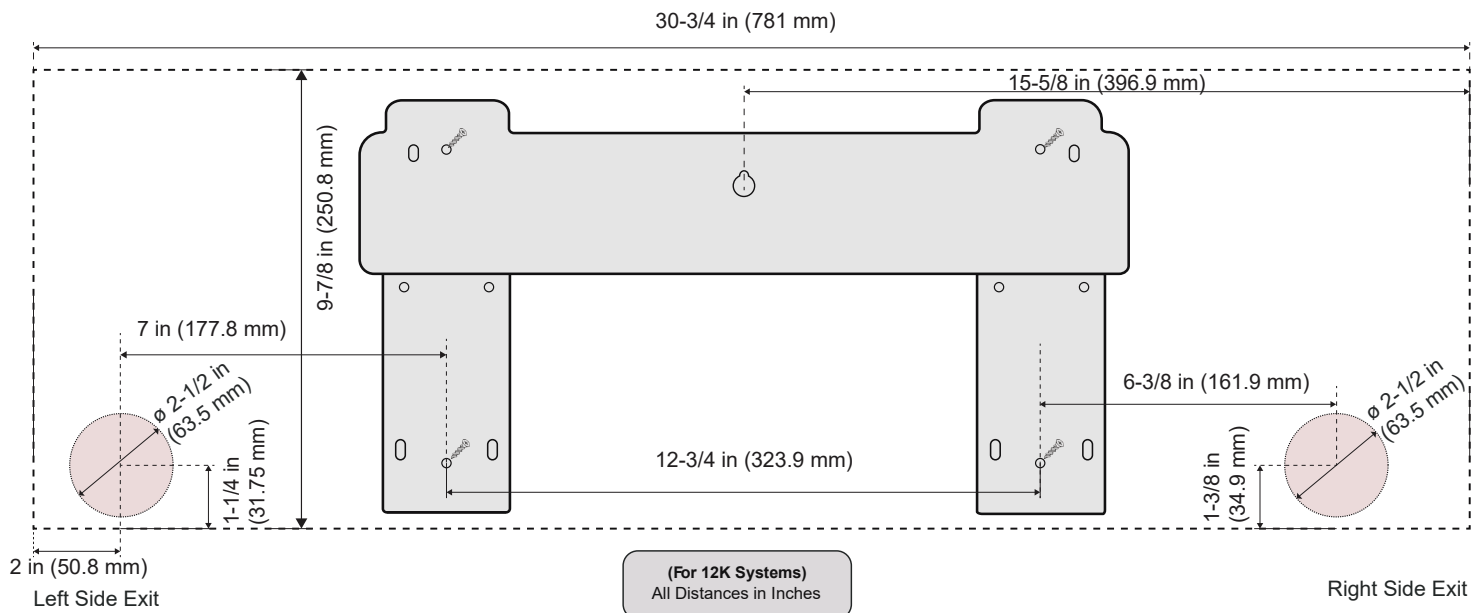

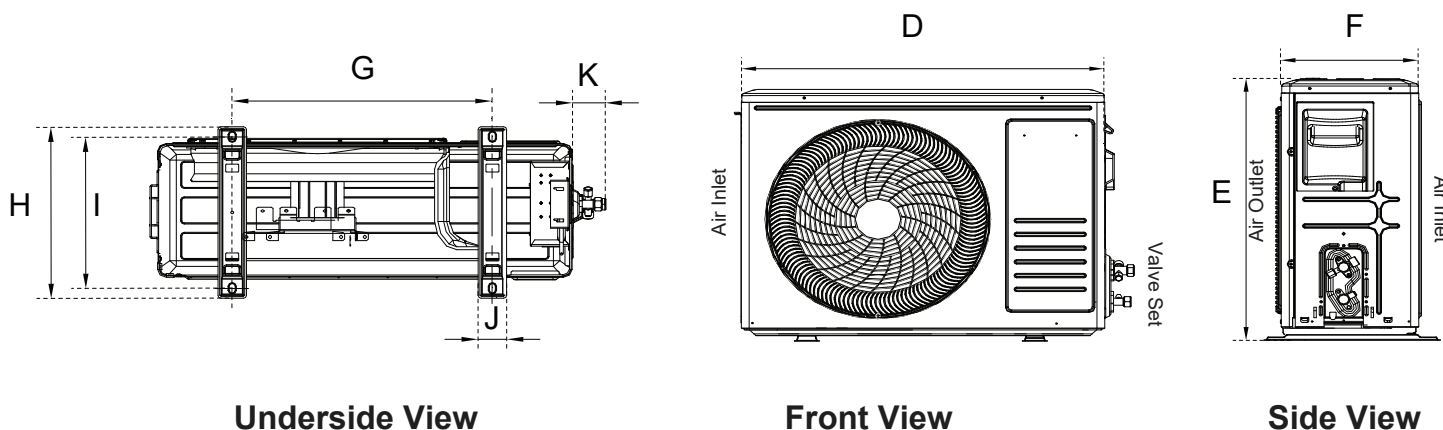

Model	D	E	F	G	H	I	J	K
YN012GLUI17RPD	28 in	19-5/8 in	9-1/4 in	16-1/4 in	11-1/2 in	8-7/8 in	1-7/8 in	2 in
	712 mm	498 mm	234 mm	415 mm	291 mm	225 mm	48.5 mm	52 mm

## Warranty Information and Length



Complete warranty details are available with the vendor or online at <https://www.pdhvac.com/support/warranty/>. This high-quality system is eligible for up to a 5-year limited warranty on the compressor, and 5 years on other internal parts. To qualify for this warranty, the system must be installed within 90 days and registered properly. All other installations that are unregistered qualify for only 1-year parts/compressor warranty.

## Outstanding Features

- LED Display
- Energy Saving
- Ultra-Thin Design
- Dual Drain Options
- Customizable Timer
- Eco-Friendly Refrigerant
- Whisper-Quiet Operation
- Power Loss Memory Recovery

## Available Accessories

Part Number	Description
IKT-LCVR4P-KIT	<i>Decorative PVC Line Cover Kit</i>
IKT-LNBR-1/4-3/8	<i>BendAid Flexible Easy Bender Kit</i>
BRK-FRM-C-2P	<i>Folding Mounting Bracket w/ Leveler</i>
IKT-UVL32UL-AG	<i>UVC Bacterial Disinfection Kit</i>
IKT-SURPRK-DV2	<i>Ultimate Surge and Power Protection</i>