

Job Name:	
Submitted By:	



Submittal Sheet For:	WT018GLSI20HLF / YN018GLSI20RPF
----------------------	--

Date _____

Ref. _____

Wall-Mounted Ductless 21SEER Inverter Heat Pump

System Full Set Model: **WYT018GLSI20RL**

AHRI Reference Number: **217048744**

Cooling Mode Performance

Rated Cooling	18,000 BTU/hr
Ambient Range	5~122°F
SEER2 Rating	21.0 BTU/W·h
EER2 Rating	10.5 BTU/W·h

* 100% Capacity @ Indoor DB 80°F / WB 67°F / m.w. 16 ft. lineset

Heating Mode Performance

Rated Heating	18,000 BTU/hr
Ambient Range	-4~86°F
HSPF2 IV (V)	9.5 (8.2) BTU/W·h
COP2 (47°F)	3.41 W/W

Heating (17°F) = 13,000 BTU / Heating (5°F) = 12,500 BTU / COP2 (5°F) = 1.8 W/W



Wall-Mounted Indoor Unit



Outdoor Condensing Unit



16 ft. Installation Kit (Pipe + Cable)



Handheld Remote Controller

Electrical Information

Rated Input (W)	Cooling	Heating
	1,700	1,530
Rated Current (A)	7.7	6.9
Breaker Needed	20A (Double-Pole)	
Power Supply	208~230V, 60Hz, 1Ph	

Piping and Refrigerant

Liquid Line (OD)	1/4 in
Suction Line (OD)	3/8 in
Refrigerant Precharge	R-454b (16 ft.)
Max Length/Height Diff.	65 ft. / 50 ft.

This combination is AHRI/ETL/ISO certified.



Interior Unit (Air Handler) Specifications

Type	Heat Pump
Sound Level (dBA)	49 (Turbo)/47 (Hi)/42 (Med)/37 (Lo)/32 (Mute)
Auto Air Circulation	2-Way Louver (Up-Down + Left-Right)
Dimensions (WDH)	39-3/4 in x 9 in x 12-3/8 in
Weight (lbs)	27.6

Exterior Unit (Condenser) Specifications

Sound Level (dBA)	55
Recommended Room Size	500~750 Sq. ft.
Minimum Room Size	40 Sq. ft.
Compressor	Inverter-Driven Rotary
Dimensions (WDH)	34 in x 13-3/4 in x 23-3/4 in
Weight (lbs)	70.5

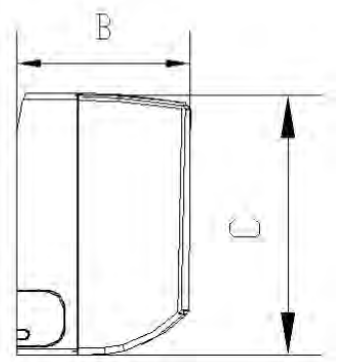
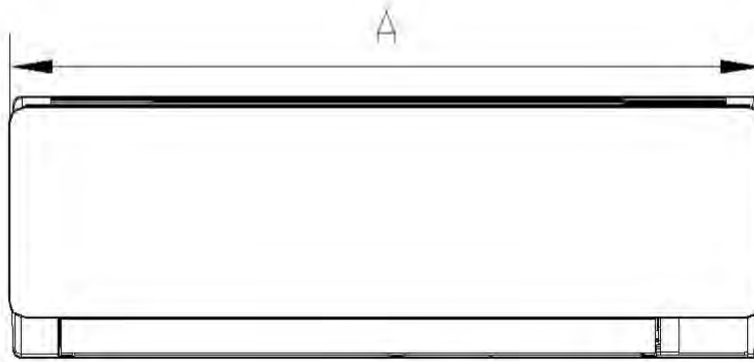
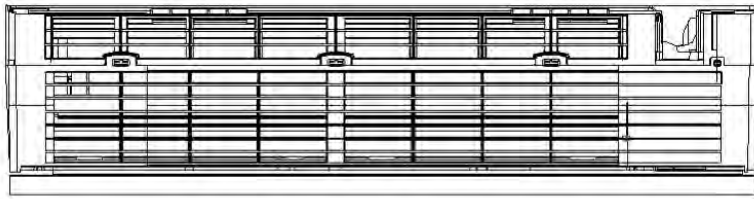

Model	A	B	C
WT018GLSI20HLF	39-3/4 in 1010 mm	12-3/8 in 315 mm	8-3/4 in 220 mm

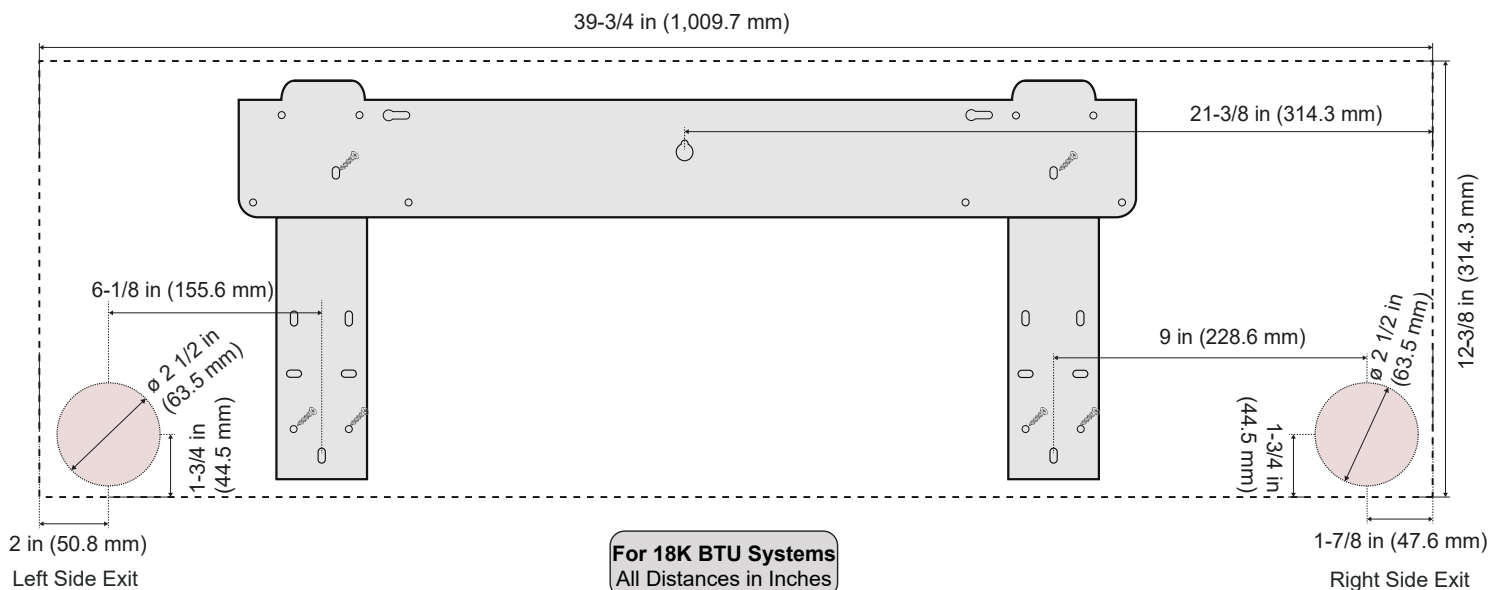

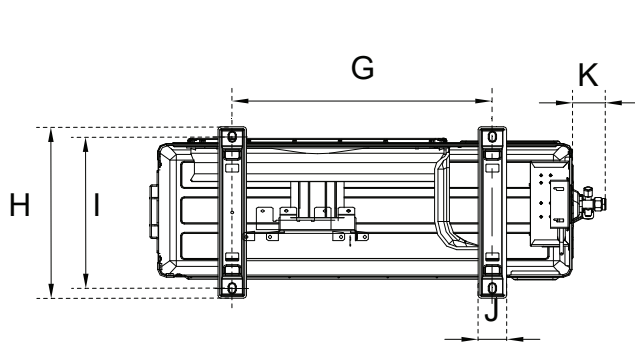

Underside View

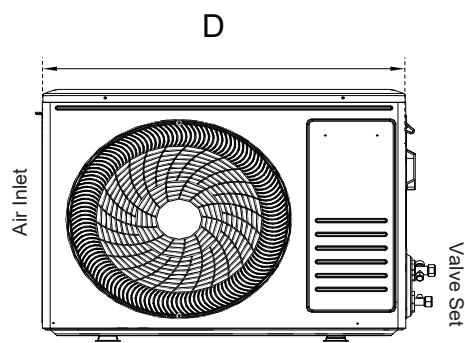

Front View

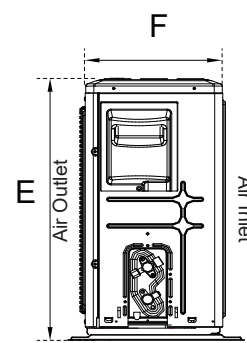

Side View

Model	D	E	F	G	H	I	J	K
YN018GLSI20RPF	30-3/4 in	23-3/4 in	11-3/8 in	20-3/8 in	13-3/4 in	12-3/8 in	2-1/8 in	2-1/4 in
	780 mm	602 mm	288 mm	516 mm	349 mm	314 mm	54 mm	57 mm

Warranty Information and Length



Complete warranty details are available with the vendor or online at <https://www.pdhvac.com/support/warranty/>. This high-quality system is eligible for up to a 5-year limited warranty on the compressor, and 5 years on other internal parts. To qualify for this warranty, the system must be installed within 90 days and registered properly. All other installations that are unregistered qualify for only 1-year parts/compressor warranty.

Outstanding Features

- LED Display
- Energy Saving
- Ultra-Thin Design
- Dual Drain Options
- Customizable Timer
- Eco-Friendly Refrigerant
- Whisper-Quiet Operation
- Power Loss Memory Recovery

Available Accessories

Part Number	Description
IKT-LCVR4P-KIT	<i>Decorative PVC Line Cover Kit</i>
IKT-LNBR-1/4-3/8	<i>BendAid Flexible Easy Bender Kit</i>
BRK-FRM-C-2P	<i>Folding Mounting Bracket w/ Leveler</i>
IKT-UVL32UL-AG	<i>UVC Bacterial Disinfection Kit</i>
IKT-SURPRK-DV2	<i>Ultimate Surge and Power Protection</i>