

Job Name:	
Submitted By:	



Submittal Sheet For:	WT018GLUI17HLD / YN018GLUI17RPD
----------------------	--

Date _____

Ref. _____

Wall-Mounted Ductless 17SEER Inverter Heat Pump

System Full Set Model: **WYT018GLUI17RL**

AHRI Reference Number: **217048736**

Cooling Mode Performance

Rated Cooling	17,000 BTU/hr
Ambient Range	54~122°F
SEER2 Rating	17 BTU/W·h
EER2 Rating	9.5 BTU/W·h

* 100% Capacity @ Indoor DB 80°F / WB 67°F / m.w. 16 ft. lineset

Heating Mode Performance

Rated Heating	16,500 BTU/hr
Ambient Range	5~86°F
HSPF2 IV (V)	8.5 (7.2) BTU/W·h
COP2 (47°F)	3.2 W/W

Low Heat (17°F) = 10,000 BTU / COP2 (5°F) = 1.8 W/W



Wall-Mounted Indoor Unit



Outdoor Condensing Unit



16 ft. Installation Kit (Pipe + Cable)



Handheld Remote Controller

Electrical Information

Rated Input (W)	Cooling	Heating
	1,770	1,440
Rated Current (A)	7.7	6.3
Breaker Needed	20A (Double-Pole)	
Power Supply	208~230V, 1Ph, 60Hz	

Piping and Refrigerant

Liquid Line (OD)	1/4 in
Suction Line (OD)	3/8 in
Refrigerant Precharge	R32 (16 ft.)
Max Length/Height Diff.	50 ft. / 33 ft.

This combination is AHRI/ETL/ISO certified.



Interior Unit (Air Handler) Specifications

Type	Heat Pump
Sound Level (dBA)	49 (Turbo) / 45 (Hi) / 40 (Med) / 34 (Lo) / 32 (Mute)
Auto Air Circulation	2-Way Louver (Up-Down + Left-Right)
Dimensions (WDH)	35-3/4 in x 8-1/8 in x 11-1/2 in
Weight (lbs)	20.9

Exterior Unit (Condenser) Specifications

Sound Level (dBA)	57
Recommended Room Size	500~750 Sq. ft.
Minimum Room Size	27 Sq. ft.
Compressor	Inverter-Driven Rotary
Dimensions (WDH)	31-7/8 in x 12 in x 21-5/8 in
Weight (lbs)	57.3

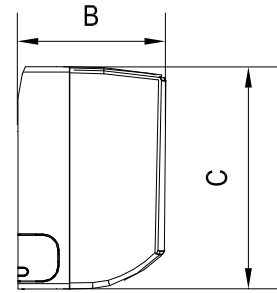
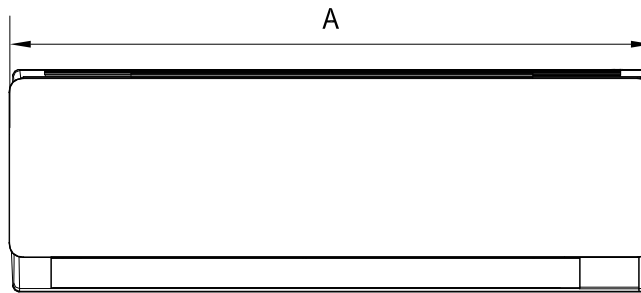
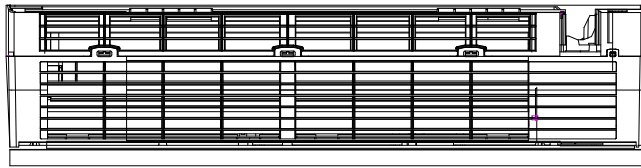

Model	A	B	C
WT018GLUI17HLD	35-3/4 in	8-1/8 in	11-1/2 in
	910 mm	205 mm	292 mm

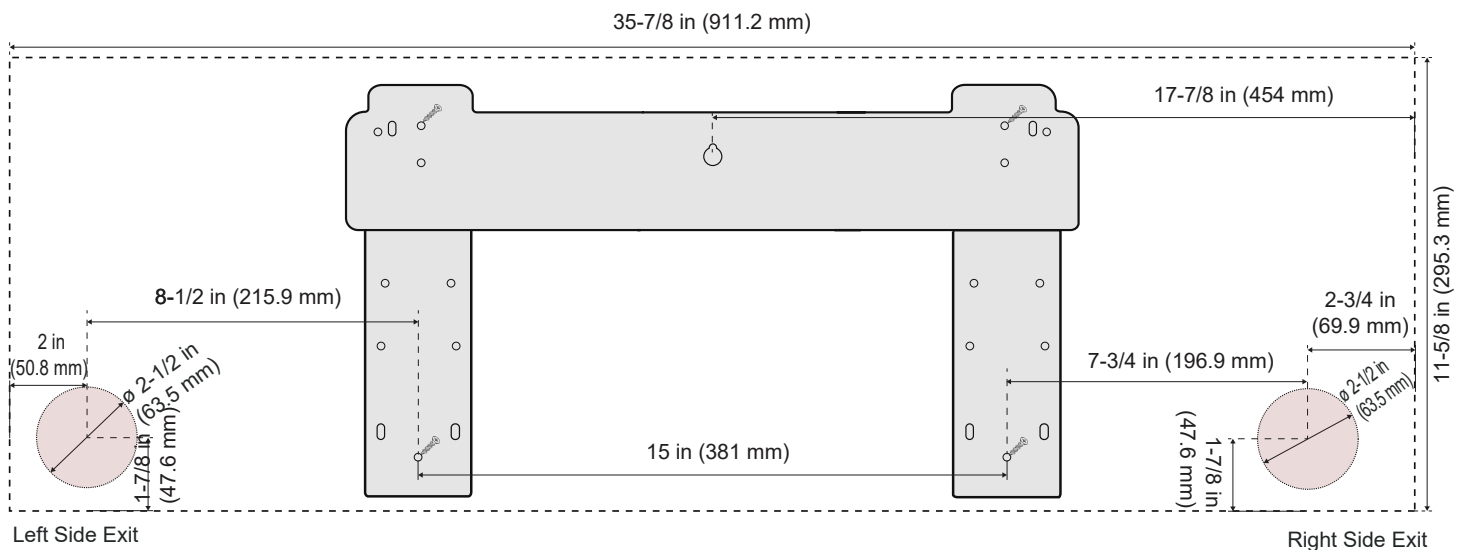

(For 18K BTU Systems)
All Distances in Inches

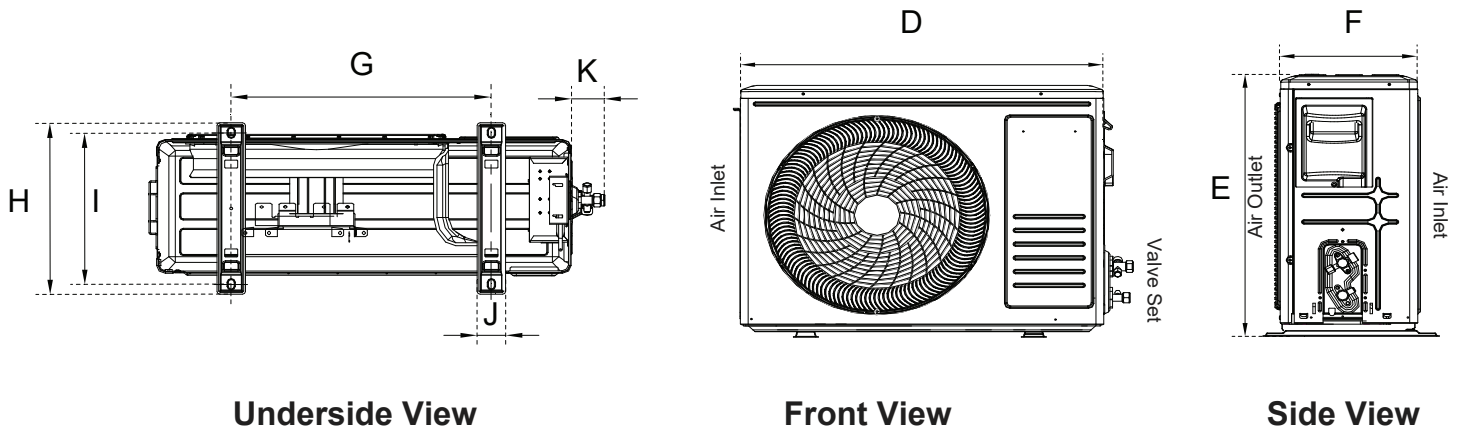

Model	D	E	F	G	H	I	J	K
YN018GLUI17RPD	28-5/8 in	21-5/8 in	9-7/8 in	17-1/8 in	12 in	10-7/8 in	1-3/8 in	2 in
	726 mm	549 mm	252 mm	433.8 mm	305 mm	278 mm	48 mm	52 mm

Warranty Information and Length



Complete warranty details are available with the vendor or online at <https://www.pdhvac.com/support/warranty/>. This high-quality system is eligible for up to a 5-year limited warranty on the compressor, and 5 years on other internal parts. To qualify for this warranty, the system must be installed within 90 days and registered properly. All other installations that are unregistered qualify for only 1-year parts/compressor warranty.

Outstanding Features

- LED Display
- Energy Saving
- Ultra-Thin Design
- Dual Drain Options
- Customizable Timer
- Eco-Friendly Refrigerant
- Whisper-Quiet Operation
- Power Loss Memory Recovery

Available Accessories

Part Number	Description
IKT-LCVR4P-KIT	<i>Decorative PVC Line Cover Kit</i>
IKT-LNBR-1/4-3/8	<i>BendAid Flexible Easy Bender Kit</i>
BRK-FRM-C-2P	<i>Folding Mounting Bracket w/ Leveler</i>
IKT-UVL32UL-AG	<i>UVC Bacterial Disinfection Kit</i>
IKT-SURPRK-DV2	<i>Ultimate Surge and Power Protection</i>