

| | |
|---------------|--|
| Job Name: | |
| Submitted By: | |



| | |
|----------------------|--|
| Submittal Sheet For: | WT024GLSI20HLF / YN024GLSI20RPF |
|----------------------|--|

Date _____

Ref. _____

Wall-Mounted Ductless 21SEER Inverter Heat Pump

System Full Set Model: **WYT024GLSI20RL**

AHRI Reference Number: **217048745**

Cooling Mode Performance

| | |
|---------------|---------------|
| Rated Cooling | 24,000 BTU/hr |
| Ambient Range | 5~122°F |
| SEER2 Rating | 21.0 BTU/W·h |
| EER2 Rating | 10.5 BTU/W·h |

* 100% Capacity @ Indoor DB 80°F / WB 67°F / m.w. 16 ft. lineset

Heating Mode Performance

| | |
|---------------|-------------------|
| Rated Heating | 24,000 BTU/hr |
| Ambient Range | -4~86°F |
| HSPF2 IV (V) | 9.5 (8.2) BTU/W·h |
| COP2 (47°F) | 3.41 W/W |

Heating (17°F) = 17,900 BTU / Heating (5°F) = 15,600 BTU / COP2 (5°F) = 2.1 W/W



Wall-Mounted Indoor Unit



Outdoor Condensing Unit



16 ft. Installation Kit (Pipe + Cable)



Handheld Remote Controller

Electrical Information

| Rated Input (W) | Cooling | Heating |
|-------------------|---------------------|---------|
| | 2,080 | 1,800 |
| Rated Current (A) | 9.4 | 8.2 |
| Breaker Needed | 25A (Double-Pole) | |
| Power Supply | 208~230V, 60Hz, 1Ph | |

Piping and Refrigerant

| | |
|-------------------------|-----------------|
| Liquid Line (OD) | 1/4 in |
| Suction Line (OD) | 1/2 in |
| Refrigerant Precharge | R-454b (16 ft.) |
| Max Length/Height Diff. | 65 ft. / 50 ft. |

This combination is AHRI/ETL/ISO certified.



Interior Unit (Air Handler) Specifications

| Type | Heat Pump |
|----------------------|---|
| Sound Level (dBA) | 52 (Turbo) / 50 (Hi) / 44 (Med) / 38 (Lo) / 36 (Mute) |
| Auto Air Circulation | 2-Way Louver (Up-Down + Left-Right) |
| Dimensions (WDH) | 46-7/8 in x 10-1/4 in x 14-1/4 in |
| Weight (lbs) | 36.4 |

Exterior Unit (Condenser) Specifications

| | |
|-----------------------|-----------------------------------|
| Sound Level (dBA) | 58 |
| Recommended Room Size | 750~1,000 Sq. ft. |
| Minimum Room Size | 51 Sq. ft. |
| Compressor | Inverter-Driven Rotary |
| Dimensions (WDH) | 36-1/2 in x 14-7/8 in x 27-1/2 in |
| Weight (lbs) | 88.2 |

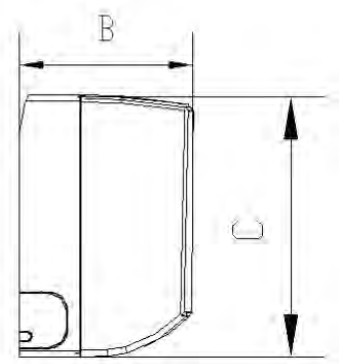
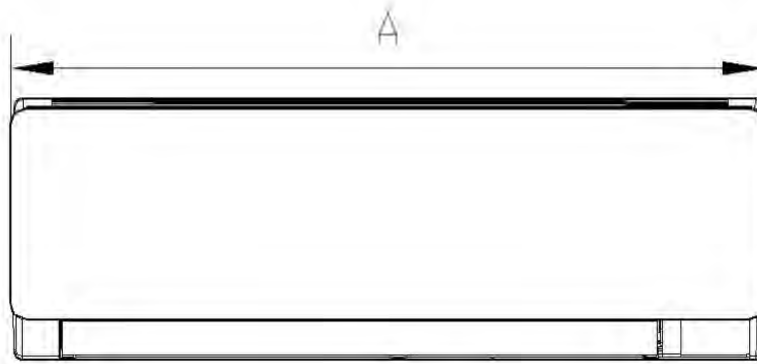
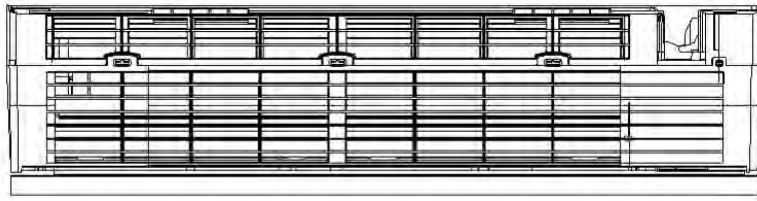

| Model | A | B | C |
|----------------|-----------|-----------|-----------|
| WT024GLSI20HLF | 46-3/4 in | 13-3/8 in | 10-5/8 in |
| | 1186 mm | 340 mm | 268 mm |

46-7/8 in (1,190.6 mm)

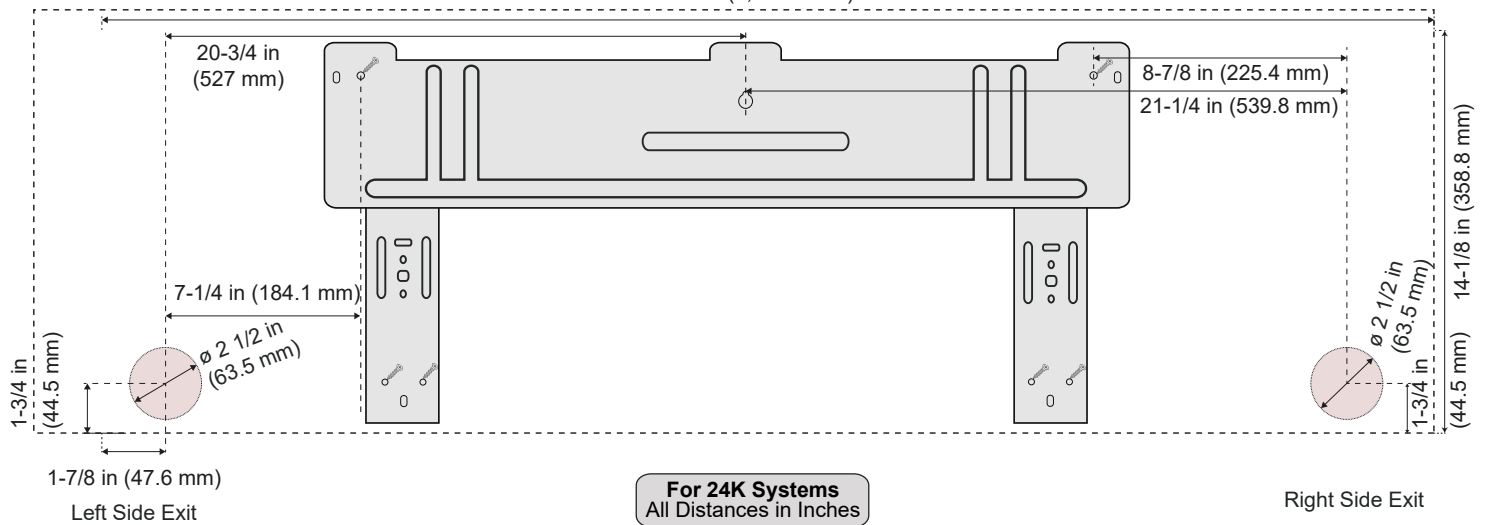

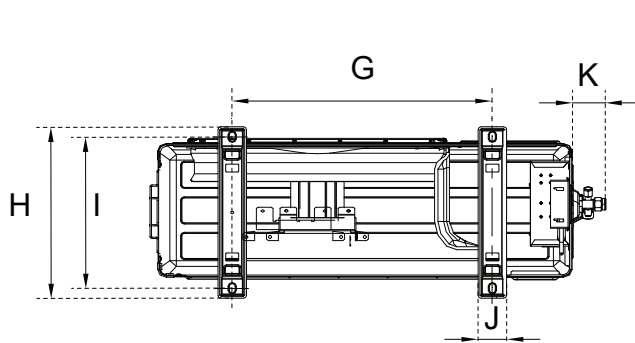

Underside View

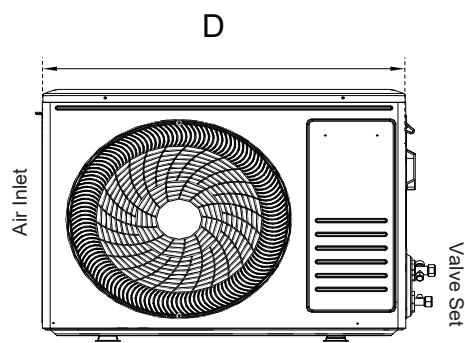

Front View

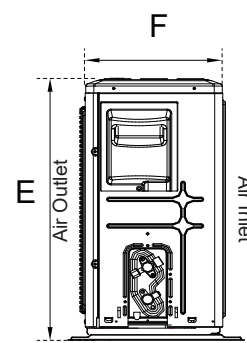

Side View

| Model | D | E | F | G | H | I | J | K |
|----------------|-----------|-----------|-----------|-----------|-----------|-----------|----------|----------|
| YN024GLSI20RPF | 33-1/4 in | 27-1/2 in | 12-7/8 in | 23-1/8 in | 14-3/4 in | 13-3/4 in | 2-1/8 in | 2-1/4 in |
| | 845 mm | 699 mm | 326 mm | 586 mm | 375 mm | 348 mm | 55 mm | 55.9 mm |

Warranty Information and Length



Complete warranty details are available with the vendor or online at <https://www.pdhvac.com/support/warranty/>. This high-quality system is eligible for up to a 5-year limited warranty on the compressor, and 5 years on other internal parts. To qualify for this warranty, the system must be installed within 90 days and registered properly. All other installations that are unregistered qualify for only 1-year parts/compressor warranty.

Outstanding Features

- LED Display
- Energy Saving
- Ultra-Thin Design
- Dual Drain Options
- Customizable Timer
- Eco-Friendly Refrigerant
- Whisper-Quiet Operation
- Power Loss Memory Recovery

Available Accessories

| Part Number | Description |
|------------------|--|
| IKT-LCVR4P-KIT | <i>Decorative PVC Line Cover Kit</i> |
| IKT-LNBR-1/4-3/8 | <i>BendAid Flexible Easy Bender Kit</i> |
| BRK-FRM-C-2P | <i>Folding Mounting Bracket w/ Leveler</i> |
| IKT-UVL32UL-AG | <i>UVC Bacterial Disinfection Kit</i> |
| IKT-SURPRK-DV2 | <i>Ultimate Surge and Power Protection</i> |