

Job Name:	
Submitted By:	



Submittal Sheet For:	<b>WT036GLSI20HLF / YN036GLSI20RPF</b>
----------------------	--

Date \_\_\_\_\_

Ref. \_\_\_\_\_

## Wall-Mounted Ductless 19SEER Inverter Heat Pump

System Full Set Model: **WYT036GLSI20RL**

AHRI Reference Number: **217048747**

### Cooling Mode Performance

Rated Cooling	36,000 BTU/hr
Ambient Range	5~122°F
SEER2 Rating	19.0 BTU/W·h
EER2 Rating	9.0 BTU/W·h

\* 100% Capacity @ Indoor DB 80°F / WB 67°F / m.w. 16 ft. lineset

### Heating Mode Performance

Rated Heating	36,000 BTU/hr
Ambient Range	-4~86°F
HSPF2 IV (V)	9.0 (7.7) BTU/W·h
COP2 (47°F)	3.15 W/W

Heating (17°F) = 23,400 BTU / Heating (5°F) = 20,400 BTU / COP2 (5°F) = 2.1 W/W



Wall-Mounted Indoor Unit



Outdoor Condensing Unit



16 ft. Installation Kit (Pipe + Cable)



Handheld Remote Controller

### Electrical Information

	Cooling	Heating
Rated Input (W)	3,850	3,350
Rated Current (A)	17.4	15.2
Breaker Needed	30A (Double-Pole)	
Power Supply	208~230V, 60Hz, 1Ph	

### Piping and Refrigerant

Liquid Line (OD)	1/4 in
Suction Line (OD)	5/8 in
Refrigerant Precharge	R-454b (16 ft.)
Max Length/Height Diff.	100 ft. / 65 ft.

This combination is AHRI/ETL/ISO certified.



### Interior Unit (Air Handler) Specifications

Type	Heat Pump
Sound Level (dBA)	52 (Turbo) / 49 (Hi) / 43 (Med) / 38 (Lo) / 36 (Mute)
Auto Air Circulation	2-Way Louver (Up-Down + Left-Right)
Dimensions (WDH)	46-7/8 in x 10-1/4 in x 14-1/4 in
Weight (lbs)	39.7

### Exterior Unit (Condenser) Specifications

Sound Level (dBA)	63
Recommended Room Size	1,100~1,400 Sq. ft.
Minimum Room Size	63 Sq. ft.
Compressor	Inverter-Driven Rotary
Dimensions (WDH)	38-1/2 in x 16-1/2 in x 31-5/8 in
Weight (lbs)	105.8

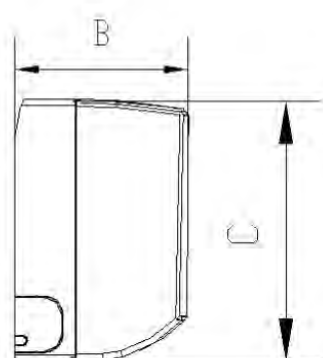
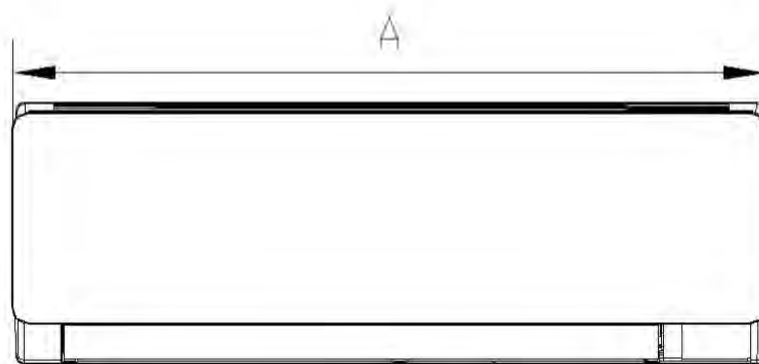
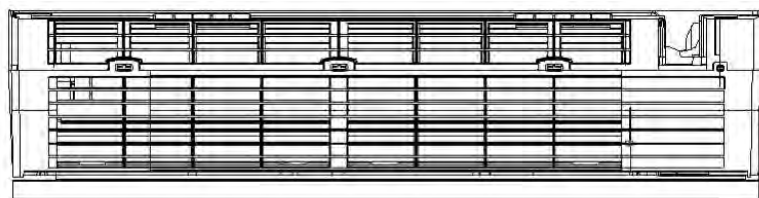

Model	A	B	C
WT036GLSI20HLF	46-3/4 in	13-3/8 in	10-5/8 in
	1186 mm	340 mm	268 mm

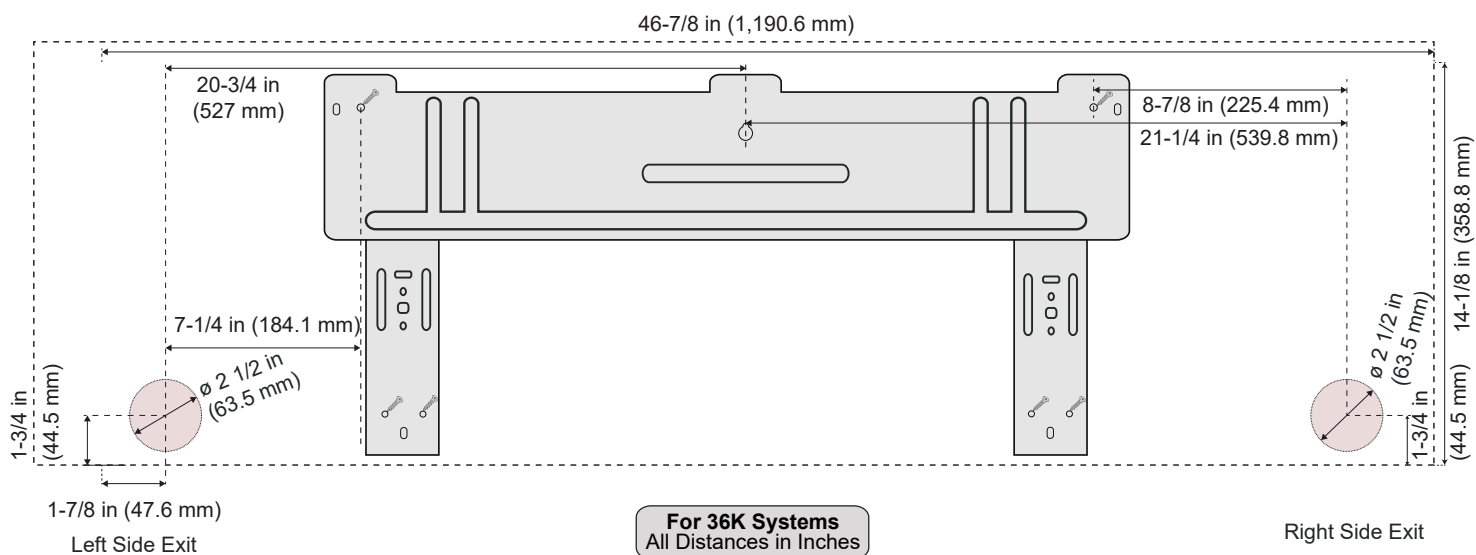

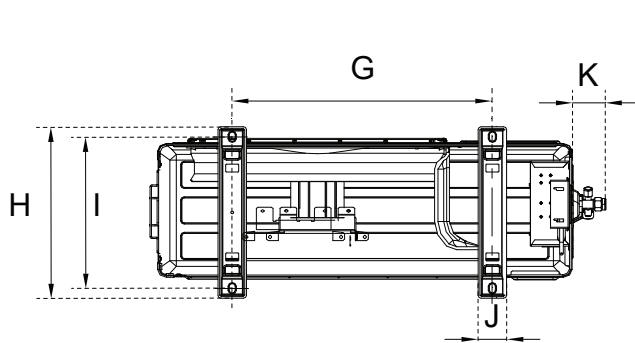

**Underside View**

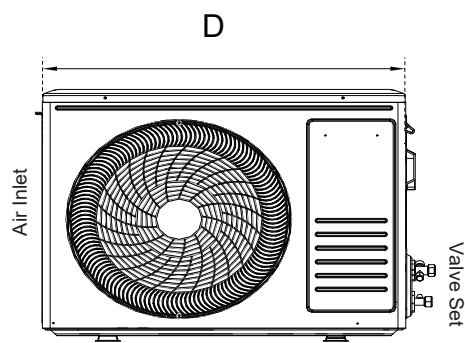

**Front View**

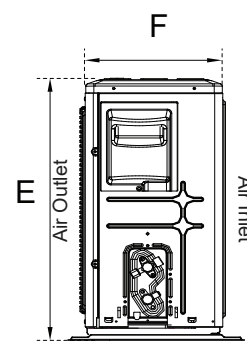

**Side View**

Model	D	E	F	G	H	I	J	K
YN036GLSI20RPF	35-7/8 in	31-5/8 in	14-1/8 in	23-7/8 in	16-5/8 in	15-3/8 in	2-3/8 in	2-1/2 in
	910 mm	803 mm	359 mm	607 mm	421 mm	390 mm	60 mm	63 mm

## Warranty Information and Length



Complete warranty details are available with the vendor or online at <https://www.pdhvac.com/support/warranty/>. This high-quality system is eligible for up to a 5-year limited warranty on the compressor, and 5 years on other internal parts. To qualify for this warranty, the system must be installed within 90 days and registered properly. All other installations that are unregistered qualify for only 1-year parts/compressor warranty.

## Outstanding Features

- LED Display
- Energy Saving
- Ultra-Thin Design
- Dual Drain Options
- Customizable Timer
- Eco-Friendly Refrigerant
- Whisper-Quiet Operation
- Power Loss Memory Recovery

## Available Accessories

Part Number	Description
IKT-LCVR4P-KIT	<i>Decorative PVC Line Cover Kit</i>
IKT-LNBR-1/4-3/8	<i>BendAid Flexible Easy Bender Kit</i>
BRK-FRM-C-2P	<i>Folding Mounting Bracket w/ Leveler</i>
IKT-UVL32UL-AG	<i>UVC Bacterial Disinfection Kit</i>
IKT-SURPRK-DV2	<i>Ultimate Surge and Power Protection</i>