

Job Name:	
Submitted By:	



Submittal Sheet For:	WT036GLUI17HLD / YN036GLUI17RPD
----------------------	--

Date _____

Ref. _____

Wall-Mounted Ductless 17SEER Inverter Heat Pump

System Full Set Model: **WYT036GLUI17RL**

AHRI Reference Number: **217048738**

Cooling Mode Performance

Rated Cooling	35,000 BTU/hr
Ambient Range	54~122°F
SEER2 Rating	17 BTU/W·h
EER2 Rating	9.5 BTU/W·h

* 100% Capacity @ Indoor DB 80°F / WB 67°F / m.w. 16 ft. lineset

Heating Mode Performance

Rated Heating	35,400 BTU/hr
Ambient Range	5~86°F
HSPF2 IV (V)	8.5 (7.5) BTU/W·h
COP2 (47°F)	3.2 W/W

Low Heat (17°F) = 20,400 BTU / COP2 (5°F) = 1.8 W/W



Wall-Mounted Indoor Unit



Outdoor Condensing Unit



16 ft. Installation Kit (Pipe + Cable)



Handheld Remote Controller

Electrical Information

Rated Input (W)	Cooling	Heating
	3,350	3,000
Rated Current (A)	14.6	13.2
Breaker Needed	35A (Double-Pole)	
Power Supply	208~230V, 1 Ph, 60Hz	

Piping and Refrigerant

Liquid Line (OD)	1/4 in
Suction Line (OD)	5/8 in
Refrigerant Precharge	R32 (16 ft.)
Max Length/Height Diff.	100 ft. / 65 ft.

This combination is AHRI/ETL/ISO certified.



Interior Unit (Air Handler) Specifications

Type	Heat Pump
Sound Level (dBA)	55 (Turbo) / 52 (Hi) / 46 (Med) / 41 (Lo) / 39 (Mute)
Auto Air Circulation	2-Way Louver (Up-Down + Left-Right)
Dimensions (WDH)	46-7/8 in x 10-1/4 in x 14-1/4 in
Weight (lbs)	38.6

Exterior Unit (Condenser) Specifications

Sound Level (dBA)	63
Recommended Room Size	1,000~1,400 Sq. ft.
Minimum Room Size	63 Sq. ft.
Compressor	Inverter-Driven Rotary
Dimensions (WDH)	38-1/2 in x 16-1/2 in x 31-5/8 in
Weight (lbs)	105.8

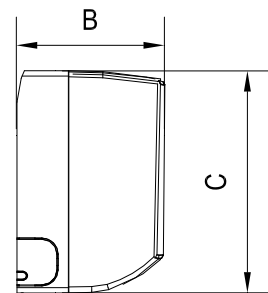
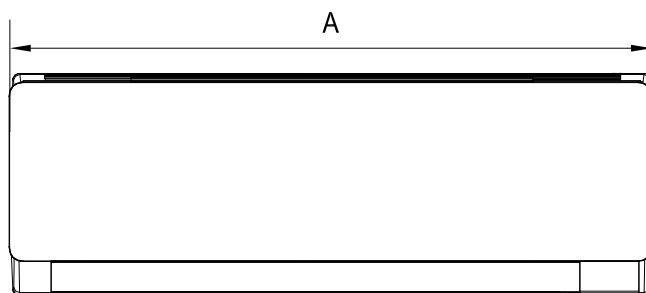
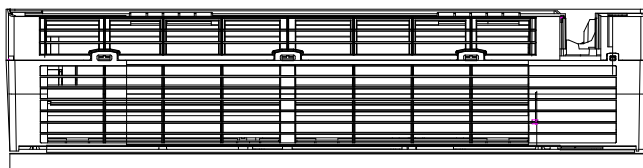

Model	A	B	C
WT036GLUI17HLD	46-3/4 in 1,186 mm	13-3/8 in 340 mm	10-5/8 in 268 mm

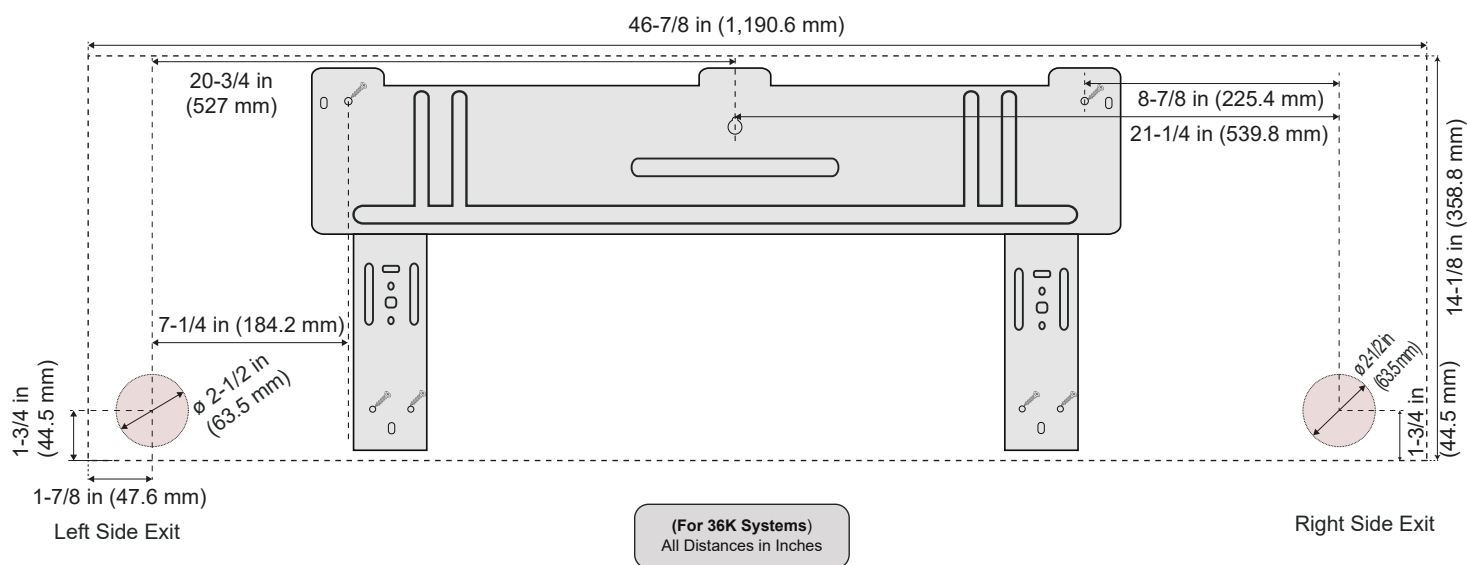

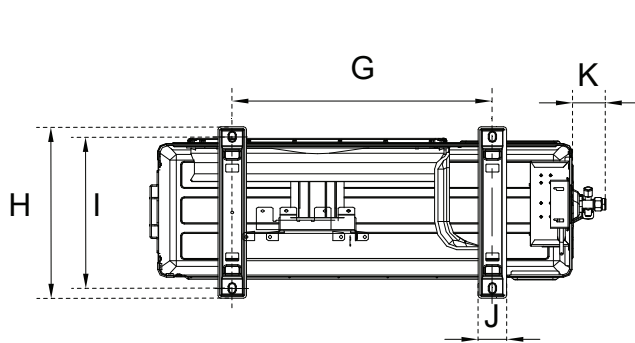

Underside View

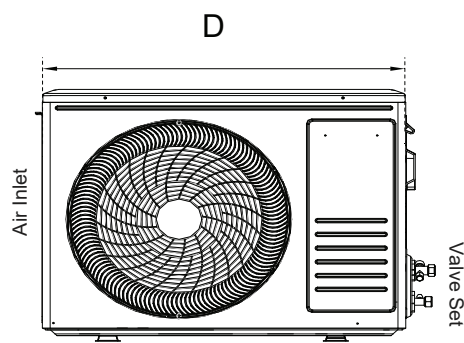

Front View

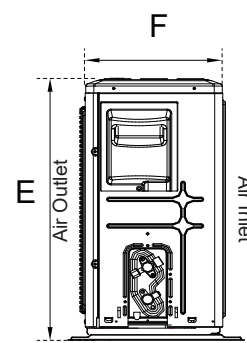

Side View

Model	D	E	F	G	H	I	J	K
YN036GLUI17RPD	35-3/4 in	31-5/8 in	14-1/8 in	23-7/8 in	16-5/8 in	15-3/8 in	2-3/8 in	2-1/2 in
	910 mm	803 mm	359 mm	607 mm	421 mm	390 mm	60 mm	63 mm

Warranty Information and Length



Complete warranty details are available with the vendor or online at <https://www.pdhvac.com/support/warranty/>. This high-quality system is eligible for up to a 5-year limited warranty on the compressor, and 5 years on other internal parts. To qualify for this warranty, the system must be installed within 90 days and registered properly. All other installations that are unregistered qualify for only 1-year parts/compressor warranty.

Outstanding Features

- LED Display
- Energy Saving
- Ultra-Thin Design
- Dual Drain Options
- Customizable Timer
- Eco-Friendly Refrigerant
- Whisper-Quiet Operation
- Power Loss Memory Recovery

Available Accessories

Part Number	Description
IKT-LCVR4P-KIT	<i>Decorative PVC Line Cover Kit</i>
TST-LCACWIFIKP	<i>Smart-WiFi Wired Wall Thermostat Kit</i>
BRK-FRM-C-2P	<i>Folding Mounting Bracket w/ Leveler</i>
IKT-UVL32UL-AG	<i>UVC Bacterial Disinfection Kit</i>
ICM517	<i>Ultimate Surge and Power Protection</i>