

210x297mm

# Retractable Safety Gate--SG018

**⚠ IMPORTANT! READ AND FOLLOW THESE INSTRUCTIONS CAREFULLY AND KEEP FOR FUTURE REFERENCE.**



Component Parts

Spacers	Brackets	Fixing screws	Scale Direction
SPA1-Ax1	A1x2	M8x40 x20	
SPA1-Bx1	A3x4	PA4x50 x20	
SPA2-Ax1	A2x2	PA4x25 x20	

### Warm Notice :

**\*Before installation, make sure the suitable screws for the surface.**

\*Shorter Screws are used on the wood surface.

PA4x25

**Note 1:** According to the hardness of wood surface, if necessary you may pre-drill holes within 2.5mm diameter before applying the screw.

PA4x50

M8x40

**\*Longer screws and Expansion Screws are used in solid wall such as concrete wall or tile wall which with skirt board.**

**Note 2:** Please pre-drill the holes on the hardwall before use expansion tube.

PA4x25

M8x40

**\*Shorter screws and Expansion Screws are used in solid wall such as concrete wall or tile wall which without skirt board.**

### Location Fixing Position

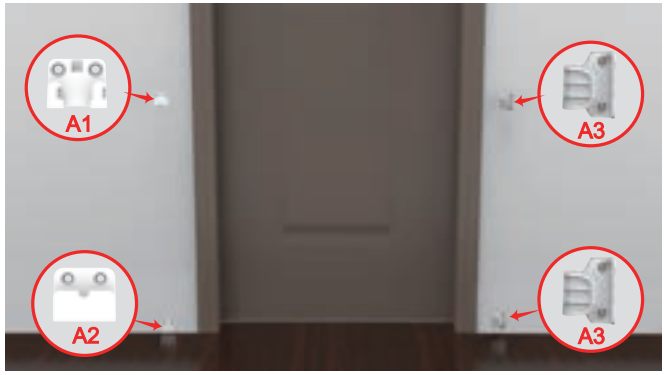

### Warning

**⚠ Before installation, make sure 2pcs A3 to be used on proper surface.**

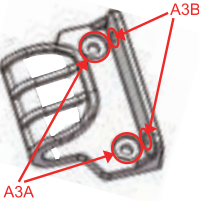

- \* If A3 are fix on the same plane, compare to the surface of A1& A2, screws should be mounting on the A3A holes.
- \* If A3 are fix on the intersection angle, compared to the surface of A1&A2, screws should be mounting on the A3B holes.

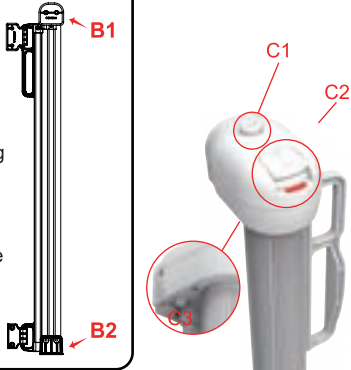

### For doorways, hallways and bottom of stairs.



Stairways



Door frame



Doorways



Baseboard

### Spacer installation

**\* Build up the wall areas equivalent to thickness of baseboard (Skirt board) with spacers.**

**\* Install the gate very close to the ground.**

**\* To fit spacers to bracket and hook, follow the below step:**

1. Spacer 1: SPA1-A x1 13mm thickness + SPA1-B x1 5mm thickness
2. Spacer 2: SPA2-A x1 13mm thickness + SPA2-B x1 5mm thickness
3. SPA1-A x1 & SPA2-A x1 can be single use for the baseboard (skirt board) in 13mm thickness
4. SPA1-A x1 + SPA1-B x1 + A1 & SPA2-A + SPA2-B + A3 can be used together for the baseboard (skirt board) in 18mm thickness.
5. Install the spacers SPA1-A or SPA1-A + SPA1-B under A1 and spacers SPA2-A or SPA2-A + SPA2-B under A3.

Spacer 1

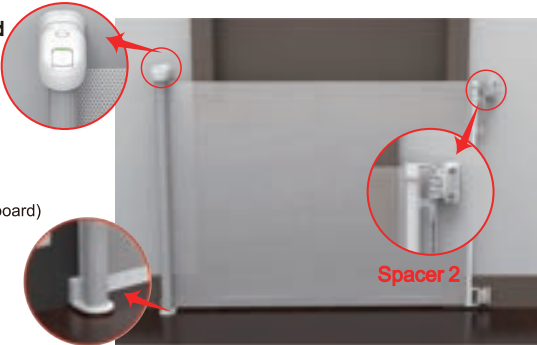

Skirting board

Spacer 1

A1+①+②

①: SPA1-A

②: SPA1-B

A1

13mm

5mm

Spacer 2

A3+①+②

①: SPA2-A

②: SPA2-B

A3

13mm

5mm

## Installation

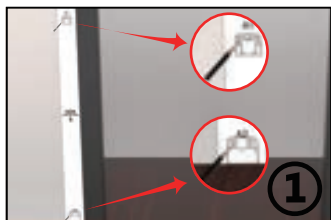

1. Stick the scale direction for left at the desired position most close to the floor, mark the screw holes of A1&A2 and make sure A1&A2 are vertical, also be sure to fit the bottom line of the scale.

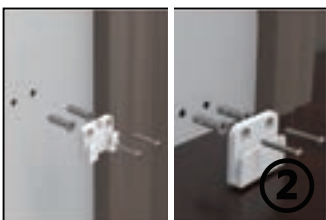

2. Drill the marked location and then insert the expansion tube and use the screws to fix A1&A2 firmly on the wall.

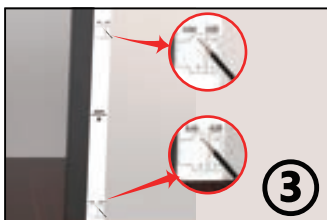

3. Stick the scale direction for right side at the other side of your desired position, mark the screw holes of two A3 and make sure two A3 are vertical, also be sure to fit the bottom line of scale.

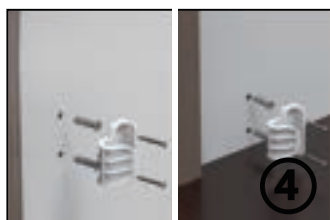

4. Fix A3 with screws on the surface firmly.

**Take note 1** please adjust the position of A1, A2 and 2XA3, then pull out the mesh to check it if it is balance, and make sure that the mesh is level.

**Take note 2** Please pre-drill the holes on the hardwall before use expansion tube.



5. Place the base B2 into A2, buckle B1 into A1. Make sure that A1&B1 is buckled into the gap well respectively. At this time the side tag will change from red to green for normal use.



6. Make sure the gate is locked position.

## To Use

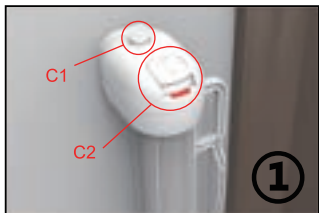

1. Press C1 in the same time push forward C2 to unlock the gate. The tag on the C2 will change to red for extendable mesh.

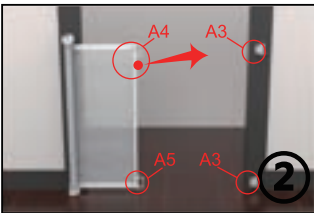

2. Hold the handle and pull out mesh barrier, keep the mesh surface vertically flat, hook A4 & A5 to both A3 well respectively.

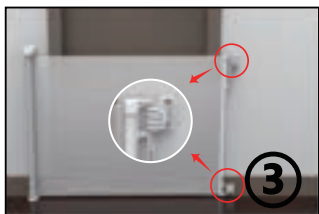

3. Make sure that A4 and A5 are hooked well in A3.

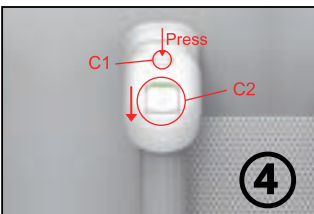

4. Press the button C1 to lock the gate. Make sure the tag on the button C2 change to green completely.

## To Remove The Gate From The Wall

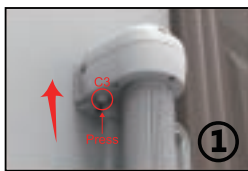

Press C3 button, and lift it up to remove the gate easily.

## Improper Installation

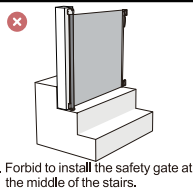

1. Forbid to install the safety gate at the middle of the stairs.



2. Forbid to install the safety gate at the top of the stairs.

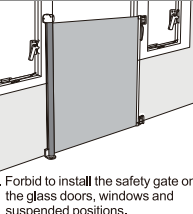

3. Forbid to install the safety gate on the glass doors, windows and suspended positions.

## Troubleshooting:

If hooking the A4&A5 into the brackets is difficult, verify the following:

- A. The brackets are level.
- B. The horizontal distances between the top brackets and the bottom brackets are equal.
- C. The brackets are directly vertical (plumb) of each other on each side of the doorway. For best results, use a slow and smooth motion to hook the A4&A5 to the brackets.

## ⚠ WARNING

1. MODEL NO.: SG018
2. Safety gate is suitable for use with children from 6 months up to 24 months of age.
3. This product is best applied for opening width within 100cm.
4. To prevent serious injury or death, securely install gate or enclosure and use according to manufacturer's instructions.
5. Never leave child unattended when using this product.
6. Incorrect installation can be dangerous.
7. Do not use the safety gate if any components are damaged or missing.
8. The safety gate must not be fitted across windows and suspended positions.
9. Never use with a child able to climb over or dislodge the gate or enclosure.
10. Danger to older children if climbing over the product.
11. Forbid to install this product on glass doors. Install this product against reliable doors or walls.
12. Forbid to install the safety gate at the top of the stairs.
13. If the product is used at the bottom of stairs, in order to prevent child climbing upstairs, it should be positioned on the lowest step.
14. Do not put any goods which can be grabbed by children or pets near this product to prevent injury.
15. Before using this product, carefully inspect for any loose parts and whether any parts needs to be tightened.
16. Make sure the product to be installed is horizontal and flat on the floor.
17. Regularly check that the safety gate is properly installed and secured.
18. Safety gate must be fitted between rigid surfaces such as timber or hard wall.