

# FROM THE FOUNDER OF THE #VIKISEWS BRAND

---



Back in 2016, when I was working on my first set of sewing instructions, I was trying to write them in such a way that even a complete beginner could easily understand and use them to create their very first garment. These instructions laid the foundation for the Vikisews brand, its vision and its mission. I wanted to create modern patterns with the utmost detailed and clear instructions.

Now, with each new collection we are constantly improving our instructions, amending them and adding more relevant details. By the time the final product reaches you, our drafters, correctors, and editors would have spent weeks perfecting every word and every photograph. If you compile a few of our instructions together, you will get a sewing manual that will assist you in sewing all kinds of garments at any difficulty level.

And I would be very happy if these instructions helped you to turn your hobby into a lifelong passion... Enjoy the process! Create your ultimate dream wardrobe! Wear your garments proudly for years to come!

If you have any questions, please contact us at [info@vikisews.com](mailto:info@vikisews.com) — we are always there to help.



## MAIDY PATTERN DESCRIPTION

---

Maidy is a semi-fitted bomber jacket with extended shoulders and a boxy silhouette. The front and back feature yokes and princess seams. There is a welt pocket in the princess seam of the right-hand side of the front. The left-hand side of the front features a chest zipper pocket. The stand collar is made of ribbing. The long set-in sleeves are made-up of two pieces. The bottom edge of the garment as well as the bottom edges of the sleeves are finished with ribbing. The bomber jacket is fully lined and fastens with a separating zipper. Maidy is below-waist length.



## IMPORTANT!

---

The contents of this pattern are copyright protected and belong exclusively to Vikisews. You may use Vikisews patterns for personal use. It is prohibited to share Vikisews patterns and instructions with third parties, as well as to publish patterns and instructions online for public access. **Non-compliance with the mentioned rules is a violation of the US copyright law and may result in civil liability and criminal prosecution.**

You may use Vikisews patterns for commercial use, to sew custom-made garments and/or create fashion collections, on the condition that the patterns are solely used in a manufacturing setting and are not further shared with individuals.

# TOTAL EASE ALLOWANCE

Ease type	Ease measurement, cm		
	XS-S	M-L	XL
Bust ease	26.8–34.9	22.8–34.9	22.8–30.9
Waistline ease	40.1–48.4	36.6–48.8	37–45.2
Upper arm ease	10.7–13.6	8.4–12.7	7.5–10.5

Ease type	Ease measurement, in		
	XS-S	M-L	XL
Bust ease	10 1/2–13 3/4	9–13 3/4	9–12 1/8
Waistline ease	15 3/4–19	14 3/8–19 1/4	14 5/8–17 3/4
Upper arm ease	4 1/4–5 3/8	3 1/4–5	3–4 1/8

# GARMENT LENGTH, SLEEVE LENGTH

Height, cm	Garment length including waistband, cm	Sleeve length including cuff, cm
1 (154–160)	46.3–49.3	62.3–63.4
2 (162–168)	47.8–50.8	64.2–65.3
3 (170–176)	50.7–53.7	66.2–67.2
4 (178–184)	53.8–56.8	68.2–69.1

Height, ft	Garment length including waistband, in	Sleeve length including cuff, in
1 (5'1"–5'3")	18 1/4–19 3/8	24 1/2–25
2 (5'4"–5'6")	18 7/8–20	25 1/4–25 3/4
3 (5'7"–5'9")	20–21 1/8	26 1/8–26 1/2
4 (5'10"–6'1")	21 1/8–22 3/8	26 7/8–27 1/4

10. One closed-bottom zipper for the chest pocket:

Size	XS-S	M-L	XL
cm	9.5	10.7	11.9
inches	3 3/4	4 1/4	4 5/8

11. Four top zipper stoppers (or two top stoppers for the separating zipper and one bottom stopper for the closed-bottom zipper)

12. One pair of shoulder pads

13. One pair of sleeve heads

14. Matching thread — 1 spool

15. Matching topstitching thread (for example, Madeira No. 35) — 1 spool

## TOOLS AND EQUIPMENT

- sewing machine for construction
- stitch-in-the-ditch foot for the sewing machine
- teflon or walking foot for the sewing machine
- one-sided foot for the sewing machine

## PATTERN PIECES LIST

### 1. From main fabric:

- front — cut 2
- side front — cut 2
- front yoke — cut 2
- back — cut 1
- side back — cut 2
- back yoke — cut 1 on fold
- top sleeve — cut 2
- bottom sleeve — cut 2
- front facing — cut 2
- back neck facing — cut 1 on fold
- welt — cut 1
- chest pocket frame — cut 1
- chest pocket facing — cut 1

### 2. From lining fabric:

- front lining — cut 2
- back lining — cut 1 on fold
- top sleeve lining — cut 2
- bottom sleeve lining — cut 2
- side pocket lining — cut 2
- chest pocket top lining — cut 1
- chest pocket bottom lining — cut 1



Press the seam allowances towards the front.

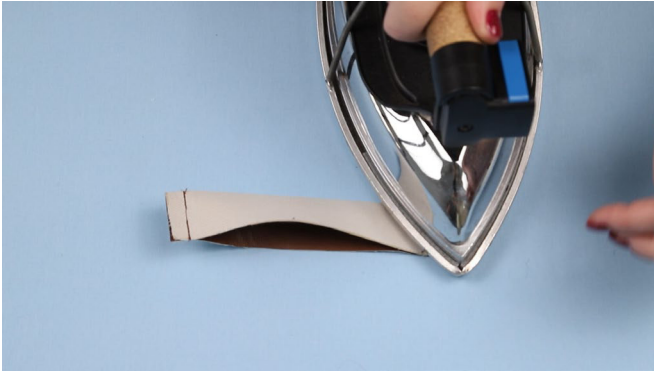

Fold the welt piece in half lengthwise, right sides together. Align the short edges, pin, and machine-stitch, backstitching at the beginning and end. Press the seams flat.



Trim the seam allowances by half to reduce the bulk.

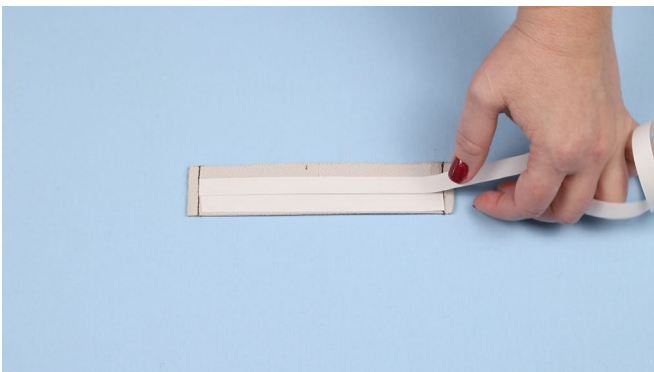

Place fusible web tape or double-sided adhesive tape onto either side of the welt turned wrong side out. Apply it to the area between the fold and the seam allowance. Remove the backing paper.



Turn the welt piece right side out and push out the corners. Align the bottom edges and press using a pressing cloth and holding the piece down with the iron for a few seconds. This will make the welt layers stick together.