

CATALOGUE 2023



DOT/SAE FITTINGS
SERIES ND



SOLUTIONS FOR THE TRANSPORTATION SECTOR



Being one of our three strategic business sectors, Camozzi Automation offers the **Transportation** industries a wide range of products. These products are ready for use in the harshest conditions, are reliable and efficient, in order to keep **you** moving.

In close cooperation with our customers and partners, we develop and produce standard products and customised solutions, always focussing on three main targets: **high performance, smart design and excellent quality**.

Developing products that can operate under extreme temperatures, in dirty or corrosive environments and tolerant of high mechanical loads and vibrations is **the mission** that drives our experienced and motivated engineers.

A remarkable level of design and production know-how, combined with an enterprising spirit and a commitment to listen to customers, is for us the **key to success** in the **Transportation** sector.

Our **worldwide customer base** consists of leading OEMs, Tier 1 System Suppliers, Component Manufacturers, Body Builders and well-known players in the Aftermarket and Repair business.

We always follow one leading principle: **"The customer first – always"**.

Camozzi Automation's long history in the **Transportation** sector has brought us into the supply chain of many different vehicle classes, including **Road, Off-Road** and **Rail** operations.

We are active in all the major application fields, including **Chassis, Cabin & Body, Mobile Automation** and **Powertrain**.

Our offering starts from fittings for multiple fluids like air, fuel, water, oil or grease and extends over a wide range of control valves for gases & fluids, to pneumatic and electric actuators, filters, regulators and other complementary products. This comprehensive range makes us **the right partner for your project**.

Connection or Actuation, On/Off or Proportional, Analogue or CAN-BUS, IATF 16949 or IRIS, **we talk your language**.

**TRUCK
& TRAILER**



**BUS
& COACH**



**OFF
HIGHWAY**



**PASSENGER CAR
& LIGHT DUTY**



RAILWAY



Truck & Trailer

Commercial vehicles are a demanding field of application. Trucks must perform in various climatic and environmental conditions.

LIFTING AND HANDLING ENGAGEMENT SYSTEMS

LOAD SENSING AND ADJUSTMENT

AIR TANKS

TIRE INFLATION

AIR BRAKES

LIFT AXLE

FUEL SYSTEMS



Maximum uptime and reduced cost of ownership are the primary needs. Components for this market, whether provided to the OEM, the bodybuilder or the aftermarket, need to be **reliable** and **robust** to keep the wheels turning and **your business going**.

TRANSMISSIONS







ENGINE











COOLING SYSTEMS

CAB CONTROLS



General index

Straight connectors		"Y" and 45° connectors		
	Page		Page	
	Mod. ND6510 Male Connector	9	 Mod. ND6100 Male Non-Swivel 45°	13
	Mod. ND6512 Male Connector	9	 Mod. ND6110 Male Swivel 45°	13
	Mod. ND6463 Female Connector	10	 Mod. ND6450 Male Swivel "Y"	14

Elbow connectors		Tee connectors		
	Page		Page	
	Mod. ND6500 Male Non-Swivel Elbow	10	 Mod. ND6410 Male Non-Swivel Branch Tee	14
	Mod. ND6503 Female Non-Swivel Elbow	11	 Mod. ND6413 Female Non-Swivel Branch Tee	14
	Mod. ND6520 Male Swivel Elbow	11	 Mod. ND6420 Male Non-Swivel Run Tee	15
	Mod. ND6522 Male Swivel Elbow	12	 Mod. ND6430 Male Swivel Branch Tee	15
	Mod. ND6523 Female Swivel Elbow	12	 Mod. ND6440 Male Swivel Run Tee Fittings	16
			 Mod. ND6433 Female Swivel Branch Tee	16

Series ND Nickel-Plated Brass DOT Fittings - NPTF/Inch

SERIES ND



Series ND fittings has been designed to meet all requirements for Federal DOT standards 571.106³² 49 CFR Ch. V and all requirements for SAE J2494-3. They offer excellent reliability and ease of assembly.

NOTE: The US Department of Transportation prohibits the use of air brake tubing assemblies between the frame and axle or between a towed and towing vehicle.

This range of electrolytic nickel plated brass body fittings is ideal for compressed air applications. Each fitting is pre-coated with tread sealant, uses a low temperature BUNA-N o-ring, and is for use with SAE J844 A & B Nylon® tubing.

Main technical features

Material	Electrolytic Nickel-plated brass OT58 UNI 5705, Tube-support/insert in glass-reinforced Nylon
Collet	Brass OT58, nickel plated
O-ring	Low temperature Buna-N (NBR)
Threads	10/32 UNF, 1/8", 1/4", 3/8", 1/2", 3/4" NPTF
Temperature Range	-58°F - 200°F
Operating pressure	0 - 275 psi (3/4" tube size operating pressure = 0 - 175 psi)
Fluid	Compressed air [for other types of fluid please contact your local Camozzi branch]
Tube diameter	5/32", 1/4", 3/8", 1/2", 5/8", 3/4" OD

Our Certifications

Working from a "Total Quality" perspective also means proving Camozzi Automation's commitment through the achievement of international certifications. Camozzi's primary goals include quality, safety and protecting the environment.



Looking for more information and our latest certificates? Scan the QR code.

Straight connectors

Male Connector Fittings Mod. ND6510

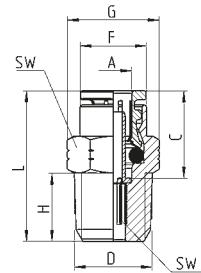

DIMENSIONS (in inches)									
Mod.	A OD	D NPTF	C	F	G	H	L	SW	SW1
ND6510 53-02	5/32	1/8	0.520	0.346	0.548	0.315	0.748	0.472	0.098
ND6510 53-04	5/32	1/4	0.520	0.346	0.639	0.472	0.906	0.551	0.098
ND6510 04-02	1/4	1/8	0.606	0.461	0.548	0.315	0.925	0.472	0.157
ND6510 04-04	1/4	1/4	0.606	0.461	0.639	0.472	1.043	0.551	0.157
ND6510 04-06	1/4	3/8	0.606	0.461	0.868	0.472	1.063	0.748	0.157
ND6510 04-08*	1/4	1/2	0.606	0.461	1.004	0.610	0.906	0.866	0.157
ND6510 06-02	3/8	1/8	0.787	0.606	0.776	0.315	1.201	0.669	0.197
ND6510 06-04	3/8	1/4	0.787	0.606	0.776	0.472	1.358	0.669	0.276
ND6510 06-06	3/8	3/8	0.787	0.606	0.868	0.472	1.161	0.748	0.276
ND6510 06-08	3/8	1/2	0.787	0.606	1.005	0.610	1.181	0.866	0.276
ND6510 08-04	1/2	1/4	0.787	0.736	0.868	0.472	1.358	0.748	0.276
ND6510 08-06	1/2	3/8	0.787	0.736	0.868	0.472	1.319	0.748	0.394
ND6510 08-08	1/2	1/2	0.787	0.736	1.005	0.610	1.280	0.866	0.394
ND6510 08-12	1/2	3/4	0.787	0.736	1.233	0.610	1.240	1.063	0.394
ND6510 10-06	5/8	3/8	0.976	0.925	1.096	0.472	1.575	0.945	0.394
ND6510 10-08	5/8	1/2	0.976	0.925	1.096	0.610	1.693	0.945	0.512
ND6510 12-06*	3/4	3/8	27.8	1.055	1.232	0.472	1.594	1.063	0.394
ND6510 12-08	3/4	1/2	1.094	1.055	1.233	0.610	1.732	1.063	0.512
ND6510 12-12	3/4	3/4	1.094	1.055	1.233	0.610	1.417	1.063	0.512

*Produced Upon Request - Contact Camozzi for Availability

Male Connector Fittings Mod. ND6512

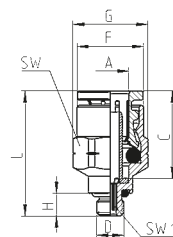

DIMENSIONS (in inches)									
Mod.	A OD	D NPTF	C	F	G	H	L	SW	SW1
ND6512 04-32	1/4	10/32UNF	0.520	0.307	0.346	0.157	0.787	0.315	0.079
ND6512 53-32	5/32	10/32UNF	0.606	0.461	0.520	0.157	0.866	0.472	0.079

Female Connector Fittings Mod. ND6463

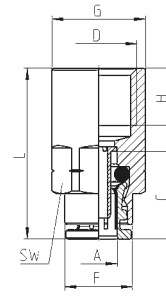

SERIES ND

DIMENSIONS (in inches)								
Part No.	A OD	D NPTF	C	F	G	H	L	SW
ND6463 53-02	5/32	1/8	0.520	0.354	0.512	0.276	0.945	0.472
ND6463 53-04	5/32	1/4	0.520	0.354	0.650	0.394	1.102	0.591
ND6463 04-02	1/4	1/8	0.606	0.461	0.512	0.276	1.024	0.472
ND6463 04-04	1/4	1/4	0.606	0.469	0.650	0.394	1.181	0.591
ND6463 04-06*	1/4	3/8	0.606	0.461	0.787	0.413	1.220	0.472
ND6463 06-02	3/8	1/8	0.787	0.606	0.728	0.276	1.201	0.669
ND6463 06-04	3/8	1/4	0.787	0.606	0.728	0.394	1.339	0.669
ND6463 06-06	3/8	3/8	0.787	0.606	0.787	0.413	1.378	0.669
ND6463 06-08*	3/8	1/2	0.787	0.606	0.945	0.551	1.535	0.669
ND6463 06-12*	3/8	3/4	0.787	0.606	1.181	0.551	1.535	0.669
ND6463 08-02*	1/2	1/8	0.787	0.736	0.098	0.276	1.201	0.748
ND6463 08-04	1/2	1/4	0.787	0.736	0.807	0.394	1.339	0.748
ND6463 08-06	1/2	3/8	0.787	0.736	0.807	0.413	1.378	0.748
ND6463 08-08	1/2	1/2	0.787	0.736	0.945	0.551	1.516	0.748
ND6463 08-12*	1/2	3/4	0.787	0.736	1.181	0.551	1.535	0.748
ND6463 10-06*	5/8	3/8	0.976	0.965	0.965	0.413	1.575	0.866
ND6463 10-08	5/8	1/2	0.976	0.925	1.043	0.551	1.732	0.945

*Produced Upon Request - Contact Camozzi for Availability

Elbow connectors

Male Non-Swivel Elbow Fittings Mod. ND6500

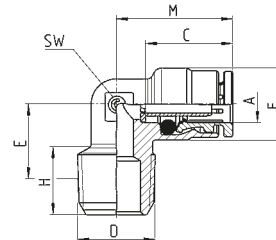

DIMENSIONS (in inches)								
Model	A OD	D NPTF	C	F	E	H	M	SW
ND6500 04-02	1/4	1/8	0.606	0.500	0.472	0.354	0.807	0.354
ND6500 04-04	1/4	1/4	0.606	0.500	0.472	0.472	0.807	0.354
ND6500 04-06	1/4	3/8	0.606	0.500	0.531	0.512	0.906	0.472
ND6500 04-08*	1/4	1/2	0.606	0.500	0.728	0.630	0.807	0.591
ND6500 06-02	3/8	1/8	0.787	0.650	0.531	0.335	1.043	0.512
ND6500 06-04	3/8	1/4	0.787	0.650	0.551	0.492	1.043	0.512
ND6500 06-06	3/8	3/8	0.787	0.650	0.512	0.472	1.043	0.512
ND6500 06-08	3/8	1/2	0.787	0.650	0.728	0.630	1.063	0.591
ND6500 08-04	1/2	1/4	0.787	0.768	0.610	0.492	1.102	0.591
ND6500 08-06	1/2	3/8	0.787	0.768	0.571	0.492	1.102	0.591
ND6500 08-08	1/2	1/2	0.787	0.768	0.728	0.630	1.102	0.591
ND6500 08-12*	1/2	3/4	0.787	0.768	0.827	0.630	1.102	0.945
ND6500 10-06	5/8	3/8	0.976	0.984	0.689	0.492	1.378	0.787
ND6500 10-08	5/8	1/2	0.976	0.984	0.748	0.610	1.378	0.787
ND6500 12-06*	3/4	3/8	1.094	1.122	0.768	0.492	1.437	0.945
ND6500 12-08	3/4	1/2	1.094	1.122	0.827	0.630	1.437	0.945
ND6500 12-12	3/4	3/4	1.094	1.122	0.827	0.630	1.437	0.945

*Produced Upon Request - Contact Camozzi for Availability

Female Non-Swivel Elbow Fittings Mod. ND6503

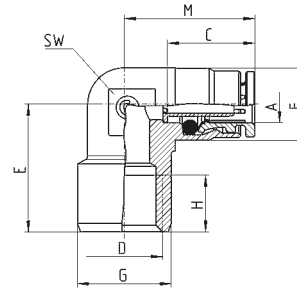

DIMENSIONS (in inches)									
Mod.	A OD	D NPTF	C	E	F	G	H	M	SW
ND6503 04-02	1/4	1/8	0.606	0.709	0.500	0.512	0.276	0.807	0.354
ND6503 04-04	1/4	1/4	0.606	0.886	0.500	0.650	0.394	0.906	0.512
ND6503 04-06	1/4	3/8	0.606	1.102	0.587	0.787	0.413	0.906	0.591
ND6503 06-02	3/8	1/8	0.787	0.748	0.650	0.512	0.276	1.043	0.512
ND6503 06-04	3/8	1/4	0.787	0.886	0.650	0.650	0.394	1.043	0.512
ND6503 06-06	3/8	3/8	0.787	1.102	0.650	0.787	0.413	1.063	0.591
ND6503 08-04	1/2	1/4	0.787	0.945	0.768	0.650	0.394	1.102	0.591
ND6503 08-06	1/2	3/8	0.787	1.102	0.768	0.787	0.413	1.102	0.591
ND6503 08-08	1/2	1/2	0.787	1.260	0.768	0.945	0.551	1.142	0.787

Male Swivel Elbow Fittings Mod. ND6520

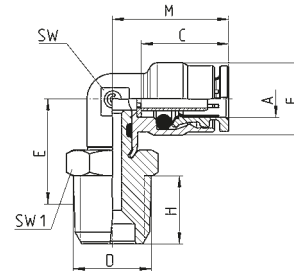

DIMENSIONS (in inches)									
Mod.	A OD	D NPTF	C	F	E	H	M	SW	SW1
ND6522 04-32	1/4	10/32UNF	0.606	0.500	0.531	0.157	0.807	0.354	0.394
ND6520 53-02	5/32	1/8	0.520	0.354	0.650	0.315	0.689	0.315	0.472
ND6520 53-04	5/32	1/4	0.520	0.354	0.689	0.472	0.689	0.315	0.551
ND6520 04-02	1/4	1/8	0.606	0.500	0.669	0.315	0.807	0.354	0.472
ND6520 04-04	1/4	1/4	0.606	0.500	0.709	0.472	0.807	0.354	0.551
ND6520 04-06	1/4	3/8	0.606	0.500	0.689	0.472	0.807	0.354	0.748
ND6520 04-08	1/4	1/2	0.606	0.500	0.876	0.610	0.807	0.354	0.866
ND6520 06-02	3/8	1/8	0.787	0.650	0.787	0.315	1.043	0.512	0.551
ND6520 06-04	3/8	1/4	0.787	0.650	0.827	0.472	1.043	0.512	0.551
ND6520 06-06	3/8	3/8	0.787	0.650	0.807	0.472	1.043	0.512	0.748
ND6520 06-08	3/8	1/2	0.787	0.650	0.886	0.610	1.043	0.512	0.866
ND6520 06-12*	3/8	3/4	0.787	0.650	0.886	0.610	1.043	0.512	1.063
ND6520 08-04	1/2	1/4	0.787	0.768	0.886	0.472	1.102	0.591	0.669
ND6520 08-06	1/2	3/8	0.787	0.768	0.846	0.472	1.102	0.591	0.748
ND6520 08-08	1/2	1/2	0.787	0.768	0.925	0.610	1.102	0.591	0.866
ND6520 08-12	1/2	3/4	0.787	0.768	0.925	0.610	1.102	0.591	1.063
ND6520 10-06	5/8	3/8	0.976	0.984	1.063	0.472	1.378	0.787	0.866
ND6520 10-08	5/8	1/2	0.976	0.984	1.122	0.610	1.378	0.787	0.866
ND6520 12-06*	3/4	3/8	1.094	1.122	1.043	0.472	1.437	0.945	0.945
ND6520 12-08	3/4	1/2	1.094	1.122	1.181	0.610	1.437	0.945	0.945
ND6520 12-12	3/4	3/4	1.094	1.122	1.181	0.610	1.437	0.945	1.063

*Produced Upon Request - Contact Camozzi for Availability

Male Swivel Elbow Fittings Mod. ND6522

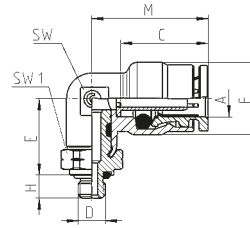

DIMENSIONS (in inches)									
Mod.	A OD	D NPTF	C	F	E	H	M	SW	SW1
ND6522 04-32	1/4	10/32UNF	0.606	0.500	0.531	0.157	0.807	0.354	0.394

Female Swivel Elbow Fittings Mod. ND6523

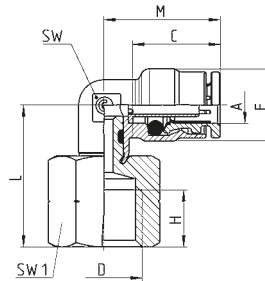

DIMENSIONS (in inches)									
Mod.	A OD	D NPTF	C	F	H	L	M	SW	SW1
ND6523 53-02	5/32	1/8	0.520	0.354	0.276	0.787	0.689	0.315	0.512
ND6523 53-04	5/32	1/4	0.520	0.354	0.394	0.945	0.689	0.315	0.669
ND6523 04-02	1/4	1/8	0.606	0.500	0.276	0.827	0.807	0.354	0.512
ND6523 04-04	1/4	1/4	0.606	0.500	0.394	0.984	0.807	0.354	0.669
ND6523 04-06	1/4	3/8	0.606	0.500	0.413	0.984	0.807	0.354	0.787
ND6523 06-02*	3/8	1/8	0.787	0.650	0.276	0.945	1.043	0.512	0.551
ND6523 06-04	3/8	1/4	0.787	0.650	0.394	1.102	1.043	0.512	0.669
ND6523 06-06	3/8	3/8	0.787	0.650	0.413	1.122	1.043	0.512	0.787
ND6523 06-08*	3/8	1/2	0.787	0.650	0.551	1.299	1.043	0.512	0.945
ND6523 08-04	1/2	1/4	0.787	0.650	0.394	1.122	1.102	0.591	0.669
ND6523 08-06	1/2	3/8	0.787	0.768	0.413	1.181	1.102	0.591	0.787
ND6523 08-08	1/2	1/2	0.787	0.768	0.551	1.339	1.102	0.591	0.945
ND6523 10-08	5/8	1/2	0.976	0.984	0.551	1.555	1.378	0.787	0.945

*Produced Upon Request - Contact Camozzi for Availability

General terms and conditions for sale are available on www.camozzi.com.

This document contains a brief description of the products offered by Camozzi Automation at the time of publication. For more complete and up-to-date information about the Camozzi Automation product range, please refer to our online catalogue at <http://catalogue.camozzi.com/>.

"Y" and 45° connectors

Male Non-Swivel 45° Fittings Mod. ND6100

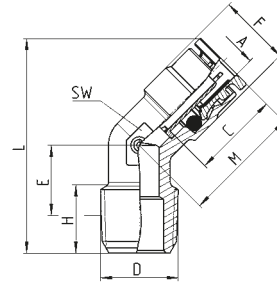

DIMENSIONS (in inches)									
Mod.	A OD	D NPTF	C	F	E	H	L	M	SW
ND6100 04-02	1/4	1/8	0.606	0.500	0.413	0.335	1.327	0.827	0.433
ND6100 04-04	1/4	1/4	0.606	0.500	0.453	0.472	1.484	0.827	0.433
ND6100 06-02	3/8	1/8	0.787	0.650	0.492	0.335	1.634	1.063	0.591
ND6100 06-04	3/8	1/4	0.787	0.650	0.512	0.492	1.772	1.063	0.591
ND6100 06-06	3/8	3/8	0.787	0.650	0.453	0.433	1.752	1.063	0.591
ND6100 06-08	3/8	1/2	0.787	0.650	0.531	0.591	1.909	1.063	0.591
ND6100 08-04	1/2	1/4	0.787	0.768	0.512	0.492	1.831	1.102	0.591
ND6100 08-06	1/2	3/8	0.787	0.768	0.453	0.433	1.811	1.102	0.591
ND6100 08-08	1/2	1/2	0.787	0.768	0.531	0.591	1.969	1.102	0.591
ND6100 10-06	5/8	3/8	0.976	0.984	0.630	0.492	2.248	1.398	0.906
ND6100 10-08	5/8	1/2	0.976	0.984	0.689	0.630	2.386	1.398	0.906
ND6100 12-08	3/4	1/2	1.094	1.122	0.689	0.630	2.469	1.437	0.906
ND6100 12-12	3/4	3/4	1.094	1.122	0.709	0.610	2.488	1.437	0.906

Male Swivel 45° Fittings Mod. ND6110

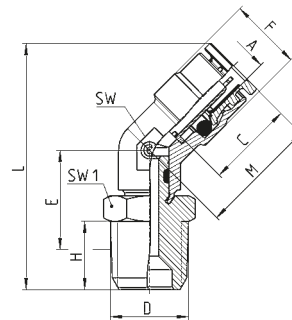

DIMENSIONS (in inches)										
Mod.	A OD	D NPTF	C	F	E	H	L	M	SW	SW1
ND6110 04-02	1/4	1/8	0.606	0.500	0.630	0.315	1.555	0.827	0.433	0.472
ND6110 04-04	1/4	1/4	0.606	0.500	0.669	0.472	1.713	0.827	0.433	0.551
ND6110 04-06	1/4	3/8	0.606	0.500	0.650	0.472	1.732	0.827	0.433	0.748
ND6110 06-04	3/8	1/4	0.787	0.650	0.709	0.472	1.969	1.063	0.591	0.669
ND6110 06-06	3/8	3/8	0.787	0.650	0.669	0.472	1.969	1.063	0.591	0.748
ND6110 06-08	3/8	1/2	0.787	0.650	0.748	0.610	2.126	1.063	0.591	0.866
ND6110 08-06	1/2	3/8	0.787	0.768	0.669	0.472	2.028	1.102	0.591	0.748
ND6110 08-08	1/2	1/2	0.787	0.768	0.748	0.610	2.185	1.102	0.591	0.866
ND6110 10-08	5/8	1/2	0.976	0.984	0.945	0.610	2.638	1.398	0.906	0.945
ND6110 12-12	3/4	3/4	1.094	1.122	0.945	0.610	2.717	1.437	0.906	1.063

General terms and conditions for sale are available on www.camozzi.com.
 This document contains a brief description of the products offered by Camozzi Automation at the time of publication.
 For more complete and up-to-date information about the Camozzi Automation product range, please refer to our online catalogue at <http://catalogue.camozzi.com/>.

Male Swivel "Y" Fittings Mod. ND6450

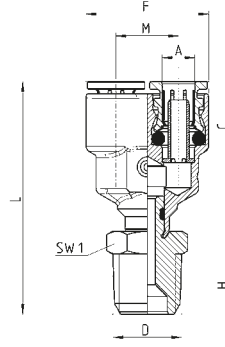

DIMENSIONS (in inches)									
Mod.	A OD	D NPTF	C	F	H	L	M	SW1	
ND6450 53-02	5/32	1/8	0.520	0.709	0.315	1.358	0.354	0.472	
ND6450 04-02	1/4	1/8	0.606	0.965	0.315	1.496	0.492	0.472	
ND6450 04-04	1/4	1/4	0.606	0.965	0.472	1.535	0.492	0.551	
ND6450 06-04	3/8	1/4	0.787	1.260	0.472	2.067	0.630	0.669	
ND6450 08-06	1/2	3/8	0.787	1.575	0.472	2.106	0.748	0.748	
ND6450 08-08	1/2	1/2	0.787	1.575	0.610	2.185	0.748	0.866	

Tee connectors

Male Non-Swivel Branch Tee Fittings Mod. ND6410

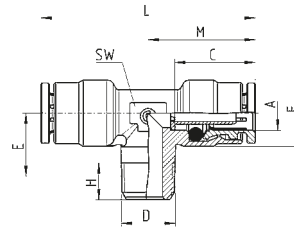

DIMENSIONS (in inches)									
Mod.	A OD	D NPTF	C	F	E	H	L	M	SW
ND6410 04-02	1/4	1/8	0.606	0.500	0.472	0.413	1.614	0.807	0.354
ND6410 04-04	1/4	1/4	0.606	0.500	0.472	0.472	1.614	0.807	0.433
ND6410 04-06	1/4	3/8	0.606	0.512	0.610	0.472	1.614	0.807	0.512
ND6410 06-02	3/8	1/8	0.787	0.650	0.531	0.335	2.087	1.043	0.512
ND6410 06-04	3/8	1/4	0.787	0.650	0.551	0.492	2.087	1.043	0.512
ND6410 06-06	3/8	3/8	0.787	0.650	0.571	0.492	2.126	1.063	0.591
ND6410 06-08	3/8	1/2	0.787	0.650	0.650	0.630	2.283	1.142	0.669
ND6410 08-04	1/2	1/4	0.787	0.768	0.610	0.492	2.205	1.102	0.591
ND6410 08-06	1/2	3/8	0.787	0.768	0.571	0.492	2.205	1.102	0.591
ND6410 08-08	1/2	1/2	0.787	0.768	0.650	0.630	2.283	1.142	0.669

Female Non-Swivel Branch Tee Fittings Mod. ND6413

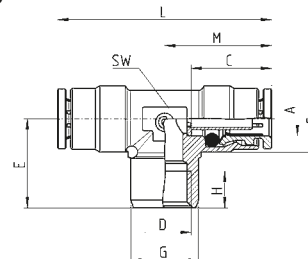

DIMENSIONS (in inches)										
Mod.	A OD	D NPTF	C	E	F	G	H	L	M	SW
ND6413 04-02	1/4	1/8	0.606	0.669	0.500	0.512	0.276	1.614	0.807	0.433
ND6413 04-04	1/4	1/4	0.606	0.885	0.591	0.650	0.394	1.811	0.906	0.591
ND6413 06-04	3/8	1/4	0.787	0.885	0.650	0.650	0.394	2.126	1.063	0.591
ND6413 06-06	3/8	3/8	0.787	1.024	0.650	0.787	0.413	2.205	1.102	0.669

Male Non-Swivel Run Tee Fittings Mod. ND6420

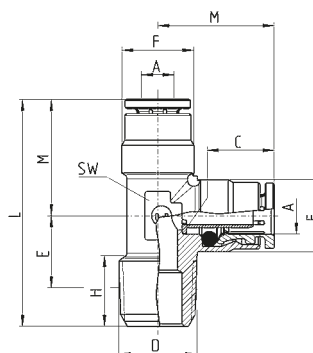

DIMENSIONS (in inches)									
Mod.	A OD	D NPTF	C	F	E	H	L	M	SW
ND6420 04-02	1/4	1/8	0.606	0.500	0.472	0.413	1.457	0.807	0.354
ND6420 04-04	1/4	1/4	0.606	0.500	0.472	0.492	1.575	0.807	0.433
ND6420 06-04	3/8	1/4	0.787	0.650	0.551	0.492	1.890	1.043	0.512
ND6420 06-06	3/8	3/8	0.787	0.650	0.571	0.492	1.969	1.063	0.591
ND6420 06-08	3/8	1/2	0.787	0.650	0.650	0.630	2.126	1.063	0.669
ND6420 08-04	1/2	1/4	0.787	0.768	0.610	0.492	2.008	1.102	0.591
ND6420 08-06	1/2	3/8	0.787	0.768	0.571	0.492	2.008	1.102	0.591

Male Swivel Branch Tee Fittings Mod. ND6430

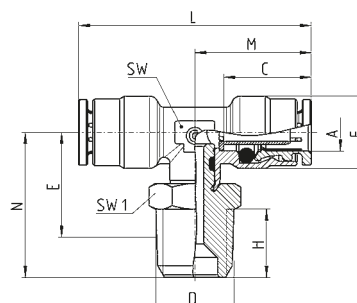

DIMENSIONS (in inches)											
Mod.	A OD	D NPTF	C	F	E	H	L	M	N	SW	SW1
ND6430 53-02	5/32	1/8	0.520	0.354	0.650	0.315	1.378	0.689	0.827	0.315	0.472
ND6430 53-04	5/32	1/4	0.520	0.354	0.689	0.472	1.378	0.689	0.984	0.315	0.551
ND6430 04-02	1/4	1/8	0.606	0.500	0.669	0.315	1.614	0.807	0.846	0.354	0.472
ND6430 04-04	1/4	1/4	0.606	0.500	0.709	0.472	1.614	0.807	1.004	0.354	0.551
ND6430 04-06	1/4	3/8	0.606	0.500	0.689	0.472	1.614	0.807	1.024	0.354	0.748
ND6430 06-02	3/8	1/8	0.787	0.650	0.787	0.315	2.087	1.043	0.965	0.512	0.472
ND6430 06-04	3/8	1/4	0.787	0.650	0.827	0.472	2.087	1.043	1.122	0.512	0.551
ND6430 06-06	3/8	3/8	0.787	0.650	0.807	0.472	2.087	1.043	1.142	0.512	0.748
ND6430 06-08	3/8	1/2	0.787	0.650	0.886	0.610	2.087	1.043	1.299	0.512	0.866
ND6430 08-04	1/2	1/4	0.787	0.768	0.886	0.472	2.205	1.102	1.181	0.591	0.669
ND6430 08-06	1/2	3/8	0.787	0.768	0.846	0.472	2.205	1.102	1.181	0.591	0.748
ND6430 08-08	1/2	1/2	0.787	0.768	0.925	0.610	2.205	1.102	1.339	0.591	0.866
ND6430 10-06*	5/8	3/8	0.976	0.984	0.984	0.472	2.756	1.378	1.535	0.787	0.866
ND6430 10-08	5/8	1/2	0.976	0.984	1.122	0.610	2.756	1.378	1.535	0.787	0.866

*Produced Upon Request - Contact Camozzi for Availability

General terms and conditions for sale are available on www.camozzi.com.
 This document contains a brief description of the products offered by Camozzi Automation at the time of publication.
 For more complete and up-to-date information about the Camozzi Automation product range, please refer to our online catalogue at <http://catalogue.camozzi.com/>.

Male Swivel Run Tee Fittings Mod. ND6440

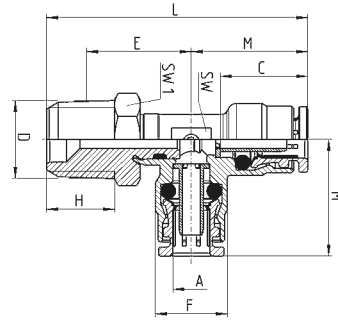

SERIES ND

DIMENSIONS (in inches)										
Mod.	A OD	D NPTF	C	F	E	H	L	M	SW	SW1
ND6440 53-02	5/32	1/8	0.520	0.354	0.650	0.315	1.516	0.689	0.315	0.472
ND6440 53-04	5/32	1/4	0.520	0.354	0.689	0.472	1.673	0.689	0.315	0.551
ND6440 04-02	1/4	1/8	0.606	0.500	0.669	0.315	1.654	0.807	0.354	0.472
ND6440 04-04	1/4	1/4	0.606	0.500	0.709	0.472	1.811	0.807	0.354	0.551
ND6440 04-06	1/4	3/8	0.606	0.500	0.689	0.472	1.831	0.807	0.354	0.748
ND6440 04-08*	1/4	1/2	0.606	0.500	0.826	0.472	1.988	0.807	0.354	0.866
ND6440 06-04	3/8	1/4	0.787	0.650	0.827	0.472	2.165	1.043	0.512	0.551
ND6440 06-06	3/8	3/8	0.787	0.650	0.807	0.472	2.185	1.043	0.512	0.748
ND6440 06-08	3/8	1/2	0.787	0.650	0.886	0.610	2.343	1.043	0.512	0.866
ND6440 08-04	1/2	1/4	0.787	0.768	0.886	0.472	2.283	1.102	0.591	0.669
ND6440 08-06	1/2	3/8	0.787	0.768	0.846	0.472	2.283	1.102	0.591	0.748
ND6440 08-08	1/2	1/2	0.787	0.768	0.925	0.610	2.441	1.102	0.591	0.866
ND6440 10-08	5/8	1/2	0.976	0.984	1.122	0.610	2.913	1.378	0.787	0.866

*Produced Upon Request - Contact Camozzi for Availability

Female Swivel Branch Tee Fittings Mod. ND6433

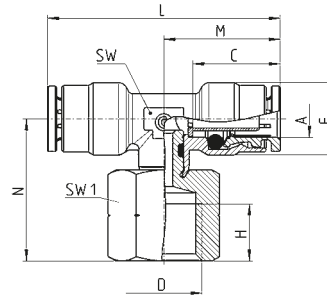

DIMENSIONS (in inches)										
Mod.	A OD	D NPTF	C	F	H	L	M	N	SW	SW1
ND6433 04-04	1/4	1/4	0.606	0.500	0.394	1.614	0.807	0.827	0.354	0.669
ND6433 06-04	3/8	1/4	0.787	0.650	0.394	2.087	1.043	1.102	0.512	0.669
ND6433 06-06	3/8	3/8	0.787	0.650	0.413	2.087	1.043	1.122	0.512	0.787
ND6433 08-04	1/2	1/4	0.787	0.768	0.394	2.205	1.102	1.122	0.591	0.669
ND6433 08-06	1/2	3/8	0.787	0.768	0.413	2.205	1.102	1.181	0.591	0.787
ND6433 08-08	1/2	1/2	0.787	0.768	0.551	2.205	1.102	1.339	0.591	0.945

Union and Bulkhead connectors

Union Tee Fittings Mod. ND6540

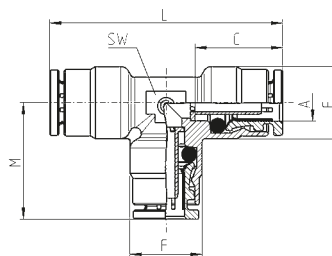

DIMENSIONS (in inches)							
Mod.	A OD	C	F	M	L	SW	
ND6540 53-00	5/32	0.520	0.354	0.689	1.378	0.315	
ND6540 04-00	1/4	0.606	0.500	0.807	1.614	0.354	
ND6540 06-00	3/8	0.787	0.650	1.043	2.086	0.512	
ND6540 08-00	1/2	0.787	0.768	1.122	2.204	0.591	
ND6540 10-00	5/8	0.976	0.984	1.378	2.756	0.787	
ND6540 12-00	3/4	1.094	1.122	1.437	2.874	0.945	

Reducing Union Tee Fittings Mod. ND6540

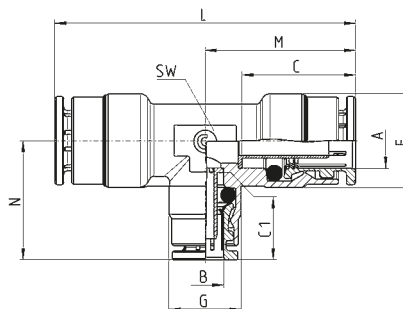

DIMENSIONS (in inches)										
Mod.	A OD	B OD	C	C1	F	G	M	N	L	SW
ND6540 06-06-04	3/8	1/4	0.787	0.606	0.650	0.500	1.043	0.827	2.087	0.512
ND6540 08-08-04*	1/2	1/4	0.787	0.606	0.768	0.500	1.102	0.886	2.205	0.591
ND6540 08-08-06*	1/2	3/8	0.787	0.787	0.768	0.650	1.102	1.102	2.205	0.591

*Produced Upon Request - Contact Camozzi for Availability

Union Elbow Fittings Mod. ND6550

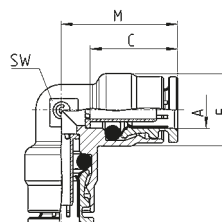

DIMENSIONS (in inches)						
Part No.	A OD	C	F	M	SW	
ND6550 53-00	5/32	0.520	0.354	0.689	0.315	
ND6550 04-00	1/4	0.606	0.500	0.807	0.354	
ND6550 06-00	3/8	0.787	0.650	1.043	0.512	
ND6550 08-00	1/2	0.787	0.768	1.102	0.591	
ND6550 10-00	5/8	0.976	0.984	1.378	0.787	

General terms and conditions for sale are available on www.camozzi.com.
 This document contains a brief description of the products offered by Camozzi Automation at the time of publication.
 For more complete and up-to-date information about the Camozzi Automation product range, please refer to our online catalogue at <http://catalogue.camozzi.com/>.

Union "Y" Fittings Mod. ND6560

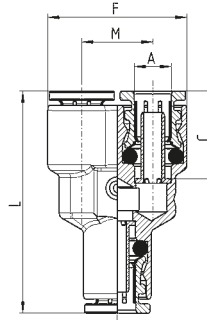

DIMENSIONS (in inches)						
Part No.	A OD	C	F	L	M	
ND6560 53-00	5/32	0.520	0.709	1.299	0.354	
ND6560 04-00	1/4	0.606	0.965	1.535	0.492	
ND6560 06-00	3/8	0.787	1.260	2.146	0.630	
ND6560 08-00	1/2	0.787	1.575	2.244	0.748	

Unequal Union "Y" Fittings Mod. ND6560

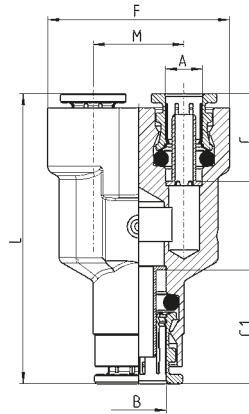

DIMENSIONS (in inches)							
Part No.	A OD	B	C	C1	F	L	M
ND6560 04-06	1/4	3/8	0.606	0.787	1.260	2.008	0.630
ND6560 06-08	3/8	1/2	0.787	0.787	1.575	2.244	0.748

Union Fittings Mod. ND6580

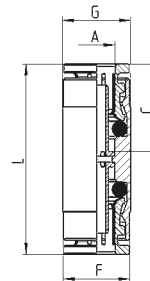

DIMENSIONS (in inches)						
Part No.	A OD	C	F	G	L	
ND6580 53-00	5/32	0.520	0.331	0.354	1.142	
ND6580 04-00	1/4	0.606	0.461	0.472	1.319	
ND6580 06-00	3/8	0.787	0.606	0.650	1.673	
ND6580 08-00	1/2	0.787	0.736	0.768	1.673	
ND6580 10-00	5/8	0.976	0.925	0.976	2.047	
ND6580 12-00	3/4	1.094	1.055	1.094	2.047	

Reducing Union Fittings Mod. ND6580

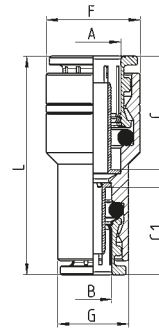

DIMENSIONS (in inches)							
Part No.	A OD	B	C	C1	F	G	L
ND6580 04-53	1/4	5/32	0.606	0.520	0.472	0.362	1.240
ND6580 06-04	3/8	1/4	0.787	0.606	0.650	0.492	1.516

Bulkhead Union Fittings Mod. ND6590

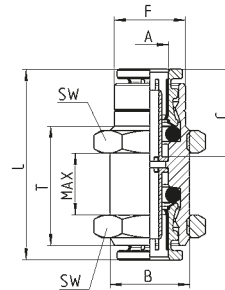

DIMENSIONS (in inches)								
Part No.	A OD	B	C	F	MAX	L	T	SW
ND6590 53-00	5/32	M10X1	0.520	0.346	0.472	1.142	0.787	0.551
ND6590 04-00	1/4	M14X1	0.606	0.492	0.512	1.319	0.827	0.669
ND6590 06-00	3/8	M18X1	0.787	0.650	0.591	1.673	0.945	0.866
ND6590 08-00	1/2	M22X1	0.787	0.768	0.630	1.673	1.063	1.063
ND6590 10-00	5/8	M26X1	0.976	0.965	0.827	2.047	1.260	1.260

Female Bulkhead Fittings Mod. ND6593

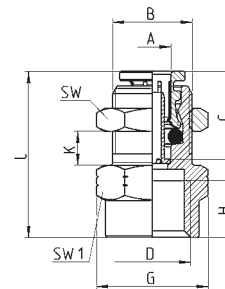

DIMENSIONS (in inches)											
Mod.	A OD	D NPTF	B	C	G	H	K (MAX)	K (MIN)	L	SW	SW1
ND6593 53-04	5/32	1/4	M10X1	0.520	0.776	0.394	0.335	0.079	1.122	0.551	0.669
ND6593 04-02	1/4	1/8	M14X1	0.606	0.776	0.276	0.394	0.079	1.024	0.669	0.669
ND6593 04-04	1/4	1/4	M14X1	0.606	0.776	0.394	0.394	0.079	1.142	0.669	0.669
ND6593 06-04	3/8	1/4	M18X1	0.787	1.005	0.394	0.531	0.079	1.339	0.866	0.866
ND6593 06-06	3/8	3/8	M18X1	0.787	1.005	0.413	0.531	0.079	1.358	0.866	0.866
ND6593 06-08	3/8	1/2	M18X1	0.787	1.096	0.551	0.531	0.079	1.496	0.866	0.945
ND6593 08-06	1/2	3/8	M22X1	0.787	1.096	0.413	0.492	0.079	1.358	1.063	0.945
ND6593 08-08	1/2	1/2	M22X1	0.787	1.096	0.551	0.492	0.079	1.496	1.063	0.945

General terms and conditions for sale are available on www.camozzi.com.
 This document contains a brief description of the products offered by Camozzi Automation at the time of publication.
 For more complete and up-to-date information about the Camozzi Automation product range, please refer to our online catalogue at <http://catalogue.camozzi.com/>.

Plug-in and Cartridge connectors

■ Plug-in Elbow Fittings Mod. ND6555

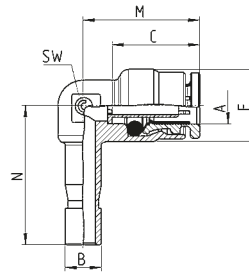

DIMENSIONS (in inches)							
Mod.	A OD	B STEM OD	C	F	M	N	SW
ND6555 04-04	1/4	1/4	0.606	0.500	0.807	0.965	0.354

■ Plug-in Reducer Fittings Mod. ND6800

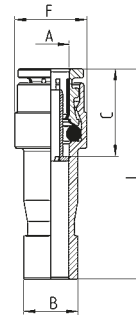

DIMENSIONS (in inches)					
Mod.	A OD	B STEM OD	C	F	L
ND6800 04-06	1/4	3/8	0.606	0.500	1.457

■ Cartridge Fittings Mod. ND6700

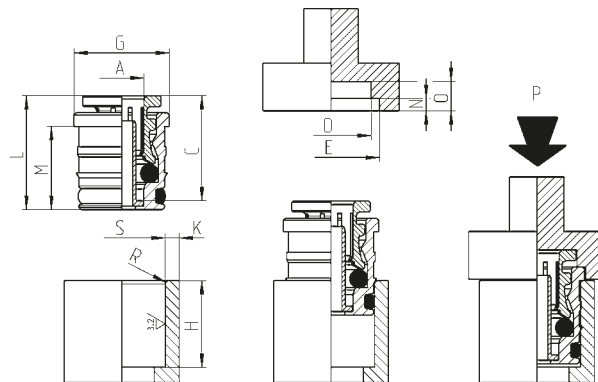

Mod.	Cartridge					Cavity				Installation Tool				
	A OD	C	G	M	L	S (±0.002)	K (min)	H (min)	R	D	E	N	O	P Max (lbs.)
ND6700 53-00	5/32	0.520	0.394	0.413	0.571	0.346	0.059	0.449	0.020	0.346	0.406	0.071	0.150	926
ND6700 04-00	1/4	0.606	0.551	0.480	0.657	0.504	0.079	0.500	0.020	0.465	0.563	0.071	0.169	1102
ND6700 06-00	3/8	0.787	0.701	0.638	0.835	0.650	0.079	0.650	0.020	0.622	0.713	0.071	0.189	2028
ND6700 08-00	1/2	0.787	0.827	0.638	0.835	0.776	0.079	0.780	0.020	0.713	0.839	0.071	0.189	2094

* Cavity dimensions listed above are suitable for non-metallic cavities, however based on the SAE J2494-4 Cartridge Cavity Dimensional Specification, cavities made from materials other than T6061-T6 aluminum may need to be adjusted dimensionally so that when installed; the tube/cartridge/cavity assembly will pass the applicable performance tests in SAE J1131 and SAE J2494-3.*The dimension for the installation tool should be noted and followed as a properly machined tool creates a specific mechanical stop which serves the purpose of avoiding damage to the collet body due to excessive insertion force being used.*Surface Finish of the gland seat required: Ra ≤ 3.2 microns.*INSTALLATION: Drill or bore hole per specifications per size of cartridge (dimensions H, S, and K).*Simply press fit cartridge into hole with an evenly distributed force over the top surface.*Removal of the collet ring is not necessary.
* Cartridge fittings are useful for installations in various manifolds and/or distribution blocks when drilling and tapping are not desirable.*For cavity specification requirements see SAE J2494-4

Accessories

■ Tube Cap Mod. ND6750

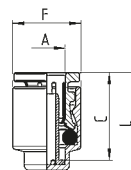

DIMENSIONS (in inches)				
Mod.	A OD	C	F	L
ND6750 53-00	5/32	0.520	0.346	0.591
ND6750 04-00	1/4	0.606	0.472	0.610

■ Fitting Plug Mod. 6900

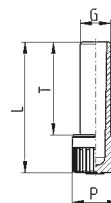

DIMENSIONS (in inches)				
Model	G STEM OD	L	P	T
6900 04-00	1/4	1.240	.315	.885
6900 06-00	3/8	1.456	.472	1.063
6900 08-00	1/2	1.594	.630	1.122

■ Tubing Cutter Mod. PNZ



Model		Replacement Blade
PNZ-12	able to cut tubes with \varnothing up to 12 mm (1/2")	LAME X PNZ-12
PNZ-25	able to cut tubes with \varnothing up to 25 mm (1")	LAME X PNZ-25

Plastic Tubing Cutter Mod. PNZP-12



Model	
PNZP-12	able to cut tubes with Ø till to 12 mm

Fitting Protection Cap Mod. 6708



Color : Black
Self-extinguishing material, class V0

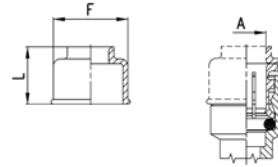

DIMENSIONS (in mm)				
Model	A	F	L	Weight (g)
6708 4	5/32	10.7	10.7	1
6708 6	1/4	13.7	11.5	1
6708 10	3/8	18.5	13	1
6708 12	1/2	20.7	15	2

DOT Tubinh Mod. TEA



Color : Black
Meets SAE Specification J844, J1131,
J2494-3 and DOT-FMVSS 106

DIMENSIONS (in inches)						
Model	Outer Diameter	Inner Diameter	Minimum Burst Pressure (psi)	Weight (lb./100ft)	Bend radius (inches)	Length (feet)
TEA 53-BK-PA-1000FT	5/32	.092	1200	.56	1/2	1000
TEA 53-BK-PA-100FT	5/32	.092	1200	.56	1/2	100
TEA 04-BK-PA-1000FT	1/4	.170	1200	1.19	1	1000
TEA 04-BK-PA-100FT	1/4	.170	1200	1.19	1	100
TEA 06-BK-PA-500FT	3/8	.251	1400	2.8	1.5	500
TEA 06-BK-PA-100FT	3/8	.251	1400	2.8	1.5	100
TEA 08-BK-PA-500FT	1/2	.376	950	3.8	2	500
TEA 08-BK-PA-100FT	1/2	.376	950	3.8	2	100
TEA 10-BK-PA-250FT	5/8	.441	900	7	2.5	250
TEA 10-BK-PA-50FT	5/8	.441	900	7	2.5	50
TEA 12-BK-PA-250FT	3/4	.566	800	8.6	3	250
TEA 12-BK-PA-50FT	3/4	.566	800	8.6	3	50

DISCOVER THE COMPLETE RANGE OF CAMOZZI AUTOMATION FITTINGS FOR THE TRANSPORTATION SECTOR

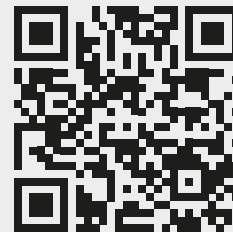

Fitting Series:

- **Series 1000**
Brass universal nose fittings
- **Series 2000**
Brass adaptors
- **Series 5000**
Quick release couplings
- **Series 6000**
Single seal brass super-rapid fittings
- **Series HP6000**
Single seal brass super-rapid fittings for lubrication
- **Series 7000**
Single seal composite super-rapid fittings
- **Series 8000/H8000**
Dual seal brass super-rapid fittings
- **Series 9000**
Dual seal brass Air Brake fittings (metric/collet design)
- **Series ND**
Single seal brass Air Brake fittings (Inch/collet design)



More Product Lines:



■ VALVES AND SOLENOID VALVES



■ ACTUATORS



■ AIR TREATMENT

Contacts

Camozzi Automation S.p.A.

Società Unipersonale
Via Eritrea, 20/I
25126 Brescia
Italy
Tel. +39 030 37921
marketing@camozzi.com

Customer Service

Tel. +39 030 3792790
service@camozzi.com

Export Department

Tel. +39 030 3792253
sales@camozzi.com



Automation

A Camozzi Group Company
www.camozzi.com

