

Nickel-Plated Brass Pipe Fittings Series 2000

Thread Type : 10-32 UNF

NPTF (1/8", 1/4", 3/8", 1/2")

Metric (M5)

BSP (G1/8, G1/4, G3/8, G1/2, G3/4, G1)

BSPT (R1/8, R1/4, R3/8, R1/2, R3/4)



When involved in factory maintenance or plant installation it is often difficult to be absolutely certain which size of fittings will be required. Pipe fittings provide a cost effective solution to this problem. The full range includes straight, L-shaped, T-shaped and cross piece male or female couplings and are available in a variety of thread sizes up to 3/4".

The addition of the Camozzi **Sprint®** seal to twelve different models of pipe fittings eliminates the need to use liquid sealants or tape and save a considerable amount of time during installation. The Sprint® fitting can be connected and disconnected several times.

Material: brass OT58 UNI 5705 (nickel-plated).

T. min. - 40°C (-40°F)

T. max. +120°C (250°F)

GENERAL DATA

Material	nickel-plated brass (UNI 5705 OT58) and PTFE
Threads	10-32 UNF, 1/8", 1/4", 3/8", 1/2" NPTF GAS conical ISO 7 (BSPT), typically models ending in "0" and/or with Sprint "S" prefix GAS cylindrical ISO 228 (BSP), typically models ending with "1", (2651/2661 gaskets required are sold separately)
Pressure	40 bar (0 to 580 psi)
Fluid	Compressed air or other low pressure fluids
Temperature	-40°C - 120°C (-40 F to 250 F)

Pipe fittings

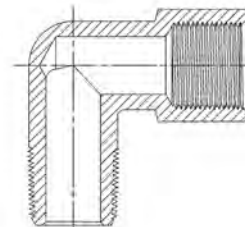

Fittings Model 2500...

Male Hex Nipple

NPTF Threads

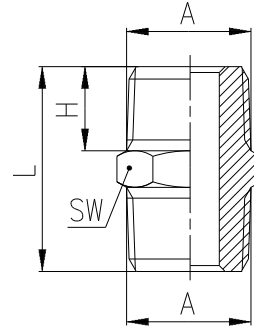

NPTF THREADS

DIMENSIONS (in inches)

Model	A	H	L	SW
NPTF				
2500 02-02	1/8	.315	.807	.472
2500 04-04	1/4	.472	1.142	.551
2500 06-06	3/8	.472	1.142	.748
2500 08-08	1/2	.610	1.437	.866

BSP Threads

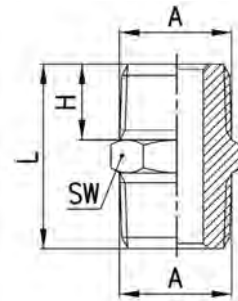

BSP THREADS

DIMENSIONS (in mm)

Model	A	H	L	SW	Weight (g)
2500 1/8	R1/8	7.5	19.5	12	9
2500 1/4	R1/4	11	27	14	16
2500 3/8	R3/8	11.5	28	17	21
2500 1/2	R1/2	14	33.5	22	41
2500 3/4	R3/4	16.5	40	27	80
2500 1	R1	19	45.5	34	125

Fittings Model S2500

BSPT Nipple Sprint®

BSP Threads

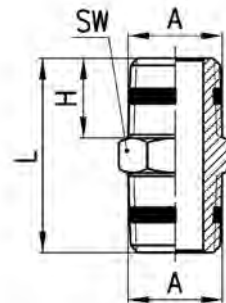

BSP THREADS

DIMENSIONS (in mm)

Model	A	H	L	SW	Weight (g)
S2500 1/8	R1/8	7.5	19.5	12	8
S2500 1/4	R1/4	11	27	14	15
S2500 3/8	R3/8	11.5	28	17	21
S2500 1/2	R1/2	14	33.5	22	39

Fittings Model 2501

Metric-BSP Nipple

BSP THREADS

DIMENSIONS (in mm)

Model	A	H	L	SW	Weight (g)
2501 M5	M5	4	11.5	8	2
2501 1/8	G1/8	6	16.5	13	9
2501 1/4	G1/4	8	21	17	15
2501 3/8	G3/8	9	23	19	21
2501 1/2	G1/2	10	25.5	24	35



BSP Threads

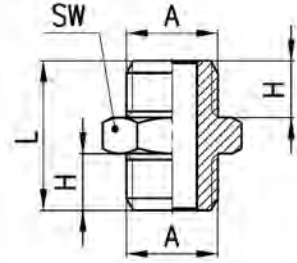

Fittings Model 2510 and S2510...

BSPT Reducing Nipple

BSP THREADS

DIMENSIONS (in mm)

Model	A1	A2	H1	H2	L	SW	Weight (g)
2510 1/8-1/4	R1/8	R1/4	7.5	11	23.5	14	14
2510 1/8-3/8	R1/8	R3/8	7.5	11.5	24	17	18
2510 1/4-3/8	R1/4	R3/8	11	11.5	27.5	17	20
2510 1/4-1/2	R1/4	R1/2	11	14	30.5	22	34
2510 3/8-1/2	R3/8	R1/2	11.5	14	31	22	34
2510 1/2-3/4	R1/2	R3/4	14	16.5	37.5	27	67



BSP Threads

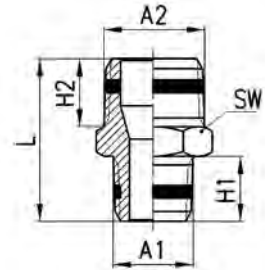
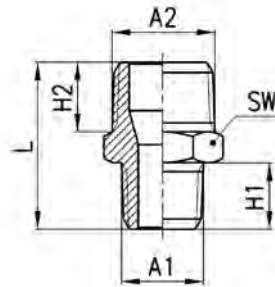

Fittings Model 2511

Metric-BSP Reducing Nipple

BSP THREADS

DIMENSIONS (in mm)

Model	A1	A2	H1	H2	L	SW	Weight (g)
2511 M5-1/8	M5	G1/8	4	6	14.5	13	8
2511 1/8-1/4	G1/8	G1/4	6	8	19	17	15
2511 1/8-3/8	G1/8	G3/8	6	9	20	19	19
2511 1/4-3/8	G1/4	G3/8	8	9	22	19	20
2511 1/4-1/2	G1/4	G1/2	8	10	23.5	24	32
2511 3/8-1/2	G3/8	G1/2	9	10	24.5	24	34



BSP Threads

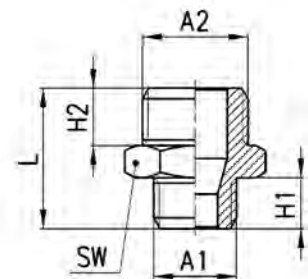

Fittings Model 2520
BSPT Male Reducing Adapter

BSP Threads

BSP THREADS						
DIMENSIONS (in mm)						
Model	A	B	H	L	SW	Weight (g)
2520 1/8-1/8	R1/8	G1/8	7.5	17.5	13	9
2520 1/8-1/4	R1/8	G1/4	7.5	19	17	15
2520 1/8-3/8	R1/8	G3/8	7.5	20	20	19
2520 1/4-1/4	R1/4	G1/4	11	22.5	17	17
2520 1/4-3/8	R1/4	G3/8	11	23.5	20	21
2520 1/4-1/2	R1/4	G1/2	11	27.5	24	35
2520 3/8-3/8	R3/8	G3/8	11.5	24	20	23
2520 3/8-1/2	R3/8	G1/2	11.5	28	24	37
2520 1/2-1/2	R1/2	G1/2	14	30.5	24	41

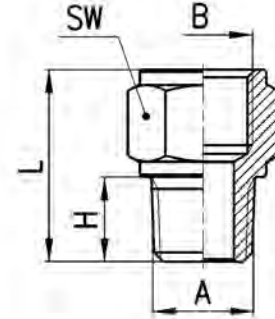

Fittings Model S2520
BSPT Male Reducing Adapter Sprint®

BSP Threads

BSP THREADS						
DIMENSIONS (in mm)						
Model	A	B	H	L	SW	Weight (g)
S2520 1/8-1/8	R1/8	G1/8	7.5	17.5	13	11
S2520 1/8-1/4	R1/8	G1/4	7.5	19	17	15
S2520 1/8-3/8	R1/8	G3/8	7.5	20	20	19
S2520 1/4-1/4	R1/4	G1/4	11	22.5	17	17
S2520 1/4-3/8	R1/4	G3/8	11	23.5	20	33
S2520 1/4-1/2	R1/4	G1/2	11	27.5	24	34
S2520 3/8-3/8	R3/8	G3/8	11.5	24	20	36
S2520 3/8-1/2	R3/8	G1/2	11.5	28	24	56
S2520 1/2-1/2	R1/2	G1/2	14	30.5	24	41

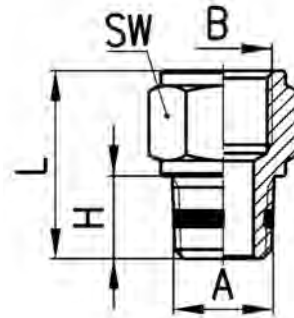

Fittings Model 2520...
Adapter BSPP Female – NPTF Male

NPTF Threads

BSP THREADS					
DIMENSIONS (in inches)					
Model	A	B	H	L	SW
	UNF	METRIC			
2520 32-M5	10-32	M5	.177	.472	.315
	NPTF	BSP			
2520 02-1/8	1/8	1/8	.315	.708	.512
2520 04-1/4	1/4	1/4	.472	.925	.669
2520 06-3/8	3/8	3/8	.472	.964	.787
2520 08-1/2	1/2	1/2	.551	1.200	.945

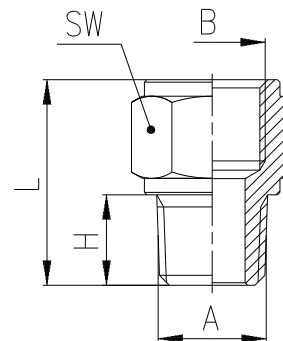

Fittings Model 2521...
Adapter NPTF Female – BSPP Male

NPTF and BSP THREADS

DIMENSIONS (in inches)

Model	A	B	H	L	SW
	BSP	NPTF			
2521 1/8-02	1/8	1/8	.236	.630	.512
2521 1/4-04	1/4	1/4	.315	.846	.669
2521 3/8-06	3/8	3/8	.354	.905	.787
2521 1/2-08	1/2	1/2	.393	1.102	.945



NPTF Threads

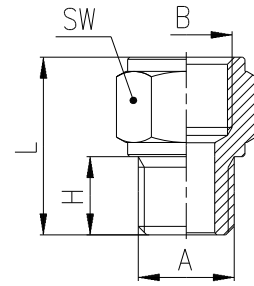

Fittings Model 2521
Metric-BSP Reducing Adapter

BSP THREADS

DIMENSIONS (in mm)

Model	A	B	H	L	SW	Weight (g)
2521 M5-1/8	M5	G1/8	4	14	13	7
2521 1/8-1/8	G1/8	G1/8	6	16	13	8
2521 1/8-1/4	G1/8	G1/4	6	17.5	17	14
2521 1/8-3/8	G1/8	G3/8	6	18.5	20	30
2521 1/4-1/4	G1/4	G1/4	8	19.5	17	16
2521 1/4-3/8	G1/4	G3/8	8	20.5	20	20
2521 1/4-1/2	G1/4	G1/2	8	24.5	24	33
2521 3/8-3/8	G3/8	G3/8	9	21.5	20	22
2521 3/8-1/2	G3/8	G1/2	9	25.5	24	35
2521 1/2-1/2	G1/2	G1/2	10	26.5	24	36



BSP Threads

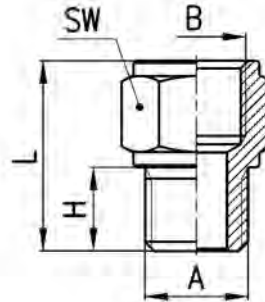

Fittings Model S2530
BSPT Reducing Bushing Sprint®

BSP THREADS

DIMENSIONS (in mm)

Model	A	B	H	L	SW	Weight (g)
S2530 1/4-1/8	R1/4	G1/8	11	16	14	9
S2530 3/8-1/8	R3/8	G1/8	11.5	16.5	17	16
S2530 1/2-1/8	R1/2	G1/8	14	19.5	22	13
S2530 3/8-1/4	R3/8	G1/4	11.5	16.5	17	33
S2530 1/2-1/4	R1/2	G1/4	14	19.5	22	32
S2530 1/2-3/8	R1/2	G3/8	14	19.5	22	22



BSP Threads

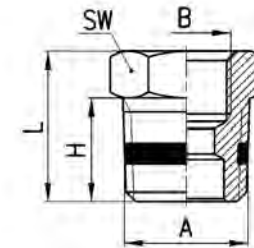

Fittings Model 2530
BSPT Reducing Bushing

BSP THREADS

DIMENSIONS (in mm)

Model	A	B	H	L	P	SW	Weight (g)
2530 1/4-1/8	R1/4	G1/8	11	16	6	14	9
2530 3/8-1/8	R3/8	G1/8	11.5	16.5	8.5	17	17
2530 1/2-1/8	R1/2	G1/8	14	19.5	9.5	22	12
2530 3/8-1/4	R3/8	G1/4	11.5	16.5	7	17	34
2530 1/2-1/4	R1/2	G1/4	14	19.5	9.5	22	30
2530 1/2-3/8	R1/2	G3/8	14	19.5	8	22	24
2530 3/4-3/8	R3/4	G3/8	16.5	23	11.5	27	67
2530 3/4-1/2	R3/4	G1/2	16.5	23.5	9.5	27	48
2530 1-1/2	R1	G1/2	19	27	14	34	131



BSP Threads

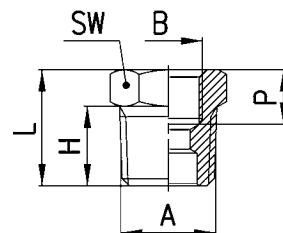

Fittings Model 2530...

Bushing NPTF – NPTF

NPTF and BSP THREADS

DIMENSIONS (in inches)

Model	A	B	H	L	SW
	NPTF	UNF			
2530 02-32	1/8	10-32	.315	.492	.472
	NPTF	NPTF			
2530 04-02	1/4	1/8	.472	.669	.551
2530 06-02	3/8	1/8	.472	.669	.748
2530 06-04	3/8	1/4	.472	.669	.748
2530 08-04	1/2	1/4	.610	.827	.866
2530 08-06	1/2	3/8	.610	.827	.866



NPTF Threads

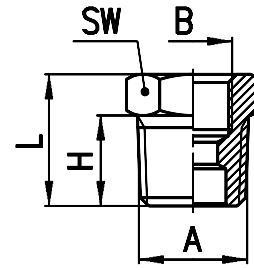

Fittings Model 2531

BSP Reducing Bushing

BSP THREADS

DIMENSIONS (in mm)

Model	A	B	H	L	SW	Weight (g)
2531 1/8-M5	G1/8	M5	6	10.5	13	8 *
2531 1/4-1/8	G1/4	G1/8	8	13	17	11 *
2531 3/8-1/8	G3/8	G1/8	9	14	19	17
2531 3/8-1/4	G3/8	G1/4	9	14	19	12 *
2531 1/2-1/8	G1/2	G1/8	10	15.5	24	32
2531 1/2-1/4	G1/2	G1/4	10	15.5	24	29
2531 1/2-3/8	G1/2	G3/8	10	15.5	24	22 *



BSP Threads

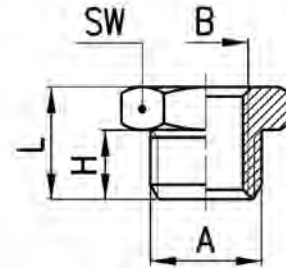

* = with through-out thread

Fittings Model 2541

BSPT Swivel Male Adapter Sprint®

BSP THREADS

DIMENSIONS (in mm)

Model	A	B	H	L	SW	SW1	Weight (g)
2541 1/8-1/8	G1/8	G1/8	5.5	28	13	14	17
2541 1/4-1/4	G1/4	G1/4	7	31.5	17	14	26
2541 3/8-3/8	G3/8	G3/8	8	34	20	19	39



BSP Threads



Fittings Model 2525

BSP Male Extension

BSP THREADS

DIMENSIONS (in mm)

Model	A	B	H	I	L	SW	Weight (g)
2525 1/8-16	G1/8	G1/8	6	16	22	13	12
2525 1/8-36	G1/8	G1/8	6	36	42	13	24
2525 1/4-27	G1/4	G1/4	8	27	35	17	30
2525 1/4-43	G1/4	G1/4	8	43	51	17	45



BSP Threads

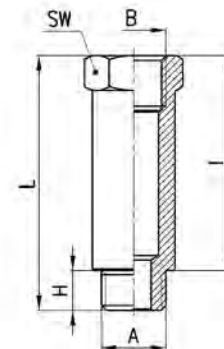

Fittings Model 2553
Reducing Female Coupling

BSP THREADS

DIMENSIONS (in mm)

Model	B1	B2	L	SW	Weight (g)
2553 M5-1/8	M5	G1/8	13.5	13	7
2553 1/8-1/4	G1/8	G1/4	17	17	18
2553 1/8-3/8	G1/8	G3/8	18	20	18
2553 1/8-1/2	G1/8	G1/2	21.5	24	28
2553 1/4-3/8	G1/4	G3/8	19.5	20	21
2553 1/4-1/2	G1/4	G1/2	23	24	32
2553 3/8-1/2	G3/8	G1/2	24	24	31



BSP Threads

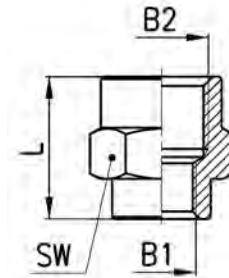

Fittings Model 2543
Female Union Coupling

BSP THREADS

DIMENSIONS (in mm)

Model	B	L	SW	Weight (g)
2543 M5	M5	11	8	3
2543 1/8	G1/8	15	13	8
2543 1/4	G1/4	22	17	19
2543 3/8	G3/8	23	20	19
2543 1/2	G1/2	28	24	29



BSP Threads

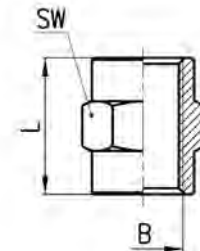

Fittings Model 2543...
Coupling NPTF Female – NPTF Female

DIMENSIONS (in inches)

Model	B	L	SW
NPTF			
2543 02-02	1/8	.630	.512
2543 04-04	1/4	.905	.669
2543 06-06	3/8	.945	.787
2543 08-08	1/2	1.220	.945



NPTF Threads

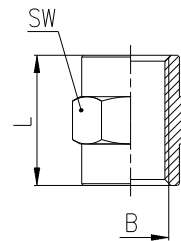

Fittings Model 2601
Metric-BSP Male Hose Adapter

BSP THREADS

DIMENSIONS (in mm)

Model	N	A	C	H	I	L	SW	Weight (g)
2601 2-M5	2	M5	1.2	4	8	16	8	2
2601 4.5-M5	4	M5	2.5	4	15	23	8	3
2601 7-1/8	7	G1/8	4	6	20	30	12	9
2601 7-1/4	7	G1/4	4	8	20	33	17	16
2601 8-1/8	8	G1/8	5	6	20	30	12	10
2601 9-1/8	9	G1/8	5.5	6	20	30	12	11
2601 9-1/4	9	G1/4	6	8	20	33	17	17
2601 9-3/8	9	G3/8	6	9	20	34	19	21
2601 12-1/4	12	G1/4	8.5	8	20	33	17	20
2601 12-3/8	12	G3/8	9	9	20	34	19	23
2601 12-1/2	12	G1/2	9	10	20	35.5	24	34
2601 17-3/8	17	G3/8	12	9	24	38	19	31
2601 17-1/2	17	G1/2	13	10	24	39.5	24	41



BSP Threads

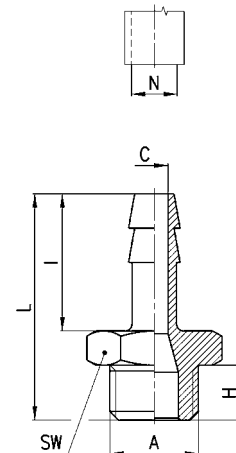

Fittings Model 2611

BSP Male Plug

BSP THREADS					
DIMENSIONS (in mm)					
Model	A	H	L	SW	Weight (g)
2611 M5	M5	4	7.5	8	2
2611 1/8	G1/8	6	10.5	13	7
2611 1/4	G1/4	8	13	17	13
2611 3/8	G3/8	9	14	19	18
2611 1/2	G1/2	10	15.5	24	31
2611 1	G1	13	19	38	76



BSP Threads

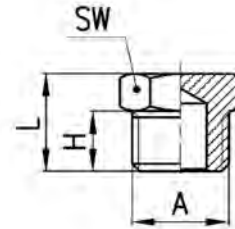

Fitting Model 2610 3/4

BSPT Male Plug

BSP THREADS					
DIMENSIONS (in mm)					
Model	A	H	L	SW	Weight (g)
2610 3/4	R3/4	16.5	23	27	61



BSP Threads

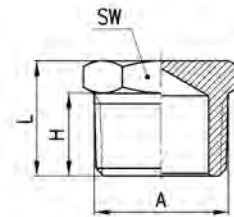

Fittings Model 2613

BSP Female Cap Plug

BSP THREADS				
DIMENSIONS (in mm)				
Model	B	L	SW	Weight (g)
2613 1/8	G1/8	11	12	6
2613 1/4	G1/4	13.5	15	13
2613 3/8	G3/8	15.5	18	19
2613 1/2	G1/2	22.5	19	33



BSP Threads

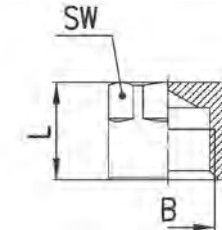

Fittings Model S2615

BSPT Male Hex Plug Sprint®

BSP THREADS				
DIMENSIONS (in mm)				
Model	A	L	SW	Weight (g)
S2615 1/8	R1/8	8	5	2
S2615 1/4	R1/4	10	7	6
S2615 3/8	R3/8	10	8	12



BSP Threads

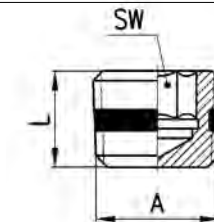

Fittings Model 2612 M7 and Model S2610

Model 2612 M7: Metric Male Socket-Cap Plug
Model S2610: BSP Male Socket-Cap Plug Sprint®

BSP THREADS				
DIMENSIONS (in mm)				
Model	A	L	SW	Weight (g)
2612 M5	M5	5.5	2	1 *
2612 M7	M7	7	4	2 *
S2610 1/8	G1/8	7.5	4	3
S2610 1/4	G1/4	9	6	6
S2610 3/8	G3/8	10	8	12
S2610 1/2	G1/2	11	10	21



BSP Threads

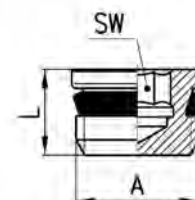

* with O-ring

Fittings Model 2020 and 2021...

Elbow NPTF Female – NPTF Male
 Model 2021: Metric Male Female Elbow
 Model 2020: BSPT Male Female Elbow

DIMENSIONS (in inches)

Model	A	B	E	H	M	SW
	NPTF	NPTF				
2020 02-00	1/8	1/8	.551	.335	.748	.472
2020 04-00	1/4	1/4	.630	.453	.984	.551
2020 06-00	3/8	3/8	.571	.433	1.043	.630
2020 08-00	1/2	1/2	.768	.591	1.299	.787

BSP THREADS

DIMENSIONS (in mm)

Model	A	B	E	H	M	P	SW	Weight (g)
2021 M5-M5	M5	M5	9	4	10.5	4.5	9	7
2020 1/8-1/8	R1/8	G1/8	11.5	8.5	19	6	11	17
2020 1/4-1/4	R1/4	G1/4	15	11	23	7	13	27
2020 3/8-3/8	R3/8	G3/8	15	11.5	25	8	15	33
2020 1/2-1/2	R1/2	G1/2	17.5	14	31.5	9.5	20	63
2020 3/4-3/4	R3/4	G3/4	19	16	36.5	16.5	25	126
2020 1-1	R1	G1	23	17	45	19	30	209



NPTF Threads

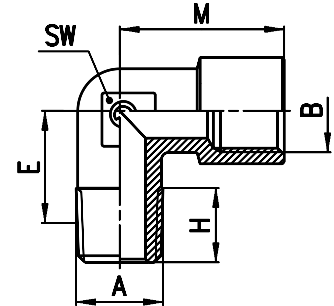

BSP Threads

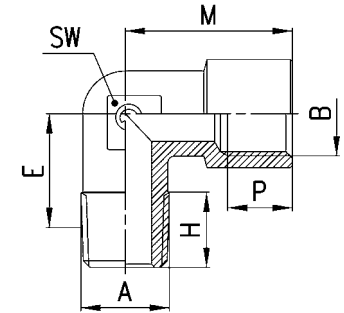

Fittings Model S2020

Male Female Elbow Sprint®

BSP THREADS

DIMENSIONS (in mm)

Model	A	B	E	H	M	SW	Weight (g)
S2020 1/8-1/8	R1/8	G1/8	11.5	8.5	19	11	16
S2020 1/4-1/4	R1/4	G1/4	15	11	23	13	27
S2020 3/8-3/8	R3/8	G3/8	15	11.5	25	15	33
S2020 1/2-1/2	R1/2	G1/2	17.5	14	31.5	20	62



BSP Threads

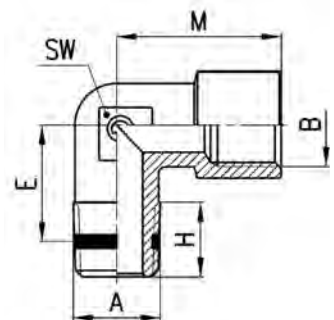

Fittings Model 2010

BSP Male Elbow

BSP THREADS

DIMENSIONS (in mm)

Model	A	E	H	SW	Weight (g)
2010 1/8	R1/8	11.5	7.5	9	10
2010 1/4	R1/4	13.5	11	12	18
2010 3/8	R3/8	15.5	11.5	14	28
2010 1/2	R1/2	16	14	16	47
2010 3/4	R3/4	19	16	25	103
2010 1	R1	23	17	30	183



BSP Threads

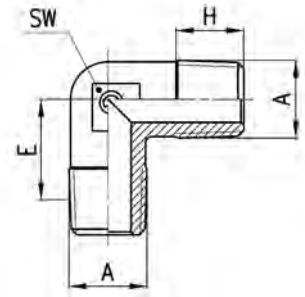

Fittings Model S2010

BSPT Male Elbow Sprint®

BSP THREADS

DIMENSIONS (in mm)

Model	A	E	H	SW	Weight (g)
S2010 1/8	R1/8	11.5	7.5	9	9
S2010 1/4	R1/4	13.5	11	12	17
S2010 3/8	R3/8	15.5	11.5	14	25
S2010 1/2	R1/2	16	14	16	47



BSP Threads

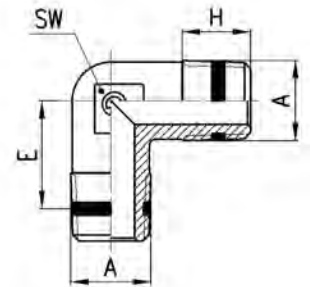

Fittings Model 2013...

Elbow NPTF Female – NPTF Female

DIMENSIONS (in inches)

Model	B	M	SW
NPTF			
2013 02-00	1/8	.748	.472
2013 04-00	1/4	.094	.551
2013 06-00	3/8	1.043	.630
2013 08-00	1/2	1.299	.787



NPTF Threads

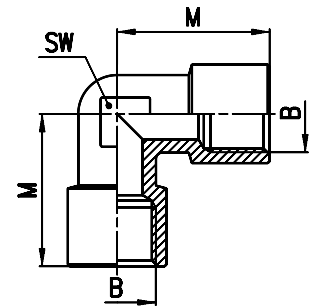

Fittings Model 2013

BSPP Female Elbow

BSP THREADS

DIMENSIONS (in mm)

Model	B	M	SW	Weight (g)
2013 1/8	G1/8	19	11	16
2013 1/4	G1/4	23	14	28
2013 3/8	G3/8	25	16	39
2013 1/2	G1/2	31.5	20	69



BSP Threads

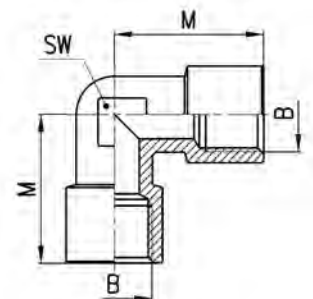

Fittings Model 2080

Male Tee

BSP THREADS

DIMENSIONS (in mm)

Model	A	E	H	SW	Weight (g)
2080 1/8	R1/8	11.5	7.5	9	14
2080 1/4	R1/4	13.5	11	12	25
2080 3/8	R3/8	15.5	11.5	14	39
2080 1/2	R1/2	16	14	16	82
2080 3/4	R3/4	19	16.2	25	135
2080 1	R1	23	17.5	30	239



BSP Threads

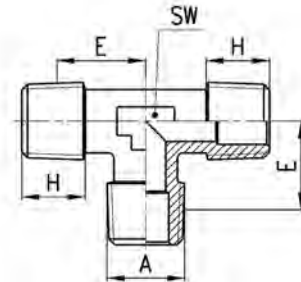

Fittings Model S2080

Male Tee Sprint®

BSP THREADS

DIMENSIONS (in mm)

Model	A	E	H	SW	Weight (g)
S2080 1/8	R1/8	11.5	7.5	9	14
S2080 1/4	R1/4	13.5	11	12	31
S2080 3/8	R3/8	15.5	11.5	14	50
S2080 1/2	R1/2	16	14	16	63



BSP Threads

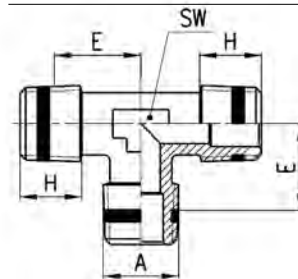

Fittings Model 2090

M.F.M. Tee

BSP THREADS

DIMENSIONS (in mm)

Model	A	B	E	H	M	P	SW	Weight (g)
2090 1/8-1/8	R1/8	G1/8	11.5	8.5	19	6	12	22
2090 1/4-1/4	R1/4	G1/4	15	11	23	7	13	37
2090 3/8-3/8	R3/8	G3/8	15	11.5	25	8	16	44
2090 1/2-1/2	R1/2	G1/2	17.5	14	31.5	9.5	20	83
2090 3/4-3/4	R3/4	G3/4	19	16	36.5	16.5	25	156
2090 1-1	R1	G1	23	17.5	45	19	30	262



BSP Threads

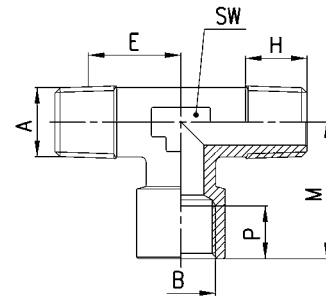

Fittings Model S2090

M.F.M. Tee Sprint®

BSP THREADS

DIMENSIONS (in mm)

Model	A	B	E	H	M	SW	Weight (g)
S2090 1/8-1/8	R1/8	G1/8	11.5	8.5	19	12	22
S2090 1/4-1/4	R1/4	G1/4	15	11	23	13	16
S2090 3/8-3/8	R3/8	G3/8	15	11.5	25	16	59
S2090 1/2-1/2	R1/2	G1/2	17.5	14	31.5	20	80



BSP Threads

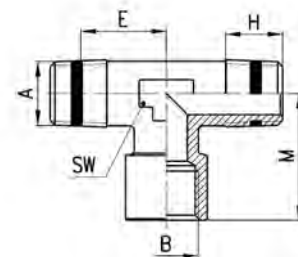

Fittings Model 2060

F.M.F. Tee

BSP Threads

BSP THREADS							
DIMENSIONS (in mm)							
Model	A	B	E	H	M	SW	Weight (g)
2060 1/8-1/8	R1/8	G1/8	11.5	8.5	19	12	22
2060 1/4-1/4	R1/4	G1/4	15	11	23	13	38
2060 3/8-3/8	R3/8	G3/8	15	11.5	25	16	49
2060 1/2-1/2	R1/2	G1/2	17.5	14	31.5	20	89

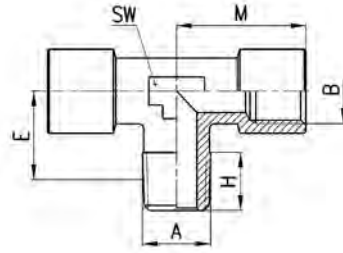

Fittings Model S2060

F.M.F. Tee Sprint®

BSP Threads

BSP THREADS							
DIMENSIONS (in mm)							
Model	A	B	E	H	M	SW	Weight (g)
S2060 1/8-1/8	R1/8	G1/8	11.5	8.5	19	12	31
S2060 1/4-1/4	R1/4	G1/4	15	11	23	13	38
S2060 3/8-3/8	R3/8	G3/8	15	11.5	25	16	51
S2060 1/2-1/2	R1/2	G1/2	17.5	14	31.5	20	88

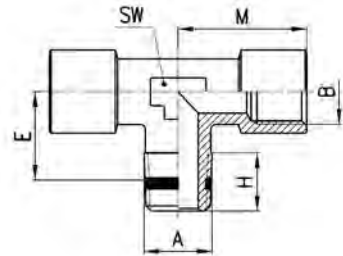

Fittings Model 2070

M.F.F. Tee

BSP Threads

BSP THREADS								
DIMENSIONS (in mm)								
Model	A	B	E	H	L	M	SW	Weight (g)
2070 1/8-1/8	R1/8	G1/8	11.5	8.5	37	19	12	22
2070 1/4-1/4	R1/4	G1/4	15	11	46	23	13	37
2070 3/8-3/8	R3/8	G3/8	15	11.5	48.5	25	16	49
2070 1/2-1/2	R1/2	G1/2	17.5	14	60.5	31.5	20	89

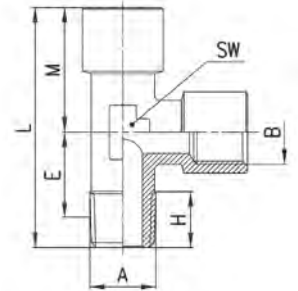

Fittings Model S2070

M.F.F. Tee Sprint®

BSP Threads

BSP THREADS								
DIMENSIONS (in mm)								
Model	A	B	E	H	L	M	SW	Weight (g)
S2070 1/8-1/8	R1/8	G1/8	11.5	8.5	37	19	12	30
S2070 1/4-1/4	R1/4	G1/4	15	11	46	23	13	36
S2070 3/8-3/8	R3/8	G3/8	15	11.5	48.5	25	16	51
S2070 1/2-1/2	R1/2	G1/2	17.5	14	60.5	31.5	20	89

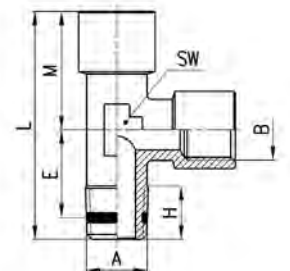

Fittings Model 2003...

Female Tee NPTF

DIMENSIONS (in inches)			
Model	B	M	SW
NPTF			
2003 02-00	1/8	.748	.472
2003 04-00	1/4	.984	.551
2003 06-00	3/8	1.043	.630
2003 08-00	1/2	1.299	.787



NPTF Threads

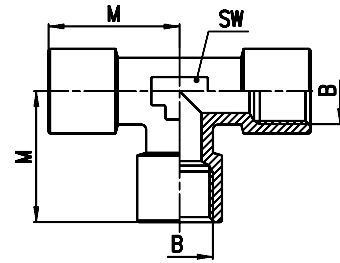

BSP THREADS				
DIMENSIONS (in mm)				
Model	B	M	SW	Weight (g)
2003 1/8	G1/8	19	12	23
2003 1/4	G1/4	23	13	39
2003 3/8	G3/8	25	16	54
2003 1/2	G1/2	31.5	20	97



BSP Threads

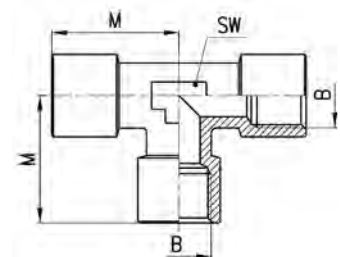

Fittings Model 2050

M.M.F. Tee

BSP THREADS								
DIMENSIONS (in mm)								
Model	A	B	E	H	L	M	SW	Weight (g)
2050 1/8-1/8	R1/8	G1/8	11.5	8.5	37	19	12	27
2050 1/4-1/4	R1/4	G1/4	15	11	46	23	13	35
2050 3/8-3/8	R3/8	G3/8	15	11.5	48.5	25	16	44
2050 1/2-1/2	R1/2	G1/2	17.5	14	60.5	31.5	20	83



BSP Threads

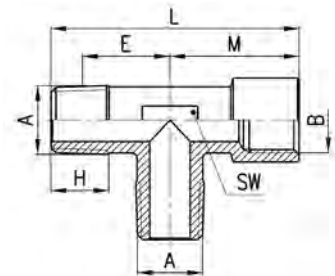

Fittings Model S2050

M.M.F. Tee Sprint®

BSP THREADS								
DIMENSIONS (in mm)								
Model	A	B	E	H	L	M	SW	Weight (g)
S2050 1/8-1/8	R1/8	G1/8	11.5	8.5	37	19	12	14
S2050 1/4-1/4	R1/4	G1/4	15	11	46	23	13	44
S2050 3/8-3/8	R3/8	G3/8	15	11.5	48.5	25	16	59
S2050 1/2-1/2	R1/2	G1/2	17.5	14	60.5	31.5	20	81



BSP Threads

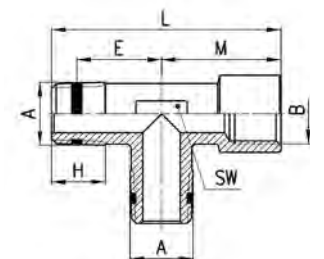

Fittings Model 2033...

Female Cross

NPTF THREADS

DIMENSIONS (in inches)

MOD	B	M	SW
UNF			
2033 32-00	10-32	.374	.354
NPTF			
2033 02-00	1/8	.748	.472
2033 04-00	1/4	.984	.551
2033 06-00	3/8	1.043	.629

BSP THREADS

DIMENSIONS (in mm)

Model	B	M	SW	Weight (g)
2033 1/8	G1/8	19	12	27
2033 1/4	G1/4	23	14	51
2033 3/8	G3/8	25	16	70

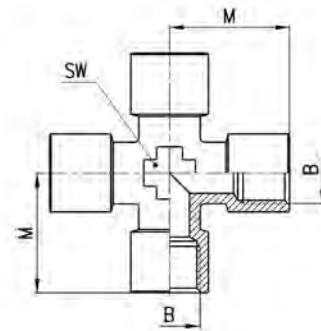
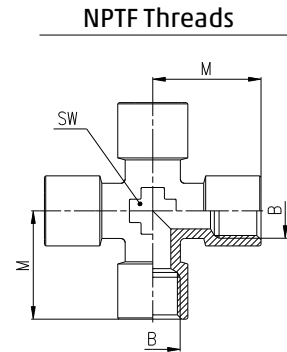

Fittings Model 2040

Y F.M.F.

BSP THREADS

DIMENSIONS (in mm)

Model	A	B	E	F	H	L	M	P	SW	Weight (g)
2040 1/8-1/8	R1/8	G1/8	9.5	14.5	8	32	14	8	13	22
2040 1/4-1/4	R1/4	G1/4	12	18	11	38	17.5	11	17	38
2040 3/8-3/8	R3/8	G3/8	13.5	20.5	11.5	42.5	19	11.5	20	52
2040 1/2-1/2	R1/2	G1/2	15.5	26.5	14	53	24.5	14	25	110

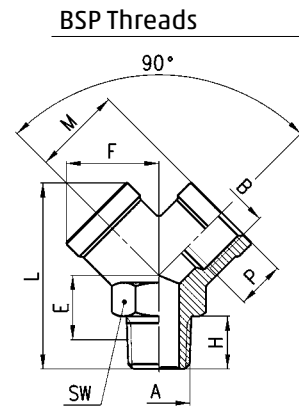

Fittings Model 2043

Female Y

BSP THREADS

DIMENSIONS (in mm)

Model	B	F	L	M	M1	P	SW	Weight (g)
2043 1/8	G1/8	14.5	26.5	14	12	8	13	18
2043 1/4	G1/4	18	32	17.5	14	11	17	32
2043 3/8	G3/8	20.5	37	19	16	11.5	20	44
2043 1/2	G1/2	26.5	45	24.5	19	14	25	84

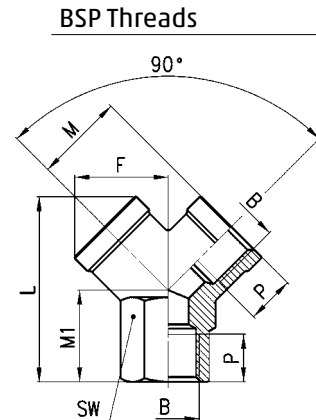

Fittings Model 3033...

4 Ways Distribution Block with mounting holes
Material: Anodized Aluminium

NPTF THREADS

DIMENSIONS (in inches)

Model	B	C	F	L	T	SW
NPTF						
3033 02-00	1/8	.157	.177	.984	.669	.630
3033 04-00	1/4	.196	.216	1.260	.866	.787
3033 06-00	3/8	.275	.216	1.575	1.023	.984
3033 08-00	1/2	.315	.216	1.968	1.338	1.181

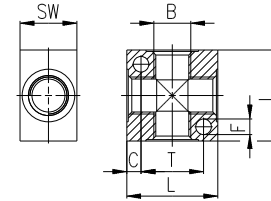

NPTF Threads

BSP THREADS

DIMENSIONS (in mm)

Model	B	C	F	L	T	SW	Weight (g)
3033 1/8	G1/8	4	4.5	25	17	16	18
3033 1/4	G1/4	5	5.5	32	22	20	35
3033 3/8	G3/8	7	5.5	40	26	25	73
3033 1/2	G1/2	8	5.5	50	34	30	137

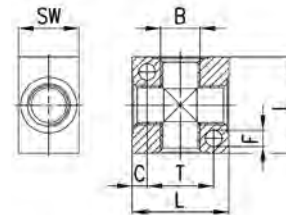

BSP Threads

Accessories Model 3043

Manifold with double lateral outlets
Material: Anodized Aluminium

BSP THREADS

DIMENSIONS (in mm)

Model	A	DOUBLE LATERAL OUTLETS	B	F	G	H	I	L	M	T	SW	Weight (g)
3043 1/4-3D-1/8	1/4	3	1/8	4.5	4.5	30	21	72	18	63	20	85
3043 1/4-4D-1/8	1/4	4	1/8	4.5	4.5	30	21	90	18	81	20	107
3043 1/4-5D-1/8	1/4	5	1/8	4.5	4.5	30	21	108	18	99	20	128
3043 1/4-6D-1/8	1/4	6	1/8	4.5	4.5	30	21	126	18	117	20	151
3043 3/8-3D-1/4	3/8	3	1/4	5.5	6	40	28	92	24	75	25	177
3043 3/8-4D-1/4	3/8	4	1/4	5.5	6	40	28	116	24	99	25	224
3043 3/8-5D-1/4	3/8	5	1/4	5.5	6	40	28	140	24	123	25	270
3043 3/8-6D-1/4	3/8	6	1/4	5.5	6	40	28	164	24	147	25	315
3043 1/2-3D-3/8	1/2	3	3/8	5.5	6.5	50	37	104	26	85	30	287
3043 1/2-4D-3/8	1/2	4	3/8	5.5	6.5	50	37	130	26	111	30	356
3043 1/2-5D-3/8	1/2	5	3/8	5.5	6.5	50	37	156	26	137	30	427
3043 1/2-6D-3/8	1/2	6	3/8	5.5	6.5	50	37	182	26	163	30	495

BSP Threads

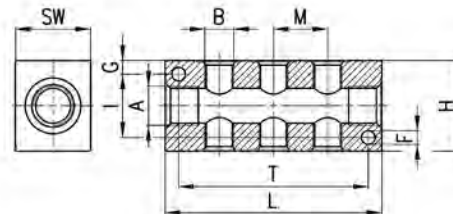

Accessories Model 3053

Manifold with lateral outlets
Material: Anodized Aluminium

BSP Threads

BSP THREADS												
DIMENSIONS (in mm)												
Model	A	SINGLE LATERAL OUTLETS	B	F	G	H	L	M	T	SW	Weight (g)	
3053 1/4-3L-1/8	1/4	3	1/8	4.5	4.5	30	72	18	63	20	92	
3053 1/4-4L-1/8	1/4	4	1/8	4.5	4.5	30	90	18	81	20	116	
3053 1/4-5L-1/8	1/4	5	1/8	4.5	4.5	30	108	18	99	20	140	
3053 1/4-6L-1/8	1/4	6	1/8	4.5	4.5	30	126	18	117	20	164	
3053 3/8-3L-1/4	3/8	3	1/4	5.5	6	40	92	24	75	25	191	
3053 3/8-4L-1/4	3/8	4	1/4	5.5	6	40	116	24	99	25	243	
3053 3/8-5L-1/4	3/8	5	1/4	5.5	6	40	140	24	123	25	294	
3053 3/8-6L-1/4	3/8	6	1/4	5.5	6	40	164	24	147	25	345	
3053 1/2-3L-3/8	1/2	3	3/8	5.5	6.5	50	104	26	85	30	313	
3053 1/2-4L-3/8	1/2	4	3/8	5.5	6.5	50	130	26	111	30	395	
3053 1/2-5L-3/8	1/2	5	3/8	5.5	6.5	50	156	26	137	30	474	
3053 1/2-6L-3/8	1/2	6	3/8	5.5	6.5	50	182	26	163	30	551	

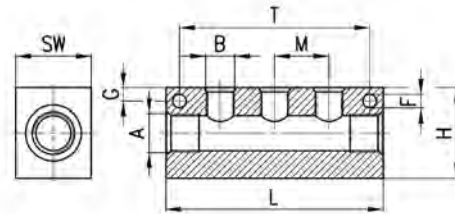

Fittings Model 2023 assembled with Model 1631, 1635

Single Female Banjo

NPTF Threads

DIMENSIONS (in inches)					
Model	B	V	O	M	W
UNF					
2023 32-32	10-32	10-32	.354	.413	.346
NPTF					
2023 02-02	1/8	1/8	.571	.787	.551
2023 04-04	1/4	1/4	.571	1.004	.709
2023 06-06	3/8	3/8	.571	1.102	.827

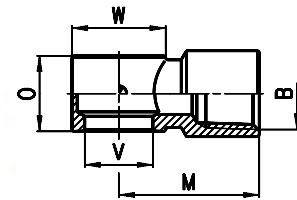

BSP Threads

BSP THREADS						
DIMENSIONS (in mm)						
Model	B	M	O	V	W	Weight (g)
2023 M5-M5	M5	10.5	9	5.1	9	6
2023 M5-M6	M5	10.5	9	5.1	9	6
2023 1/8-1/8	G1/8	20	14.5	9.8	∅ 14	14
2023 1/4-1/4	G1/4	23.5	14.5	13.2	∅ 18	21
2023 3/8-3/8	G3/8	26.5	14.5	16.7	∅ 21	27

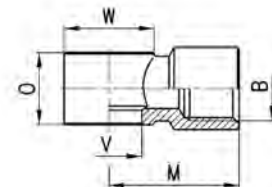

= assembly with Model SCU, SCU,
SVU... M5
= assembly with Model 1635